

F.A.I. RTE.	SECTION	COUNTY	TOTAL SHEETS	SHEET NO.
55	*	WILL	608	19
STA.	TO STA.			
FED. ROAD DIST. NO. 1		ILLINOIS FED. AID PROJECT		
* (26, 26HB-1&114) R-2 CONTRACT NO. 60363				

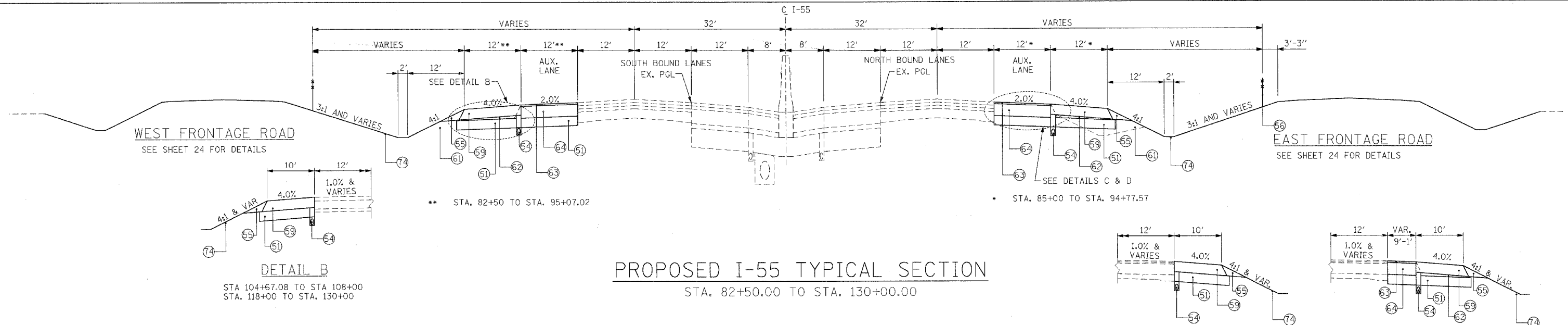
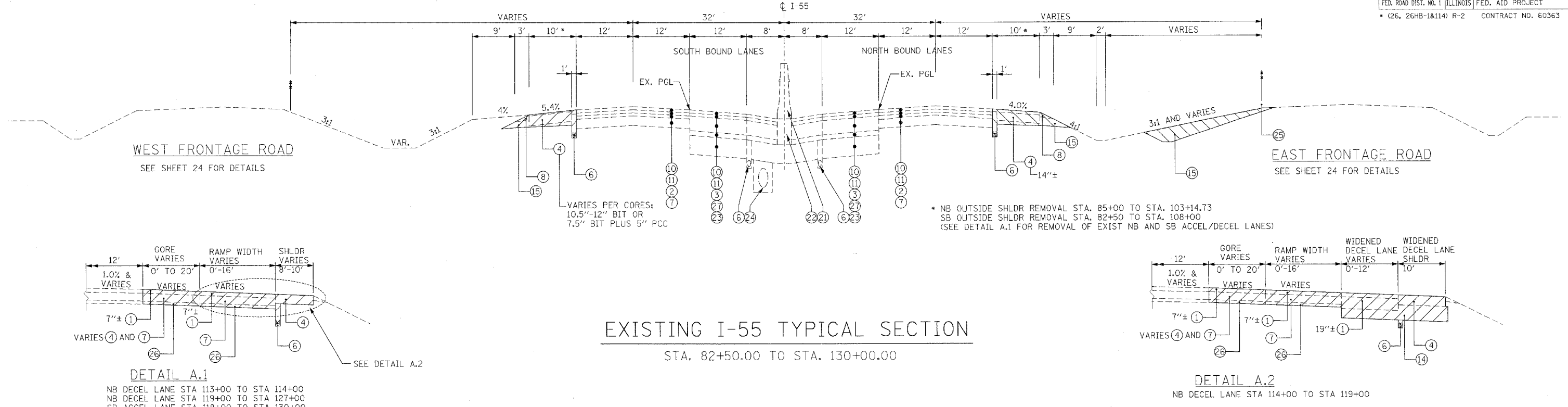

- | | |
|--------------------------------------|---|
| REMOVAL | 15 EARTH EXCAVATION |
| 1 BITUMINOUS CONCRETE PAVEMENT | 16 BIT. BASE COURSE 10" |
| 2 BIT. RESURFACING 3 1/2" AND VARIES | 17 CONC GUTTER TYPE B-6.24 |
| 3 HMA BASE CSE 8" | 18 GRAVEL BASE COURSE |
| 4 BITUMINOUS SHOULDER | 19 CONC BASE COURSE |
| 5 SUB BASE GRA. MATERIAL 4" | 20 GRANULAR SUB-BASE 8"± |
| 6 PIPE UNDERDRAIN 6" | 21 CONC. BARRIER, DOUBLE FACE, 42" HEIGHT |
| 7 P.C.C. PAVEMENT, 10" AND VARIES | 22 BARRIER BASE |
| 8 AGG. SHOULDER STONE TYPE B | 23 AGGREGATE SUBGRADE 12" |
| 9 AGG. SUBGRADE 4" | 24 STORM SEWER |
| 10 POL HMA SC SMA N80 1 3/4 | 25 FENCE (REMOVAL) |
| 11 POL HMA BC SMA N80 1 3/4 | 26 STABILIZED SUB-BASE 4" |
| 12 P.C.C. BASE COURSE 9"-7"-9" | 27 HMA BASE CSE 2 1/2" |
| 13 CONC GUTTER TYPE B 6" | 28 |
| 14 AGG. SUBGRADE (VARIES) | |

- PROPOSED LEGEND**
- | | | |
|--|--|--|
| 50 P.C.C. PAVEMENT JOINTED 9 3/4" | 60 P HMA SC "F" N90 - 2"*** | **TO BE PAID FOR AS HMA PAVT FD 17 |
| 51 AGGREGATE SUBGRADE 12" | 61 P HMA SC "F" N90 - 15"*** | |
| 52 P HMA SC "F" N90 - 2"*** | 62 HMA BC IL-19.0 N90 - 13 3/4"*** | **TO BE PAID FOR AS HMA PAVT FD 15 3/4 |
| 53 HMA BC IL-19.0 N90 - 13 3/4"*** | 63 STAB SUBBASE HMA 4" | |
| 54 PIPE UNDERDRAINS 6" | 64 HMA SC "C" N50 - 2"*** | ***TO BE PAID FOR AS HMA PAVT FD 9 |
| 55 AGGREGATE SHOULDERS, TYPE B | 65 HMA BC IL-19.0 N50 - 7"*** | |
| 56 CHAIN LINK FENCE, 4' | 66 LONGITUDINAL SAWS JOINT WITH NO. 6 TIE BARS @ 30" CTS | |
| 57 CURB AND GUTTER TYPE B-6.24 | 67 LONGITUDINAL CONSTRUCTION JOINT WITH NO. 6 TIE BARS @ 24" CTS | |
| 58 DEPRESSED CURB AND GUTTER TYPE B-6.24 | 68 SODDING, SALT TOLERANT - 4" TOPSOIL | |
| 59 HMA SHOULDERS 13" | 69 CONCRETE MEDIAN SURFACE, 5" (SPECIAL) | |
| 60 HMA SHOULDERS 8" | 70 7' - PCC SIDEWALK 5" | |
| 61 FURNISHED EXCAVATION | 71 AGGREGATE BASE COURSE, TYPE B 4" | |
| 62 AGGREGATE SUBGRADE | 72 SEEDING, CLASS 2A - 4" TOPSOIL | |
| | 73 HMA STAB AT SPBGR (PAID FOR AS HMA SHOULDERS 8") | |
| | 74 SAWED LONGITUDINAL JOINT WITH NO. 6 TIE BARS @ 18" CTS | |

REVISIONS	
NAME	DATE

ILLINOIS DEPARTMENT OF TRANSPORTATION
FAI 55 AT FAP 338 ILLINOIS ROUTE 59
SECTION: (26, 26HB-1&114) R-2
I-55 TYPICAL SECTION
STA. 82+50 TO STA. 130+00

SCALE: N.T.S. DRAWN BY: JB
DATE: 03/14/08 CHECKED BY: ACL

TENG

TENG & ASSOCIATES, INC.
ENGINEERS/ARCHITECTS/PLANNERS
360 N. MICHIGAN AVE. CHICAGO, IL 60611
TELEPHONE: 312.587.9000

\TSCORP\N\LOG\25781\25781.DWG \TSCORP\N\LOG\25781\25781.DWG \TSCORP\N\LOG\25781\25781.DWG \TSCORP\N\LOG\25781\25781.DWG
 \TSCORP\N\LOG\25781\25781.DWG \TSCORP\N\LOG\25781\25781.DWG \TSCORP\N\LOG\25781\25781.DWG \TSCORP\N\LOG\25781\25781.DWG
 \TSCORP\N\LOG\25781\25781.DWG \TSCORP\N\LOG\25781\25781.DWG \TSCORP\N\LOG\25781\25781.DWG \TSCORP\N\LOG\25781\25781.DWG
 \TSCORP\N\LOG\25781\25781.DWG \TSCORP\N\LOG\25781\25781.DWG \TSCORP\N\LOG\25781\25781.DWG \TSCORP\N\LOG\25781\25781.DWG
 \TSCORP\N\LOG\25781\25781.DWG \TSCORP\N\LOG\25781\25781.DWG \TSCORP\N\LOG\25781\25781.DWG \TSCORP\N\LOG\25781\25781.DWG