

PLAN	SURVEYED	DATE
	PLOTTED	
	CHECKED	
	BY	
	NOTE BOOK	
	NO.	
	PAID FILE NAME	

PROFILE	SURVEYED	DATE
	PLOTTED	
	CHECKED	
	BY	
	NOTE BOOK	
	NO.	
	STRUCTURE	
	NOTATIONS	
	CHRD	

10-14-2009 16:18:43 BONDHUJO BONDHUJO\M-FS-0844J-TRANS.07-2282-28868-001\CIVIL\CAO\99 ALL CONTRACTS\CONNSHEETS CONTRACT 03\DRCONN-02-SHT-DRNUTL1-99002.DGN

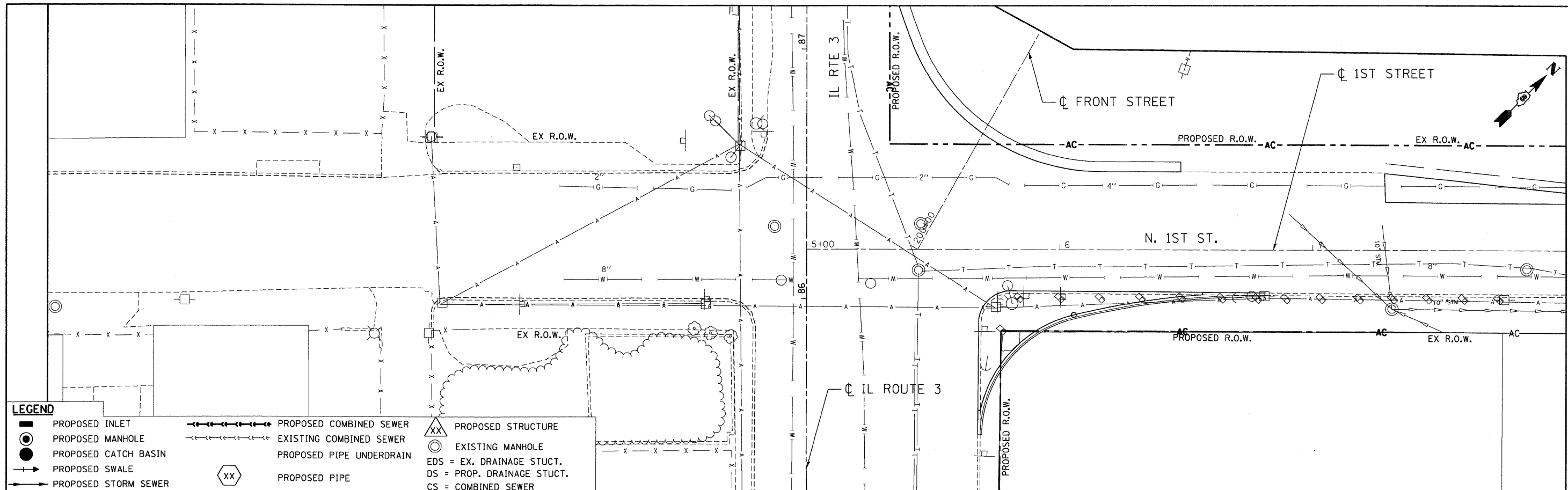

LEGEND

	PROPOSED INLET		PROPOSED COMBINED SEWER		PROPOSED STRUCTURE
	PROPOSED MANHOLE		EXISTING COMBINED SEWER		EXISTING MANHOLE
	PROPOSED CATCH BASIN		PROPOSED PIPE UNDERDRAIN		EDS = EX. DRAINAGE STUCT.
	PROPOSED SWALE		DS = PROP. DRAINAGE STUCT.		CS = COMBINED SEWER
	PROPOSED STORM SEWER		PROPOSED PIPE		

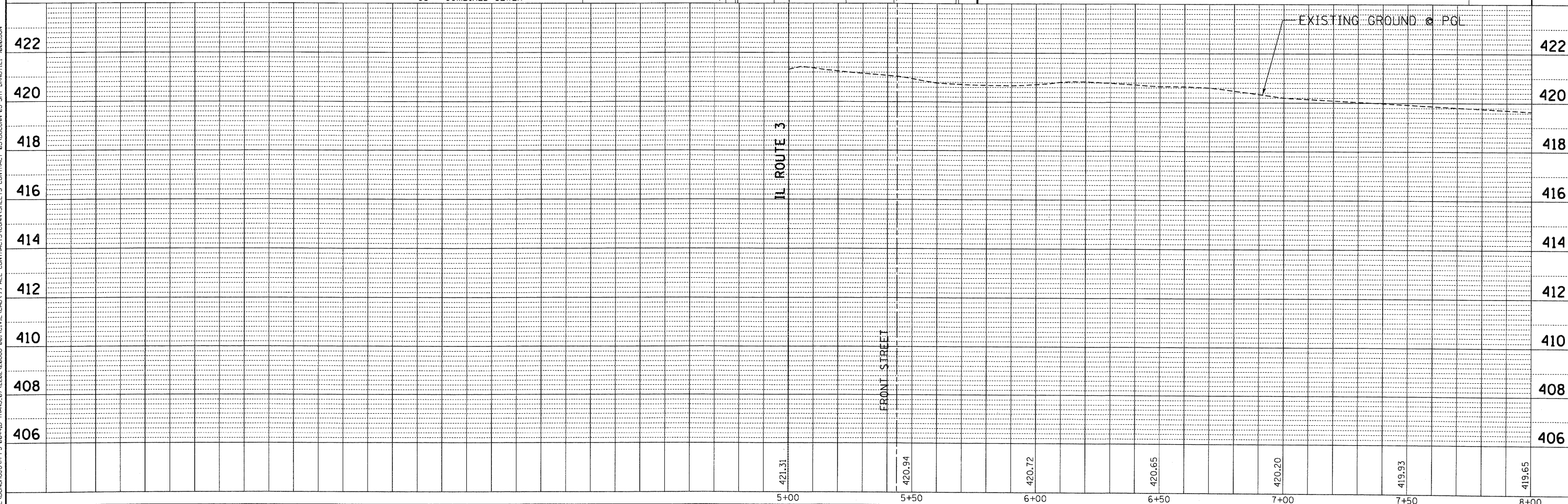

MATCH LINE STA. 8+00
SEE SHEET 60

FILE NAME =	USER NAME = *USER*	DESIGNED - JB	REVISED -	STATE OF ILLINOIS DEPARTMENT OF TRANSPORTATION I-70 CONNECTION		PROPOSED DRAINAGE PLAN & PROFILE 1ST STREET STA. 5+00.00 TO STA. 8+00.00		F.A.P. RTE.	SECTION	COUNTY	TOTAL SHEETS	SHEET NO.
#FILEL#	PLLOT SCALE = #SCALE#	DRAWN - JB	REVISED -			9153	82-1K	ST. CLAIR	107	59		
TENG	PLLOT DATE = #DATE#	CHECKED - ACL	REVISED -	SCALE: HORIZ. 1"=20'		VERT. 1"=2'		FED. ROAD DIST. NO.		ILLINOIS FED. AID PROJECT		
DATE - 10/09/09		REVISD -		STA.		TO STA.		CONTRACT NO. 76C40				