

INDEX TO SHEETS	
Sheet Number	Sheet Title
1	COVER SHEET
2	SUMMARY OF QUANTITIES AND INDEX OF SHEETS
3	SCOPE OF WORK
4	CONSTRUCTION SAFETY AND PHASING PLAN SHEET 1
5	CONSTRUCTION SAFETY AND PHASING PLAN SHEET 2
6	CONSTRUCTION SAFETY AND PHASING PLAN NOTES
7	ALIGNMENT PLAN
8	DEMOLITION PLAN
9	PROPOSED CONSTRUCTION PLAN
10	PROPOSED CONSTRUCTION POINT TABLE
11	TYPICAL SECTIONS
12	PLAN AND PROFILE - SHEET 1
13	PLAN AND PROFILE - SHEET 2
14	PLAN AND PROFILE - SHEET 3
15	PROPOSED DRAINAGE PLAN
16	BOLLARD AND DRAINAGE DETAILS
17	PROPOSED GRADING PLAN
18	PROPOSED JOINTING PLAN
19	PROPOSED JOINTING PLAN DETAILS AND NOTES
20	PROPOSED STAKING PLAN - BASE BID
21	PROPOSED STAKING PLAN - ADDITIVE ALTERNATE 1
22	PROPOSED STAKING PLAN - ADDITIVE ALTERNATE 2
23	PROPOSED MARKING PLAN
24	MARKING DETAILS
25	STORM WATER POLLUTION PREVENTION PLAN
26	STORM WATER POLLUTION PREVENTION DETAILS AND NOTES
27	HIGHWAY STANDARD DETAIL 420111-04 SHEET 1
28	HIGHWAY STANDARD DETAIL 420111-04 SHEET 2

UTILITY NOTE

THE LOCATION, SIZE, AND TYPE OF MATERIAL OF EXISTING UNDERGROUND AND/OR ABOVEGROUND UTILITIES INDICATED ON THE PLANS ARE NOT REPRESENTED AS BEING ACCURATE, SUFFICIENT OR COMPLETE. NEITHER THE OWNER NOR THE ENGINEER ASSUMES ANY RESPONSIBILITY WHATSOEVER IN RESPECT TO THE ACCURACY, COMPLETENESS, OR SUFFICIENCY OF THE INFORMATION. THERE IS NO GUARANTEE, EITHER EXPRESSED OR IMPLIED, THAT THE LOCATIONS, SIZE AND TYPE OF MATERIAL OF EXISTING UNDERGROUND UTILITIES INDICATED ARE REPRESENTATIVE OF THOSE TO BE ENCOUNTERED IN THE CONSTRUCTION. IT SHALL BE THE CONTRACTOR'S RESPONSIBILITY TO DETERMINE THE ACTUAL LOCATION OF ALL SUCH FACILITIES, INCLUDING SERVICE CONNECTIONS TO UNDERGROUND UTILITIES. PRIOR TO CONSTRUCTION, THE CONTRACTOR SHALL NOTIFY THE UTILITY COMPANIES AND AGENCIES OF HIS OPERATIONAL PLANS AND SHALL OBTAIN FROM THE RESPECTIVE UTILITY COMPANIES DETAILED INFORMATION AND ASSISTANCE RELATIVE TO THE LOCATION OF THEIR FACILITIES AND THE WORKING SCHEDULE OF THE COMPANIES FOR REMOVAL OR ADJUSTMENT WHERE REQUIRED. IN THE EVENT AN UNEXPECTED UTILITY INTERFERENCE IS ENCOUNTERED DURING CONSTRUCTION, THE CONTRACTOR SHALL STOP WORK AND IMMEDIATELY NOTIFY THE UTILITY COMPANY OF JURISDICTION. THE OWNER'S REPRESENTATIVE AND/OR THE RESIDENT ENGINEER SHALL ALSO BE IMMEDIATELY NOTIFIED. ANY DAMAGE TO SUCH MAINS AND SERVICES SHALL BE RESTORED TO SERVICE AT ONCE AND PAID FOR BY THE CONTRACTOR AT NO ADDITIONAL COST TO THE CONTRACT. ALL UTILITY CABLES AND LINES SHALL BE LOCATED BY THE RESPECTIVE UTILITY.

CONTACT JULIE (JOINT UTILITY LOCATION INFORMATION FOR EXCAVATORS) FOR UTILITY INFORMATION, PHONE: 1-800-892-0123. CONTACT THE FAA (FEDERAL AVIATION ADMINISTRATION) FOR ASSISTANCE IN LOCATING FAA CABLES AND UTILITIES. LOCATION OF FAA POWER, CONTROL, AND COMMUNICATION CABLES SHALL BE COORDINATED WITH AND/OR LOCATED BY THE FAA. ALSO CONTACT AIRPORT DIRECTOR/MANAGER AND AIRPORT PERSONNEL FOR ASSISTANCE IN LOCATING UNDERGROUND AIRPORT CABLES AND/OR UTILITIES. ALSO COORDINATE WORK WITH ALL ABOVEGROUND UTILITIES.



800.892.0123

J.U.L.I.E. INFORMATION

COUNTY _____ MACON
CITY _____ DECATUR
TOWNSHIP _____ LONG CREEK
SECTION NO. _____ 15, 16, 21, AND 22
ADDRESS _____ DECATUR AIRPORT
910 SOUTH AIRPORT ROAD
DECATUR, IL 62524

SUMMARY OF QUANTITIES - BASE BID				
ITEM NO.	DESCRIPTION	UNIT	TOTAL QUANTITY	AS-BUILT QUANTITY
AW150510	ENGINEER'S FIELD OFFICE	L SUM	1	
AW150520	MOBILIZATION	L SUM	1	
AW152410	UNCLASSIFIED EXCAVATION	CU YD	2,560	
AW152540	SOIL STABILIZATION FABRIC	SQ YD	10,630	
AW156510	SILT FENCE	FOOT	700	
AW208650	AGGREGATE SUBBASE PREPARATION	SQ YD	2,650	
AW209600	CRUSHED AGG. BASE COURSE-6"	SQ YD	10,630	
AW401010	CONTRACTOR QUALITY CONTROL PROGRAM	L SUM	1	
AW401900	REMOVE BITUMINOUS PAVEMENT	SQ YD	11,825	
AW501506	6" PCC PAVEMENT	SQ YD	10,520	
AW501530	PCC TEST BATCH	EACH	1	
AW620520	PAVEMENT MARKING-WATERBORNE	SQ FT	1,751	
AW620525	PAVEMENT MARKING-BLACK BORDER	SQ FT	1,866	
AW705526	6" PERFORATED UNDERDRAIN W/SOCK	FOOT	1,176	
AW705640	UNDERDRAIN CLEANOUT	EACH	6	
AW901510	SEEDING	ACRE	1.55	
AW905520	TOPSOILING (FROM OFF SITE)	CU YD	275	
AW908510	MULCHING	ACRE	1.55	
AW910420	BOLLARD	EACH	4	
AW910425	REMOVE BOLLARD	EACH	4	

SUMMARY OF QUANTITIES - ADDITIVE ALTERNATE NO. 1				
ITEM NO.	DESCRIPTION	UNIT	TOTAL QUANTITY	AS-BUILT QUANTITY
AX152410	UNCLASSIFIED EXCAVATION	CU YD	1,560	
AX152540	SOIL STABILIZATION FABRIC	SQ YD	6,070	
AX208650	AGGREGATE SUBBASE PREPARATION	SQ YD	1,500	
AX209606	CRUSHED AGG. BASE COURSE-6"	SQ YD	6,070	
AX401900	REMOVE BITUMINOUS PAVEMENT	SQ YD	6,006	
AX501506	6" PCC PAVEMENT	SQ YD	6,010	
AX620520	PAVEMENT MARKING-WATERBORNE	SQ FT	940	
AX620525	PAVEMENT MARKING-BLACK BORDER	SQ FT	1,018	
AX705526	6" PERFORATED UNDERDRAIN W/SOCK	FOOT	755	
AX705640	UNDERDRAIN CLEANOUT	EACH	4	
AX901510	SEEDING	ACRE	0.63	
AX908510	MULCHING	ACRE	0.63	
AX910420	BOLLARD	EACH	28	
AX910425	REMOVE BOLLARD	EACH	28	

SUMMARY OF QUANTITIES - ADDITIVE ALTERNATE NO. 2				
ITEM NO.	DESCRIPTION	UNIT	TOTAL QUANTITY	AS-BUILT QUANTITY
AY152410	UNCLASSIFIED EXCAVATION	CU YD	830	
AY152480	SHOULDER ADJUSTMENT	SQ YD	770	
AY152540	SOIL STABILIZATION FABRIC	SQ YD	3,795	
AY208650	AGGREGATE SUBBASE PREPARATION	SQ YD	950	
AY209606	CRUSHED AGG. BASE COURSE-6"	SQ YD	3,795	
AY401900	REMOVE BITUMINOUS PAVEMENT	SQ YD	3,705	
AY501506	6" PCC PAVEMENT	SQ YD	3,705	
AY620520	PAVEMENT MARKING-WATERBORNE	SQ FT	317	
AY701518	18" RCP, CLASS IV	FOOT	64	
AY701900	REMOVE PIPE	FOOT	63	
AY752418	PRECAST REINFORCED CONC. FES 18"	EACH	2	
AY901510	SEEDING	ACRE	0.16	
AY908510	MULCHING	ACRE	0.16	
AY910410	PARKING BLOCK	EACH	19	
AY910415	REMOVE PARKING BLOCK	EACH	20	

GENERAL NOTES

1. THE PROJECT PAY ITEMS ARE INTENDED TO BE INCLUSIVE OF ALL WORK TO BE PERFORMED AS SHOWN IN THESE PLANS. ALL INCIDENTAL WORK REQUIRED TO COMPLETE THE PROJECT TO THE SATISFACTION OF THE RESIDENT ENGINEER IS TO BE INCLUDED IN THE COSTS OF PERFORMING THESE ITEMS. THE CONTRACTOR SHALL FURNISH ALL LABOR, MATERIAL, EQUIPMENT, AND TRANSPORTATION NECESSARY TO CONSTRUCT ALL ELEMENTS OF THE PROJECT AS DESCRIBED IN THE CONSTRUCTION PLANS AND SPECIFICATIONS.
2. THE RULES, REGULATIONS, AND SPECIFICATIONS ENUMERATED HEREIN SHALL BE CONSIDERED AS MINIMUM REQUIREMENTS. THEY SHALL NOT PROHIBIT THE CONTRACTOR FROM FURNISHING AND INSTALLING HIGHER GRADES OF MATERIAL THAN ARE SPECIFIED HEREIN, IF APPROVED BY THE ENGINEER.
3. ACCESS TO THE SITE SHALL BE RESTRICTED EXCLUSIVELY TO THE DESIGNATED CONSTRUCTION ENTRANCE, STAGING AREA, AND HAUL ROUTE. NO EQUIPMENT OR PERSONNEL SHALL BE PERMITTED OUTSIDE THE GENERAL PROJECT AREA.
4. IT SHALL BE THE RESPONSIBILITY OF THE CONTRACTOR TO PROTECT AND KEEP CLEAN OF DEBRIS ALL EXISTING AIRFIELD AND ROADWAY PAVEMENTS AT ALL TIMES. ANY DAMAGE TO EXISTING ELECTRICAL, DRAINAGE, AND PAVEMENT STRUCTURES SHALL BE IMMEDIATELY REPAIRED AT NO ADDITIONAL COST TO THE CONTRACT.
5. IT SHALL BE THE RESPONSIBILITY OF THE CONTRACTOR TO PROTECT, PRESERVE, AND REPAIR THE EXISTING AIRFIELD AND ROADWAY PAVEMENTS AT ALL TIMES. THE CONTRACTOR SHALL REPAIR ANY DAMAGE TO EXISTING ELECTRICAL, DRAINAGE AND PAVEMENT STRUCTURES AT NO ADDITIONAL COST TO THE CONTRACT. ANY DAMAGE TO FAA CABLES, ACCESS ROADS OR TO FAA FACILITIES DURING CONSTRUCTION WILL REQUIRE THE CONTRACTOR TO REPLACE THE DAMAGED CABLES, ACCESS ROAD OR FAA FACILITIES TO FAA REQUIREMENTS AT THE CONTRACTOR'S EXPENSE. SPLICING OF CABLES IS NOT AN ACCEPTABLE FORM OF REPAIR.
6. CONTRACTOR SHALL RESTORE TO ORIGINAL CONDITION ALL GRASS, STONE, OR PAVEMENT DISTURBED BY CONTRACTOR'S CONSTRUCTION OPERATIONS, STAGING, AND CONSTRUCTION ACCESS ROUTES. DISTURBED AREAS ARE TO BE REPAIRED, GRADED, AND SEEDED AND MULCHED UNLESS OTHERWISE NOTED. STAGING AREA AND SITE ACCESS RESTORATION SHALL BE INCLUDED IN THE COST OF MOBILIZATION.
7. CONTRACTOR IS REQUIRED TO PROVIDE THEIR OWN RESTROOM FACILITIES.
8. THE LOCATION OF THE ENGINEER'S FIELD OFFICE WILL BE DETERMINED AT THE PRE-CONSTRUCTION MEETING.
9. THE OWNER SHALL HAVE THE RIGHT OF FIRST REFUSAL FOR ALL SALVAGEABLE MATERIAL REMOVED ON THE PROJECT.
10. THE CONTRACTOR SHALL BE RESPONSIBLE FOR OBTAINING PERMITS FOR HAULING ON PUBLIC ROADS, AS APPLICABLE. THE CONTRACTOR SHALL BE RESPONSIBLE FOR CORRECTING ANY DAMAGES TO ANY PAVEMENTS (PUBLIC OR PRIVATE) CAUSED BY HIS/HER CONSTRUCTION EQUIPMENT OR PERSONNEL.
11. THE CONTRACTOR SHALL PROVIDE ONE SET OF PRELIMINARY REDLINED RECORD DRAWINGS TO THE RESIDENT ENGINEER AT THE COMPLETION OF THE PROJECT FOR INCORPORATION INTO THE OFFICIAL RECORD DRAWINGS HE WILL PREPARE.
12. APPROXIMATE LOCATIONS OF UNDERGROUND UTILITIES ARE SHOWN THROUGHOUT THESE PLANS. THE CONTRACTOR SHALL DETERMINE EXACT LOCATIONS AND PROTECT THESE UTILITIES DURING CONSTRUCTION. ANY UTILITIES DAMAGED DURING CONSTRUCTION SHALL BE REPAIRED AT THE CONTRACTOR'S EXPENSE. CONTRACTOR SHALL COORDINATE WITH THE PROPER AUTHORITIES FOR THE PURPOSE OF LOCATING AND PROTECTING EXISTING UNDERGROUND UTILITIES.
13. NPDES PERMIT - THIS PROJECT WILL DISTURB MORE THAN 1 ACRE, THEREFORE A NPDES PERMIT IS REQUIRED.
14. MATERIAL CERTIFICATIONS - MATERIALS CANNOT BE INSTALLED UNTIL ALL THE MATERIAL CERTIFICATIONS FOR THAT ITEM HAVE BEEN RECEIVED, REVIEWED, AND ACCEPTED BY THE RESIDENT ENGINEER. MATERIALS INSTALLED WITHOUT APPROVAL ARE SUBJECT TO REMOVAL AND REPLACEMENT AT THE CONTRACTOR'S EXPENSE.
15. CERTIFIED PAYROLLS - THE RESIDENT ENGINEER CANNOT FORWARD A CONSTRUCTION REPORT FOR PAYMENT TO THE IDOT-DIVISION OF AERONAUTICS FOR PROCESSING UNTIL ALL CERTIFIED PAYROLLS FOR THAT PERIOD HAVE BEEN RECEIVED.
16. STANDARDS AND CODES - STANDARDS AND CODES REFERENCED HEREIN SHALL BE UNDERSTOOD TO BE REFERRING TO THE CURRENT EDITION.



Offices Nationwide
www.hanson-inc.com

Hanson Professional Services Inc
1525 S. 6th Street
Springfield, IL 62703
phone: 217-788-2450
fax: 217-788-2503

Illinois Licensed
Professional Service Corporation
#184-001084



Decatur Park District
Decatur Airport
910 South Airport Road
Decatur, IL 62521

DATE: XX/XX/2025 LICENSE: 11/30/2025
SIGNED: XX/XX/2025 EXPIRES: 11/30/2025

RECONSTRUCT SOUTH T-HANGAR PAVEMENTS

IDA NO: DEC-5251
SBG NO: 3-17-0033-TBD

[illegible]

ISSUE: NOVEMBER 14, 2025

PROJECT NO: 24A0077

CAD FILE: G-002-SOQ.DWG

DESIGN BY: AJC 03/20/202

DRAWN BY: AJC 03/20/202

REVIEWED BY: LDH 11/13/2025

SHEET TITLE

SUMMARY OF QUANTITIES AND INDEX OF SHEETS

100% SUBMITTAL

GENERAL NOTES

1. THE SCOPE OF WORK SHEET IS INTENDED ONLY AS A GENERAL DESCRIPTION OF WORK ITEMS AND THEIR APPROXIMATE LOCATIONS AND LIMITS, FOR THE PURPOSE OF UNDERSTANDING THE SCOPE OF THE PROJECT. THIS SHEET SHALL NOT BE USED AS A CONSTRUCTION PLAN. REFER TO THE FOLLOWING PLAN SHEETS FOR DETAILED CONSTRUCTION REQUIREMENTS, LOCATIONS, AND ITEMS OF WORK.
2. THIS PROJECT CONSISTS OF THE FULL-DEPTH RECONSTRUCTION OF THE SOUTH T-HANGAR ACCESS PAVEMENTS. WORK ITEMS INCLUDE, BUT ARE NOT LIMITED TO, PAVEMENT REMOVAL, UNCLASSIFIED EXCAVATION, PCC PAVEMENT, PAVEMENT MARKING, SEEDING/MULCHING, EROSION CONTROL AND ASSOCIATED WORK ITEMS. THIS PROJECT INCLUDES TWO ADDITIVE ALTERNATES.
3. THE CONTRACTOR SHALL FURNISH ALL LABOR, MATERIAL, EQUIPMENT, AND TRANSPORTATION NECESSARY TO CONSTRUCT ALL ELEMENTS OF THE PROJECT AS DESCRIBED IN THE CONSTRUCTION PLANS AND SPECIFICATIONS. THE PROJECT PAY ITEMS ARE INTENDED TO BE INCLUSIVE OF ALL WORK TO BE PERFORMED AS SHOWN IN THESE PLANS. ALL INCIDENTAL WORK REQUIRED TO COMPLETE THE PROJECT TO THE SATISFACTION OF THE RESIDENT ENGINEER/TECHNICIAN IS TO BE INCLUDED IN THE COSTS OF PERFORMING THESE ITEMS.
4. THE RULES, REGULATIONS, AND SPECIFICATIONS ENUMERATED HEREIN SHALL BE CONSIDERED AS MINIMUM REQUIREMENTS. THEY SHALL NOT PROHIBIT THE CONTRACTOR FROM FURNISHING AND INSTALLING HIGHER GRADES OF MATERIAL THAN ARE SPECIFIED HEREIN.
5. NO EQUIPMENT SHALL BE PERMITTED TO CROSS OR USE ANY EXISTING PAVEMENT OUTSIDE THE CONSTRUCTION LIMITS, GENERAL PROJECT AREA OR HAUL ROUTE.
6. UNLESS OTHERWISE NOTED, ALL DISTURBED AREAS OUTSIDE OF THE PROPOSED CONSTRUCTION LIMITS SHALL BE GRADED, SEEDED AND/OR HYDROMULCH SEEDED AT NO ADDITIONAL COST TO THE CONTRACT.
7. ALL WASTE MATERIAL SHALL BE HAULED FROM THE AIRPORT AND PROPERLY DISPOSED OF UNLESS OTHERWISE SPECIFIED HEREIN.
8. THE CONTRACTOR SHALL COORDINATE WITH THE RESIDENT ENGINEER/TECHNICIAN SO THEY MAY DEVELOP ONE SET OF REDLINED AS-BUILT DRAWINGS AT THE COMPLETION OF THE PROJECT.
9. CONTRACTOR SHALL NOTE THAT ALL AREAS WITHIN THE AIRPORT PROPERTY LINE AND OUTSIDE THE CONSTRUCTION LIMITS MAY BE USED FOR AGRICULTURAL PURPOSES. THE CONSTRUCTION LIMITS SHALL BE RESTRICTED TO AREAS THAT ARE ABSOLUTELY NECESSARY TO DISTURB TO COMPLETE THE REQUIRED WORK ITEMS. LIMITS SHALL BE COORDINATED WITH THE RESIDENT ENGINEER PRIOR TO BEGINNING ANY WORK. ALL AREAS WHICH HAVE BEEN FARMED AND/OR DESIGNATED TO BE FARMED AFTER THE PROJECT COMPLETION, AND HAVE BEEN DISTURBED BY CONSTRUCTION ACTIVITY, SHALL BE CHISEL PLOWED (36" MAX.) OR OTHERWISE SCARIFIED TO RETURN THE AREA TO A REASONABLE TILLABLE CONDITION (IF SO PERMITTED BY THE AIRPORT DIRECTOR).
10. THE CONTRACTOR MUST AT ALL TIMES MAINTAIN PROPER DRAINAGE FOR ALL AREAS AFFECTED BY HIS/HER WORK.

SURVEY POINTS				
POINT #	DESCRIPTION	ELEV.	NORTHING	EASTING
1	CHISELED SQUARE	674.103	1152609.000	831271.000
2	CHISELED SQUARE	674.598	1151900.000	831259.000
3	5/8" IRON PIN	670.831	1152553.866	831227.191
4	5/8" IRON PIN	672.000	1152026.683	831234.867

SURVEY NOTES

1. ALL COORDINATE VALUES SHOWN IN TABLE ARE BASED ON ILLINOIS STATE PLANE COORDINATE SYSTEM, EAST ZONE, NAD-83 (2011). ALL ELEVATIONS ARE REFERENCED TO NAVD 88.
2. THE CONTRACTOR SHALL BE RESPONSIBLE FOR ALL CONSTRUCTION LAYOUT AND ANY EXTENSION OF THE CONTROL NETWORK NEEDED TO PROPERLY COMPLETE THE WORK.

N

200

0

200

400

LEGEND

EXISTING BUILDINGS

PROPOSED PAVEMENT RECONSTRUCTION (BASE BID)

PROPOSED PAVEMENT REMOVAL (BASE BID)

PROPOSED PAVEMENT RECONSTRUCTION (ADD ALT 1)

PROPOSED PAVEMENT RECONSTRUCTION (ADD ALT 2)

X

EXISTING FENCE

Offices Nationwide
www.hanson-inc.com

Hanson Professional Services Inc.
1525 S. 6th Street
Springfield, IL 62703
phone: 217-788-2450
fax: 217-788-2503

Illinois Licensed
Professional Service Corporation
#184-001084

Decatur Park District
Decatur Airport
910 South Airport Road
Decatur, IL 62521

DATE: XX/XX/2025 LICENSE: 11/30/2027
SIGNED: EXPIRES:

RECONSTRUCT SOUTH T-HANGAR PAVEMENTS

IDA NO: DEC-5251
SBG NO: 3-17-0033-TBD

NO.	DATE	DESCRIPTION			
		DES	DWN	REV	

ISSUE: NOVEMBER 14, 2025
PROJECT NO: 24A0077
CAD FILE: G-003-SFY.DWG
DESIGN BY: AJC 03/20/2025
DRAWN BY: AJC 03/21/2025
REVIEWED BY: LDH 11/13/2025

SHEET TITLE

SCOPE OF WORK





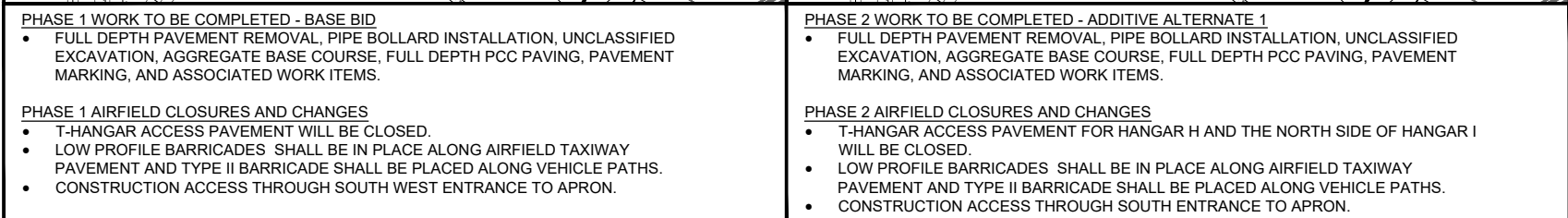

100% SUBMITTAL

I:\24\JOBS\24A0077_00\CAD\AIRPORT\1\SHEET\G-003-SFY.DWG
NOV 24, 2025 5:05 PM CRAFT02387

3



CRITICAL POINTS							
PHASE	POINT NO.	DESCRIPTION	LAT.	LONG.	GND ELEV. (MSL)	MAX EQUIP. HEIGHT (FT)	TOP ELEV. GND + EQUIP HEIGHT (MSL)
1	1	CONSTRUCTION LIMITS	N039° 49' 47.80"	W088° 52' 34.57"	672	25	697
1	2	LOW PROFILE BARRICADES	N039° 49' 43.69"	W088° 52' 34.49"	672	2	674
1	3	CONSTRUCTION LIMITS	N039° 49' 43.16"	W088° 52' 34.48"	672	25	697
2	4	CONSTRUCTION LIMITS	N039° 49' 49.51"	W088° 52' 34.60"	673	25	698
2	5	CONSTRUCTION LIMITS	N039° 49' 47.29"	W088° 52' 34.56"	672	25	697
2	6	LOW PROFILE BARRICADES	N039° 49' 46.76"	W088° 52' 36.55"	672	2	674
3	7	TYPE II BARRICADES	N039° 49' 49.50"	W088° 52' 41.17"	672	3	675
3	8	TYPE II BARRICADES	N039° 49' 43.51"	W088° 52' 41.99"	673	3	676
ALL	9	CONSTRUCTION STAGING AREA	N039° 49' 43.05"	W088° 52' 36.35"	671	25	696

PROPOSED	LEGEND
	EXISTING BUILDINGS
	CONSTRUCTION LIMITS
	CONTRACTOR STAGING / STORAGE AREA
	LOW PROFILE BARRICADES
	TEMPORARY HAUL ROUTE / ACCESS ROUTE
	TYPE II BARRICADES

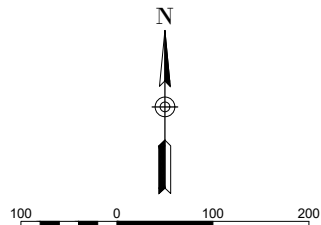

1. GENERAL - THE DECATUR AIRPORT IS COMPRISED OF THREE RUNWAYS. THE PROPOSED CONSTRUCTION WILL NOT NECESSITATE CLOSING ANY RUNWAYS.
2. ALL PROVISIONS OF THE LATEST EDITION OF FAA ADVISORY CIRCULAR 150/5370-10, "OPERATIONAL SAFETY ON AIRPORTS DURING CONSTRUCTION" APPLY TO THIS CONTRACT, EXCEPT AS MODIFIED BY THIS SAFETY PLAN AND APPROVED BY THE FAA AND THE AIRPORT.
3. THE CONTRACTOR WILL BE REQUIRED TO SUBMIT TO THE RESIDENT ENGINEER, FOR APPROVAL BY THE AIRPORT DIRECTOR, A SCHEDULE OF CONSTRUCTION ACTIVITIES PRIOR TO THE START OF CONSTRUCTION. CLOSURE OF ANY PORTION OF AIRPORT ROAD BEGINNING AND ENDING TIMES WILL BE DETERMINED BY THE AIRPORT DIRECTOR. THE CONTRACTOR IS REQUIRED TO ALLOW SUFFICIENT TIME PRIOR TO THE ENDING OF THE CLOSURE TIME FOR CURING OF PLACED MATERIALS AND CLEAN UP OF THE WORK AREA.
4. THE CONTRACTOR IS REQUIRED TO NOTIFY THE AIRPORT DIRECTOR THROUGH THE RESIDENT ENGINEER, A MINIMUM OF 7 DAYS PRIOR TO THE START OF CONSTRUCTION.
5. THE AWARDED CONTRACTOR MAY PROPOSE AN ALTERNATE, PRACTICAL AND EFFECTIVE STAGING PLAN THAT WILL MINIMIZE DISRUPTION TO NORMAL AIRPORT ACTIVITY WHILE NOT COMPROMISING SAFETY OF PERSONNEL OR THE QUALITY OF THE PROJECT. SUCH AN ALTERNATE PROPOSAL WILL BE CONSIDERED BY THE OWNER FOR APPROVAL.

1. THE CONTRACTOR AND HIS EMPLOYEES WILL BE RESTRICTED TO THE WORK AREA AND ALL OTHER AREAS OF THE AIRPORT ARE "OFF LIMITS" TO THEM.
2. THE CONTRACTOR SHALL MAINTAIN FULL USE AND ACCESS TO ALL ADMINISTRATIVE AND PARKING AREAS NOT UNDER ACTIVE CONSTRUCTION FOR THE DURATION OF THE PROJECT.
3. TRENCHES AND/OR HOLES THAT REMAIN OPEN OVERNIGHT WILL REQUIRE BARRICADES AND/OR CONES TO INDICATE THEIR LOCATION AND PREVENT ACCIDENTAL ENTRANCE, WITHIN THE PROJECT AREA AND OUTSIDE ANY ACTIVE SAFETY AREAS.
4. IDENTIFICATION - WHEN THE CONTRACTORS VEHICLES AND EQUIPMENT ARE ON THE AIRPORT THEY SHALL BE PROPERLY MARKED WITH THREE (3') FOOT SQUARE CHECKERED FLAGS (INTERNATIONAL ORANGE AND WHITE). THE CONTRACTOR WILL ALSO PROVIDE WORKERS WITH SOME TYPE OF TAG OR GARMENT TO IDENTIFY THE PERSON AS BEING PART OF THE CONSTRUCTION CREW.

1. CONTRACTOR SHALL BE RESPONSIBLE FOR CONSTRUCTION SIGNAGE AND MAINTENANCE OF TRAFFIC ON AIRPORT ROAD DURING CONSTRUCTION IN ACCORDANCE WITH MUTCD AND/OR LOCAL REQUIREMENTS. DURING WORK HOURS, MAINTAIN A MINIMUM OF ONE LANE OPEN TO TRAFFIC ON AIRPORT RD. DURING NON-WORK HOURS, AIRPORT ROAD SHALL REMAIN UNOBSTRUCTED.
2. ALL CONSTRUCTION/OPERATIONS ARE TO BE PERFORMED IN ACCORDANCE WITH FAA ADVISORY CIRCULAR (AC) 150/5370-10 "OPERATIONAL SAFETY ON AIRPORTS DURING CONSTRUCTION" AND AC 150/5300-13 "AIRPORT DESIGN".
3. ALL CONSTRUCTION EQUIPMENT ON THE AIRPORT SHALL BE MARKED, LIGHTED AND/OR FLAGGED IN ACCORDANCE WITH AC 150/5210-20 AND 70/7460-1.
4. THE MAXIMUM ANTICIPATED HEIGHT OF THE CONSTRUCTION EQUIPMENT WILL BE 25 FEET. THE TALLEST EQUIPMENT IS EXPECTED TO BE A SEMI-TRUCK AND TRAILER.

1. PRIOR TO ISSUANCE OF A CONSTRUCTION NOTICE-TO-PROCEED (NTP), THE CONTRACTOR SHALL BE RESPONSIBLE FOR PREPARING AND SUBMITTING A SAFETY PLAN COMPLIANCE DOCUMENT IN ACCORDANCE WITH FAA ADVISORY CIRCULAR 150/5370-2G, PARAGRAPH 2.4.2, OR EQUIVALENT SECTION IN SUBSEQUENT/CURRENT ISSUE. THE AIRPORT DIRECTOR/MANAGER SHALL APPROVE THIS DOCUMENT AND SUBMIT TO THE AIRPORT FOR APPROVAL PRIOR TO THE NTP ISSUANCE.

IDA NO: DEC-5251
SBG NO: 3-17-0033-TBD

NO.	DATE	DESCRIPTION		
		DES	DWN	REV

SHEET TITLE

CONSTRUCTION
SAFETY AND
PHASING PLAN
SHEET 1

100% SUBMITTAL

100% SUBMITTAL

1. THE CONTRACTOR SHALL PROVIDE A SCHEDULE AT THE PRECONSTRUCTION MEETING DETAILING THE ANTICIPATED HANGAR/TAXIWAY CLOSURE DATES AND DURATIONS.
2. THE HAUL ROUTE, VEHICLE PARKING, AND MATERIAL STORAGE AREAS CONSIST PAVED & TURF AREAS. THE CONTRACTOR WILL MAINTAIN THE HAUL ROUTES. AT THE COMPLETION OF THE PROJECT DISTURBED TURF AREAS WILL BE RESHAPED AND RESTORED, PAVEMENTS CLEANED AND, IF DAMAGED, RE-MARKED, AND ALL OTHER AREAS RESTORED TO PRE-CONSTRUCTION CONDITION.
3. THE CONTRACTOR SHALL HAVE THE SAFETY PLAN COMPLIANCE DOCUMENT (SPCD), AS DETAILED IN THE SPECIAL PROVISIONS, SUBMITTED AND APPROVED PRIOR TO BEING ISSUED THE "NOTICE TO PROCEED."
4. AIRPORT SECURITY WILL BE MAINTAINED AT ALL TIMES. ONLY CONTRACTOR EMPLOYEES SHALL BE ALLOWED WITHIN THE PROJECT LIMITS. GATES SHALL BE CLOSED AT ALL TIMES UNLESS THE CONTRACTOR IS IN A CONTINUOUS HAULING OPERATIONS, DURING WHICH TIME HE WILL PROVIDE A PERSON TO MONITOR THE GATE AREA.
5. RADIO CONTROL- THE DECATUR AIRPORT IS TOWER CONTROLLED FROM 6 A.M. TO 10 P.M. THE CONTRACTOR WILL BE REQUIRED TO BE IN TWO-WAY RADIO CONTACT WITH THE AIRPORT CONTROL TOWER - GROUND FREQUENCY (121.75 MHZ) WHEN THERE ARE EQUIPMENT AND/OR PERSONNEL ON ANY ACTIVE AIRFIELD PAVEMENTS.



1. ALL CONSTRUCTION SIGNS AND TRAFFIC CONTROL DEVICES SHALL CONFORM TO THE MANUAL ON UNIFORM TRAFFIC CONTROL DEVICES INCLUDING THE ILLINOIS SUPPLEMENT (LATEST EDITION) AND THE FAA ADVISORY CIRCULARS (LATEST EDITION) UNLESS NOTED OTHERWISE. THE FAA OR MORE STRINGENT SPECIFICATIONS SHALL GOVERN.
2. BARRICADES SHALL BE SPACED END TO END THE WIDTH OF THE PAVEMENT WITH A MAXIMUM SPACING OF 4' BETWEEN ENDS. BARRICADES ARE TO BE SET BACK 250' FROM THE ACTIVE RUNWAY CENTERLINE, 85.5' FROM THE ACTIVE TAXIWAY CENTERLINE OR AS SHOWN ON THE PLANS.
3. CONSTRUCTION RED WARNING LIGHT: THESE ARE PORTABLE, LENS DIRECTED, ENCLOSED LIGHTS. THE COLOR OF THE LIGHT EMITTED SHALL BE RED. THEY MAY BE USED IN EITHER A STEADY BURN (TYPE C) OR LOW INTENSITY FLASHING MODE (TYPE A) UNLESS NOTED OTHERWISE.
4. THE LIGHTING SHALL BE MAINTAINED IN OPERATION DURING THE HOURS OF DARKNESS BETWEEN 1/2 HOUR AFTER SUNSET AND 1/2 HOUR BEFORE SUNRISE AND WHEN CONDITIONS EXIST WHICH TEND TO OBSCURE VISION.
5. BARRICADES SHALL BE SECURED TO THE GROUND BY APPROVED METHODS TO PREVENT MOVEMENT BY PROP WASH, JET BLAST OR OTHER WIND CURRENTS.
6. THE ONLY COLOR COMBINATION ON BARRICADES IS ORANGE AND WHITE. THE ORANGE STRIPES SHALL BE ENCAPSULATED LENS REFLECTIVE SHEETING. THE WHITE STRIPES SHALL BE EITHER ENCAPSULATED OR ENCLOSED LENS REFLECTIVE SHEETING AND MUST BE IN ACCEPTABLE CONDITION.
7. THE COST OF SUPPLYING, PLACING, RELOCATING, & REMOVING BARRICADES SHALL BE INCIDENTAL TO THE CONTRACT.

3. THE CONTRACTORS SHALL MINIMIZE DISRUPTION OF STANDARD OPERATING PROCEDURES FOR AERONAUTICAL ACTIVITY BY REMAINING WITHIN THE PRESCRIBED STAGING, CONSTRUCTION, AND PHASING AREAS PRESENTED ON THE CONSTRUCTION SAFETY AND PHASING PLAN SHEETS.
4. NO UNAUTHORIZED PERSONNEL SHALL ENTER ANY AREA OF THE AIRPORT THAT COULD POTENTIALLY BE HAZARDOUS. THE AIRPORT MANAGER RESERVES THE RIGHT TO SUSPEND OPERATIONS IN ORDER TO MAINTAIN SAFETY AT THE AIRPORT.
5. PRIOR TO ACCESSING THE AIRFIELD, ANY DESIGNATED CONTRACTOR OR SUBCONTRACTOR EMPLOYEES WHO WILL BE OPERATING OR ESCORTING A VEHICLE ON AN ACTIVE AREA OF THE AIRFIELD MUST ATTEND A 1 HOUR AIRFIELD SAFETY TRAINING AND ORIENTATION PROVIDED BY THE AIRPORT. PRIOR TO THE TRAINING, THE EMPLOYEES MUST BE FAMILIAR WITH THE "FAA GUIDE TO GROUND VEHICLE OPERATIONS", AND KEEP A HARD COPY IN THE VEHICLE FOR REFERENCE. THE GUIDE CAN BE FOUND AT:
https://www.faa.gov/airports/runway_safety/media/Ground_Vehicle_Guide_Proof_Final.pdf
6. CONTRACTOR EQUIPMENT, VEHICLES, AND PROJECT MATERIALS SHALL BE STORED AT THE STAGING AREA SHOWN ON THE PLAN VIEW, EXCEPT AS OTHERWISE PROVIDED FOR AT THE PRE-CONSTRUCTION CONFERENCE.
7. ALL CONSTRUCTION EQUIPMENT OPERATING IN THE PRESCRIBED CONSTRUCTION AREA IS REQUIRED TO DISPLAY A CHECKERBOARD FLAG PROPERLY LOCATED OR A ROTATING BEACON (STROBE) AS SPECIFIED IN AC 150/5210-5, "PAINTING, MARKING, AND LIGHTING OF VEHICLES USED ON AN AIRPORT" (CURRENT EDITION).
8. NO CONSTRUCTION MATERIAL STOCKPILES SHALL BE LOCATED WITHIN 500' OF ANY ACTIVE RUNWAY CENTERLINE, WITHIN 129.5' OF ANY OTHER ACTIVE AIRPORT OPERATIONS AREA (EX. TAXIWAY), OR PENETRATE A PART 77 IMAGINARY SURFACE (PROVIDED BY THE RESIDENT ENGINEER/TECHNICIAN) EXTENDING OUT AND UPWARDS FROM ALL SIDES OF AN ACTIVE RUNWAY.
9. CLOSED AIRFIELD PHASING AREAS, OPEN TRENCHES, AND STOCKPILED MATERIALS AT THE CONSTRUCTION SITE SHALL BE PROMINENTLY MARKED WITH LIGHTED BARRICADES WITH STEADY BURNING OR FLASHING RED LIGHTS AS SPECIFIED IN 150/5370-2, "OPERATIONAL SAFETY ON AIRPORT DURING CONSTRUCTION, LATEST EDITION. LIGHTED BARRICADES MUST BE NO TALLER THAN 18" (EXCLUSIVE OF SUPPLEMENTARY LIGHTS AND FLAGS) ON THE TAXIWAYS AND COMPLY WITH ADVISORY CIRCULAR 150/5370-2, LATEST EDITION. CONTRACTOR SHALL NIGHT CHECK BARRICADES DAILY FOR PROPER OPERATION.
10. NO OPEN TRENCHES WITHIN 250' OF AN ACTIVE RUNWAY CENTERLINE OR WITHIN 129.5' OF ANY TAXIWAY CENTERLINE WILL BE PERMITTED. OTHER TRENCHES SHALL BE MAINTAINED SAFE, I.E., MARKED, BARRICADED OR COVERED WITH STEEL PLATES IN ALL OTHER AREAS.
11. NO CONSTRUCTION EQUIPMENT GREATER THAN 25' TALL WILL BE PERMITTED ON THE AIRPORT, WITH THE EXCEPTION OF CRANES WITHIN THE DESIGNATED AREA SHOWN ON THE SAFETY PLAN, UNLESS PERMITTED WITH THE APPROVAL OF THE AIRPORT MANAGER AND ADDITIONAL AIRSPACE APPROVAL BY THE FAA.
12. NO OPEN FLAME WELDING OR TORCH CUTTING OPERATION IS PERMITTED UNLESS ADEQUATE FIRE AND SAFETY PRECAUTIONS ARE PROVIDED AND HAVE BEEN APPROVED BY THE AIRPORT MANAGER NO FLARE POTS ARE ALLOWED ON THE PROJECT.
13. SOIL, DEBRIS, AND LOOSE MATERIAL DROPPED OR TRUCKED ONTO AIRPORT ROADS, TAXIWAYS, AND SOD SURFACES, OR WHICH CAN BE BLOWN ONTO SUCH SURFACES, SHALL BE IMMEDIATELY SWEEPED, PICKED UP AND REMOVED, OR PLACED INTO CLOSED CONTAINERS. ANY DAMAGE TO AIRPORT PROPERTY SHALL BE REPAIRED IMMEDIATELY AT NO COST TO THE OWNER.
14. EACH CONTRACTOR SHALL BE RESPONSIBLE FOR LOCATING AND MAINTAINING AIRPORT LIGHTING AND NAVIGATIONAL ELECTRICAL SYSTEMS DURING CONSTRUCTION. A CONTACT PERSON AND TELEPHONE NUMBER FOR 24 HOUR EMERGENCY IMMEDIATE REPAIR SHALL BE SUBMITTED TO THE AIRPORT MANAGER AND RESIDENT ENGINEER/TECHNICIAN. HAUL ROUTES CROSSING PAVEMENT, DRAINAGE, MISCELLANEOUS. STRUCTURES AND/OR AIRFIELD CABLES SHALL BE PROTECTED FROM DAMAGE.
15. ALL AIRCRAFT AND AIRPORT OPERATIONS HAVE THE RIGHT-OF-WAY. CONTRACTOR TO YIELD TO VEHICLES AND REMAIN CLEAR AT ALL TIMES.
16. CONTRACTOR SHALL PLACE, SECURE, AND MAINTAIN LIGHTED BARRICADES AND CLOSURE CROSSES WHEN A RUNWAY/TAXIWAY/APRON IS CLOSED OR AS REQUIRED BY THE PLANS AND DESIGNATED BY THE RESIDENT ENGINEER/TECHNICIAN.
17. CONTRACTOR SHALL MARK HAZARDOUS AREAS WITH STEADY-BURNING OR FLASHING RED LIGHTS DURING PERIODS OF LOW VISIBILITY AS REQUIRED.
18. THE CONTRACTOR SHALL PERIODICALLY PERFORM ONSITE INSPECTIONS THROUGHOUT THE DURATION OF THE PROJECT WITH THE IMMEDIATE REMEDY OF ANY DIFFERENCES, WHETHER CAUSED BY NEGLIGENCE, OVERSIGHT, OR PROJECT SCOPE CHANGE.
19. THE CONTRACTOR WILL BE RESPONSIBLE FOR IMPLEMENTING MEASURES TO CONTROL OR AVOID CREATING ATTRACTANTS TO WILDLIFE. MEASURES MAY INCLUDE CONTINUOUSLY REMOVING ANY WASTE OR LOOSE MATERIALS, PLACEMENT OF MATERIALS IN APPROPRIATE STORAGE CONTAINERS, PROPERLY MAINTAINING FENCES AND GATES TO PREVENT ACCESS, AND PREVENTING PONDING OF WATER THROUGHOUT THE SITE.
20. CONTRACTOR SHALL MOVE MAINTENANCE OF TRAFFIC COMPONENTS AT THE WRITTEN DIRECTION OF THE RESIDENT ENGINEER/TECHNICIAN AT NO ADDITIONAL COST.
21. CONTRACTOR SHALL NOT REMOVE THE BARRICADES WITHOUT THE APPROVAL BY THE RESIDENT ENGINEER/TECHNICIAN.
22. CONTRACTOR SHALL MAINTAIN FLASHERS, SIGNS AND/OR BARRICADES AS REQUIRED BY THE PLANS, CITY OR COUNTY REGULATIONS OR CONTRACTOR ACTIVITIES. CONTRACTOR SHALL OBTAIN ANY AND ALL REQUIRED LOCAL PERMITS UNLESS SPECIFIED OTHERWISE.
23. THE CONTRACTOR SHALL UTILIZE WATER AND/OR CHEMICALS APPROVED BY THE RESIDENT ENGINEER/TECHNICIAN AS NECESSARY TO CONTROL DUST.
24. NO CONSTRUCTION VEHICLES SHALL BE DRIVEN ACROSS ANY ACTIVE AIRFIELD PAVEMENT AREA WITHOUT AN APPROPRIATE ESCORT. CONSTRUCTION EQUIPMENT OR CONSTRUCTION ACTIVITY WILL NOT BE PERMITTED WITHIN 250' OF ANY ACTIVE RUNWAY CENTERLINE OR WITHIN 129.5' OF ANY OTHER ACTIVE AIRPORT TAXIWAY OR APRON.



RECONSTRUCT SOUTH T-HANGAR PAVEMENTS

DA NO: DEC-5251
SBG NO: 3-17-0033-TBD

ISSUE: NOVEMBER 14, 2025

SHEET TITLE

CONSTRUCTION SAFETY AND PHASING PLAN NOTES

100% SUBMITTAL

I:\24\JOBS\24A0077_00\CAD\AIRPORT\120-ALIGN.DWG
NOV 24, 2025 5:08 PM CRAF02387

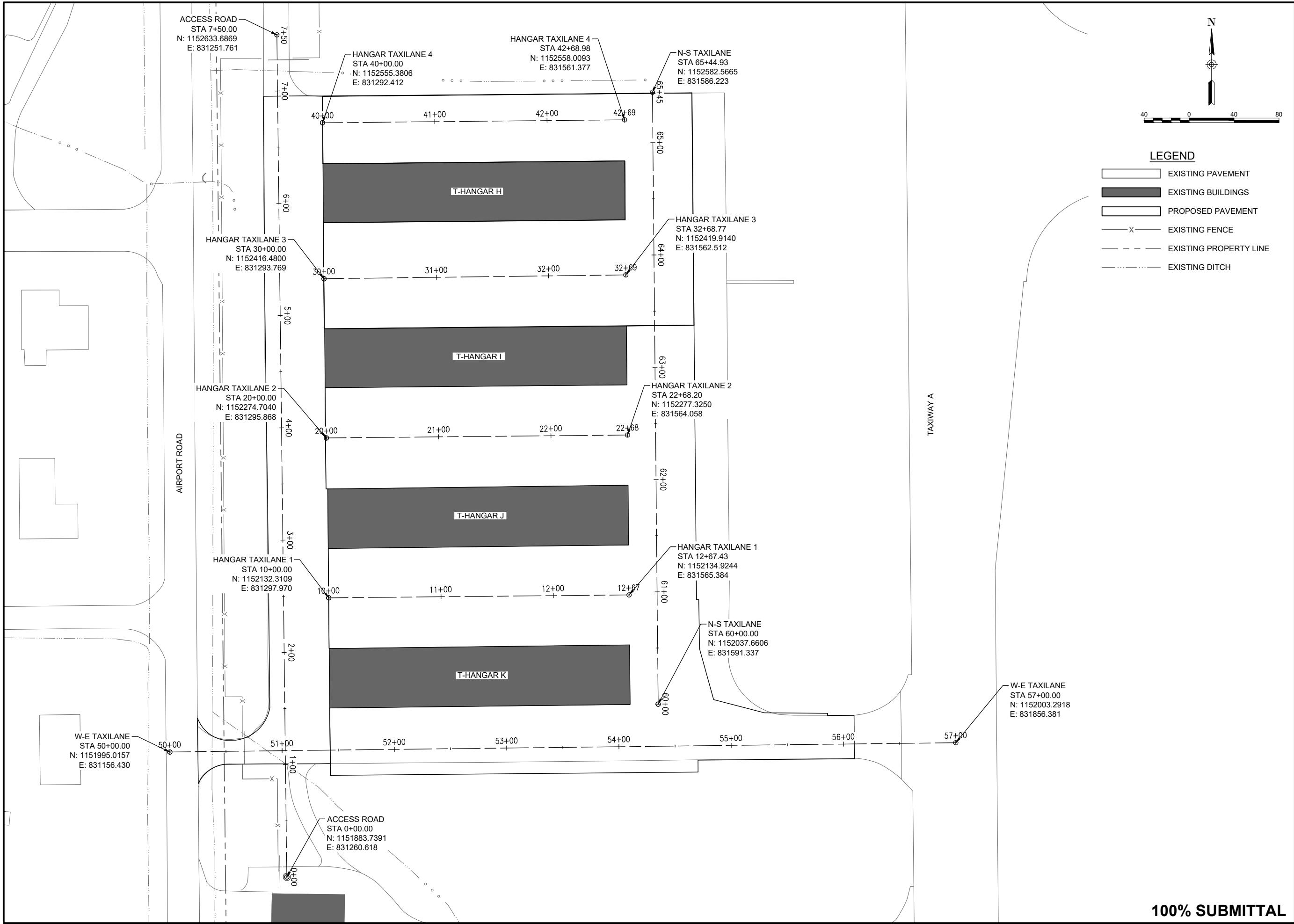

Offices Nationwide
www.hanson-inc.com

Hanson Professional Services Inc.
1525 S. 6th Street
Springfield, IL 62703
phone: 217-788-2450
fax: 217-788-2503

Illinois Licensed
Professional Service Corporation
#184-001084



Decatur Park District
Decatur Airport
910 South Airport Road
Decatur, IL 62521

DATE: XX/XX/2025 LICENSE
SIGNED: 11/30/2027 EXPIRES: 11/30/2027

RECONSTRUCT SOUTH T-HANGAR PAVEMENTS

IDA NO: DEC-5251
SBG NO: 3-17-0033-TBD

NO.	DATE	DESCRIPTION		
		DES	DWN	REV

ISSUE: NOVEMBER 14, 2025

PROJECT NO: 24A0077

CAD FILE: C-120-ALIGN.DWG

DESIGN BY: AJC 10/06/2025

DRAWN BY: AJC 10/16/2025

REVIEWED BY: LDH 11/13/2025

SHEET TITLE

ALIGNMENT PLAN



RECONSTRUCT SOUTH T-HANGAR PAVEMENTS

IDA NO: DEC-5251
SBG NO: 3-17-0033-TBD

NO.	DATE	DESCRIPTION		
		DES	DWN	REV

ISSUE: NOVEMBER 14, 2025
PROJECT NO: 24A0077
CAD FILE: C-122-DEM.DWG
DESIGN BY: AJC 10/16/2025
DRAWN BY: AJC 10/16/2025
REVIEWED BY: LDH 11/13/2025

SHEET TITLE

DEMOLITION PLAN

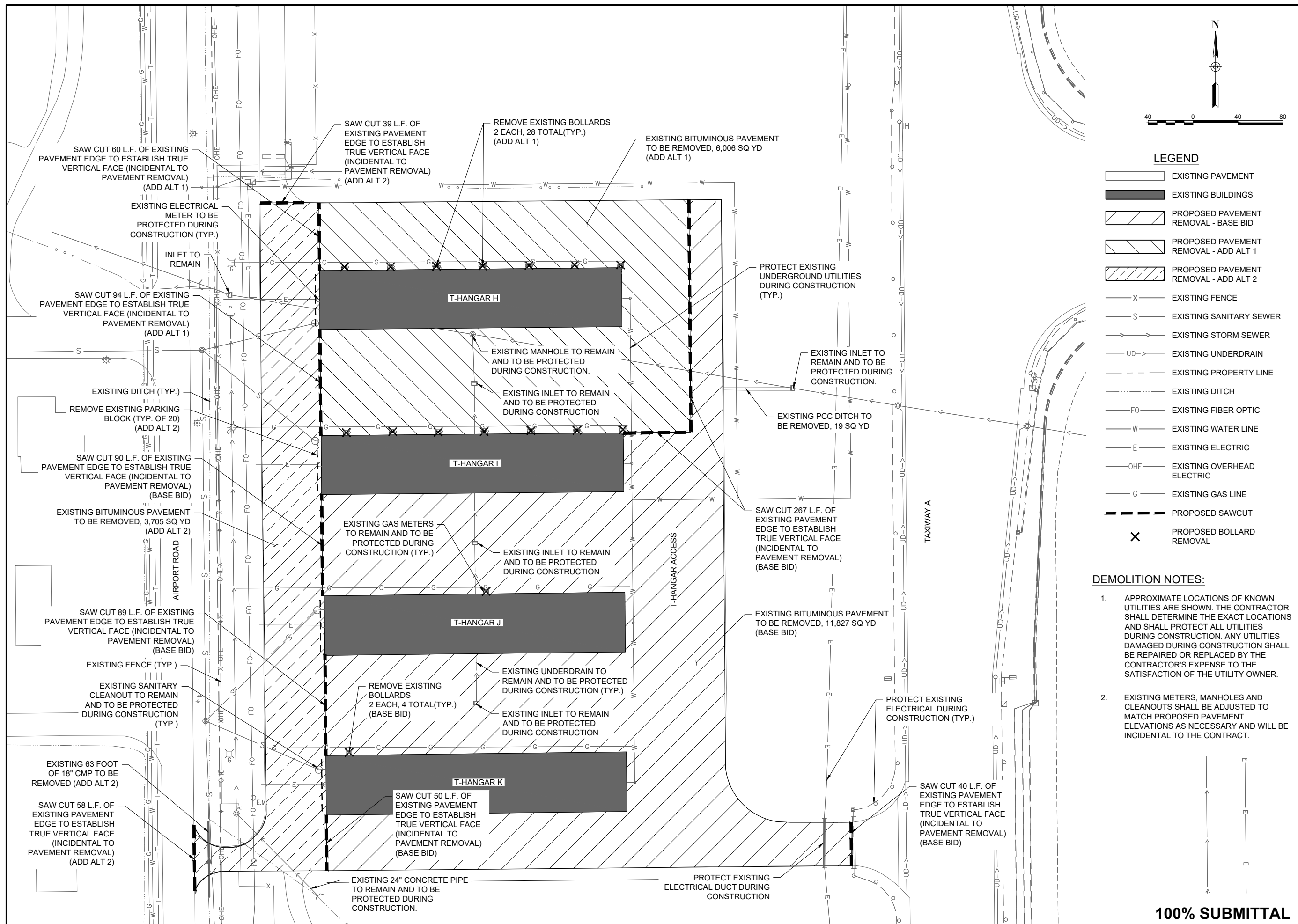

I:\24JOBS\24A0077_00\CAD\AIRPORT\1SHEET\C-122-DEM.DWG
NOV 24, 2025 5:07 PM CRAFT02387

1:24 (BS) 24A0077_00 CAD AIRPORT SHEET C-121-CON.DWG
NOV 24, 2025 5:06 PM CRAFT02387

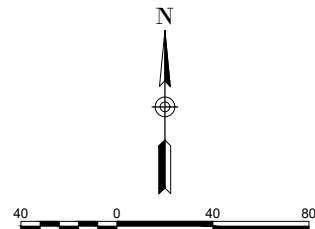
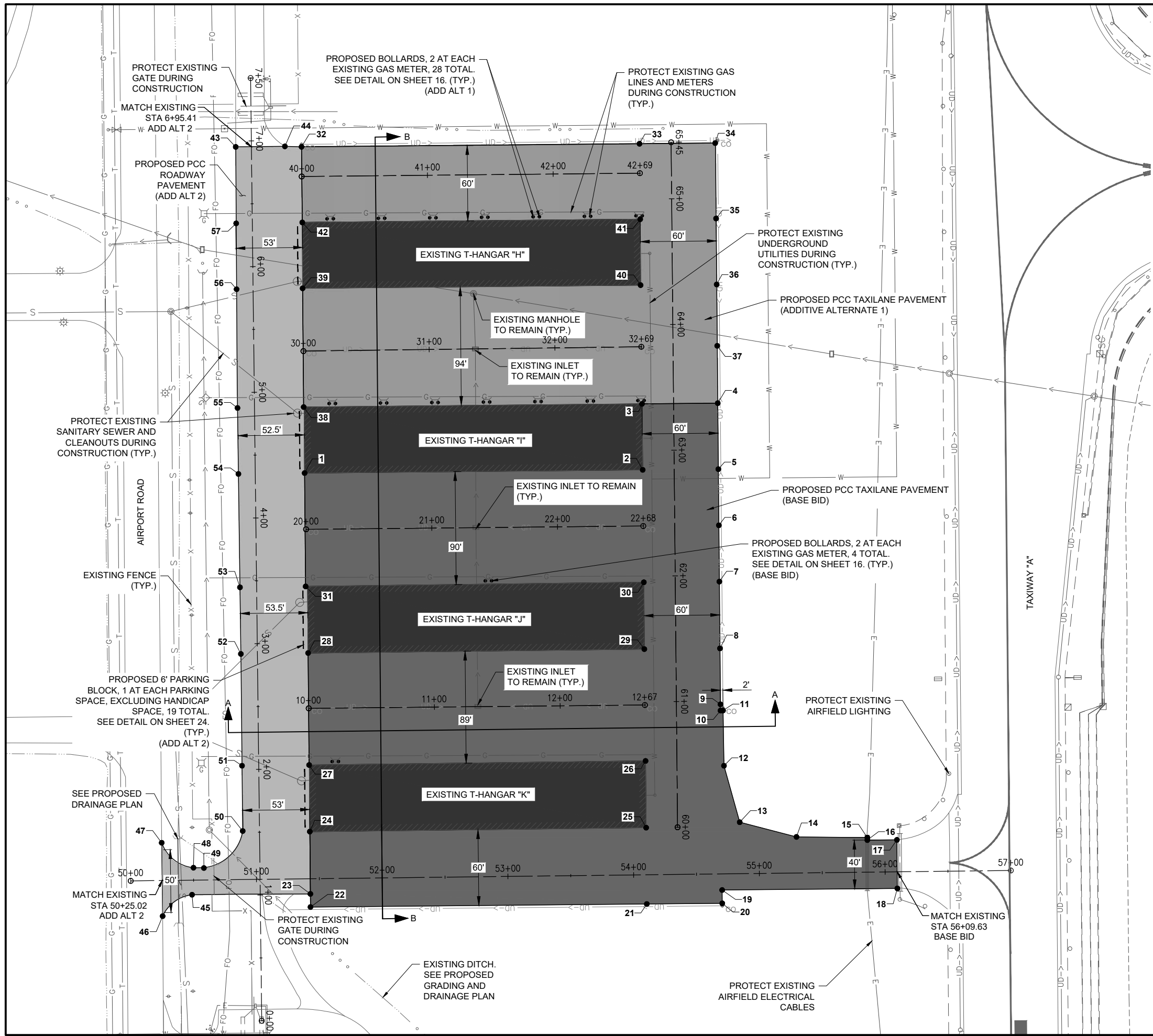

LEGEND

- EXISTING PAVEMENT
- EXISTING BUILDINGS
- PROPOSED PAVEMENT - BASE BID
- PROPOSED PAVEMENT - ADD ALT 1
- PROPOSED PAVEMENT - ADD ALT 2
- PROPOSED BOLLARD
- EXISTING FENCE
- EXISTING SANITARY SEWER
- EXISTING STORM SEWER
- PROPOSED UNDERDRAIN
- EXISTING PROPERTY LINE
- EXISTING DITCH

CONSTRUCTION NOTES:

- APPROXIMATE LOCATIONS OF KNOWN UTILITIES ARE SHOWN. THE CONTRACTOR SHALL DETERMINE THE EXACT LOCATIONS AND SHALL PROTECT ALL UTILITIES DURING CONSTRUCTION. ANY UTILITIES DAMAGED DURING CONSTRUCTION SHALL BE REPAIRED OR REPLACED BY THE CONTRACTOR'S EXPENSE TO THE SATISFACTION OF THE UTILITY OWNER.
- THE PROPOSED PAVEMENT SHALL MATCH FLUSH WITH THE EXISTING PAVEMENT AND DRAIN WITHOUT CREATING PONDS. THE CONTRACTOR SHALL VERIFY EXISTING ELEVATIONS AT "MATCH" LOCATIONS PRIOR TO CONSTRUCTION. ANY DISCREPANCIES SHALL BE BROUGHT TO THE ATTENTION OF THE RESIDENT ENGINEER/TECHNICIAN IMMEDIATELY TO DETERMINE IF ADJUSTMENTS ARE NECESSARY TO PROPOSED GRADES.
- EXISTING METERS, MANHOLES, AND CLEANOUTS SHALL BE ADJUSTED TO MATCH PROPOSED PAVEMENT ELEVATIONS AS NECESSARY AND WILL BE INCIDENTAL TO THE CONTRACT.



Offices Nationwide
www.hanson-inc.com

Hanson Professional Services Inc.
1525 S. 6th Street
Springfield, IL 62703
phone: 217-788-2450
fax: 217-788-2503

Illinois Licensed
Professional Service Corporation
#184-001084



Decatur Park District
Decatur Airport
910 South Airport Road
Decatur, IL 62521

DATE: 11/30/2027
SIGNED: XX/XX/2025 EXPIRES: 11/30/2027

RECONSTRUCT SOUTH T-HANGAR PAVEMENTS

IDA NO: DEC-5251
SBG NO: 3-17-0033-TBD

NO.	DATE	DESCRIPTION		
		DES	DWN	REV

ISSUE: NOVEMBER 14, 2025

PROJECT NO: 24A0077
CAD FILE: C-121-CON.DWG
DESIGN BY: AJC 10/16/2025
DRAWN BY: AJC 10/16/2025
REVIEWED BY: LDH 11/13/2025

SHEET TITLE

PROPOSED CONSTRUCTION PLAN

100% SUBMITTAL

CONSTRUCTION POINTS				
POINT #	NORTHING	EASTING	PROPOSED ELEVATION	DESCRIPTION
41	1152521.4098	831561.6077	672.50	EXISTING HANGAR
42	1152518.8238	831292.8547	672.48	EXISTING HANGAR
43	1152578.9200	831239.9203	671.85	MATCH EXISTING
44	1152579.3300	831279.0300	672.13	MATCH EXISTING
45	1151984.0100	831205.2000	672.80	EDGE OF PAVEMENT
46	1151966.9864	831181.8082	673.45	MATCH EXISTING
47	1152025.3433	831181.0525	673.11	MATCH EXISTING
48	1152005.4700	831206.3000	672.77	EDGE OF PAVEMENT
49	1152005.2600	831214.6100	672.66	EDGE OF PAVEMENT
50	1152034.6800	831245.4600	671.98	EDGE OF PAVEMENT
51	1152086.6146	831244.9470	671.20	EDGE OF PAVEMENT
52	1152175.5453	831244.0305	671.15	EDGE OF PAVEMENT
53	1152228.5353	831243.3036	671.17	EDGE OF PAVEMENT
54	1152318.7330	831242.0663	671.54	EDGE OF PAVEMENT
55	1152371.2284	831241.3461	671.46	EDGE OF PAVEMENT
56	1152465.7067	831240.6176	671.96	EDGE OF PAVEMENT
57	1152518.1028	831240.2949	671.95	EDGE OF PAVEMENT

DA NO: DEC-5251
SBG NO: 3-17-0033-TBD

SHEET TITLE

PROPOSED CONSTRUCTION POINT TABLE



TYPICAL SECTION A-A
NOT TO SCALE



NO.	DATE	DESCRIPTION		
		DES	DWN	REV

ISSUE: NOVEMBER 14, 2025

PROJECT NO: 24A0077

CAD FILE: C-301-TYP.DWG

DESIGN BY: AJC 10/16/2025

DRAWN BY: AJC 10/16/2025

REVIEWED BY: LDH 11/13/2025

SHEET TITLE

TYPICAL SECTIONS

100% SUBMITTAL

I:\24JOBS\24A0077_00\CAD\AIRPORT\1\SHEET\C-301-TYP.DWG
NOV 24, 2025 5:07 PM CRAFT02387



RECONSTRUCT SOUTH
T-HANGAR PAVEMENTS

IDA NO: DEC-5251
SBG NO: 3-17-0033-TBD

NO.	DATE	DESCRIPTION		
		DES	DWN	REV

ISSUE: NOVEMBER 14, 2025

PROJECT NO: 24A0077
CAD FILE: C-701-PNP.DWG
DESIGN BY: AJC 10/16/2025
DRAWN BY: AJC 10/16/2025
REVIEWED BY: LDH 11/13/2025

SHEET TITLE

PLAN AND PROFILE -
SHEET 1

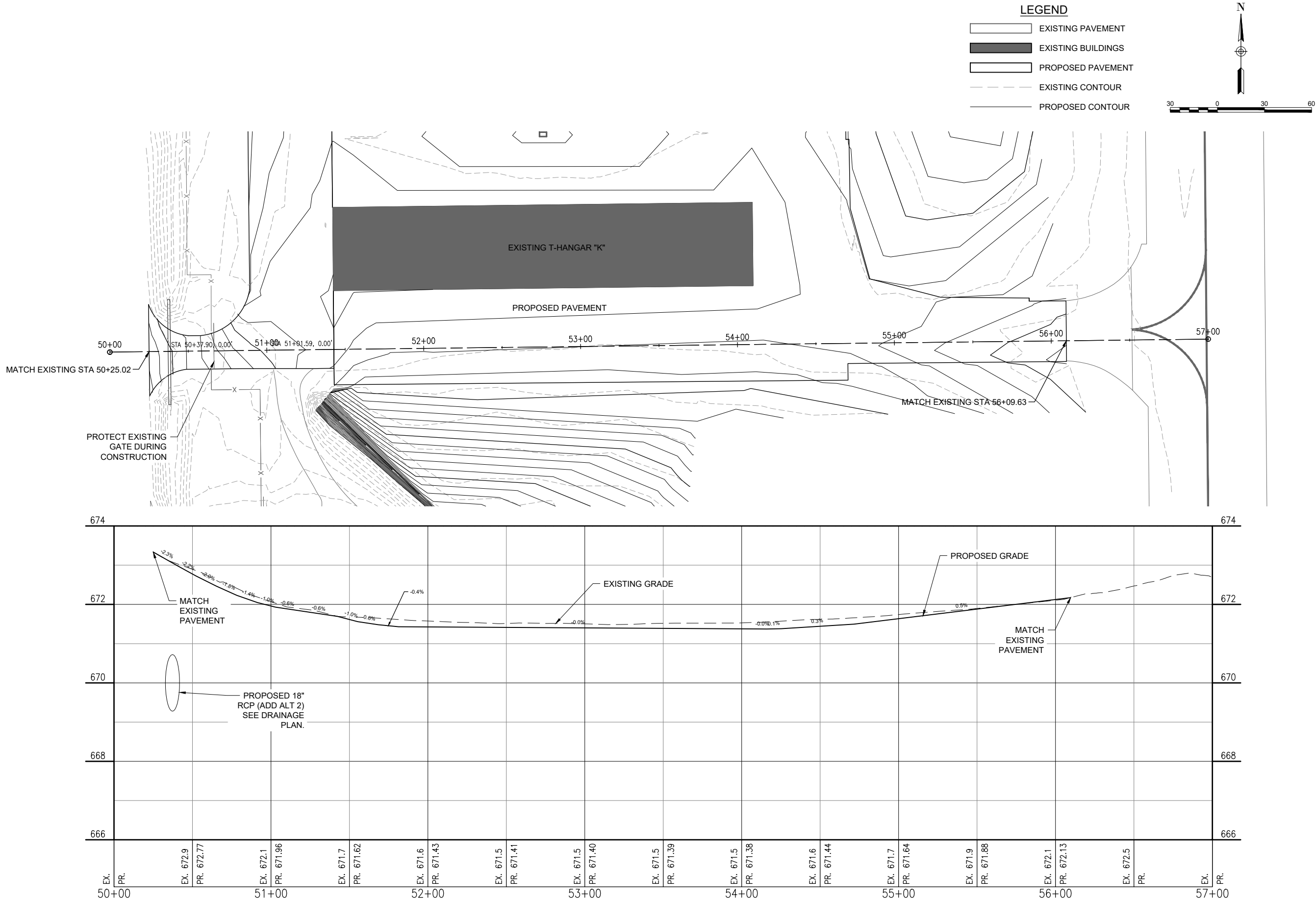

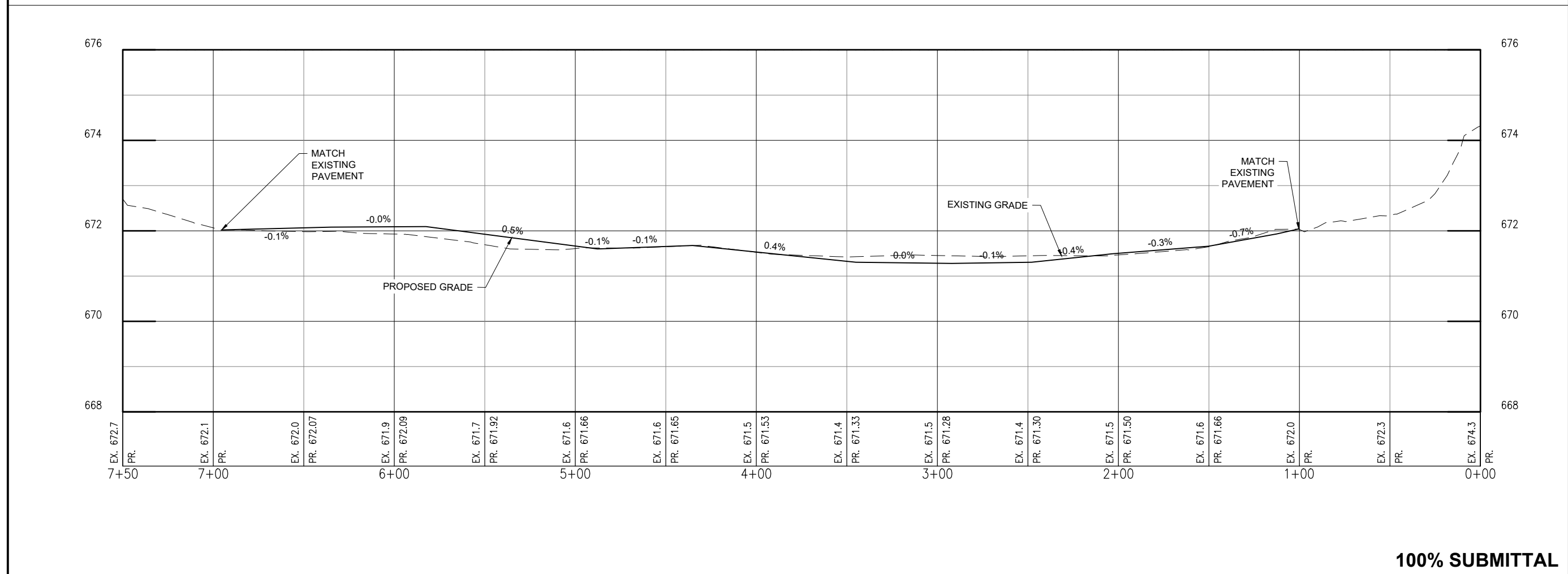

100% SUBMITTAL



Decatur Park District
Decatur Airport
910 South Airport Road
Decatur, IL 62521

DATE: XX/XX/2025 LICENSE: 11/30/2027
SIGNED: XX/XX/2025 EXPIRES: 11/30/2027

RECONSTRUCT SOUTH
T-HANGAR PAVEMENTS

IDA NO: DEC-5251
SBG NO: 3-17-0033-TBD

NO.	DATE	DESCRIPTION		
		DES	DWN	REV

ISSUE: NOVEMBER 14, 2025

PROJECT NO: 24A0077
CAD FILE: C-703-PNP.DWG
DESIGN BY: AJC 10/16/2025
DRAWN BY: AJC 10/16/2025
REVIEWED BY: LDH 11/13/2025

SHEET TITLE

PLAN AND PROFILE -
SHEET 3

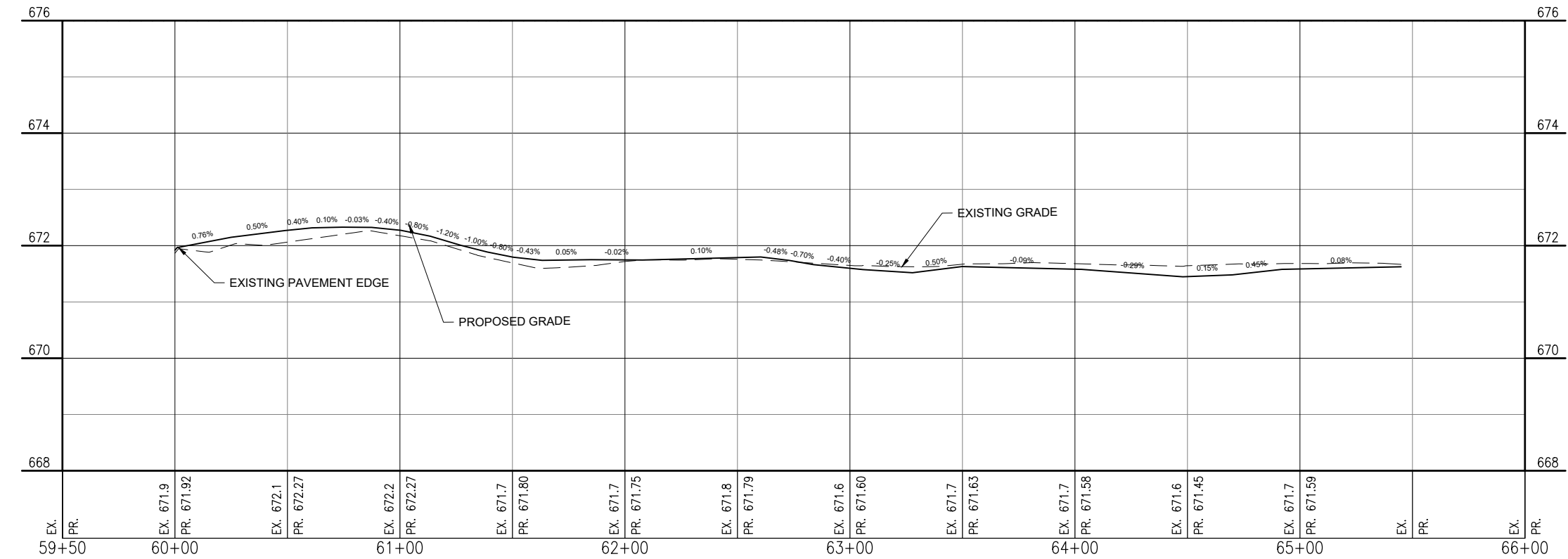
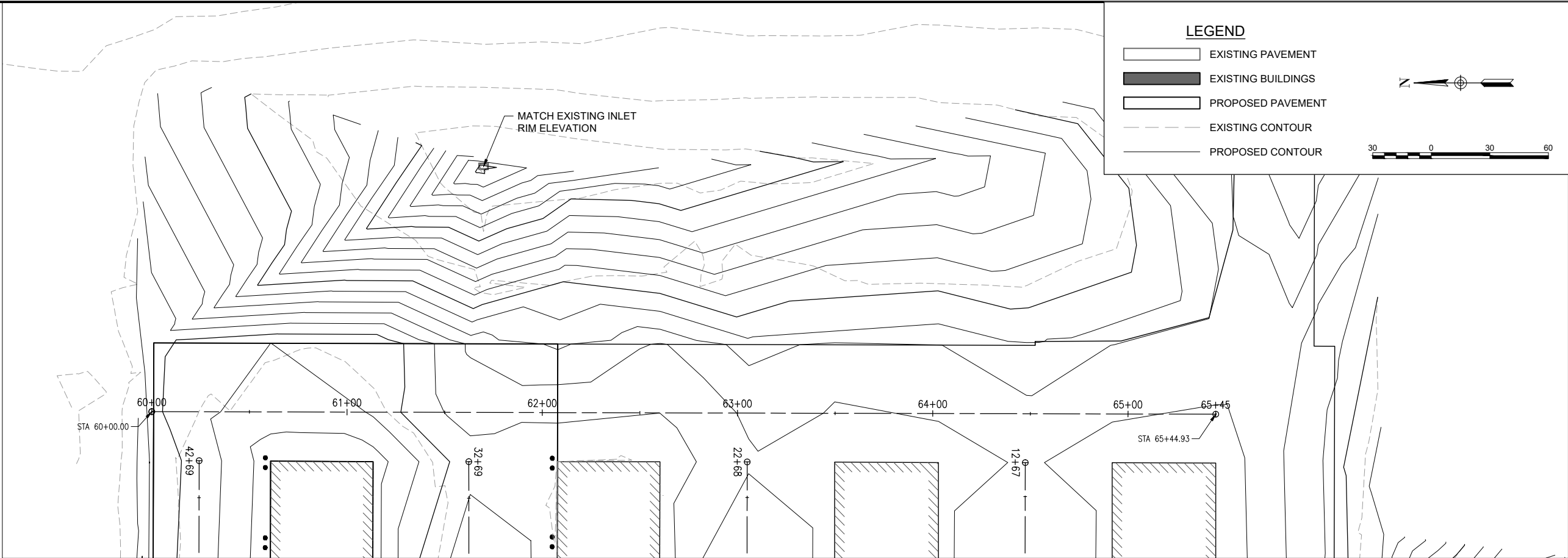

100% SUBMITTAL

SHEET TITLE

BOLLARD AND DRAINAGE DETAILS



1:\24\JOBS\24A0077_00\CAD\AIRPORT\181-GRD.DWG
NOV 24, 2025 5:09 PM CRAFT02387

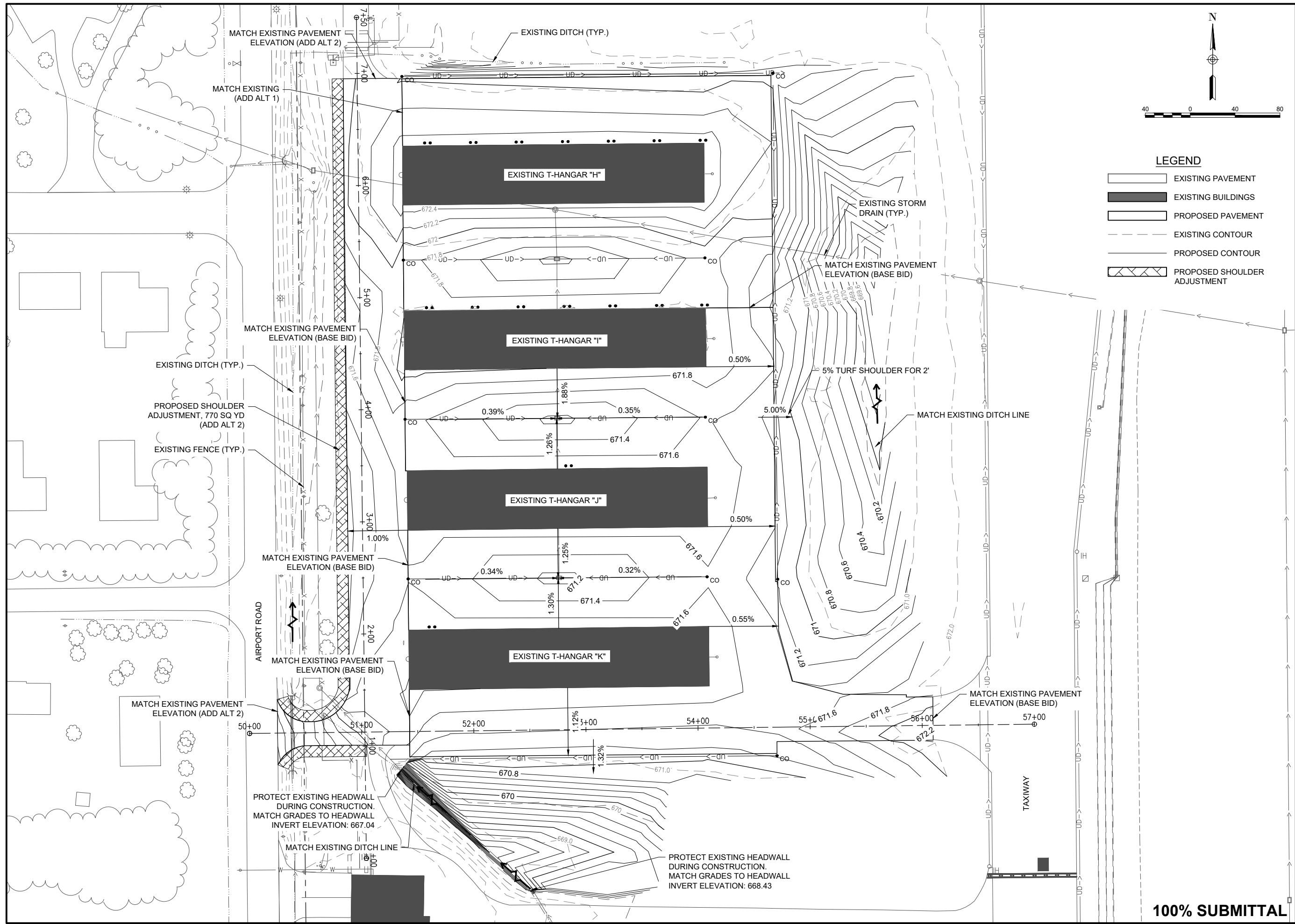

Offices Nationwide
www.hanson-inc.com

Hanson Professional Services Inc.
1525 S. 6th Street
Springfield, IL 62703
phone: 217-788-2450
fax: 217-788-2503

Illinois Licensed
Professional Service Corporation
#184-001084



Decatur Park District
Decatur Airport
910 South Airport Road
Decatur, IL 62521

DATE: XX/XX/2025 LICENSE: 11/30/2027
SIGNED: XX/XX/2025 EXPIRES: 11/30/2027

RECONSTRUCT SOUTH T-HANGAR PAVEMENTS

IDA NO: DEC-5251
SBG NO: 3-17-0033-TBD

NO.	DATE	DESCRIPTION		
		DES	DWN	REV

ISSUE: NOVEMBER 14, 2025

PROJECT NO: 24A0077

CAD FILE: C-181-GRD.DWG

DESIGN BY: AJC 10/16/2025

DRAWN BY: AJC 10/16/2025

REVIEWED BY: LDH 11/13/2025

SHEET TITLE

PROPOSED GRADING PLAN

100% SUBMITTAL

NO.	DATE	DESCRIPTION		
		DES	DWN	REV

SHEET TITLE

PROPOSED JOINTING PLAN

100% SUBMITTAL

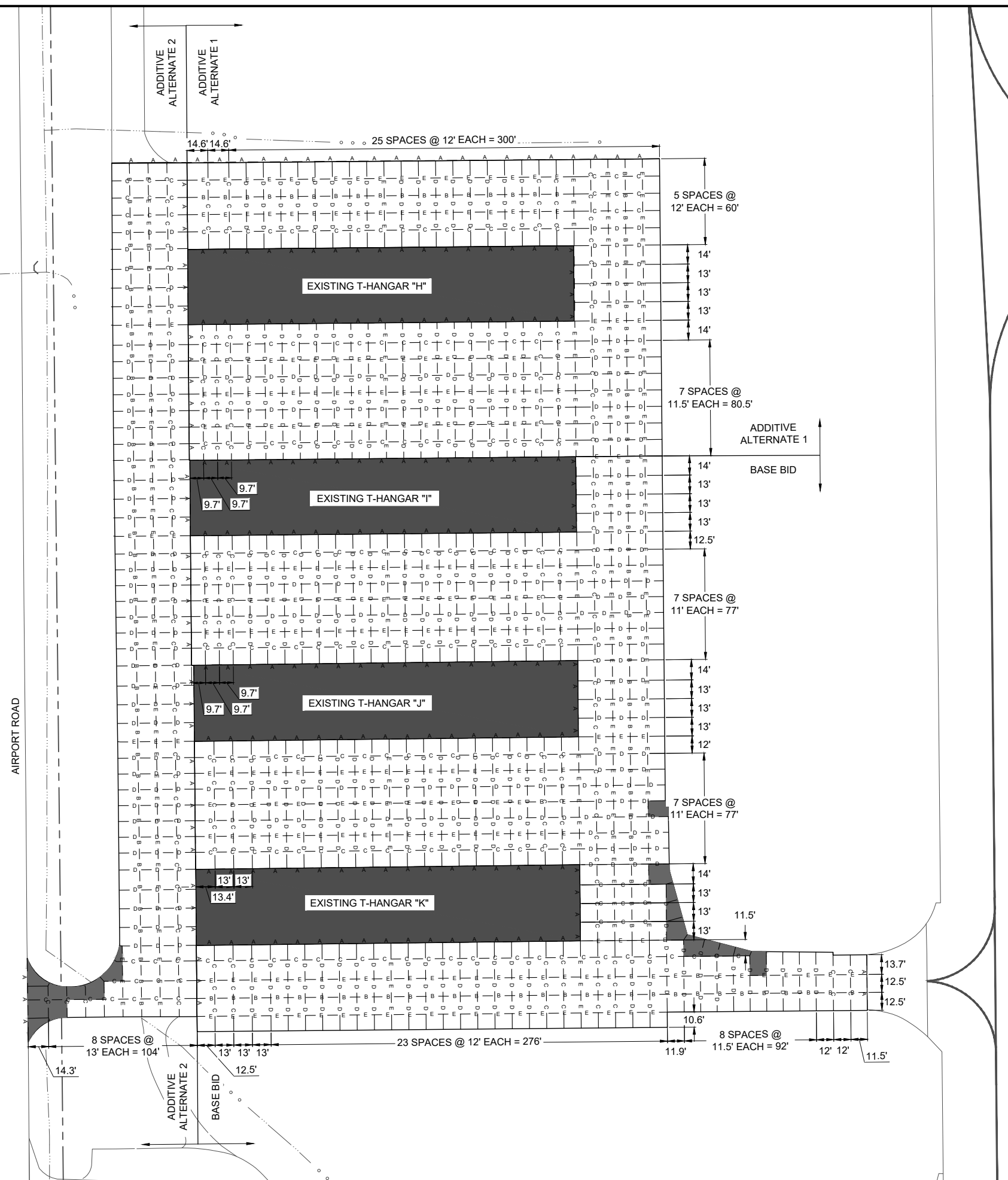

I:\24JOBS\24A0077_00\CAD\AIRPORT\SHEET\C-125-JNT.DWG
NOV 24, 2025 5:10 PM CRAFT02387



Decatur Park District
Decatur Airport
910 South Airport Road
Decatur, IL 62521

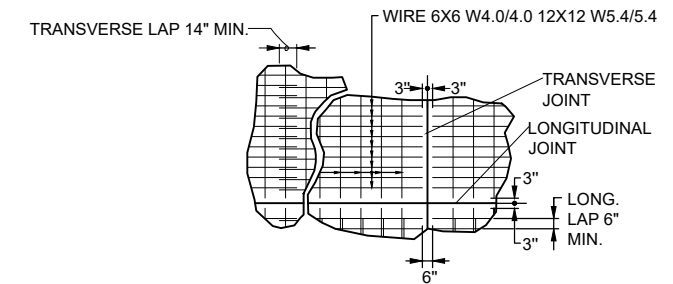
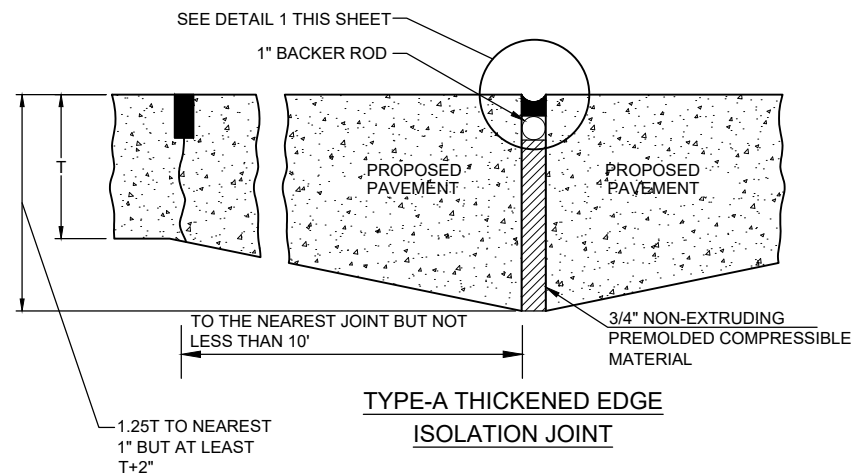
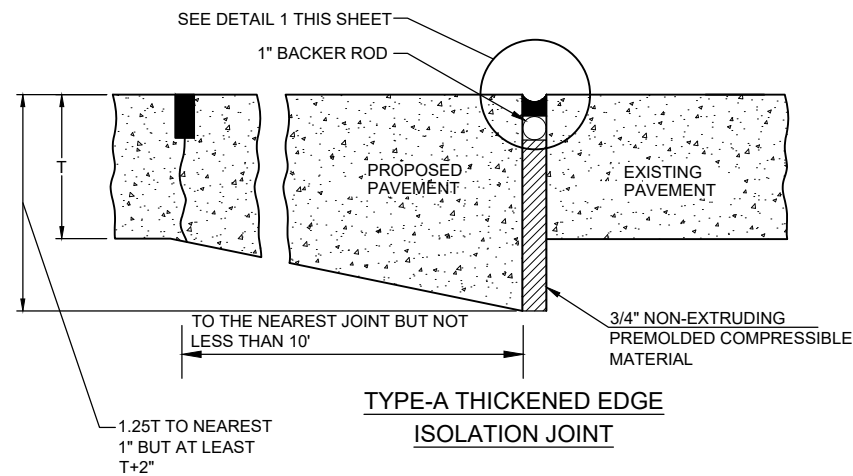

REINFORCEMENT SHEET WIRE FABRIC DETAIL

NOT TO SCALE

NOTE:
DIFFERENT WIRE MESH SIZES/CONFIGURATIONS ARE PERMITTED TO
PROVIDE A MINIMUM OF 0.05% OF THE PANEL CROSS-SECTIONAL AREA
IN BOTH DIRECTIONS.

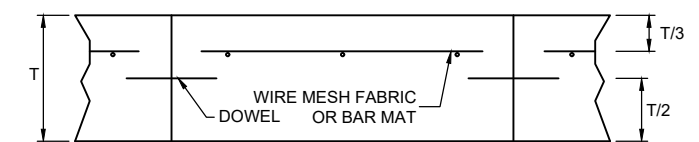

PAVEMENT REINFORCING DETAIL

NOT TO SCALE

REINFORCING NOTES:

1. END LAPS SHALL BE A MINIMUM OF 12", BUT NOT LESS THAN 30 TIMES THE DIAMETER OF THE LONGITUDINAL WIRE OR BAR.
2. SIDE LAPS SHALL BE A MINIMUM OF 6", BUT NOT LESS THAN 20 TIMES THE DIAMETER OF TRANSVERSE WIRE OR BAR.
3. END AND SIDE CLEARANCES SHALL BE A MAXIMUM OF 6" AND A MINIMUM OF 2".
4. LONGITUDINAL MEMBERS SHALL BE SPACED NOT LESS THAN 4" NOR MORE THAN 12" APART.
5. TRANSVERSE MEMBERS SHALL BE SPACED NOT LESS THAN 4" NOR MORE THAN 24" APART.
6. REINFORCING SHALL CONSIST OF WELDED STEEL WIRE FABRIC CONFORMING TO THE REQUIREMENTS OF ASTM A 185 OR BAR MATS CONFORMING TO THE REQUIREMENTS OF ASTM A 184 OR A 704.
7. PAVEMENT REINFORCING SHALL BE INCIDENTAL TO ITEM 501 PCC PAVEMENT.

JOINTING NOTES

1. ALL JOINT EDGES SHALL BE SAWCUT TO PRODUCE THE 1/4" CHAMFER.
2. ALL LONGITUDINAL AND TRANSVERSE CONTRACTION JOINTS SHALL BE SAWED.
3. ALL DOWEL BARS SHALL BE SECURELY HELD IN PLACE BY MEANS OF A DOWEL BAR ASSEMBLY WHICH WILL ENSURE THAT THEY WILL REMAIN PARALLEL TO THE SURFACE OF THE PAVEMENT AND TO THE CENTERLINES OF THE PAVEMENT LANES. THE DOWEL BAR ASSEMBLIES SHALL BE APPROVED BY THE RESIDENT ENGINEER/TECHNICIAN PRIOR TO INSTALLATION.
4. ALL TIE BARS SHALL BE HELD IN PLACE BY SUPPORT PINS OR OTHER METHODS TO PREVENT SHIFTING DURING AND AFTER CONCRETE PLACEMENT. SUPPORT PINS SHALL BE OF SUFFICIENT LENGTH TO PENETRATE AT LEAST 6" INTO THE SUBGRADE.
5. ALL TIE BARS SHALL BE PLACED AT A POINT NOT LESS THAN 6" OR MORE THAN 15" FROM A TRANSVERSE OR EXPANSION JOINT.
6. DOWELS IN TRANSVERSE CONTRACTION AND LONGITUDINAL CONSTRUCTION JOINTS SHALL BE COATED WITH A RUSTPROOFING COMPOUND AND HALF THE LENGTH GREASED WITH A HEAVY GREASE.
7. ALLOWABLE TOLERANCES FOR GROOVE DEPTH WILL BE $\pm 1/8"$ FOR CONSTRUCTION JOINTS AND $\pm 1/4"$ FOR CONTRACTION JOINTS.
8. THE CONTRACTOR IS REQUIRED TO DRILL AND EPOXY THE PROPOSED DOWELS IN ACCORDANCE WITH THE DETAILS AND SPECIFICATIONS. THE EPOXY MATERIAL MUST BE APPROVED BY THE DIVISION OF AERONAUTICS PRIOR TO USE.
9. THE COST OF ALL DOWEL BARS, TIE-BARS, SAWING AND SEALING SHALL BE INCLUDED IN THE COST OF THE PCC PAVEMENT.
10. WHEN CONSTRUCTING "FILL-IN" PAVEMENT LANES THE CONTRACTOR SHALL USE BELTING OR OTHER PROTECTIVE MATERIAL FOR THE PAVING MACHINE TO TRAVEL ON AND WILL PROTECT THE TRANSVERSE JOINTS.
11. JOINT SEALANT SHALL BE AS SPECIFIED IN THE STANDARD SPECIFICATIONS, ITEM 605.
12. CURING COMPOUND SHALL BE AS SPECIFIED IN THE STANDARD SPECIFICATIONS, ITEM 501-2.9, AND SHALL BE APPROVED PRIOR TO THE PAVING OPERATION BY THE RESIDENT ENGINEER/TECHNICIAN.
13. ALL NON-ALIGNED EDGES WILL BE SAWED FULL DEPTH.

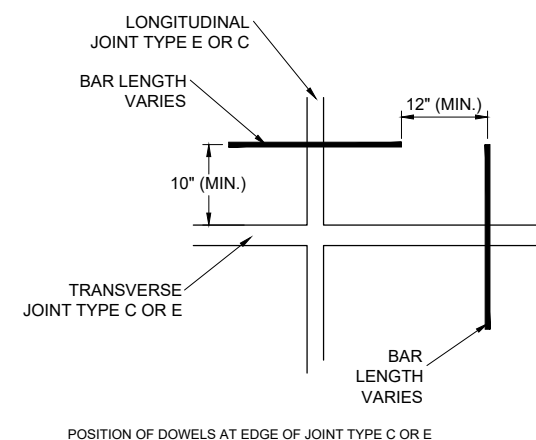
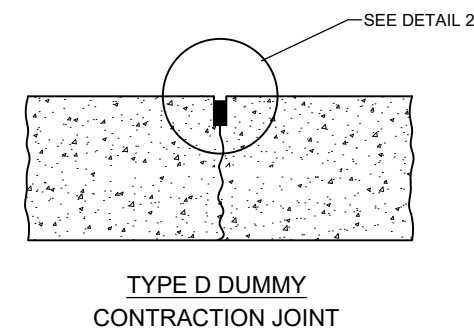
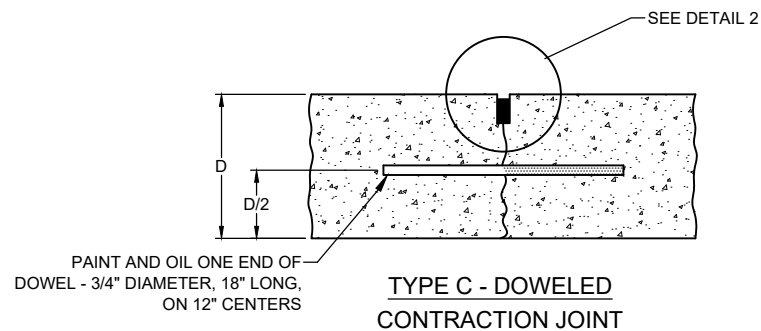

DOWEL PLAN VIEW

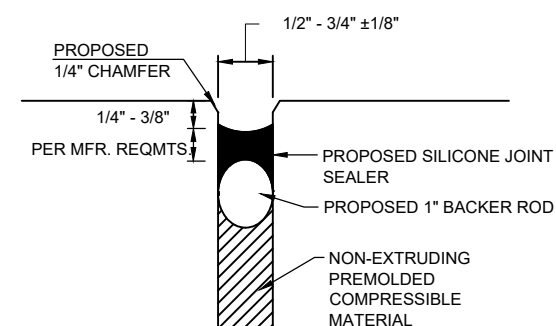
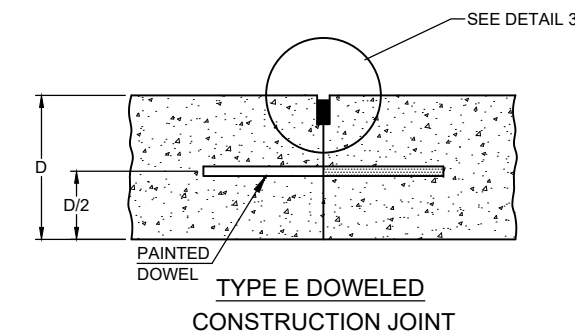

DETAIL 1
NOT TO SCALE

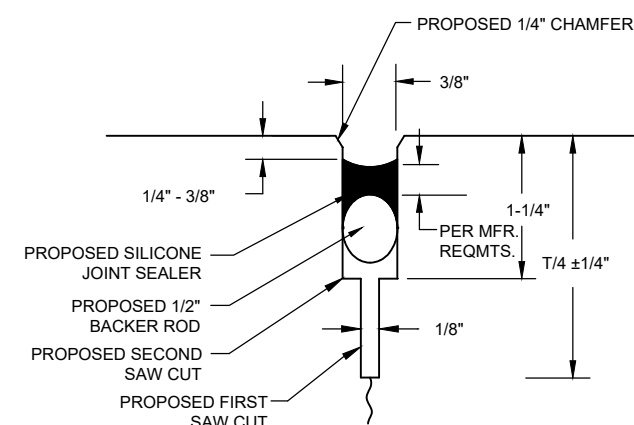

DETAIL 2
NOT TO SCALE

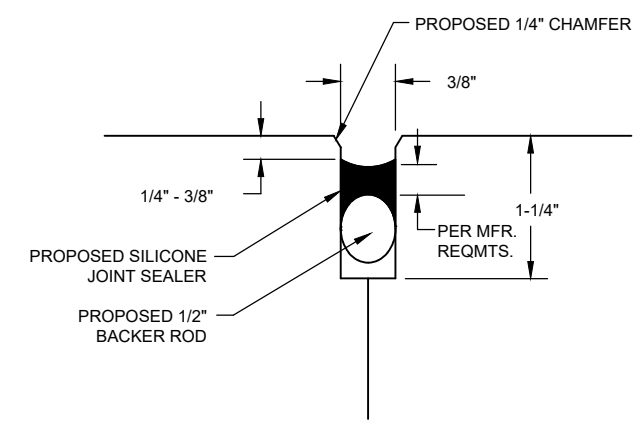

DETAIL 3
NOT TO SCALE

JOINT SEALING DETAILS

NOT TO SCALE

100% SUBMITTAL

NO.	DATE	DESCRIPTION		
		DES	DWN	REV

ISSUE: NOVEMBER 14, 2025

PROJECT NO: 24A0077

CAD FILE: C-561-JNT.DWG

DESIGN BY: AJC 03/20/2025

DRAWN BY: A.J.C. 03/20/2025

REVIEWED BY: J.DH. 11/13/2025

REVIEWED BY: EDIT 11/13/2023

SHEET TITLE

PROPOSED JOINTING PLAN DETAILS AND NOTES

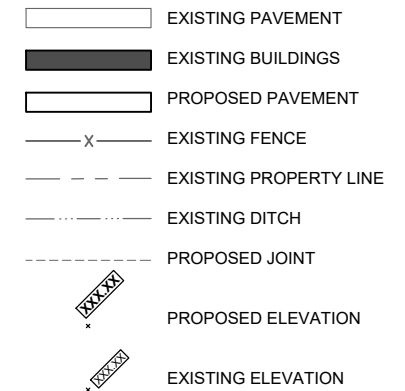

NOTE:
AS BUILT SURVEY SHALL BE PROVIDED
AT JOINT LOCATIONS.

IDA NO: DEC-5251
SBG NO: 3-17-0033-TBD









NO.	DATE	DESCRIPTION		
		DES	DWN	REV

SHEET TITLE

PROPOSED STAKING
PLAN - BASE BID

100% SUBMITTAL



- | | |
|---|------------------------|
|  | EXISTING PAVEMENT |
|  | EXISTING BUILDINGS |
|  | PROPOSED PAVEMENT |
|  | EXISTING FENCE |
|  | EXISTING PROPERTY LINE |
|  | EXISTING DITCH |
|  | PROPOSED JOINT |
|  | PROPOSED ELEVATION |
|  | EXISTING ELEVATION |

NOTE:
AS BUILT SURVEY SHALL BE PROVIDED
AT JOINT LOCATIONS.

DATE SIGNED: ---- LICENSE EXPIRES: 11/30/2027

RECONSTRUCT SOUTH T-HANGAR PAVEMENTS

IDA NO: DEC-5251
SBG NO: 3-17-0033-TBD

NO.	DATE	DESCRIPTION		
		DES	DWN	REV

ISSUE: NOVEMBER 14, 2025









PROJECT NO: 24A0077
CAD FILE: C-131-STK.DWG
DESIGN BY: AJC 10/06/2025
DRAWN BY: AJC 10/16/2025
REVIEWED BY: LDH 11/13/2025

SHEET TITLE

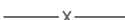
PROPOSED STAKING PLAN - ADDITIVE ALTERNATE 1



Decatur Park District
Decatur Airport
910 South Airport Road
Decatur, IL 62521

- ### LEGEND
- | | |
|---|------------------------|
|  | EXISTING PAVEMENT |
|  | EXISTING BUILDINGS |
|  | PROPOSED PAVEMENT |
|  | EXISTING FENCE |
|  | EXISTING PROPERTY LINE |
|  | EXISTING DITCH |
|  | PROPOSED JOINT |
|  | PROPOSED ELEVATION |
|  | EXISTING ELEVATION |

NOTE:
AS BUILT SURVEY SHALL BE PROVIDED
AT JOINT LOCATIONS.

DATE SIGNED: ****	LICENSE EXPIRES: 11/30/2027
----------------------	--------------------------------

RECONSTRUCT SOUTH T-HANGAR PAVEMENTS

IDA NO: DEC-5251
SBG NO: 3-17-0033-TBD

NO.	DATE	DESCRIPTION		
		DES	DWN	REV

ISSUE: NOVEMBER 14, 2025

PROJECT NO: 24A0077

CAD FILE: C-131-STK.DWG

DESIGN BY: AJC 10/06/2025

DRAWN BY: AJC 10/16/2025

REVIEWED BY: LDH 11/13/2025

SHEET TITLE

PROPOSED STAKING
PLAN - ADDITIVE
ALTERNATE 2

I:\24JOBS\24A0077_00\CAD\AIRPORT\131-STK.DWG
NOV 24, 2025 5:08 PM CRAFT02387



RECONSTRUCT SOUTH T-HANGAR PAVEMENTS

IDA NO: DEC-5251
SBG NO: 3-17-0033-TBD

ISSUE: NOVEMBER 14, 2025
PROJECT NO: 24A0077
CAD FILE: C-153-MRK.DWG
DESIGN BY: AJC 03/20/2025
DRAWN BY: AJC 03/20/2025
REVIEWED BY: LDH 11/13/2025

SHEET TITLE

PROPOSED MARKING PLAN



I:\24\JOBS\24A0077_00\CAD\AIRPORT\153-MRK.DWG
NOV 24, 2025 5:08 PM CRAFT02387

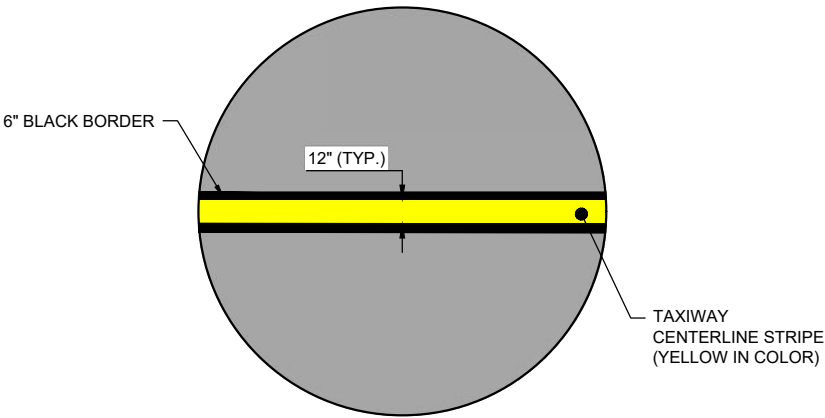

TAXIWAY CENTERLINE DETAIL
NOT TO SCALE

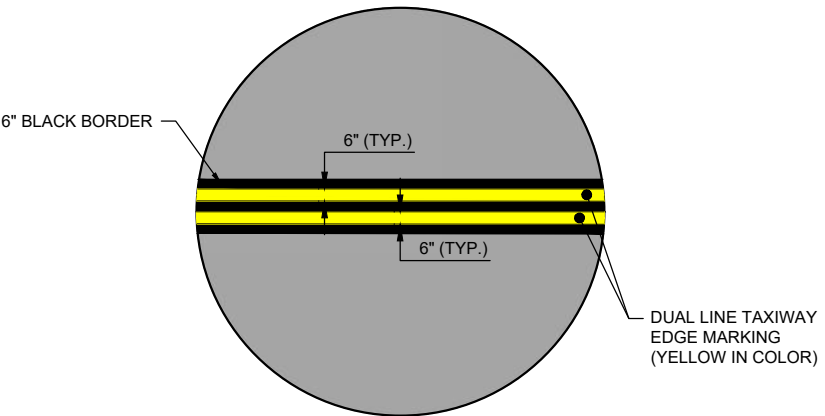

DUAL LINE TAXIWAY EDGE MARKING DETAIL
NOT TO SCALE

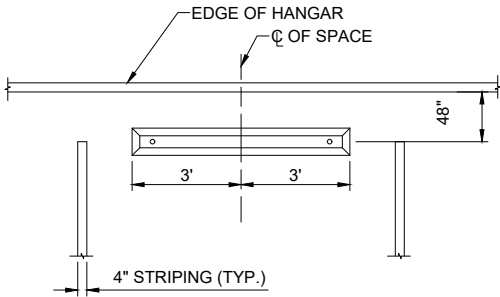

PARKING BLOCK LAYOUT
NOT TO SCALE

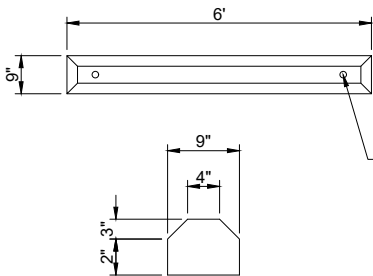

STANDARD PRE-CAST PARKING BLOCK
NOT TO SCALE

NOTES: A FUNCTIONAL EQUIVALENT OF THE STANDARD PARKING BLOCK MAY BE USED IF APPROVED BY THE ENGINEER AND AIRPORT MANAGER PRIOR TO INSTALLATION.

THE PARKING BLOCK SHALL BE INSTALLED WITH A MIN OF TWO PINS AT EACH END WITH A MIN EMBEDMENT OF 15" AND BE PAINTED YELLOW.

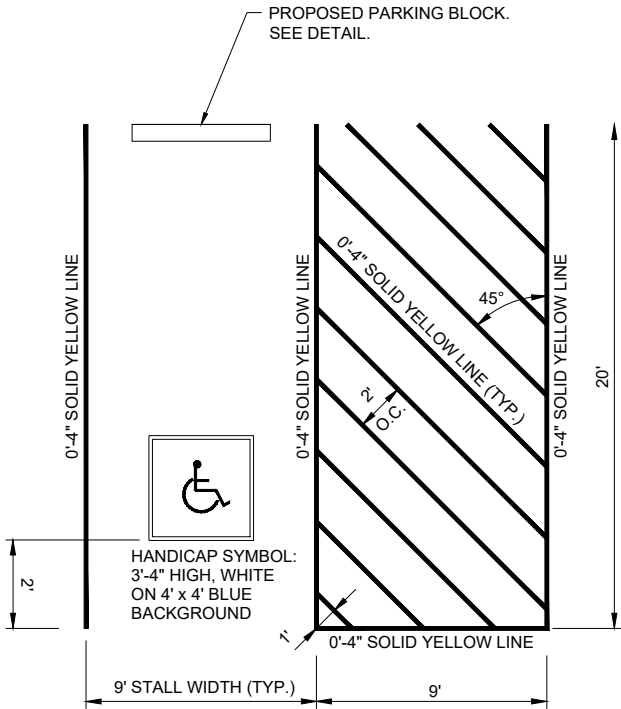

ACCESSIBLE SPACE DETAIL

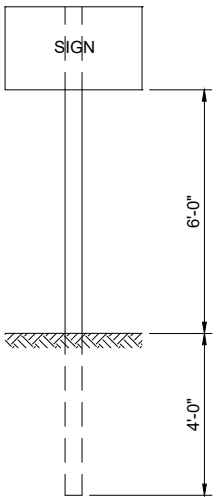

ONE POST INSTALLATION

WATERBORNE PAVEMENT MARKING NOTES

1. ALL PARKING LOT MARKING WILL BE YELLOW (AR620520) AND 4" IN WIDTH.
2. SEE PROPOSED MARKING AND SIGNING DETAIL SHEET FOR ADDITIONAL INFORMATION.
3. A 30-DAY WAITING PERIOD IS REQUIRED BETWEEN PAVING AND THE APPLICATION OF WATERBORNE PAINT.
4. GLASS BEADS SHALL BE APPLIED ON THE SECOND COAT OF MARKING. GLASS BEADS SHALL NOT BE APPLIED TO BLACK PAINT.
5. CUT-OFF SHEETS WILL BE REQUIRED TO ENSURE STRAIGHT EDGES.
6. THE CONTRACTOR WILL BE RESPONSIBLE FOR RE-MARKING ANY MARKINGS DAMAGED BY CONSTRUCTION ACTIVITIES THAT ARE OUTSIDE OF THE PROPOSED WORK LIMITS.



HANDICAP SIGN PANEL

R7-8il

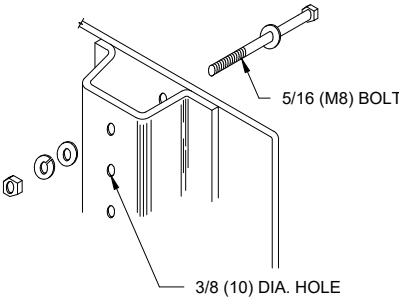

DETAIL OF MOUNTING SIGN TO POST

ROADWAY SIGN POST

(IDOT STANDARD 720011, 720006, & 729001)

NOTES: PROVISION AND INSTALLATION OF ACCESSIBLE PARKING SPOT SIGN WILL BE INCIDENTAL TO THE CONTRACT.

Offices Nationwide
www.hanson-inc.com

Hanson Professional Services Inc.
1525 S. 6th Street
Springfield, IL 62703
phone: 217-788-2450
fax: 217-788-2503

Illinois Licensed
Professional Service Corporation
#184-001084



Decatur Park District
Decatur Airport
910 South Airport Road
Decatur, IL 62521

DATE: XX/XX/2025 LICENSE
SIGNED: XX/XX/2025 EXPIRES: 11/30/2027

**RECONSTRUCT SOUTH
T-HANGAR PAVEMENTS**

IDA NO: DEC-5251
SBG NO: 3-17-0033-TBD

NO.	DATE	DESCRIPTION		
		DES	DWN	REV

ISSUE: NOVEMBER 14, 2025

PROJECT NO: 24A0077

CAD FILE: C-153-MRK.DWG

DESIGN BY: AJC 10/16/2025

DRAWN BY: AJC 10/16/2025





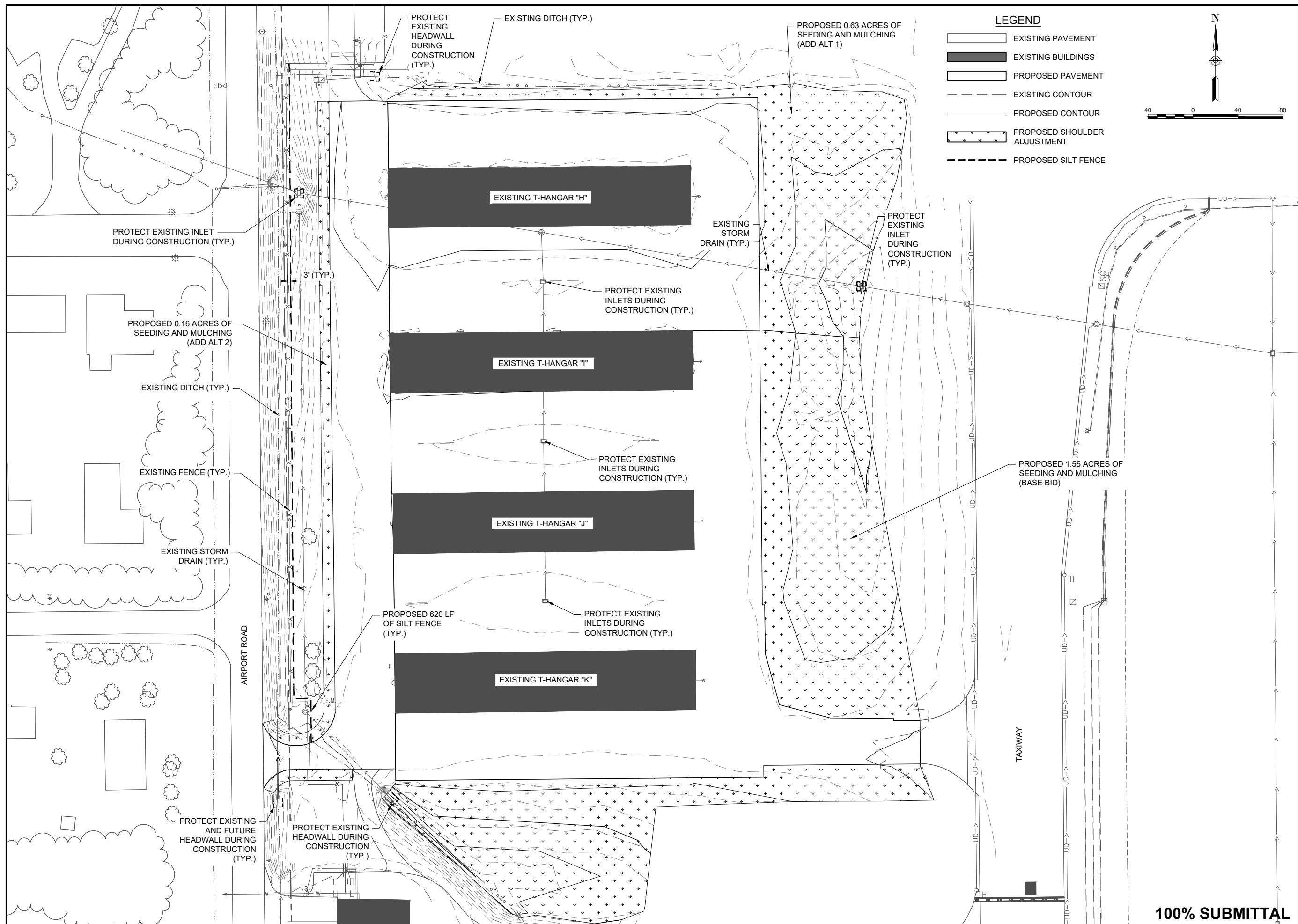

REVIEWED BY: LDH 11/13/2025

SHEET TITLE

MARKING DETAILS



LEGEND

- | | |
|---|---------------------------------|
|  | EXISTING PAVEMENT |
|  | EXISTING BUILDINGS |
|  | PROPOSED PAVEMENT |
|  | EXISTING CONTOUR |
|  | PROPOSED CONTOUR |
|  | PROPOSED SHOULDER
ADJUSTMENT |
|  | PROPOSED SILT FENCE |

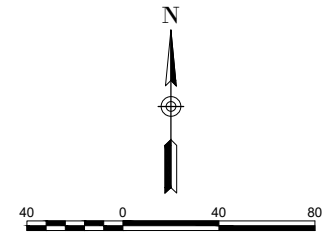

Offices Nationwide
www.hanson-inc.com

Hanson Professional Services Inc.
1525 S. 6th Street
Springfield, IL 62703
phone: 217-788-2450
fax: 217-788-2503

Illinois Licensed
Professional Service Corporation
#184-001084



Decatur Park District
Decatur Airport
910 South Airport Road
Decatur, IL 62521

DATE SIGNED: XX/XX/2025 LICENSE EXPIRES: 11/30/2027

RECONSTRUCT SOUTH T-HANGAR PAVEMENTS

IDA NO: DEC-5251
SBG NO: 3-17-0033-TBD

NO.	DATE	DESCRIPTION		
		DES	DWN	REV

ISSUE: NOVEMBER 14, 2025

PROJECT NO: 24A0077

CAD FILE: C-191-SWP.DWG

DESIGN BY: AJC 10/16/2025

DRAWN BY: AJC 10/16/2025

REVIEWED BY: LDH 11/13/2025

SHEET TITLE

STORM WATER POLLUTION PREVENTION PLAN

1. THE CONTRACTOR SHALL IMPLEMENT ALL PROVISIONS OF THE CONTRACT DOCUMENTS TO ASSURE THAT EROSION CONTROL ITEMS ARE CONSTRUCTED AND MAINTAINED IN A TIMELY MANNER. SEDIMENTATION MUST NOT BE TRANSPORTED OFF THE CONSTRUCTION SITE. PERMANENT DRAINAGE FEATURES AND VEGETATIVE MEASURES SHALL BE PROVIDED AS SOON AS POSSIBLE.
2. THE CONTRACTOR SHALL BE REQUIRED TO IMPLEMENT AND MAINTAIN EROSION CONTROL PRACTICES AND MEASURES PRIOR TO THE STRIPPING OF EXISTING VEGETATION WHERE EVER POSSIBLE AND AS SOON AS CONSTRUCTION PERMITS IN OTHER AREAS. EROSION CONTROL MEASURES SHALL BE IN ACCORDANCE WITH THE CONTRACT DOCUMENTS, INCLUDING THESE CONSTRUCTION PLANS, AND WITH STANDARDS AND SPECIFICATIONS FOR SOIL EROSION AND SEDIMENT CONTROL, ILLINOIS ENVIRONMENTAL PROTECTION AGENCY, CURRENT ISSUE. THE CONTRACTOR SHALL ADJUST HIS OPERATIONS AND IMPLEMENT EROSION CONTROL MEASURES SO THAT NO RUNOFF FROM STRIPPED AREAS WILL LEAVE THE CONSTRUCTION SITE OTHER THAN THROUGH SEDIMENT TRAPS OR OTHER SUITABLE CONTROL MEASURES.
3. EROSION CONTROL ITEMS SHALL BE PROVIDED AS NOTED ON THE EROSION CONTROL PLAN AND IN THE EROSION CONTROL DETAILS AND AS DIRECTED BY THE RESIDENT ENGINEER/TECHNICIAN. THE LIMITS OF SUCH MEASURES SHALL BE STAKED BY THE CONTRACTOR PRIOR TO THE COMMENCEMENT OF CONSTRUCTION. SUCH LIMITS MAY BE ADJUSTED BY THE RESIDENT ENGINEER/TECHNICIAN TO ACCOUNT FOR ACTUAL SITE CONDITIONS EXPERIENCED DURING CONSTRUCTION. ADDITIONAL COMPENSATION FOR MEASURES EXCEEDING THE PLAN QUANTITIES WILL BE PAID FOR AT THE CONTRACT UNIT PRICE FOR EACH ITEM.
4. THE CONTRACTOR IS TO MAINTAIN AND ADJUST, REPAIR OR REPLACE ALL EROSION CONTROL MEASURES AS REQUIRED OR AS DIRECTED BY THE RESIDENT ENGINEER/TECHNICIAN UNTIL PERMANENT VEGETATION HAS BEEN ESTABLISHED. MAINTENANCE OF EROSION CONTROL MEASURES IS TO BE PROVIDED AT NO ADDITIONAL COST TO THE CONTRACT.



NOT TO SCALE



NO SCALE

Offices Nationwide
www.hanson-inc.com

Hanson Professional Services Inc.
1525 S. 6th Street
Springfield, IL 62703
phone: 217-788-2450
fax: 217-788-2503

Illinois Licensed
Professional Service Corporation
#184-001084



Decatur Park District
Decatur Airport
910 South Airport Road
Decatur, IL 62521

DATE SIGNED: XX/XX/2025 LICENSE EXPIRES: 11/30/2027

RECONSTRUCT SOUTH T-HANGAR PAVEMENTS

IDA NO: DEC-5251
SBG NO: 3-17-0033-TBD

NO.	DATE	DESCRIPTION		
		DES	DWN	REV

ISSUE: NOVEMBER 14, 2025

PROJECT NO: 24A0077

CAD FILE: C-191-SWP.DWG

DESIGN BY: AJC 10/16/2025

DRAWN BY: AJC 10/16/2025

REVIEWED BY: LDH 11/13/2025

SHEET TITLE

STORM WATER POLLUTION PREVENTION DETAILS AND NOTES



Decatur Park District
Decatur Airport
910 South Airport Road
Decatur, IL 62521

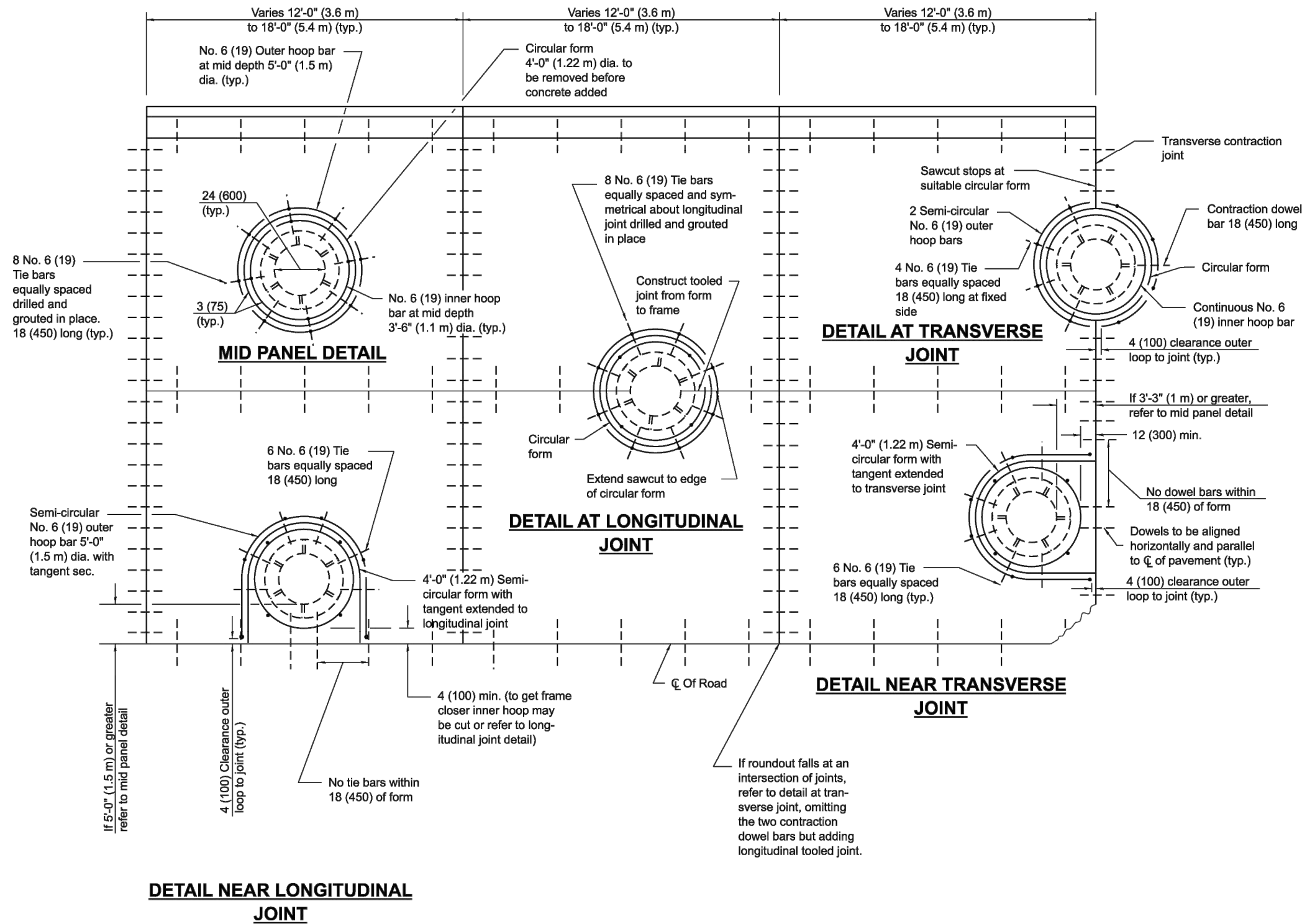

GENERAL NOTES

Transverse joints may be moved to accommodate roundout. Edge of circular joint shall be minimum 24 (600) from transverse joint. Relocated transverse joint shall be continuous from edge of pavement to edge of pavement.

The transverse joint spacing should be adjusted to use the DETAIL NEAR TRANSVERSE JOINT. If the joint cannot be adjusted to give the 12 (300) min. offset, use the DETAIL AT TRANSVERSE JOINT and ensure the joint is centered in the structure as shown.

Circular form shall be removed prior to drill and grout of tie bars.

Drill and grout is preferred, however tie bars can be poured in place if clearance is provided to outer edge of frame. Maximum 2 (50) clearance.

Shims shall be used to adjust all frames. After adjusting mortar has cured, the shims shall be removed and the voids under the frames filled with nonshrink grout.

Hoop reinforcement shall be one piece construction having a minimum lap length of 24 (600).

All situations not shown and may require combination of details.

WHEN USING CAST IN PLACE:
Frame shall be anchored to the structure to prevent movement during the paving operation.

All dimensions are in inches (millimeters) unless otherwise shown.

DATE	REVISIONS
1-1-18	Revised standard for 36 (900)
	tie bar spacing. Revised
	General Notes.
1-1-11	Corrected 'T/2' dim. on
	DETAIL OF REINFORCEMENT
	FOR PAVEMENT ROUNDOUT.

PCC PAVEMENT ROUNDOUTS

(Sheet 1 of 2)

STANDARD 420111-04

FOR REFERENCE

RECONSTRUCT SOUTH T-HANGAR PAVEMENTS

IDA NO: DEC-5251
SBG NO: 3-17-0033-TBD

NO.	DATE	DESCRIPTION		
		DES	DWN	REV

ISSUE: NOVEMBER 14, 2025

PROJECT NO: 24A0077

CAD FILE: C-562-JNT.DWG

DESIGN BY: AJC 10/06/2025

DRAWN BY: AJC 10/16/2025

REVIEWED BY: LDH 11/13/2025

SHEET TITLE

HIGHWAY STANDARD
DETAIL 420111-04
SHEET 1

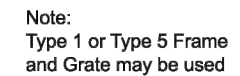

DETAIL OF REINFORCEMENT FOR PAVEMENT ROUNDOUT

PCC PAVEMENT ROUNDOUTS

(Sheet 2 of 2)

STANDARD 420111-04

FOR REFERENCE

NO.	DATE	DESCRIPTION		
		DES	DWN	REV

ISSUE: NOVEMBER 14, 2025

PROJECT NO: 24A0077

CAD FILE: C-562-INT.DWG

CAD FILE: C-562-JNT.DWG
DESIGN BY: AJG 10/22/2005

DESIGN BY: AJC 10/06/2025

DRAWN BY: AJC 10/16/2025

REVIEWED BY: LDH 11/13/2025

SHEET TITLE

HIGHWAY STANDARD
DETAIL 420111-04
SHEET 2