

STATE OF ILLINOIS
DEPARTMENT OF TRANSPORTATION

F.A.U. RTE.	SECTION	COUNTY	TOTAL SHEETS	SHEET NO.
3728	2001-142RS	COOK	26	1
		ILLINOIS	CONTRACT NO. 62321	

D-91-449-01

FOR INDEX OF SHEETS, SEE SHEET NO. 2

THE IMPROVEMENT IS LOCATED IN THE
CITY OF CHICAGO

TRAFFIC DATA
KIMBALL AVENUE 2022 ADT = 13,300
POSTED SPEED LIMIT = 20 MPH

**PROPOSED
HIGHWAY PLANS**
**FAU ROUTE 3728 (KIMBALL AVE.)
FROM DIVERSEY AVE. TO WELLINGTON AVE.**
SECTION: 2001-142RS
PROJECT : STP-NW2U (968)
STANDARD OVERLAY, ADA IMPROVEMENT
COOK COUNTY
C-91-449-01

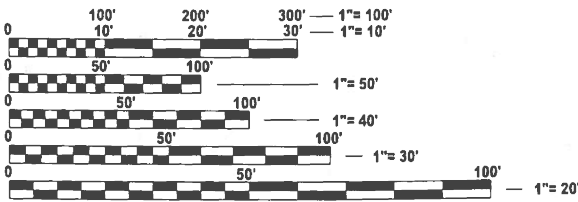
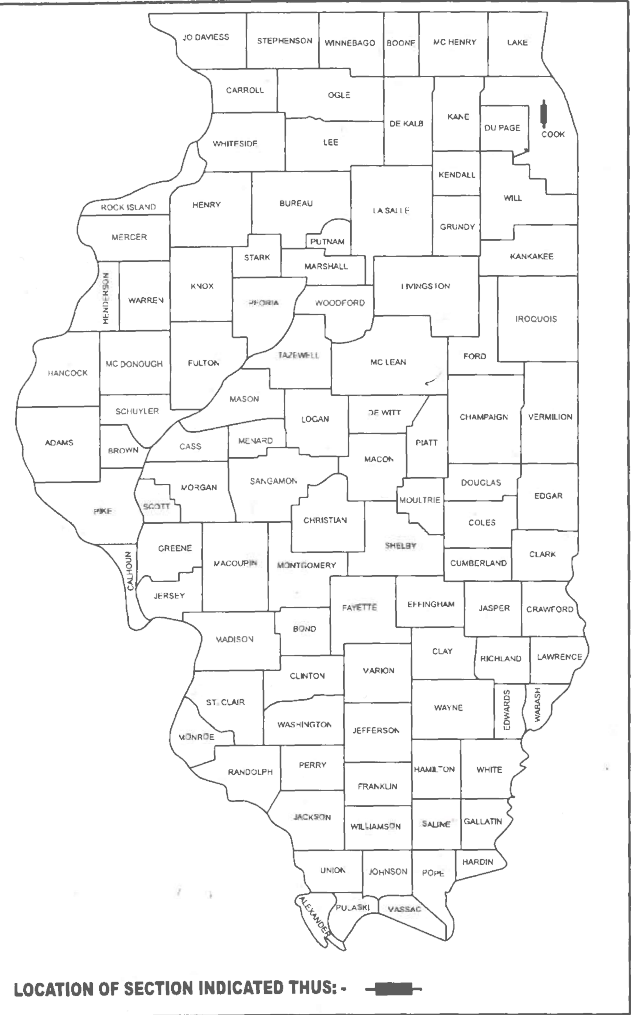

FULL SIZE PLANS HAVE BEEN PREPARED USING STANDARD
ENGINEERING SCALES. REDUCED SIZED PLANS WILL NOT
CONFORM TO STANDARD SCALES. IN MAKING MEASUREMENTS
ON REDUCED PLANS, THE ABOVE SCALES MAY BE USED.

J.U.L.I.E.
JOINT UTILITY LOCATION INFORMATION FOR EXCAVATION
1-800-892-0123
OR 811

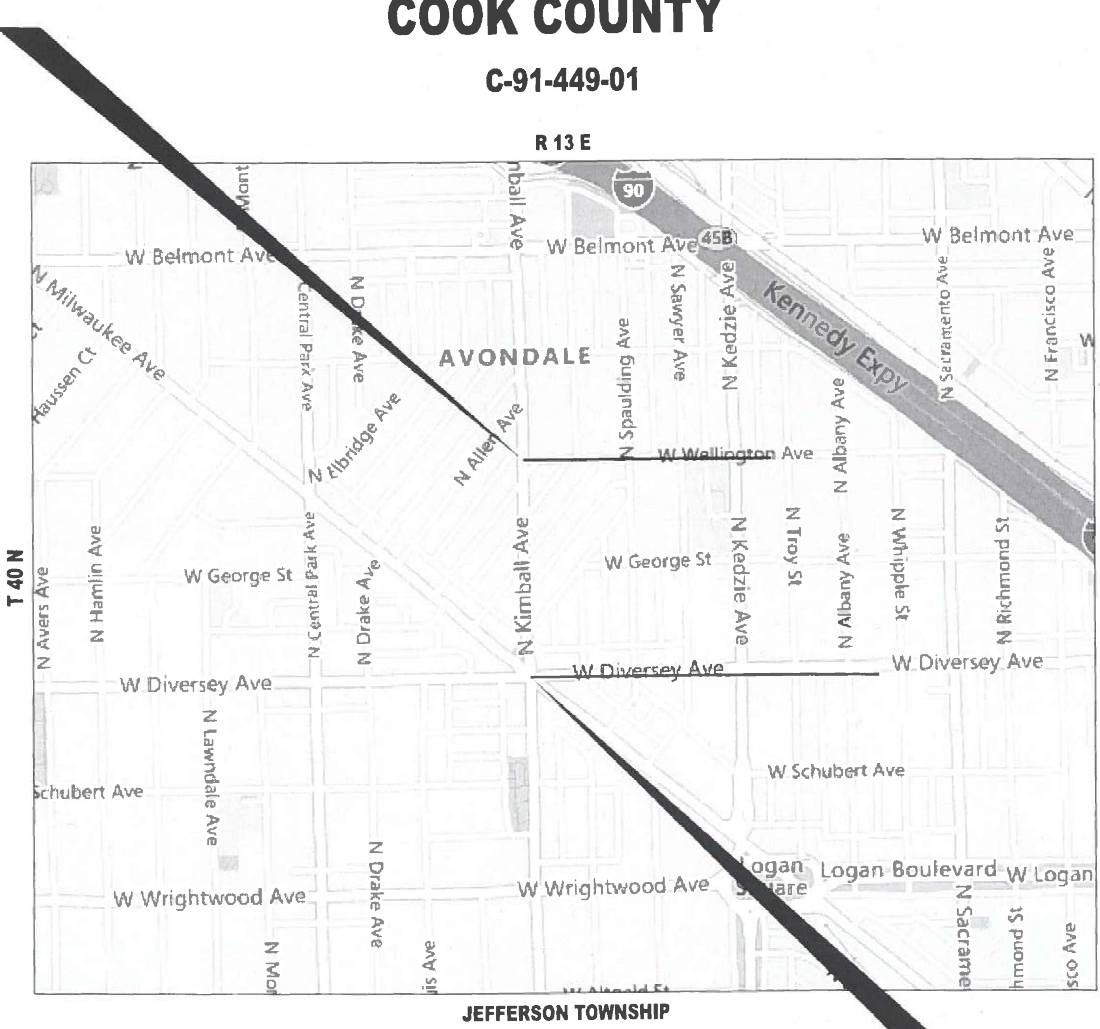

PROJECT ENGINEER: LUKASZ POCIECHA (847) 705-4255
PROJECT MANAGER: VESELIN VELICHKOV

GROSS LENGTH = 1,357 FT. = 0.25 MILE

PROJECT BEGINS
STA. 15+60

CONTRACT NO. 62321

STATE OF ILLINOIS
DEPARTMENT OF TRANSPORTATION

SUBMITTED Aug 14th 2025
[Signature] REGIONAL ENGINEER

December 5, 2025
[Signature] ENGINEER OF DESIGN AND ENVIRONMENT

December 5, 2025
[Signature] DIRECTOR OF HIGHWAYS PROJECT IMPLEMENTATION

PRINTED BY THE AUTHORITY
OF THE STATE OF ILLINOIS

MODEL: GenNotesSh01 [Sheet]
FILE NAME: c:\pwwork\work\illinois.gov_merin.jose@illinois.gov\d107871\144901-shi-gennote.dgn

INDEX OF SHEETS

STATE STANDARDS

GENERAL NOTES (CONTINUED...)

SHEET NO.

DESCRIPTION

STANDARD NO.

DESCRIPTION

1	TITLE SHEET
2	INDEX OF SHEETS, HIGHWAY STANDARDS, AND GENERAL NOTES
3-4	SUMMARY OF QUANTITIES
5	TYPICAL SECTIONS
6	ROADWAY AND PAVEMENT MARKING PLANS
7-9	PROPOSED SIDEWALK RAMP DETAILS
10	DETAILS FOR FRAMES AND LIDS ADJUSTMENT WITH MILLING (BD-08)
11	PAVEMENT PATCHING FOR HMA SURFACED PAVEMENT (BD-22)
12	CURB OR CURB AND GUTTER REMOVAL AND REPLACEMENT (BD-24)
13	BUTT JOINT AND HMA TAPER DETAILS (BD-32)
14	CITY OF CHICAGO DETECTABLE WARNINGS (BD-58)
15	TRAFFIC CONTROL AND PROTECTION FOR SIDE ROADS, INTERSECTIONS, AND DRIVEWAYS (TC-10)
16	TRAFFIC CONTROL AND PROTECTION AT TURN BAYS (TC-14)
17	SHORT TERM PAVEMENT MARKING LETTERS AND SYMBOLS (TC-16)
18	ARTERIAL ROAD INFORMATION SIGN (TC-22)
19-20	CITY OF CHICAGO TYPICAL PAVEMENT MARKINGS (TC-24)
21	DRIVEWAY ENTRANCE SIGNING (TC-26)
22	PROJECT DETAIL FOR SINGLE PERPENDICULAR CURB RAMPS (PD-01)
23	PROJECT DETAIL FOR DEPRESSED CORNER CURB RAMPS (PD-05)
24	CITY OF CHICAGO CATCH BASIN, INLET AND MANHOLE DETAILS (BD-47)
25-26	UTILITY MARKUP PLANS

000001-09	STANDARD SYMBOLS, ABBREVIATIONS AND PATTERNS
424001-12	PERPENDICULAR CURB RAMPS FOR SIDEWALKS
424011-05	CORNER PARALLEL CURB RAMPS FOR SIDEWALKS
424021-07	DEPRESSED CORNER FOR SIDEWALKS
442201-04	CLASS C AND D PATCHES
604001-05	FRAME AND LIDS TYPE 1
606001-09	CONCRETE CURB TYPE B AND COMBINATION CONCRETE CURB AND GUTTER
701006- 05	OFF-RD OPERATIONS, MULTILANE, 15' (4.5 m) TO 24" (600 mm) FROM PAVEMENT EDGE
701301-04	LANE CLOSURE, 2L 2W,SHORT TIME OPERATIONS
701311-03	LANE CLOSURES, 2L,2W, MOVING OPERATIONS-DAY ONLY
701427-05	LANE CLOSURE, MULTILANE, INTERMITTENT OR MOVING OPER., FOR SPEEDS =< 40 MPH
701501-06	URBAN LANE CLOSURE, 2L,2W UNDIVIDED
701606-10	URBAN SINGLE LANE CLOSURE, MULTILANE, 2W WITH MOUNTABLE MEDIAN.
701611-01	URBAN HALF ROAD CLOSURE,MULTILANE, 2W WITH MOUNTABLE MEDIAN
701701-10	URBAN LANE CLOSURE, MULTILANE INTERSECTION
701801-06	SIDEWALK, CORNER OR CROSSWALK CLOSURE
701901-11	TRAFFIC CONTROL DEVICES

11. FOR FRAMES AND LIDS ADJUSTMENT WITHOUT MILLING, REUSE EXISTING FRAME AND LID UNLESS OTHERWISE SPECIFIED IN THE PLANS.
12. WHEN MILLED PAVEMENT IS OPEN TO TRAFFIC, THE MAXIMUM GRADE DIFFERENTIAL BETWEEN PASSES OF THE MILLING MACHINE SHALL NOT EXCEED 1¼ INCHES WHERE THE SPEED LIMIT IS 45 MPH OR LESS, AND 1 INCH WHERE THE SPEED LIMIT IS OVER 45 MPH. WITH WRITTEN APPROVAL FROM THE ENGINEER, A MAXIMUM GRADE DIFFERENTIAL OF 3 INCHES MAY BE ALLOWED IF THE EDGE OF THE MILLING IS SLOPED A MINIMUM OF 1V:3H.
13. BUTT JOINTS WILL BE INSTALLED AT THE ENDS OF RESURFACING (WHERE RESURFACING MEETS EXISTING PAVEMENT) IN ACCORDANCE WITH THE "BUTT JOINT AND HMA TAPER DETAILS" SHEET INCLUDED IN THE PLANS, UNLESS OTHERWISE SPECIFIED.
14. THE ENGINEER SHALL CONTACT PATRICE HARRIS, ARTERIAL TRAFFIC FIELD ENGINEER AT PATRICE.HARRIS@ILLINOIS.GOV A MINIMUM OF 2 WEEKS PRIOR TO PLACEMENT OF PERMANENT PAVEMENT MARKINGS.
15. BEFORE BEGINNING ANY WORK, THE CONTRACTOR SHALL RETAIN AND RECORD FOR FUTURE REFERENCE, ALL EXISTING PAVEMENT MARKING LINES (AND RAISED REFLECTIVE PAVEMENT MARKERS) IN ORDER THAT THESE LOCATIONS CAN BE RE-ESTABLISHED FOR STRIPING. EXACT LOCATIONS OF ALL PAVEMENT MARKINGS SHALL BE AS DIRECTED BY THE ENGINEER.
16. ANY PAVEMENT MARKINGS AND RAISED REFLECTIVE PAVEMENT MARKERS OBLITERATED BY MILLING AND RESURFACING OPERATIONS ON SIDE STREETS AND ENTRANCES SHALL BE REPLACED AND PAID FOR IN KIND.
17. THE CONTRACTOR SHALL MAINTAIN PEDESTRIAN ACCESS AT ALL TIMES DURING CONSTRUCTION.
18. LOCATION OF COMBINATION CONCRETE CURB AND GUTTER REMOVAL AND REPLACEMENT [OR COMBINATION CURB AND GUTTER (THE TYPE SPECIFIED IN THE PLANS)] WILL BE DETERMINED IN THE FIELD BY THE ENGINEER.
19. PAVEMENT MARKING TAPE TYPE IV SHALL BE USED FOR SHORT TERM PAVEMENT MARKING ON ALL FINAL SURFACES
20. TEN (10) FOOT TRANSITIONS SHALL BE USED TO MATCH PROPOSED CURB AND GUTTER AND MEDIAN ITEMS OF WORK TO EXISTING CURBS AND GUTTER AND MEDIANS IN THE FIELD, UNLESS OTHERWISE SHOWN. THE TRANSITIONS SHALL BE PAID FOR AT THE CONTRACT UNIT PRICE FOR THE PROPOSED ITEMS OF WORK SPECIFIED.
21. ALL DAMAGE TO EXISTING PAVEMENT MARKINGS OR RAISED REFLECTIVE PAVEMENT MARKERS OUTSIDE THE REMOVAL LINE SHOWN ON THE PLANS SHALL BE REPLACED AT NO ADDITIONAL COST TO THE DEPARTMENT.
22. SIDEWALK REMOVAL AND P.C.C. SIDEWALK 5" LOCATIONS SHALL BE DETERMINED BY THE ENGINEER.
23. TEMPORARY PAVEMENT MARKINGS OR SHORT TERM PAVEMENT MARKINGS ON INTERMEDIATE SURFACES SHALL NOT BE REMOVED, UNLESS DIRECTED BY THE ENGINEER.
24. WHERE SECTION OR SUB-SECTION MONUMENTS ARE ENCOUNTERED, THE ENGINEER SHALL BE NOTIFIED BEFORE SUCH MONUMENTS ARE REMOVED. THE CONTRACTOR SHALL PROTECT AND CAREFULLY PRESERVE ALL PROPERTY MARKERS AND MONUMENTS UNTIL THE OWNER, AN AUTHORIZED SURVEYOR OR AGENT HAS WITNESSED THEIR LOCATION.
25. THE THICKNESS OF THE HMA MIXTURE SHOWN ON THE PLANS IS THE NOMINAL THICKNESS. DEVIATIONS FROM THE NOMINAL THICKNESS WILL BE PERMITTED WHEN SUCH DEVIATIONS OCCUR DUE TO IRREGULARITIES IN THE EXISTING SURFACE OR BASE ON WHICH THE HMA MIXTURE IS PLACED.
26. EXISTING BROKEN FRAMES AND LIDS SHALL BE REMOVED AND DISPOSED OF BY THE CONTRACTOR AND SHALL BE REPLACED AS DIRECTED BY THE ENGINEER. REPLACEMENT FRAMES AND LIDS WILL BE PAID FOR ACCORDING TO ARTICLE 109.04 OF THE STANDARD SPECIFICATIONS UNLESS A SEPARATE PAY ITEM HAS BEEN PROVIDED.
27. OVERNIGHT LANE CLOSURES SHALL NOT BE ALLOWED FOR REHABILITATION PROJECTS INVOLVING DAYTIME MILLING AND RESURFACING OPERATIONS AND CLASS D PATCHING UNLESS OTHER CONDITIONS WARRANT EXTENDED LANE CLOSURES AS DETERMINED AND APPROVED IN WRITING BY THE ENGINEER OR AS PROVIDED FOR IN THE CONTRACT SPECIFICATIONS.
28. ALL BROKEN, CRACKED, WORN OR OTHERWISE DAMAGED OR BICYCLE UNSAFE FRAMES AND LIDS ON SEWER STRUCTURES, SHALL BE REPLACED WITH NEW DEPARTMENT OF SEWERS' STANDARD FRAMES AND LIDS.

GENERAL NOTES

1. BEFORE STARTING ANY EXCAVATION, THE CONTRACTOR SHALL CALL "CUAN" AT (312) 744-7000 FOR FIELD LOCATIONS OF BURIED ELECTRIC, TELEPHONE, AND GAS FACILITIES. (48 HOUR NOTIFICATION REQUIRED)
2. THE CONTRACTOR SHALL COORDINATE CONSTRUCTION ACTIVITIES WITH UTILITY COMPANIES AND THE CITY OF CHICAGO AND OBTAIN ALL NECESSARY PERMITS.
3. FRAMES AND GRATES ADJUSTMENT OF PRIVATE UTILITIES WITHIN THE LIMITS OF THE IMPROVEMENTS SHALL BE DONE BY THEIR RESPECTIVE OWNERS AND ARE NOT PART OF THIS CONTRACT.
4. THE CONTRACTOR SHALL CONTACT THE IDOT ARTERIAL DISTRICT ONE TRAFFIC CONTROL SUPERVISOR KALPANA KANNAN-HOSADURGA AT KALPANA.KANNAN-HOSADURGA@ILLINOIS.GOV A MINIMUM OF 72 HOURS IN ADVANCE OF BEGINNING WORK.
5. THE CONTRACTOR WILL NOT BE ALLOWED TO SET UP A YARD OR FIELD OFFICE ON STATE PROPERTY WITHOUT THE WRITTEN PERMISSION OF THE DEPARTMENT.
6. UNLESS OTHER CONDITIONS WARRANT EXTENDED LANE CLOSURE AS DETERMINED AND APPROVED IN WRITING BY THE ENGINEER OR AS PROVIDED FOR IN THE CONTRACT SPECIFICATIONS, OVERNIGHT CLOSURES SHALL NOT BE ALLOWED FOR REHABILITATION PROJECTS INVOLVING DAYTIME MILLING AND RESURFACING OPERATIONS AND CLASS D PATCHING.
7. IT SHALL BE THE CONTRACTOR'S RESPONSIBILITY TO VERIFY ALL DIMENSIONS AND CONDITIONS EXISTING IN THE FIELD PRIOR TO CONSTRUCTION AND ORDERING OF MATERIALS.
8. THE CONTRACTOR SHALL BE REQUIRED TO PROVIDE ACCESS TO ABUTTING PROPERTY AT ALL TIMES DURING THE CONSTRUCTION OF THIS PROJECT.
9. ALL PAVEMENT PATCHING LOCATIONS WILL BE DETERMINED IN THE FIELD BY THE ENGINEER.
10. DRAINAGE ADJUSTMENT OR RECONSTRUCTION LOCATIONS WILL BE DETERMINED IN THE FIELD BY THE ENGINEER.

GENERAL NOTE-UTILITY SECTION

1. OUC- EFP 131372 WAS APPROVED. GC SHALL USE THE EFP NUMBER TO SECURE ALL NEEDED CDOT PERMITS.

	USER NAME = merin.jose	DESIGNED -	REVISED -	STATE OF ILLINOIS DEPARTMENT OF TRANSPORTATION	GENERAL NOTES AND INDEX OF SHEETS KIMBALL AVE. (DIVERSEY AVE. TO WELLINGTON AVE.)				F A U RTE.	SECTION	COUNTY	TOTAL SHEETS	SHEET NO.
		DRAWN -	REVISED -						372B	2001-142RS	COOK	26	2
		CHECKED -	REVISED -						CONTRACT NO. 62321				
	PLOT DATE = 8/14/2025	DATE -	REVISED -		SCALE: NONE	SHEET 1	OF 1	SHEETS	STA.	TO STA.	ILLINOIS FED. AID PROJECT		

MODEL: SQCA (Sheet)
FILE NAME: c:\p\work\pwtod\illinois.gov_merin.jose@illinois.gov\1078710\144901-shl-SQO.dgn

SUMMARY OF QUANTITIES					TYPE CODE					
					URBAN	URBAN	URBAN	URBAN	URBAN	URBAN
					ROADWAY	DRAINAGE				
					80% FED 20% STATE	100% STATE				
	Code No.	Item	Unit	Total Quantity	0005	0043				
	20200100	EARTH EXCAVATION	CU YD	72	72					
	21101615	TOPSOIL FURNISH AND PLACE, 4"	SQ YD	380	380					
	25200110	SODDING, SALT TOLERANT	SQ YD	380	380					
	25200200	SUPPLEMENTAL WATERING	UNIT	3	3					
	40600290	BITUMINOUS MATERIALS (TACK COAT)	POUND	4428	4428					
	40600370	LONGITUDINAL JOINT SEALANT	FOOT	1384	1384					
	40600400	MIXTURE FOR CRACKS, JOINTS, AND FLANGEWAYS	TON	10	10					
	40600982	HOT-MIX ASPHALT SURFACE REMOVAL - BUTT JOINT	SQ YD	87	87					
	40601005	HOT-MIX ASPHALT REPLACEMENT OVER PATCHES	TON	224	224					
	40603200	POLYMERIZED HOT-MIX ASPHALT BINDER COURSE, IL-4.75, N50	TON	271	271					
	40604062	HOT-MIX ASPHALT SURFACE COURSE, IL-9.5, MIX "D", N70	TON	552	552					
	42101300	PROTECTIVE COAT	SQ YD	431	431					
	42300400	PORTLAND CEMENT CONCRETE DRIVEWAY PAVEMENT, 8 INCH	SQ YD	27	27					
	42400200	PORTLAND CEMENT CONCRETE SIDEWALK 5 INCH	SQ FT	842	842					
	44000158	HOT-MIX ASPHALT SURFACE REMOVAL, 2 1/4"	SQ YD	6560	6560					
	44000200	DRIVEWAY PAVEMENT REMOVAL	SQ YD	27	27					
	44000600	SIDEWALK REMOVAL	SQ FT	842	842					
	44002215	HOT-MIX ASPHALT REMOVAL OVER PATCHES, 3 3/4"	SQ YD	1067	1067					
	44201761	CLASS D PATCHES, TYPE I, 10 INCH	SQ YD	66	66					
	44201765	CLASS D PATCHES, TYPE II, 10 INCH	SQ YD	370	370					
	44201769	CLASS D PATCHES, TYPE III, 10 INCH	SQ YD	144	144					
		USER NAME = merin.jose	DESIGNED -	REVISED -	STATE OF IL DEPARTMENT OF TRANSPORTATION					
			DRAWN -	REVISED -						
			CHECKED -	REVISED -						
		PLOT DATE = 8/14/2025	DATE -	REVISED -						

MODEL: SOQ-B [Sheet]
FILE NAME: c:\pw_ work\pw\dot\illinois.gov_merin.jose@illinois.gov\d1107871D144901-sht-SOQ.dgn

SUMMARY OF QUANTITIES					TYPE CODE					
					URBAN	URBAN	URBAN	URBAN	URBAN	URBAN
					ROADWAY	DRAINAGE				
					80% FED 20% STATE	100% STATE				
	Code No.	Item	Unit	Total Quantity	0005	0043				
	70300221	TEMPORARY PAVEMENT MARKING - LINE 4"- PAINT	FOOT	2544	2544					
	70300241	TEMPORARY PAVEMENT MARKING - LINE 6"- PAINT	FOOT	114	114					
	70300261	TEMPORARY PAVEMENT MARKING - LINE 12"- PAINT	FOOT	112	112					
	70300281	TEMPORARY PAVEMENT MARKING - LINE 24"- PAINT	FOOT	1256	1256					
	70307120	TEMPORARY PAVEMENT MARKING - LINE 4" - TYPE IV TAPE	FOOT	5356	5356					
	72400100	REMOVE SIGN PANEL ASSEMBLY - TYPE A	EACH	1	1					
	72400500	RELOCATE SIGN PANELASSEMBLY - TYPE A	EACH	1	1					
*	78000100	THERMOPLASTIC PAVEMENT MARKING - LETTERS AND SYMBOLS	SQ FT	42	42					
*	78000200	THERMOPLASTIC PAVEMENT MARKING - LINE 4"	FOOT	1272	1272					
*	78000400	THERMOPLASTIC PAVEMENT MARKING - LINE 6"	FOOT	57	57					
*	78000600	THERMOPLASTIC PAVEMENT MARKING - LINE 12"	FOOT	56	56					
*	78000650	THERMOPLASTIC PAVEMENT MARKING - LINE 24"	FOOT	628	628					
	X0320050	CONSTRUCTION LAYOUT (SPECIAL)	L SUM	1	1					
	X4240800	DETECTABLE WARNINGS (SPECIAL)	SQ FT	60	60					
	X4400501	COMBINATION CURB AND GUTTER REMOVAL AND REPLACEMENT LESS THAN OR EQUAL TO 10 FEET	FOOT	75	75					
	X4400503	COMBINATION CURB AND GUTTER REMOVAL AND REPLACEMENT GREATER THAN 10 FEET	FOOT	1425	1425					
	X4406818	PORTLAND CEMENT CONCRETE SURFACE REMOVAL 2 1/4"	SQ YD	23	23					
	X5537800	STORM SEWERS TO BE CLEANED 12"	FOOT	330		330				
	X6030310	FRAMES AND LIDS TO BE ADJUSTED (SPECIAL)	EACH	16	16					
	X6700407	ENGINEER'S FIELD OFFICE, TYPE A (D1)	CAL MO	6	6					
	X7200061	TEMPORARY INFORMATION SIGNING	SQ FT	70	70					

	USER NAME = merin,jose	DESIGNED -	REVISED -	STATE OF ILL DEPARTMENT OF TRA
		DRAWN -	REVISED -	
		CHECKED -	REVISED -	
	PLOT DATE = 8/13/2025	DATE -	REVISED -	

[illegible]

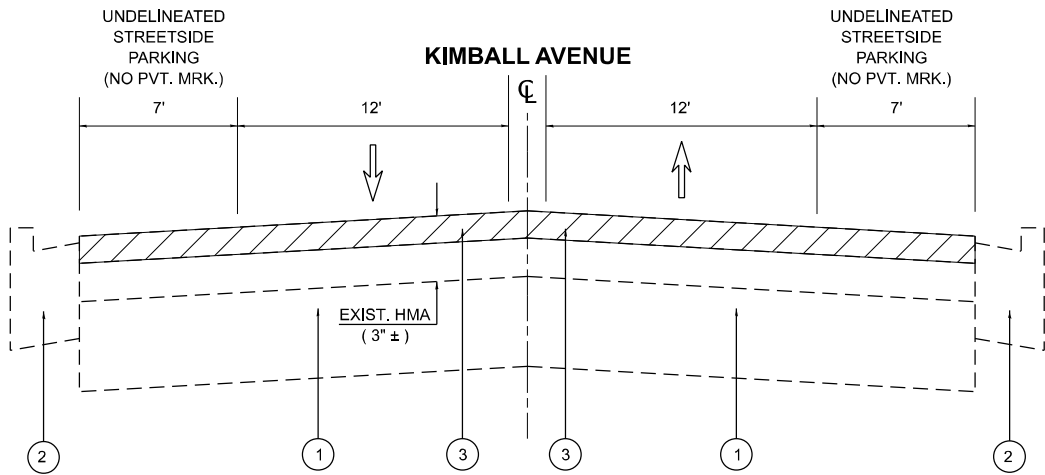

EXIST. TYPICAL SECTION
STA. 15+60 TO STA. 29+17

LEGEND

- 1 EXISTING P.C.C. PAVEMENT BASE COURSE, ±10"
- 2 EXISTING COMBINATION CURB AND GUTTER
- 3 PROPOSED HMA SURFACE REMOVAL, 2 ¼"
- 4 PROPOSED HMA SURFACE COURSE, IL-9.5, MIX "D", N70, 1 ½"
- 5 PROPOSED POLY. HMA BINDER COURSE, IL-4.75, N50, ¾"

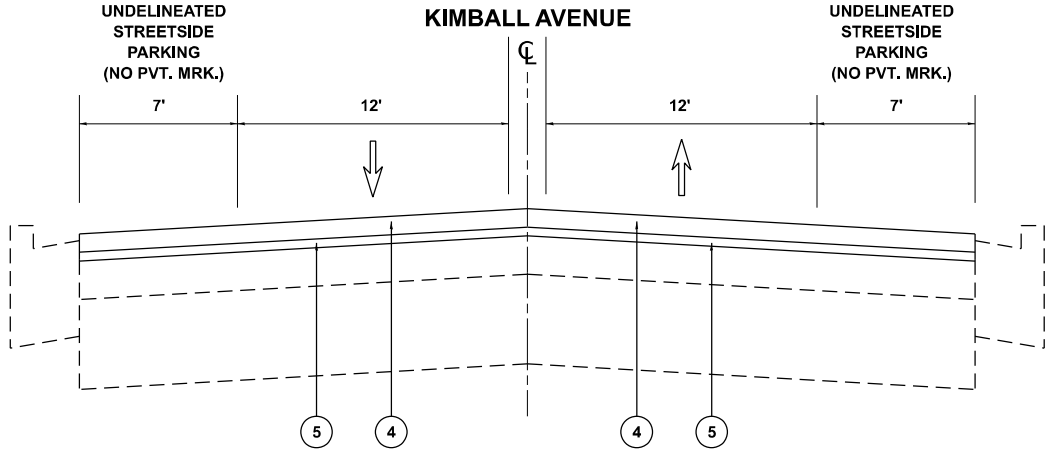

PROP. TYPICAL SECTION
STA. 15+60 TO STA. 29+17

HOT-MIX ASPHALT MIXTURE REQUIREMENTS

MIXTURE TYPE	AIR VOIDS @ N _{DES}	QMP
--------------	------------------------------	-----

ROADWAY HMA RESURFACING - STANDARD OVERLAY MIXTURES:

HMA SURFACE COURSE, IL-9.5, MIX "D", N70, 1 ½"	4% AT 70 GYR.	QC/QA
POLY. HMA BINDER COURSE, IL-4.75, N50, ¾"	3.5% AT 50 GYR.	QC/QA

HOT-MIX ASPHALT PATCHING:

CLASS D PATCHES (HMA BINDER IL-19 mm)	4% AT 70 GYR.	QC / QA
HMA REPLACEMENT OVER PATCHES (HMA BINDER IL-19 mm)	4% AT 70 GYR.	QC / QA

QMP Designation: Quality Control/Quality Assurance (QC/QA);
Quality Control for Performance (QCP); Pay for Performance (PFP)

NOTES:

1. THE CONTRACTOR SHALL PATCH FIRST THEN MILL THE ROADWAY PER BD-22 DETAIL.
2. THE PROPOSED LOGITUDINAL JOINT SEALANT SHALL BE PLACED ON THE POLY. HMA BINDER COURSE, IL-4.75, N50.

NOTES:

THE UNIT WEIGHT USED TO CALCULATE ALL HMA SURFACE MIXTURE QUANTITIES IS 112 LBS/SQ YD/IN.

THE "AC TYPE" FOR POLYMERIZED HMA MIXES SHALL BE "SBS/SBR PG 76 -22" AND FOR NON-POLYMERIZED HMA THE "AC TYPE" SHALL BE "PG 64 -22" UNLESS MODIFIED BY RECLAIMED MATERIALS SPECIFICATIONS.

MODEL: Typ01 [Sheet]
FILE NAME: c:\p\work\pwr\illinois.gov_merlin.jose\illinois.gov\110787\1D14901-shr-typical.dgn

	USER NAME = merlin.jose	DESIGNED -	REVISED -	STATE OF ILLINOIS DEPARTMENT OF TRANSPORTATION	TYPICAL SECTIONS KIMBALL AVE. (DIVERSEY AVE. TO WELLINGTON AVE.)			F.A.U RTE.	SECTION	COUNTY	TOTAL SHEETS	SHEET NO.
		DRAWN -	REVISED -					3728	2001-142RS	COOK	26	5
		CHECKED -	REVISED -					CONTRACT NO. 62321				
	PLOT DATE = 7/11/2025	DATE -	REVISED -		SCALE: NONE	SHEET 1	OF 1 SHEETS	STA.	TO STA.	ILLINOIS FED. AID PROJECT		

MODEL: Kimball Ave - Plan 1 [Sheet]
FILE NAME: c:\pwy_work\pwydata\illinois.gov\114901-shr-plan.dgn

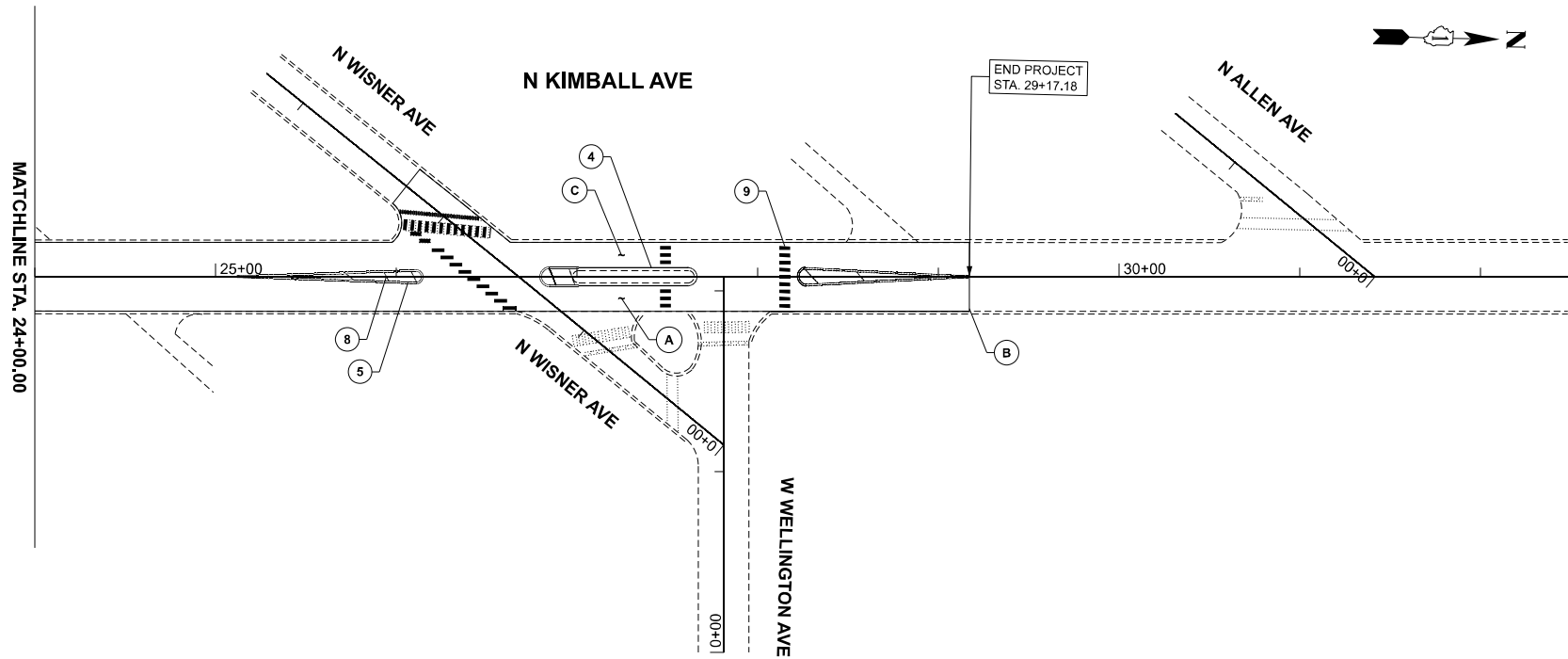
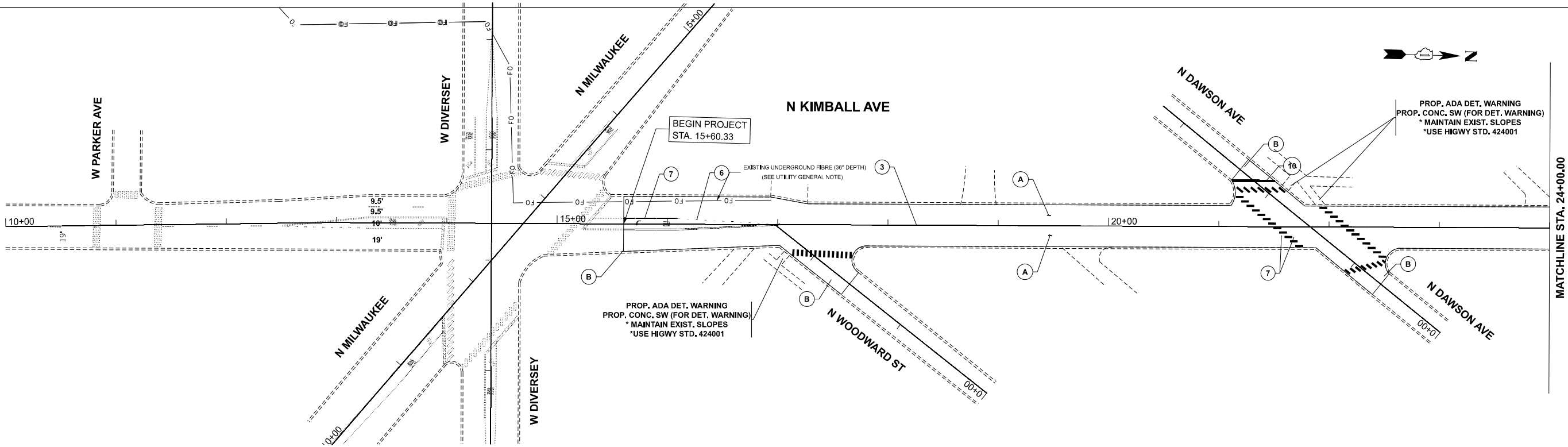

PAVEMENT MARKING LEGEND

- 1 PROP. THERMO. PVT. MRK., 8-FT LETTERS AND SYMBOLS (TYP.)

2 PROP. THERMO. PVT. MRK.-4" LANE LINE, 6' DASH - 18' SKIP, WHITE (TYP.)

3 PROP. THERMO. PVT. MRK.-4" CENTERLINE, 6' DASH - 18' SKIP, YELLOW (TYP.)

4 PROP. THERMO. PVT. MRK.-4" PCC MEDIAN BORDER, SINGLE SOLID YELLOW (TYP.)

5 PROP. THERMO. PVT. MRK.-4" CENTERLINE & PAINTED MEDIAN BORDER, DOUBLE SOLID YELLOW (TYP.)
- 6 PROP. THERMO. PVT. MRK.-6" DOTTED LINE, WHITE, 2' DASH, 6' SKIP (TYP.)

7 PROP. THERMO. PVT. MRK.-6" SOLID LINE, WHITE (TYP.)

8 PROP. THERMO. PVT. MRK.-12" PAINTED MEDIAN DIAGONAL, SOLID LINE, YELLOW (TYP.)

9 PROP. THERMO. PVT. MRK.-24" CROSSWALK BARS, WHITE (TYP.)

10 PROP. THERMO. PVT. MRK.-24" STOP LINE, WHITE (TYP.)

ROADWAY PROPOSED WORK LEGEND

- A PROP. HMA SURFACE REMOVAL, 2 1/4" PROP. HMA SURFACE CRSE, IL-9.5, MIX "D", N70, 1 1/2" PROP. POLY. HMA BINDER CRSE, IL-4.75, N50, 3/4"

B PROP. HMA SURFACE REMOVAL - BUTT JOINT LIMIT OF RESURFACING

C PROP. PCC SURFACE REMOVAL, 2 1/4" PROP. HMA SURFACE CRSE, IL-9.5, MIX "D", N70, 1 1/2" PROP. POLY. HMA BINDER CRSE, IL-4.75, N50, 3/4"
- * PROP. PCC SIDEWALK CURB RAMP IMPROVEMENT (SEE DETAIL SHEETS)

NOTE:
ALL FINAL PAVEMENT MARKINGS SHALL BE PLACED IN ACCORDANCE WITH DISTRICT ONE DETAIL TC-24.
ANY EXISTING RAISED REFLECTIVE PAVEMENT MARKERS FOUND AND REMOVED SHALL NOT BE REPLACED.

USER NAME	= merin,jose	DESIGNED	-	REVISED	-
		DRAWN	-	REVISED	-
		CHECKED	-	REVISED	-
PLOT DATE	= 8/8/2025	DATE	-	REVISED	-

STATE OF ILLINOIS
DEPARTMENT OF TRANSPORTATION

ROADWAY PLAN
KIMBALL AVE. (DIVERSEY AVE. TO WELLINGTON AVE.)

SCALE: SHEET 1 OF 1 SHEETS STA. 9+00.00 TO STA. 39+00.00

F.A.U RTE.	SECTION	COUNTY	TOTAL SHEETS	SHEET NO.
3728	2001-142RS	COOK	26	6
CONTRACT NO. 62321				
ILLINOIS FED. AID PROJECT				

MODEL: WELLINGTON [Sheet]
FILE NAME: c:\paw_work\paw\illinois.gov_merlin.jose@illinois.gov\1107872\0144901-ADA-Design.dgn

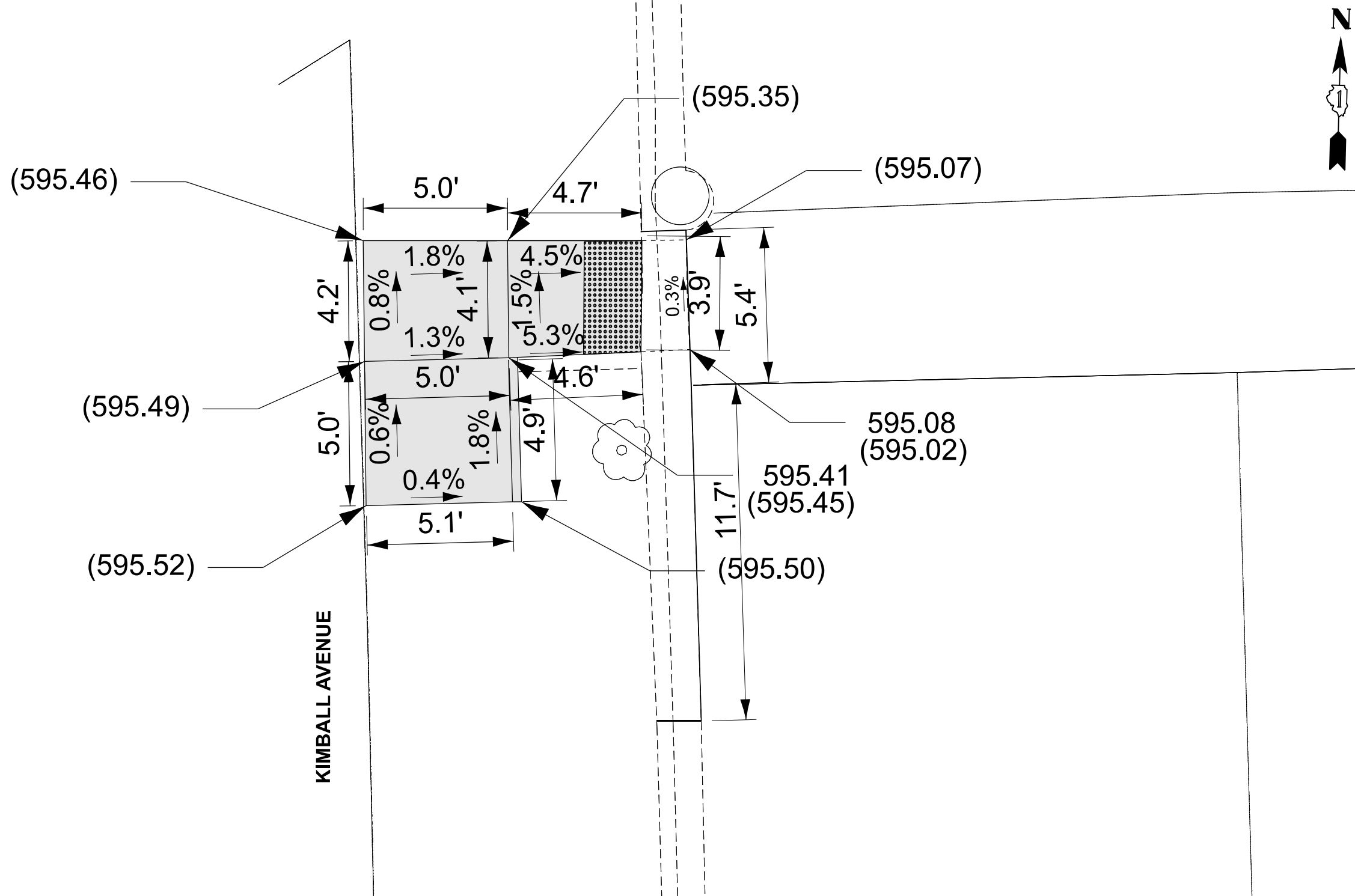

LEGEND

XX.XX'

EXISTING LENGTH

=====

PROPOSED SIDE CURB

()

EXISTING ELEVATION/SLOPE



PROPOSED SIDEWALK



DETECTABLE WARNINGS



SIDEWALK REMOVAL
REPLACE W/TOPSOIL & SOD

USER NAME = merlin.jose	DESIGNED -	REVISED -
	DRAWN -	REVISED -
	CHECKED -	REVISED -
PLOT DATE = 8/14/2025	DATE -	REVISED -

STATE OF ILLINOIS
DEPARTMENT OF TRANSPORTATION

ADA IMPROVEMENT DETAILS
KIMBALL AVE AT WELLINGTON ST.

SCALE: SHEET 1 OF 3 SHEETS STA. 0+00.00 TO STA. 0+00.00

F.A.U. RTE.	SECTION	COUNTY	TOTAL SHEETS	SHEET NO.
3728	2001-142RS	COOK	26	7
CONTRACT NO. 62321				
ILLINOIS FED. AID PROJECT				

WISNER AVE.



KIMBALL AVENUE

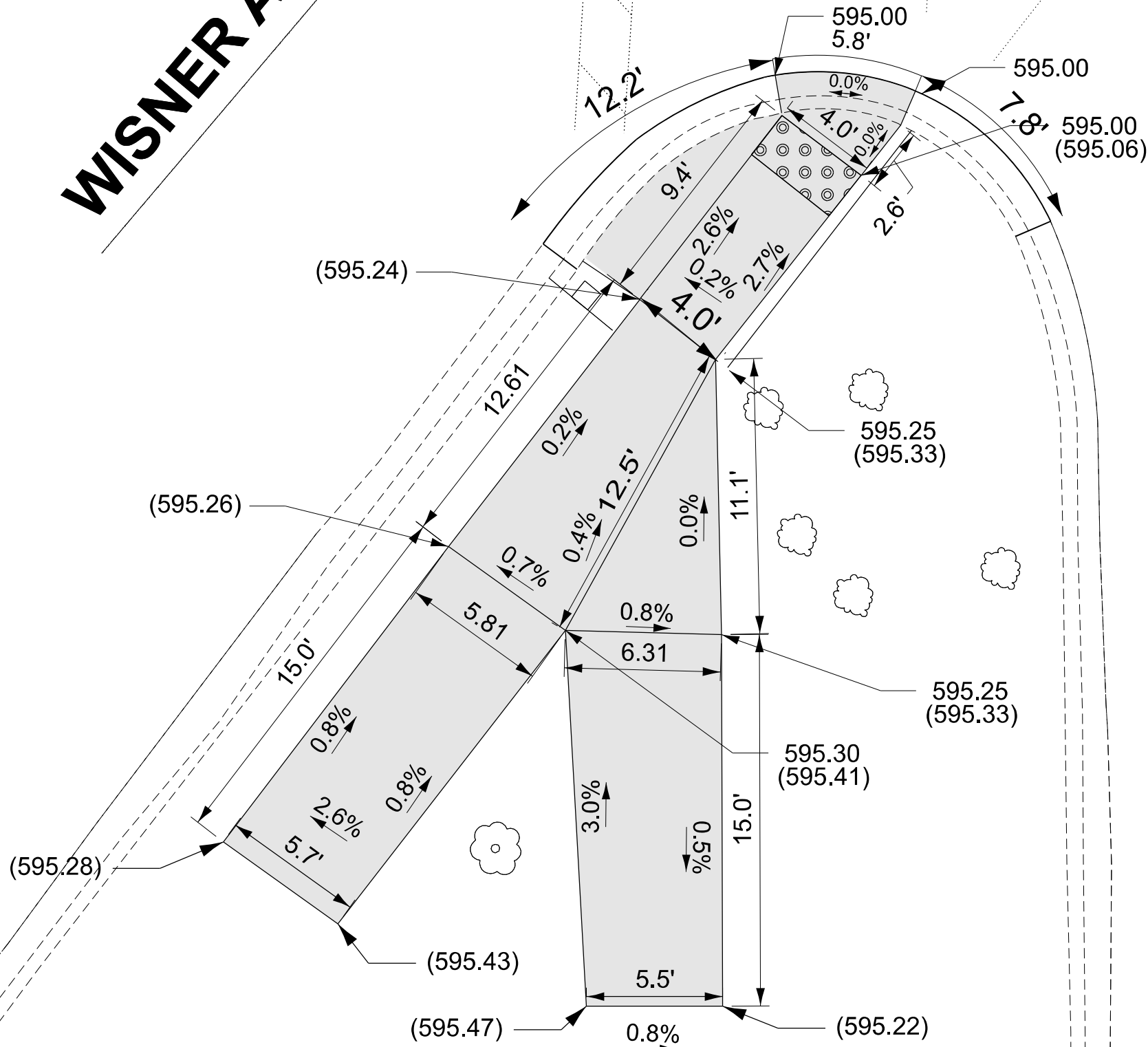

LEGEND

XX.XX'

EXISTING LENGTH

PROPOSED SIDE CURB

()

EXISTING ELEVATION/SLOPE



PROPOSED SIDEWALK



DETECTABLE WARNINGS



SIDEWALK REMOVAL
REPLACE W/TOPSOIL & SOD

STATE OF ILLINOIS
DEPARTMENT OF TRANSPORTATION

ADA IMPROVEMENT DETAILS
KIMBALL AVE AT WISNER AVE

SCALE: SHEET 3 OF 3 SHEETS STA. 0+00.00 TO STA. 0+00.00

F.A.U. RTE.	SECTION	COUNTY	TOTAL SHEETS	SHEET NO.
3728	2001-142RS	COOK	26	9
CONTRACT NO. 62321				
ILLINOIS FED. AID PROJECT				

USER NAME = merlin.jose	DESIGNED -	REVISED -
	DRAWN -	REVISED -
	CHECKED -	REVISED -
PLOT DATE = 7/11/2025	DATE -	REVISED -

MODEL: BD-08 [Sheet]
FILE NAME: c:\pav_work\pavtoillinois.gov_merlin.jose@illinois.gov\1107871\144901-shft-DistSigs.dgn

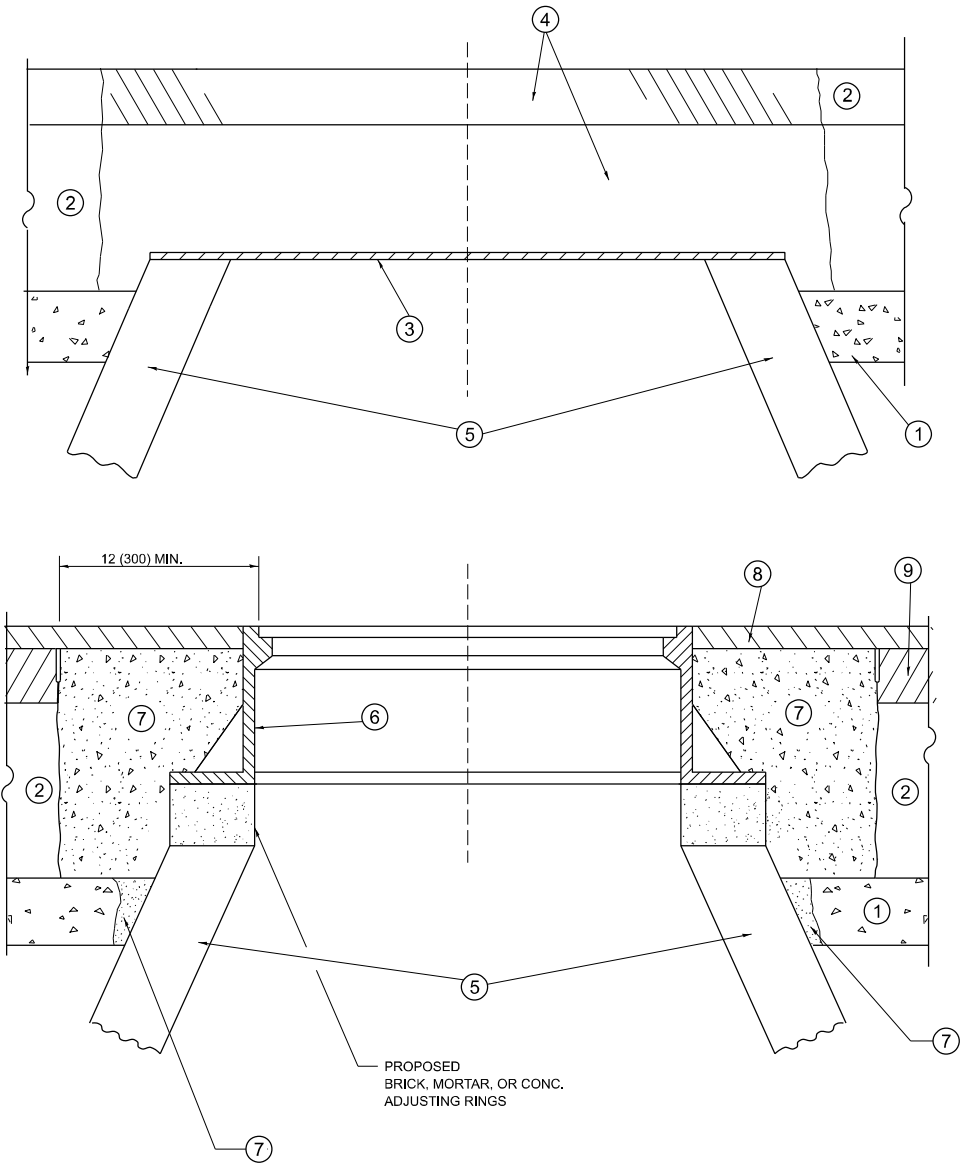

**DETAILS FOR FRAMES AND LIDS ADJUSTMENT
WITH MILLING**

NOTES

- EXISTING BROKEN FRAMES AND LIDS SHALL BE REMOVED AND DISPOSED OF BY THE CONTRACTOR AND SHALL BE REPLACED AS DIRECTED BY THE ENGINEER. REPLACEMENT FRAMES AND LIDS WILL BE PAID FOR IN ACCORDANCE WITH ARTICLE 109.04 OF THE STANDARD SPECIFICATIONS UNLESS A SEPARATE PAY ITEM HAS BEEN PROVIDED.
- IF THE EXISTING LIDS ARE OPEN, THE FRAME WILL BE ADJUSTED TO THE ELEVATION OF THE MILLED PAVEMENT SURFACE PRIOR TO THE MILLING OPERATION. THE FRAME WILL NOT BE REMOVED AND COVERED BY THE METAL PLATE.
- CITY OF CHICAGO CASTINGS ARE THE PROPERTY OF THE CITY AND THE CONTRACTOR SHALL NOTIFY THE CITY FOR REMOVAL AND DISPOSITION OF THE CASTINGS.
- THE METAL PLATE USED TO COVER THE STRUCTURE SHALL REMAIN THE PROPERTY OF THE CONTRACTOR.
- THE CONTRACTOR SHALL REMOVE ALL TRAFFIC CONTROL DEVICES BY THE END OF EACH WORK SHIFT.

CONSTRUCTION PROCEDURES

STAGE 1 (BEFORE PAVEMENT MILLING)

- REMOVE A MINIMUM OF 12 (300) OF THE PAVEMENT FROM AROUND THE STRUCTURE.
- REMOVE THE EXISTING FRAME AND LID FROM THE STRUCTURE.
- COVER THE STRUCTURE OPENING WITH A 36 (900) DIAMETER METAL PLATE.
- BACKFILL WITH CRUSHED STONE AND HMA SURFACE MIX APPROVED BY THE ENGINEER. (MIN. 3 (80) HMA TO REMAIN AFTER MILLING).

STAGE 2 (AFTER PAVEMENT MILLING)

- REMOVE THE HMA SURFACE MIX AND CRUSHED STONE.
- INSTALL THE FRAME AND LID; ADJUST THE FRAME TO ITS FINAL SURFACE ELEVATION.
- THE SURROUNDING SPACE SHALL BE FILLED WITH CLASS PP-2* CONCRETE TO THE ELEVATION OF THE SURFACE OF THE EXISTING BASE COURSE OR THE BINDER COURSE.

*UNLESS OTHERWISE SPECIFIED IN THE PLANS.

THE PROCEDURE EXPLAINED ABOVE SHALL CONFORM TO THE APPLICABLE PORTIONS OF SECTIONS 353, 406, 602, AND 603 OF THE STANDARD SPECIFICATIONS EXCEPT THAT "THE CONTRACTOR SHALL ADJUST THE STRUCTURES TO THE FINISHED PAVEMENT ELEVATION NO MORE THAN 5 CALENDAR DAYS PRIOR TO PLACEMENT OF THE FINAL LIFT OF SURFACE UNLESS APPROVED BY THE ENGINEER."

LEGEND

- | | |
|--|-------------------------------|
| ① SUB-BASE GRANULAR MATERIAL | ⑥ FRAME AND LID (SEE NOTES) |
| ② EXISTING PAVEMENT | ⑦ CLASS PP-2* CONCRETE |
| ③ 36 (900) DIAMETER METAL PLATE | ⑧ PROPOSED HMA SURFACE COURSE |
| ④ PROPOSED CRUSHED STONE AND HMA SURFACE MIX | ⑨ PROPOSED HMA BINDER COURSE |
| ⑤ EXISTING STRUCTURE | |

LOCATION OF STRUCTURES

THE CONTRACTOR WILL BE REQUIRED TO KEEP A RECORD OF THE LOCATIONS OF THE BURIED STRUCTURES ACCORDING TO THE STATION AND DISTANCE LEFT OR RIGHT OF THE CENTERLINE OF PAVEMENT. UPON COMPLETION OF THE WORK, THE CONTRACTOR WILL DELIVER THE RECORD TO THE ENGINEER.

BASIS OF PAYMENT

- REMOVING FRAMES AND LIDS ON DRAINAGE AND UTILITY STRUCTURES IN THE PAVEMENT PRIOR TO MILLING, AND ADJUSTING TO FINAL GRADE PRIOR TO PLACING THE SURFACE COURSE, WILL BE PAID FOR AT THE CONTRACT UNIT PRICE EACH FOR "FRAMES AND LIDS TO BE ADJUSTED (SPECIAL)."
- THIS WORK WILL NOT BE PAID FOR WHEN DRAINAGE AND UTILITY STRUCTURES ARE SPECIFIED FOR PAYMENT AS STRUCTURE RECONSTRUCTION.
- NEW FRAMES AND LIDS, WHEN SPECIFIED, WILL BE PAID FOR SEPARATELY.
- WHEN STRUCTURES ARE TO BE ADJUSTED OR RECONSTRUCTED, THE LOWERING AND RAISING OF THE FRAMES AND LIDS WILL NOT BE PAID FOR SEPARATELY BUT WILL BE INCLUDED IN THE COST OF THE CORRESPONDING PAY ITEM.

ALL DIMENSIONS ARE IN INCHES (MILLIMETERS) UNLESS OTHERWISE SHOWN

	USER NAME = Merlin.Jose	DESIGNED - R. SHAH	REVISED - R. BORO 03-09-11	STATE OF ILLINOIS DEPARTMENT OF TRANSPORTATION	DETAILS FOR FRAMES AND LIDS ADJUSTMENT WITH MILLING			F.A.U RTE.	SECTION	COUNTY	TOTAL SHEETS	SHEET NO.
		DRAWN -	REVISED - R. BORO 12-06-11					3728	2001-142RS	COOK	26	10
		CHECKED -	REVISED - K. SMITH 11-18-22		BD600-03 (BD-08)			CONTRACT NO. 62321				
	PLOT DATE = 7/17/2025	DATE - 10-25-94	REVISED - K. SMITH 09-15-23		SCALE: NONE	SHEET 1	OF 1 SHEETS	STA.	TO STA.	ILLINOIS FED. AID PROJECT		

METHOD OF MEASUREMENT

REFER TO SECTION 442 OF THE STANDARD SPECIFICATIONS FOR ROAD AND BRIDGE CONSTRUCTION AND THE RECURRING SPECIAL PROVISION "PATCHING WITH HOT-MIX ASPHALT OVERLAY REMOVAL."

BASIS OF PAYMENT

- 1. REFER TO SECTION 442 OF THE STANDARD SPECIFICATIONS FOR ROAD AND BRIDGE CONSTRUCTION AND THE RECURRING SPECIAL PROVISION "PATCHING WITH HOT-MIX ASPHALT OVERLAY REMOVAL."
- 2. SAW CUT/SCORING OF EXISTING HMA OVERLAY IS INCLUDED IN THE COST OF PAVEMENT PATCHING.
- 3. SAW CUT/SCORING OF EXISTING PAVEMENT IS INCLUDED IN THE COST OF PAVEMENT PATCHING.

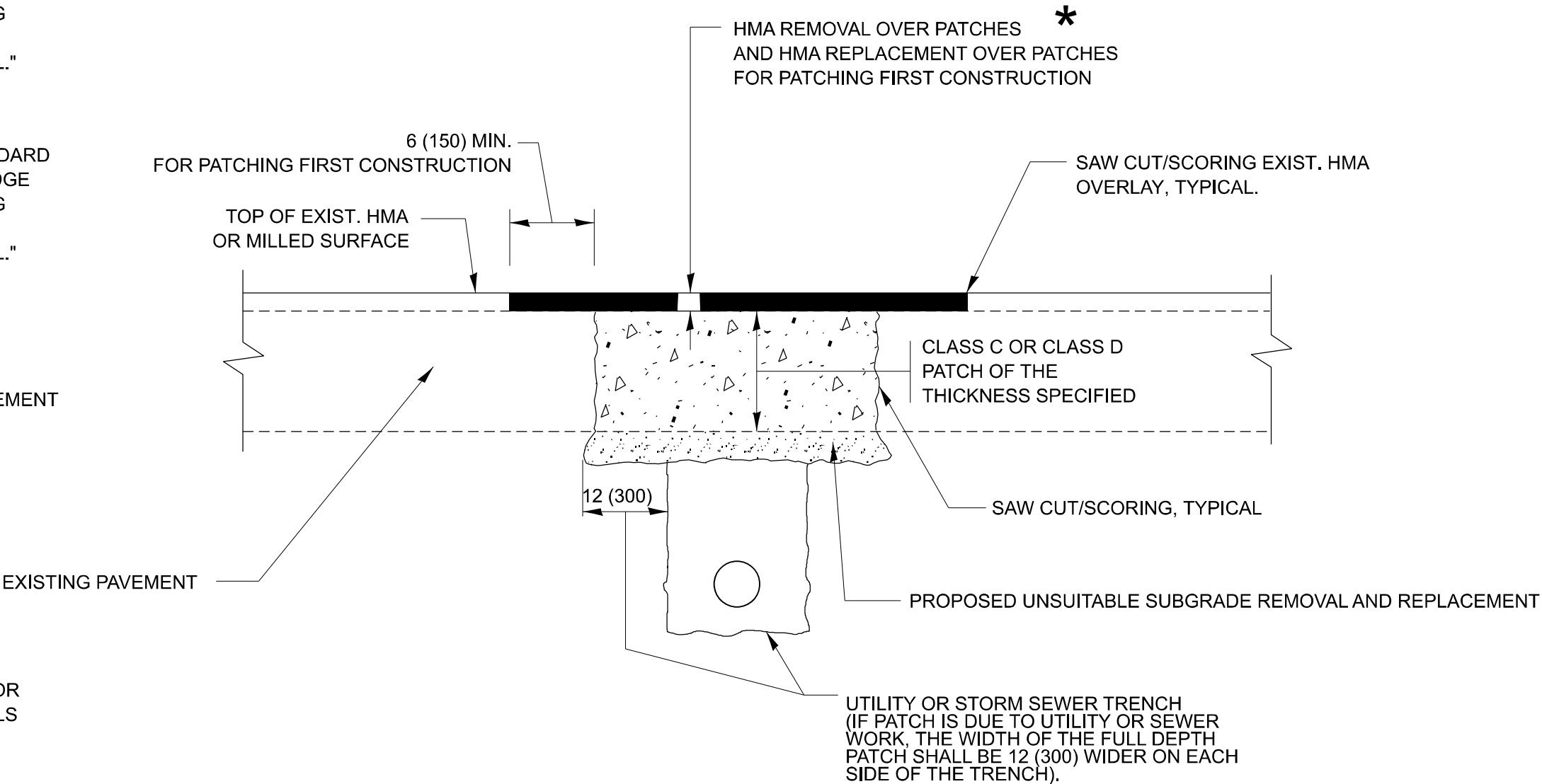

* SEE TYPICAL SECTIONS FOR THICKNESS AND MATERIALS

SEQUENCE OF CONSTRUCTION (PATCHING FIRST)

- 1. REMOVE THE EXISTING HMA MATERIAL OVER THE AREA TO BE PATCHED.
- 2. REMOVE AND REPLACE WITH CLASS C OR D PATCH.
- 3. REPLACE HMA MATERIAL OVER THE AREA TO BE PATCHED.

SEQUENCE OF CONSTRUCTION (MILLING FIRST)

- 1. MILL HMA FIRST IF THERE IS AT LEAST 4 1/2 INCHES OR MORE OF HMA MATERIAL ON TOP OF THE EXISTING PAVEMENT OR IF THE PAVEMENT IS FULL DEPTH HMA. A MINIMUM OF 2 INCHES OF HMA MATERIAL SHALL BE IN PLACE AFTER MILLING.
- 2. REMOVE AND REPLACE WITH FULL DEPTH CLASS D PATCHES TO TOP OF MILLED SURFACE.

ALL DIMENSIONS ARE IN INCHES (MILLIMETERS) UNLESS OTHERWISE SHOWN.

MODEL: BD-22 (Sheet)
FILE NAME: c:\pav_work\pav\illinois.gov\11078710\144901-shr-DistStds.dgn

	USER NAME = merin,jose	DESIGNED - R. SHAH	REVISED - R. BORO 01-01-07	STATE OF ILLINOIS DEPARTMENT OF TRANSPORTATION	PAVEMENT PATCHING FOR HMA SURFACED PAVEMENT				F.A.U RTE.	SECTION	COUNTY	TOTAL SHEETS	SHEET NO.
		DRAWN -	REVISED - R. BORO 09-04-07						3728	2001-142RS	COOK	26	11
		CHECKED -	REVISED - K. ENG 10-27-08						BD400-04 (BD-22)		CONTRACT NO. 62321		
	PLOT DATE = 7/11/2025	DATE - 10-25-94	REVISED - K. SMITH 11-18-22		ILLINOIS FED. AID PROJECT								
					SCALE: NONE	SHEET 1	OF 1	SHEETS	STA.	TO STA.			

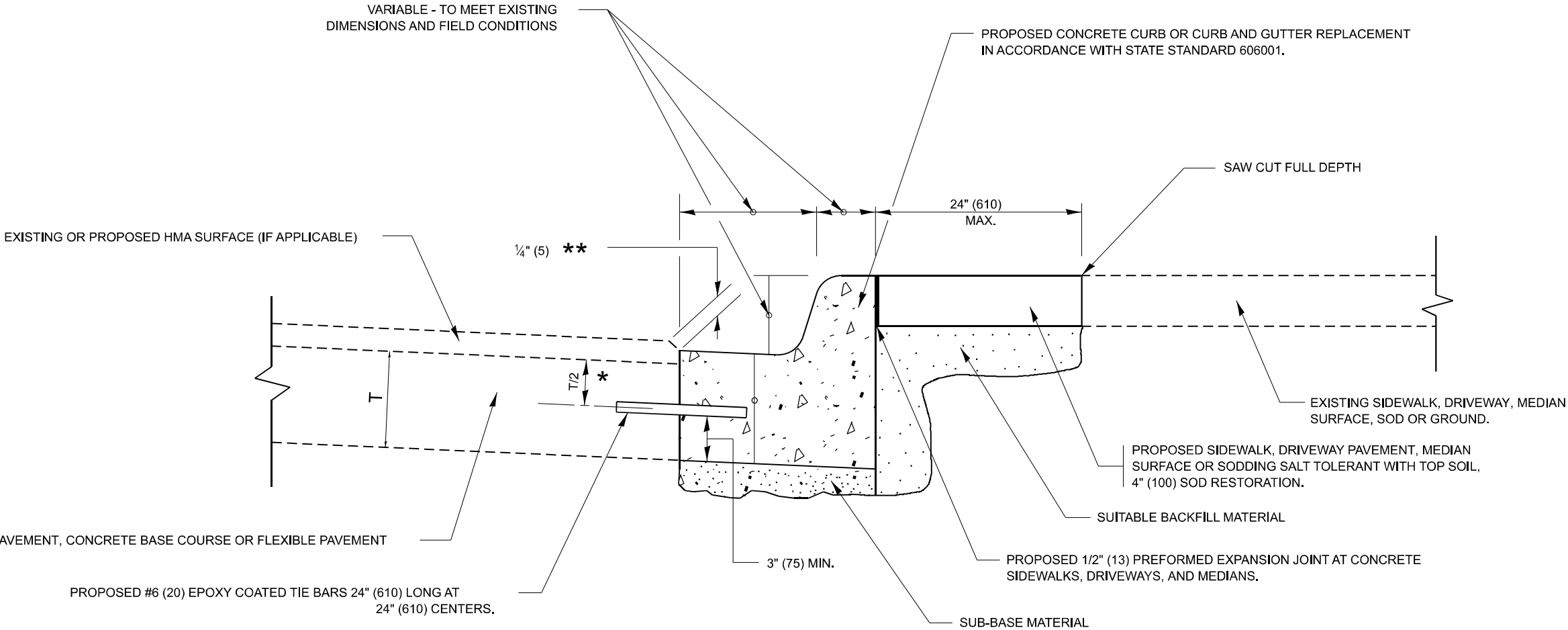

- * 3" (75) MINIMUM FROM TOP AND BOTTOM OF THE CONCRETE PAVEMENT OR BASE COURSE.
- ** IF THE FINAL SURFACE OF THE PAVEMENT IS CONCRETE, THE GUTTER IS TO BE FLUSH WITH THE PAVEMENT.

CURB OR CURB AND GUTTER REMOVAL AND REPLACEMENT

ALL DIMENSIONS ARE IN INCHES (MILLIMETERS)
UNLESS OTHERWISE SHOWN.

MODEL: BD-24 [Sheet]
FILE NAME: c:\paw\work\paw\illinois.gov\merin.jose\illinois.gov\1107871\10144901-shr-dist\stds.dgn

	USER NAME = Merin,Jose	DESIGNED - A. HOUSEH	REVISED - A. ABBAS 03-21-97	STATE OF ILLINOIS DEPARTMENT OF TRANSPORTATION	CURB OR CURB AND GUTTER REMOVAL AND REPLACEMENT					F.A.U RTE.	SECTION	COUNTY	TOTAL SHEETS	SHEET NO.
		DRAWN -	REVISED - M. GOMEZ 01-22-01							3728	2001-142RS	COOK	26	12
		CHECKED -	REVISED - R. BORO 12-15-09							BD600-06 (BD-24)				
	PLOT DATE = 7/17/2025	DATE - 03-11-94	REVISED - K. SMITH 07-11-19		SCALE: NONE		SHEET 1	OF 1	SHEETS	STA.	TO STA.			
							ILLINOIS FED. AID PROJECT							

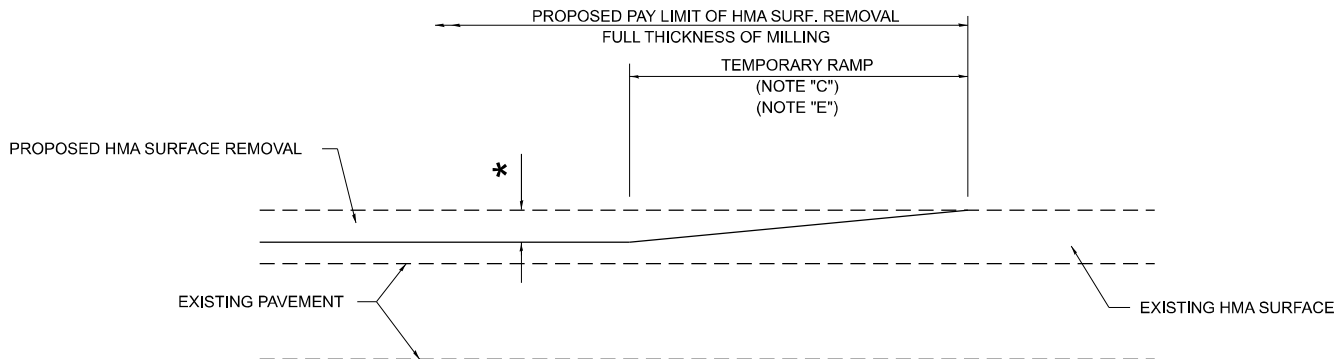

MILLED TEMPORARY RAMP
(FOR BUTT JOINT AND HMA TAPER SEE DETAIL BELOW)

OPTION 1

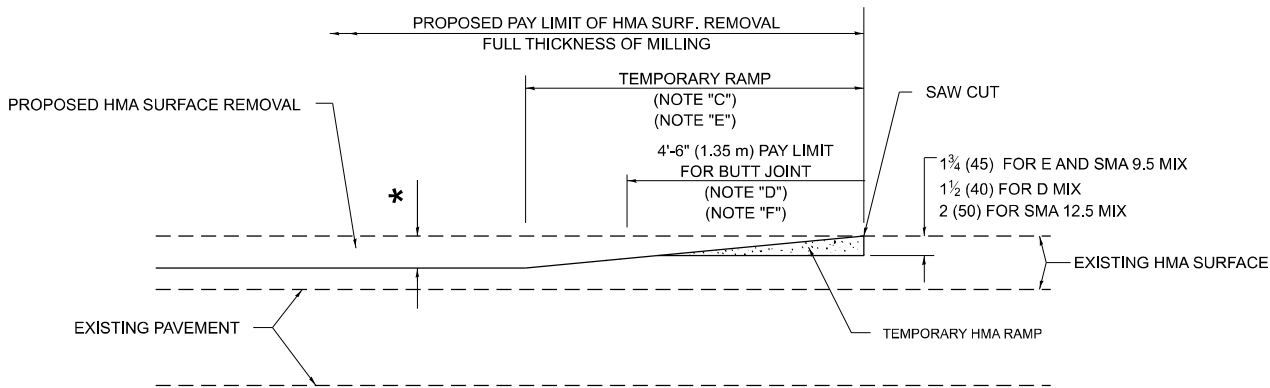

HMA CONSTRUCTED TEMPORARY RAMP
(FOR BUTT JOINT AND HMA TAPER SEE DETAIL BELOW)

OPTION 2

TYPICAL TEMPORARY RAMP

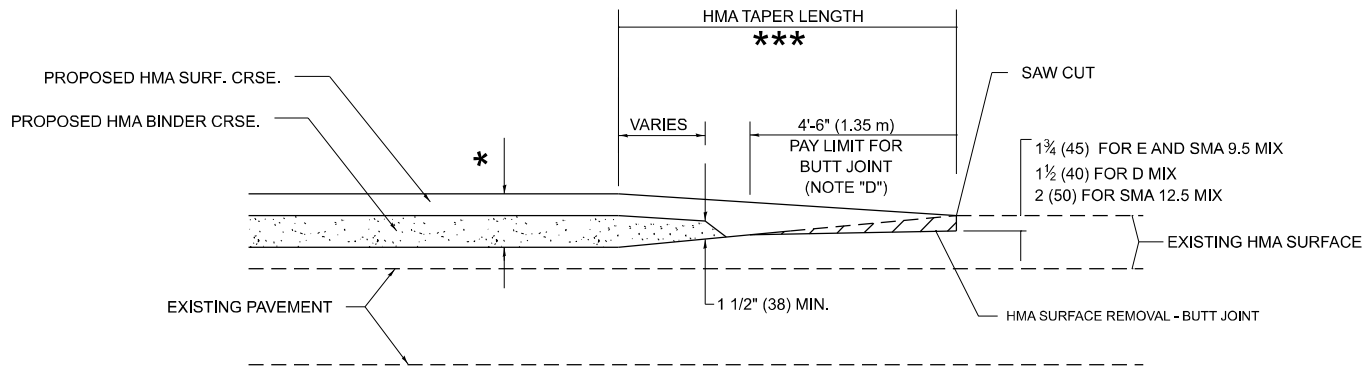

**BUTT JOINT AND
HMA TAPER**

**TYPICAL BUTT JOINT AND HMA TAPER
FOR MILLING AND RESURFACING**

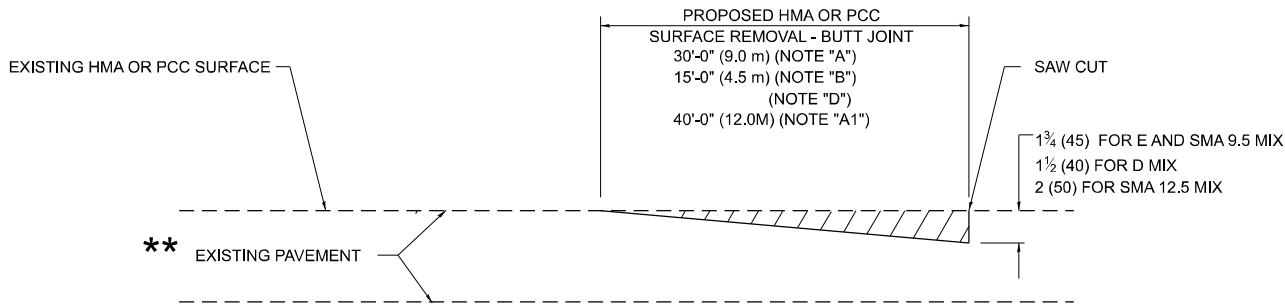

BUTT JOINT DETAIL

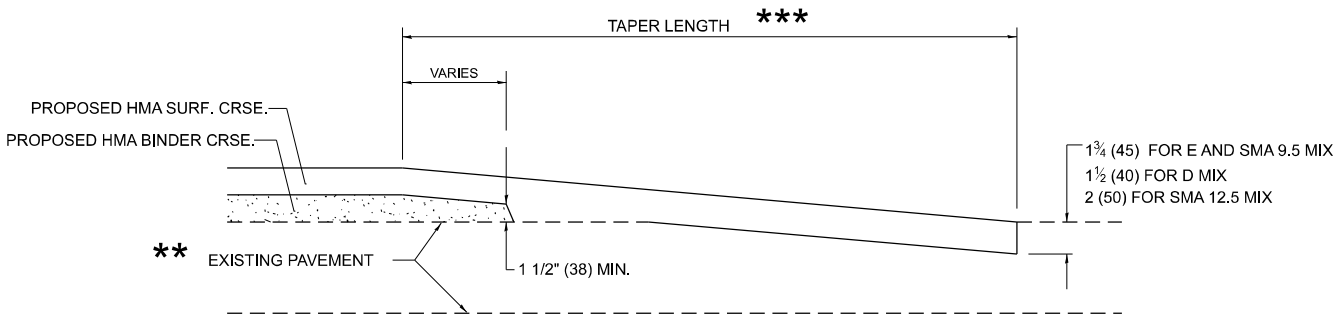

HMA TAPER DETAIL

**TYPICAL BUTT JOINT AND HMA TAPER
FOR RESURFACING ONLY**

****** PC CONCRETE, HMA OR HMA RESURFACED PAVEMENT.

GENERAL NOTES

- A. MAINLINE ARTERIAL ROADWAYS AND MAJOR SIDE ROADS.
- A1. INTERSTATES
- B. MINOR SIDE ROADS.
- C. THE TEMP. RAMP SHALL BE CONSTRUCTED IMMEDIATELY UPON REMOVAL OF THE EXISTING HMA SURFACE.
- D. THE BUTT JOINT SHALL BE CONSTRUCTED IMMEDIATELY PRIOR TO PLACING THE PROPOSED HMA COURSES.
- E. TAPER THE TEMP. RAMP AT A RATE OF 3' - 4" (1.02m) PER 1 INCH (25 mm) OF MILLING THICKNESS.
***** SEE TYPICAL SECTIONS FOR MILLING THICKNESS.
- F. SEE ARTICLE 406.08 AND 406.14 OF THE STANDARD SPECIFICATIONS FOR "HMA AND/OR PCC SURFACE REMOVAL, BUTT JOINT".

20'-0" (6.1 m) PER 1 (25) RESURFACING (NOTE "A")
10'-0" (3.0 m) PER 1 (25) RESURFACING (NOTE "B")

BASIS OF PAYMENT

- 1. THE BUTT JOINT WILL BE PAID FOR AT THE CONTRACT UNIT PRICE PER SQUARE YARD (SQUARE METER) FOR "HOT-MIX ASPHALT SURFACE REMOVAL - BUTT JOINT" OR FOR "PORTLAND CEMENT CONCRETE SURFACE REMOVAL- BUTT JOINT".
- 2. THE TEMPORARY RAMP AND SAW CUT SHALL BE INCLUDED IN THE UNIT COST FOR HMA OR PCC SURFACE REMOVAL-BUTT JOINT.

ALL DIMENSIONS ARE IN INCHES (MILLIMETERS) UNLESS OTHERWISE SHOWN.

MODEL: BD-32 [Sheet]
FILE NAME: c:\pav_work\pav\dist\illinois.gov_merlin.jose@illinois.gov\110787\10144901-shr-dist\Std.dgn

PLOT DATE = 7/17/2025	USER NAME = Merlin,Jose	DESIGNED - M. DE YONG	REVISED - A. ABBAS 03-21-97
		DRAWN -	REVISED - M. GOMEZ 04-06-01
		CHECKED -	REVISED - R. BORO 01-01-07
	DATE - 06-13-90		REVISED - K. SMITH 11-18-22

STATE OF ILLINOIS
DEPARTMENT OF TRANSPORTATION

**BUTT JOINT AND
HMA TAPER DETAILS**

SCALE: NONE SHEET 1 OF 1 SHEETS STA. TO STA.

F.A.U RTE.	SECTION	COUNTY	TOTAL SHEETS	SHEET NO.
3728	2001-142RS	COOK	26	13
BD400-05 BD-32		CONTRACT NO. 62321		
		ILLINOIS	FED. AID PROJECT	

STRAIGHT DETECTABLE WARNING UNITS

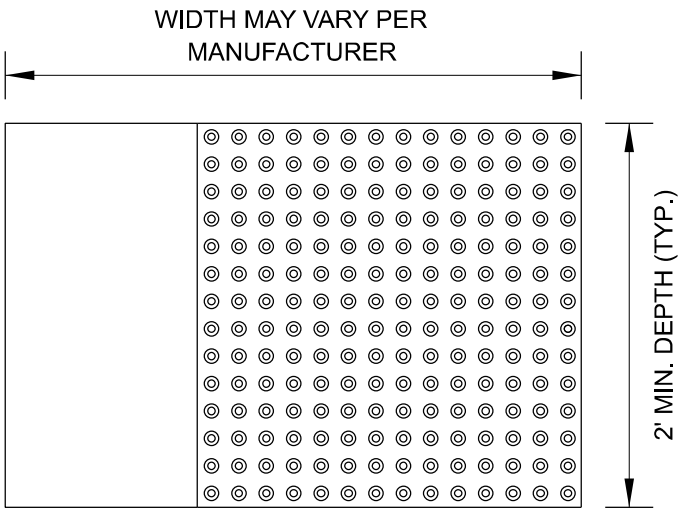

RADIAL DETECTABLE WARNING UNITS

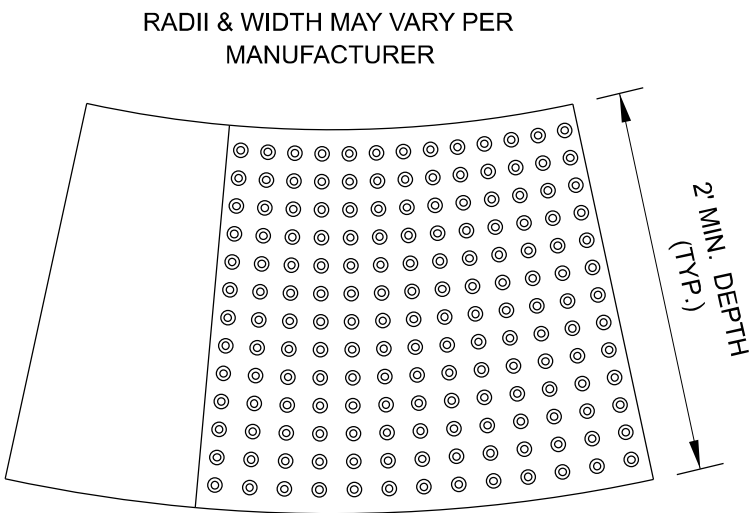

DETECTABLE WARNING UNIT SIZES

- VERIFY ALL DIMENSIONS WITH THE PRODUCT MANUFACTURER.
- IF USING RADIAL UNITS, VERIFY THAT THE CURB RADIUS MATCHES AVAILABLE UNIT RADII WITH THE PRODUCT MANUFACTURER.

GENERAL NOTE:
THE ROWS OF DOMES IN THE DETECTABLE WARNING MATERIAL MUST BE ALIGNED WITH THE PATH OF WHEELCHAIR TRAVEL WHICH IS REQUIRED TO BE PERPENDICULAR TO THE GRADE BREAK AT THE BOTTOM OF THE RAMP TO PERMIT TRACKING BETWEEN DOME ROWS. ON BLENDED TRANSITIONS OR FLUSH TRANSITIONS, WHERE RADIAL UNITS ARE SITUATED ABOUT THE CURB RADIUS, DOME ORIENTATION IS NOT SIGNIFICANT.

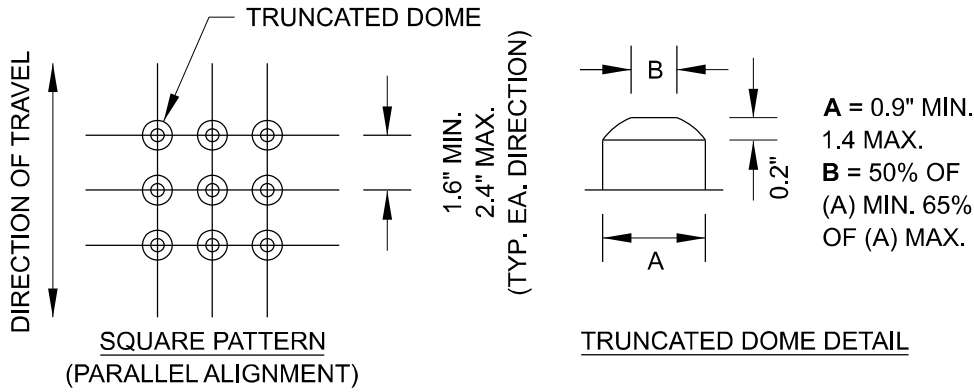

UNIT PATTERN & DOME DETAIL

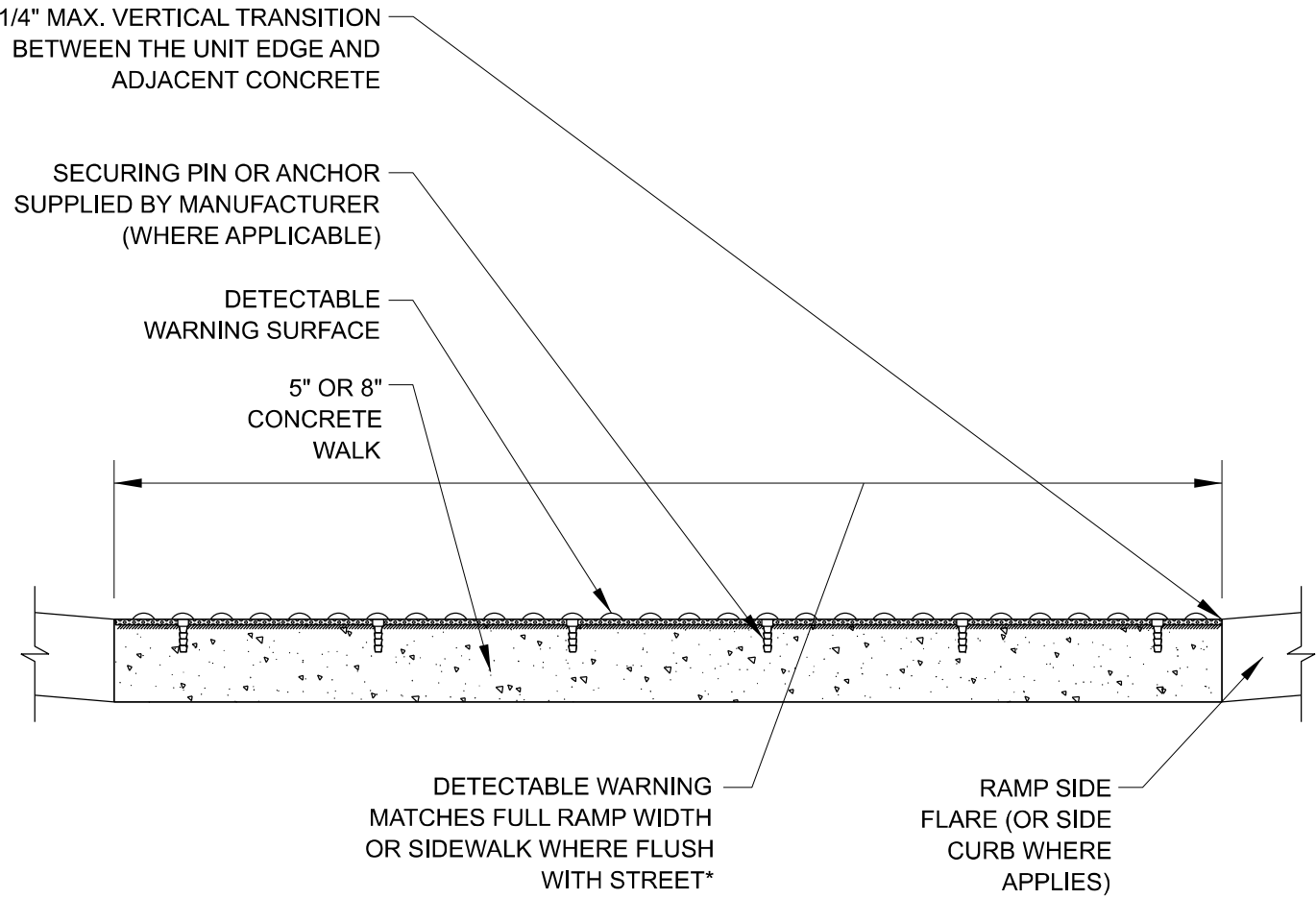

*A BORDER OF 2 INCHES OR LESS AROUND THE DETECTABLE WARNING SURFACE IS ACCEPTABLE IF REQUIRED FOR PROPER INSTALLATION OF THE DETECTABLE WARNING SURFACE PRODUCT

DETECTABLE WARNING UNIT SECTION

MODEL: BD-58 (Sheet)
FILE NAME: c:\paw_work\paw\illinois.gov_merlin.jose@illinois.gov\1107871\144901-shr-Dist\Sigs.dgn

	USER NAME = Merin,Jose	DESIGNED -	REVISED -	STATE OF ILLINOIS DEPARTMENT OF TRANSPORTATION	CITY OF CHICAGO DETECTABLE WARNINGS				F.A.U RTE.	SECTION	COUNTY	TOTAL SHEETS	SHEET NO.
		DRAWN -	REVISED -						3728	2001-142RS	COOK	26	14
		CHECKED -	REVISED -						BD 58		CONTRACT NO. 62321		
	PLOT DATE = 7/17/2025	DATE - 06-20-2017	REVISED -						ILLINOIS FED. AID PROJECT				
					SCALE: NONE	SHEET 1	OF 1 SHEETS	STA.	TO STA.				

MODEL: TC-10 (Sheet)
FILE NAME: c:\p\work\pwt\illinois.gov_merlin.jose@illinois.gov\11078710\144901-shr-DistStd.dgn

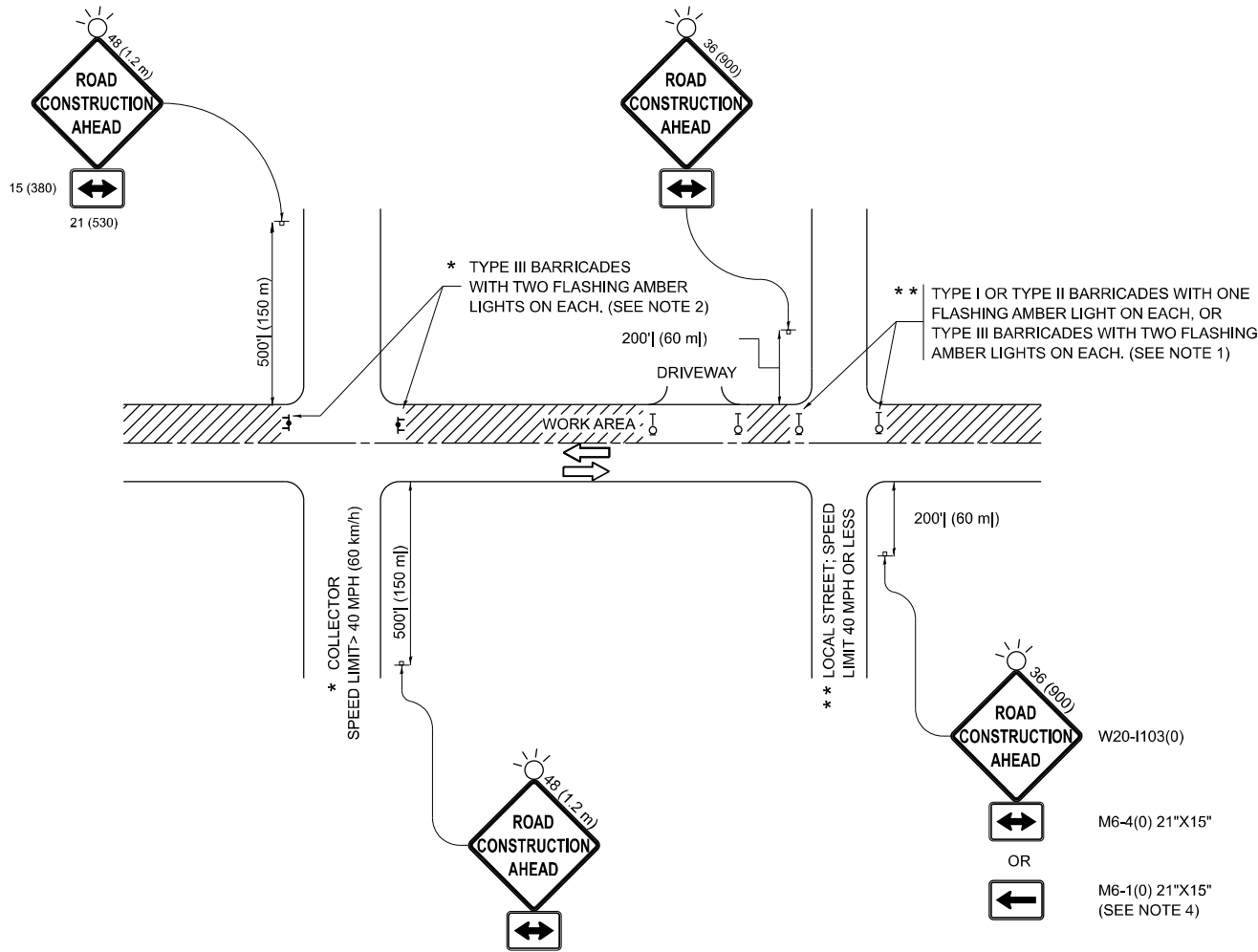

NOTES:

- SIDE ROAD WITH A SPEED LIMIT OF 40 MPH (60 km/h) OR LESS AS SHOWN ON THE DRAWING AND AS DIRECTED BY THE ENGINEER:
 - ONE "ROAD CONSTRUCTION AHEAD" SIGN 36 x 36 (900x900) WITH A FLASHER MOUNTED ON IT APPROXIMATELY 200' (60 m) IN ADVANCE OF THE MAIN ROUTE.
 - THE CLOSED PORTION OF THE MAIN ROUTE SHALL BE PROTECTED BY BLOCKING WITH TYPE I, TYPE II OR TYPE III BARRICADES, 1/3 OF THE CROSS SECTION OF THE CLOSED PORTION.
- SIDE ROAD WITH A SPEED LIMIT GREATER THAN 40 MPH (60 km/h) AS SHOWN ON THE DRAWING AND AS DIRECTED BY THE ENGINEER:
 - ONE "ROAD CONSTRUCTION AHEAD" SIGN 48 x 48 (1.2 m x 1.2 m) WITH A FLASHER MOUNTED ON IT APPROXIMATELY 500' (150 m) IN ADVANCE OF THE MAIN ROUTE.
 - THE CLOSED PORTION OF THE MAIN ROUTE SHALL BE PROTECTED BY BLOCKING WITH TYPE III BARRICADES, 1/2 OF THE CROSS SECTION OF THE CLOSED PORTION.
- CONES MAY BE SUBSTITUTED FOR BARRICADES OR DRUMS AT HALF THE SPACING DURING DAY OPERATIONS. CONES SHALL BE A MINIMUM OF 28 (710) IN HEIGHT.
- WHEN THE SIDE ROAD LIES BETWEEN THE BEGINNING OF THE MAINLINE SIGNING AND THE WORK ZONE, A SINGLE HEADED ARROW (M6-1) SHALL BE USED IN LIEU OF THE DOUBLE HEADED ARROW (M6-4).
- WHEN WORK IS BEING PERFORMED ON A SIDE ROAD OR DRIVEWAY, FOLLOW THE APPLICABLE STANDARD(S). THE DIRECTIONAL ARROW (M6-1 OR M6-4) SHALL BE COVERED OR REMOVED WHEN NO LONGER CONSISTENT WITH THE TRAFFIC CONTROL SET-UP.
- ADVANCE WARNING SIGNS ARE TO BE OMITTED ON DRIVEWAYS UNLESS OTHERWISE SPECIFIED IN THE PLANS OR BY THE ENGINEER.
- THE TRAFFIC CONTROL AND PROTECTION FOR SIDE ROADS, INTERSECTIONS, AND DRIVEWAYS SHALL BE INCLUDED IN THE COST OF SPECIFIED TRAFFIC CONTROL STANDARDS OR ITEMS.

All dimensions are in inches (millimeters)
unless otherwise shown.

	USER NAME = Merin,Jose	DESIGNED - L.H.A.	REVISED - T. RAMMACHER 01-06-00	STATE OF ILLINOIS DEPARTMENT OF TRANSPORTATION	TRAFFIC CONTROL AND PROTECTION FOR SIDE ROADS, INTERSECTIONS, AND DRIVEWAYS	SCALE:	SHEET	OF	SHEETS	STA.	TO STA.	F.A.U	SECTION	COUNTY	TOTAL	SHEET			
		DRAWN -	REVISED - A. SCHUETZE 07-01-13									3728	2001-142RS	COOK	26	15			
		CHECKED -	REVISED - A. SCHUETZE 09-15-06									TC-10					CONTRACT NO. 62321		
	PLOT DATE = 7/17/2025	DATE - 06-89	REVISED - D. SENDERAK 05-03-24									ILLINOIS FED. AID PROJECT							

TURN BAY ENTRANCE AT START
OF LANE CLOSURE TAPER

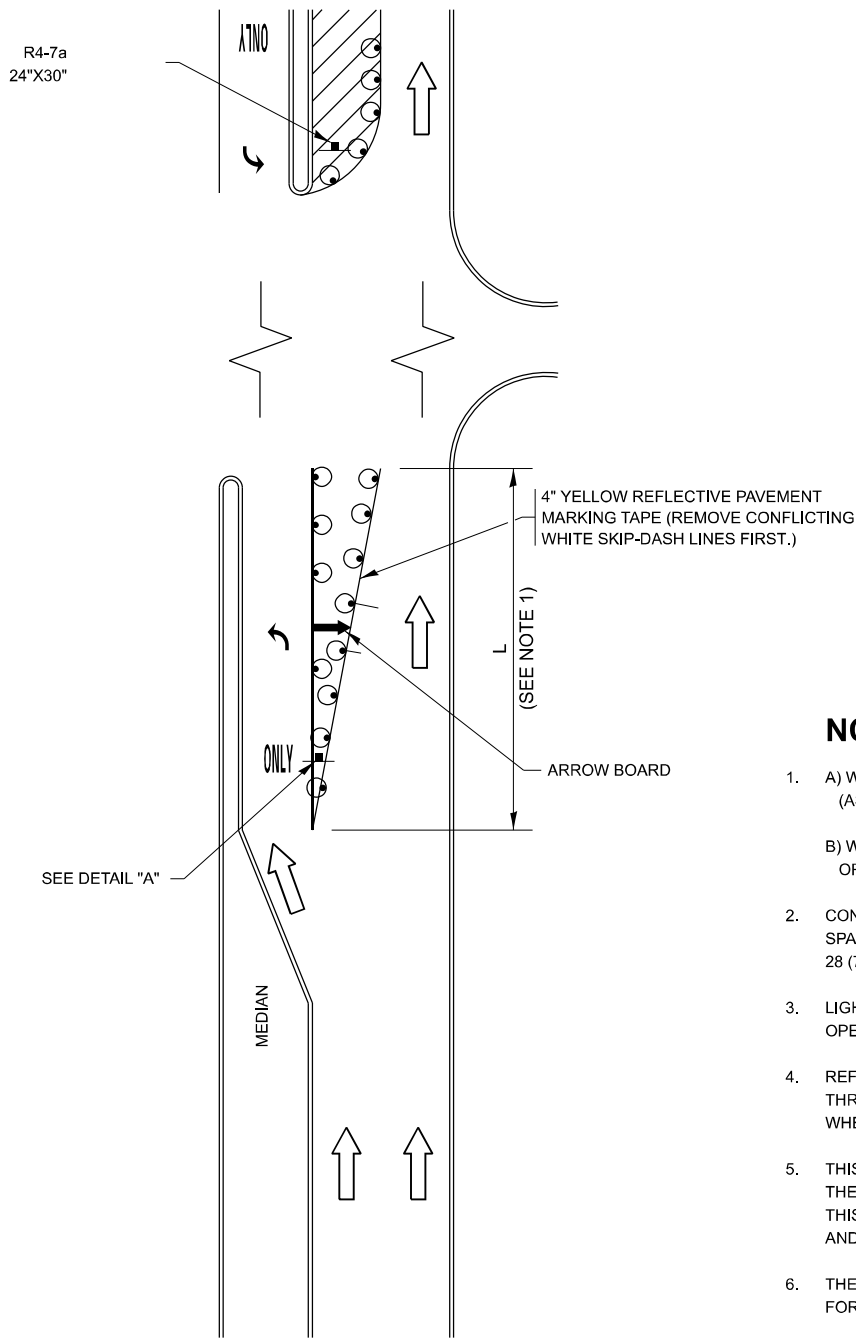
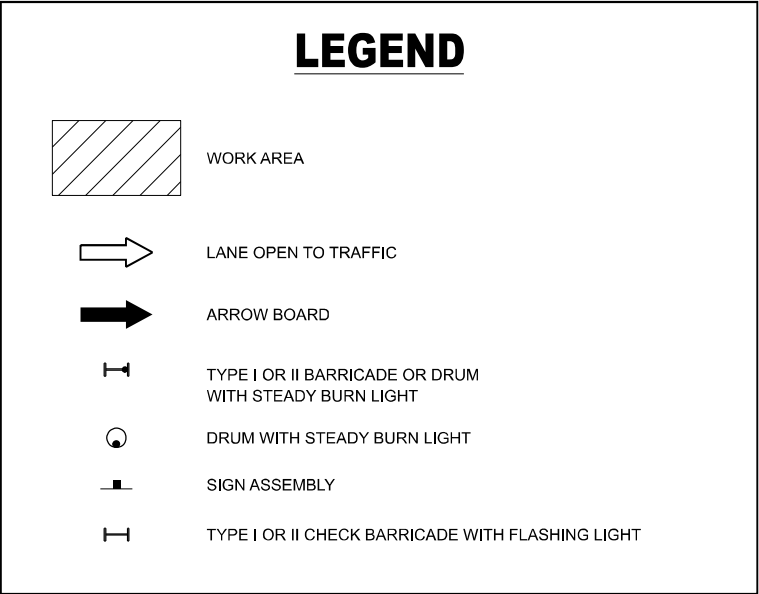

FIGURE 1

LEGEND



NOTES:

- A) WHEN "L" IS \leq THE STORAGE LENGTH OF THE TURN LANE (AS SHOWN IN FIG. 1), USE FIGURE 1.
B) WHEN "L" IS $>$ THE STORAGE LENGTH OF THE TURN LANE OR THE TURN LANE IS WITHIN THE LANE CLOSURE, USE FIGURE 2.
- CONES MAY BE SUBSTITUTED FOR BARRICADES OR DRUMS AT HALF THE SPACING DURING DAY OPERATIONS. CONES SHALL BE A MINIMUM OF 28 (710) IN HEIGHT.
- LIGHTS WILL NOT BE REQUIRED ON BARRICADES OR DRUMS FOR DAY OPERATIONS. ALL LIGHTS SHALL BE MONODIRECTIONAL.
- REFLECTIVE TEMPORARY PAVEMENT MARKINGS SHALL BE PLACED THROUGHOUT THE BARRICADED AREAS OF EACH TURN BAY AS SHOWN WHERE THE CLOSURE TIME IS GREATER THAN FOURTEEN (14) DAYS.
- THIS APPLICATION ALSO APPLIES WHEN WORK IS BEING PERFORMED IN THE RIGHT LANE(S) AND THE RIGHT TURN BAY IS TO REMAIN OPEN. UNDER THIS CONDITION, "RIGHT TURN LANE" R3-I100R 24 x 24 (600 x 600) AND M6-2R 21 x 15 (530 x 380) SHALL BE USED.
- THESE CONTROLS SHALL SUPPLEMENT MAINLINE TRAFFIC CONTROL FOR LANE CLOSURES.
- THE SIGNS SHALL BE MOUNTED ABOVE THE BARRICADES/DRUMS ON SEPARATE SIGN SUPPORTS THAT MEET NCHRP 350 OR MASH REQUIREMENTS.
- TRAFFIC CONTROL AND PROTECTION AT TURN BAYS (TO REMAIN OPEN TO TRAFFIC) SHALL BE INCLUDED IN THE COST OF SPECIFIED TRAFFIC CONTROL STANDARDS OR ITEMS.

TURN BAY ENTRANCE
WITHIN A LANE CLOSURE

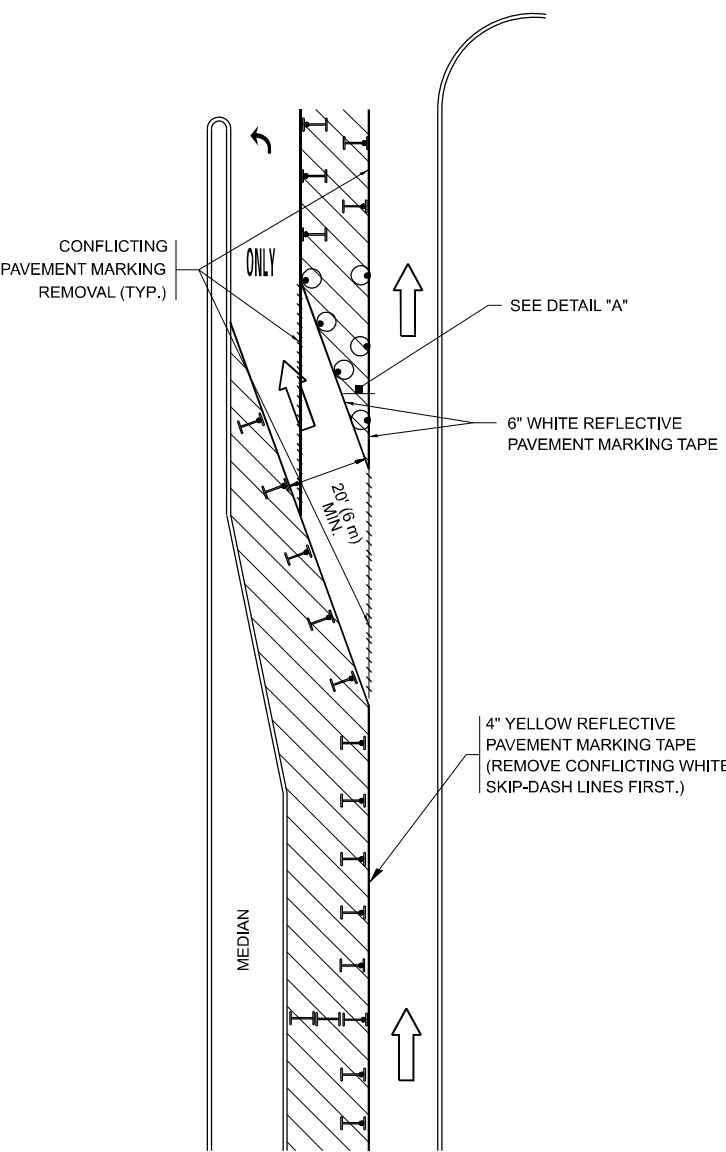
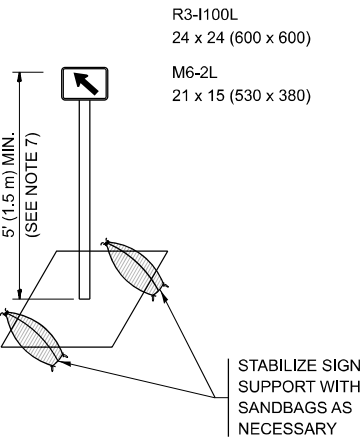

FIGURE 2



DETAIL A

All dimensions are in inches (millimeters) unless otherwise shown.

MODEL: TC-14 (Sheet)
FILE NAME: c:\p\work\pwork\illinois.gov_merlin.jose@illinois.gov\1107871014901-shr-dist\Sigs.dgn

USER NAME = Merlin.Jose	DESIGNED - T. RAMMACHER 09-08-94	REVISED - R. BORO 09-14-09
	DRAWN - A. HOUSEH 11-07-95	REVISED - A. SCHUETZE 07-01-13
	CHECKED - A. HOUSEH 10-12-96	REVISED - A. SCHUETZE 09-15-16
PLOT DATE = 7/17/2025	DATE - T. RAMMACHER 01-06-00	REVISED -

STATE OF ILLINOIS
DEPARTMENT OF TRANSPORTATION

TRAFFIC CONTROL AND PROTECTION AT TURN BAYS
(TO REMAIN OPEN TO TRAFFIC)

SCALE: NONE SHEET 1 OF 1 SHEETS STA. TO STA.

F.A.U RTE.	SECTION	COUNTY	TOTAL SHEETS	SHEET NO.
3728	2001-142RS	COOK	26	16
TC-14		CONTRACT NO. 62321		
ILLINOIS		FED. AID PROJECT		

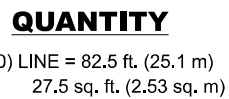
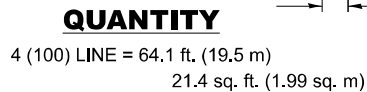
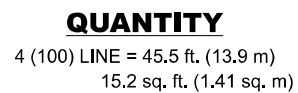

ALL QUANTITIES OF PLACEMENT ARE REPRESENTED
IN LINEAR FEET OF 4" LINES TO MATCH THE
4" TEMPORARY TAPE PAY ITEM AND REPRESENTS
THE TOTAL QUANTITY OF 4" TAPE REQUIRED.

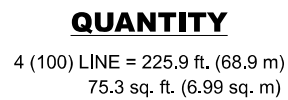

MODEL: TC-16 [Sheet]
FILE NAME: c:\pw_work\pwidot\illinois.gov_merin.jose@illinois.gov\d1107871ID144901-sh1-DistSids.dgn

USER NAME = Merin_Jose	DESIGNED -	REVISED - T. RAMMACHER 03-02-98
	DRAWN -	REVISED - E. GOMEZ 08-28-00
	CHECKED -	REVISED - E. GOMEZ 08-28-00
PLOT DATE = 7/17/2025	DATE - 09-18-94	REVISED - A. SCHUETZE 09-15-16

STATE OF ILLINOIS
DEPARTMENT OF TRANSPORTATION

SHORT TERM PAVEMENT MARKING LETTERS AND SYMBOLS

SCALE: NONE	SHEET 1 OF 1 SHEETS	STA. TO STA.
-------------	---------------------	--------------

F.A.U RTE.	SECTION	COUNTY	TOTAL SHEETS	SHEET NO.
3728	2001-142RS	COOK	26	17
TC-16		CONTRACT NO. 62321		
ILLINOIS		FED. AID PROJECT		

MODEL: TC-22 [Sheet]
FILE NAME: c:\p\work\pwrtd\illinois.gov_merlin.jose@illinois.gov\d1078710\144901-shr-DistSigs.dgn

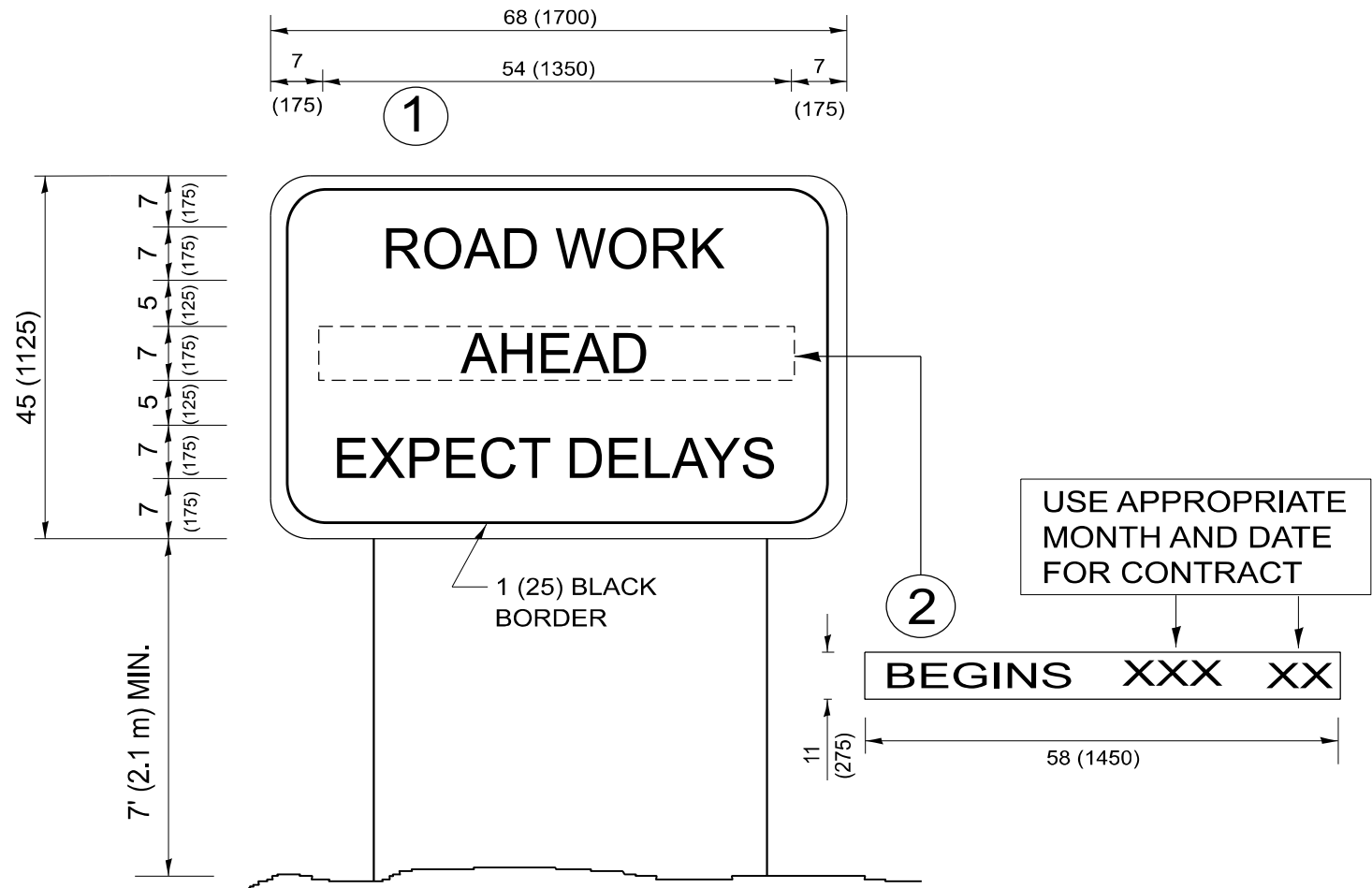

NOTES:

1. USE BLACK LETTERING ON ORANGE BACKGROUND.
2. ERECT SIGNS IN ADVANCE OF THE LOCATION FOR THE "ROAD CONSTRUCTION AHEAD" SIGN AT LOCATIONS AS DIRECTED BY THE ENGINEER.
3. ERECT SIGN ① WITH INSTALLED PANEL ② ONE WEEK PRIOR TO THE START OF CONSTRUCTION.
4. REMOVE PANEL ② SOON AFTER THE START OF CONSTRUCTION.
5. SEE SPECIAL PROVISION FOR "TEMPORARY INFORMATION SIGNING" FOR ADDITIONAL INFORMATION.
6. ONE SIGN ASSEMBLY EQUALS 25.70 SQ. FT. (2.3 SQ. M.)
7. SHALL BE PAID FOR AS TEMPORARY INFORMATION SIGNING.

ALL DIMENSIONS ARE IN INCHES (MILLIMETERS)
UNLESS OTHERWISE SHOWN.

	USER NAME = Merin,Jose	DESIGNED -	REVISED - R. MIRS 09-15-97	STATE OF ILLINOIS DEPARTMENT OF TRANSPORTATION	ARTERIAL ROAD INFORMATION SIGN				F.A.U RTE.	SECTION	COUNTY	TOTAL SHEETS	SHEET NO.
		DRAWN -	REVISED - R. MIRS 12-11-97						3728	2001-142RS	COOK	26	18
		CHECKED -	REVISED - T. RAMMACHER 02-02-99						TC-22				
	PLOT DATE = 7/17/2025	DATE -	REVISED - C. JUCIUS 01-31-07		ILLINOIS FED. AID PROJECT								
					SCALE: NONE	SHEET 1	OF 1	SHEETS	STA.	TO STA.			

MODEL: TC-24A (Sheet)
FILE NAME: c:\p\work\wv\illinois.gov\1107871\144901-shf-DistStd.dgn

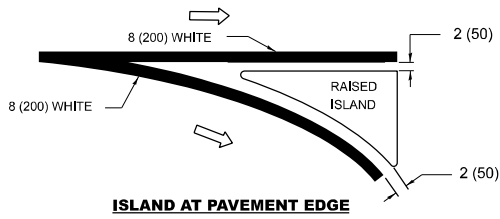
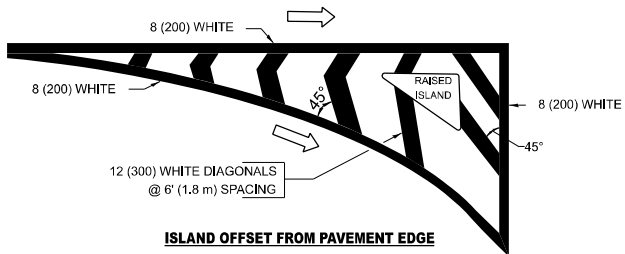
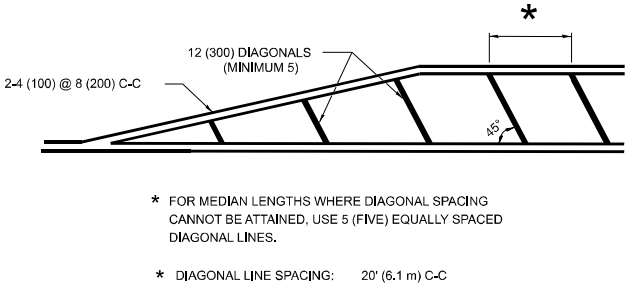
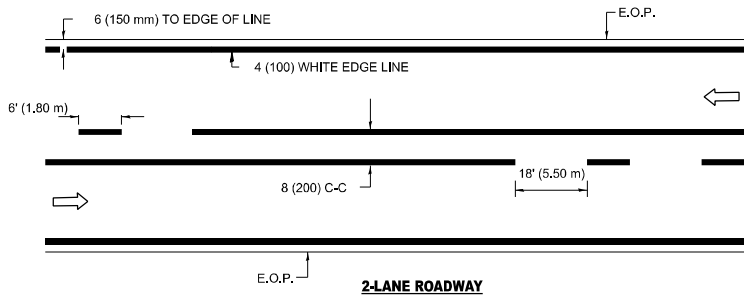

TYPICAL ISLAND MARKING

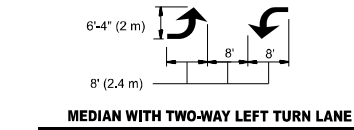
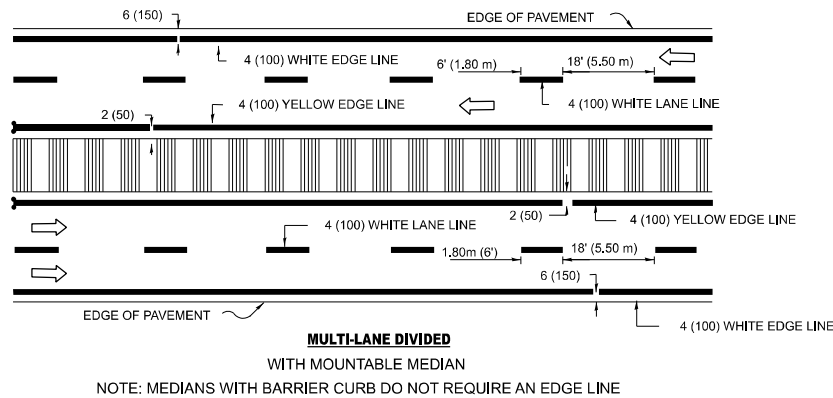
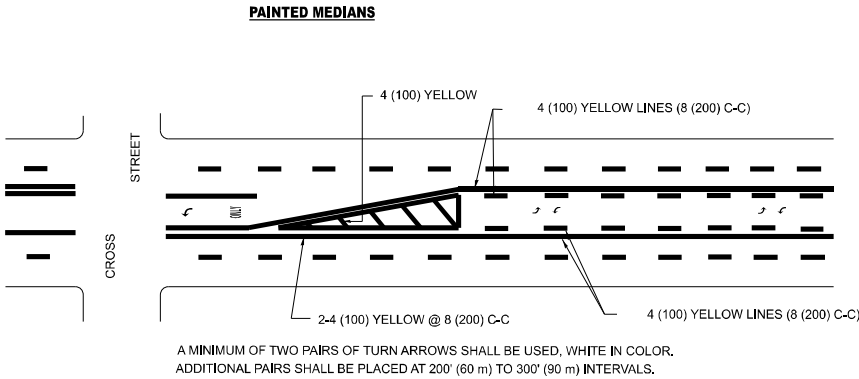
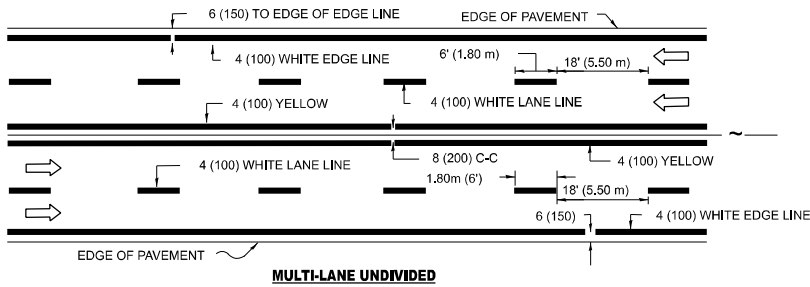

TYPICAL PAINTED MEDIAN MARKING

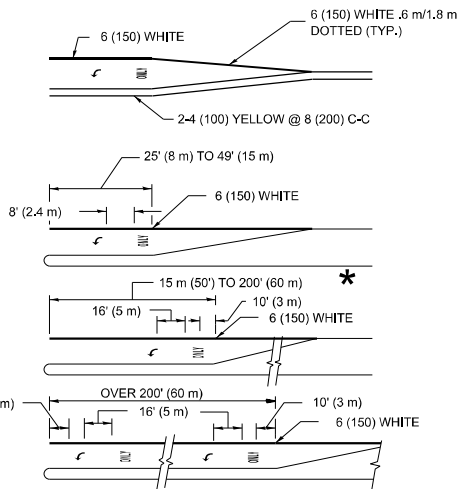

FULL SIZE LETTERS 8' (2.4 m) AND ARROWS SHALL BE USED.
AREA = 15.8 SQ. FT. (1.47 m²) ONLY AREA = 22.9 SQ. FT. (2.13 m²)

* TURN LANES IN EXCESS OF 400' (120 m) IN LENGTH MAY HAVE AN ADDITIONAL SET OF ARROW - "ONLY" INSTALLED MIDWAY BETWEEN THE OTHER TWO SETS OF ARROW - "ONLY".

TYPICAL LEFT (OR RIGHT) TURN LANE

TYPICAL TURN LANE MARKING

TYPE OF MARKING	WIDTH OF LINE	PATTERN	COLOR	SPACING / REMARKS
CENTERLINE ON 2 LANE PAVEMENT	4 (100)	SKIP-DASH	YELLOW	6' (1.80 m) LINE WITH 18' (5.50 m) SPACE
CENTERLINE ON MULTI-LANE UNDIVIDED PAVEMENT	2 @ 4 (100)	SOLID	YELLOW	8 (200) C-C
NO PASSING ZONE LINES: FOR ONE DIRECTION FOR BOTH DIRECTIONS	4 (100) 2 @ 4 (100)	SOLID SOLID	YELLOW YELLOW	8 (200) C-C
LANE LINES	4 (100) 5 (125) ON FREEWAYS	SKIP-DASH SKIP-DASH	WHITE WHITE	6' (1.80 m) LINE WITH 18' (5.50 m) SPACE
DOTTED LINES (EXTENSIONS OF CENTER, LANE OR TURN LANE MARKINGS)	SAME AS LINE BEING EXTENDED	SKIP-DASH	SAME AS LINE BEING EXTENDED	2' (600) LINE WITH 6' (1.8) SPACE
EDGE LINES	4 (100)	SOLID	YELLOW-LEFT WHITE-RIGHT	OUTLINE MOUNTABLE MEDIANS IN YELLOW; EDGE LINES ARE NOT USED NEXT TO BARRIER CURB
TURN LANE MARKINGS	6 (150) LINE: FULL SIZE LETTERS & SYMBOLS (8' (2.4 m))	SOLID	WHITE	SEE TYPICAL TURN LANE MARKING DETAIL
TWO WAY LEFT TURN MARKING	2 @ 4 (100) EACH DIRECTION 8' (2.4 m) LEFT ARROW	SKIP-DASH AND SOLID IN PAIRS	YELLOW WHITE	6' (1.8 m) LINE WITH 18' (5.50 m) SPACE FOR SKIP-DASH; 8 (200) C-C BETWEEN SOLID LINE AND SKIP-DASH LINE SEE TYPICAL TWO-WAY LEFT TURN MARKING DETAIL
CROSSWALK LINES A. DIAGONALS (BIKE & EQUESTRIAN) B. LONGITUDINAL BARS (SCHOOL & PEDESTRIAN)	12 (300) @ 45° 24 (600) @ 90°	SOLID SOLID	WHITE WHITE	2' (600) APART 2' (600) APART SEE TYPICAL CROSSWALK MARKING DETAILS.
STOP LINES	24 (600)	SOLID	WHITE	PLACE 4' (1.2 m) IN ADVANCE OF AND PARALLEL TO CROSSWALK. IF PRESENT, OTHERWISE, PLACE AT DESIRED STOPPING POINT. PARALLEL TO CROSSROAD CENTERLINE, WHERE POSSIBLE
PAINTED MEDIANS	2 @ 4 (100) WITH 12 (300) DIAGONALS @ 45°	SOLID	YELLOW: TWO WAY TRAFFIC WHITE: ONE WAY TRAFFIC	8 (200) C-C FOR THE DOUBLE LINE SEE TYPICAL PAINTED MEDIAN MARKING.
GORE MARKING AND CHANNELIZING LINES	8 (200) WITH 12 (300) DIAGONALS @ 45°	SOLID	WHITE	DIAGONALS: 20' (6.1 m) (LESS THAN 30 MPH (50 km/h))
RAILROAD CROSSING	24 (600) TRANSVERSE LINES: "RR" IS 6' (1.8 m) LETTERS; 16 (400) LINE FOR "X"	SOLID	WHITE	SEE STATE STANDARD 780001 AREA OF: "R"=3.6 SQ. FT. (0.33m ²) EACH "X"=54.0 SQ. FT. (5.0 m ²)

FOR FURTHER DETAILS ON PAVEMENT MARKING REFER TO STREET MARKING STANDARDS, PRINTED BY CITY OF CHICAGO, DEPARTMENT OF TRANSPORTATION, BUREAU OF TRAFFIC.

ALL DIMENSIONS ARE IN INCHES (MILLIMETERS) UNLESS OTHERWISE SHOWN.

TYPICAL LANE AND EDGE LINE MARKING

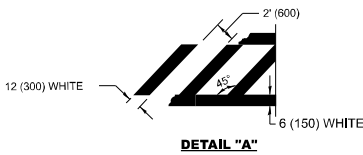
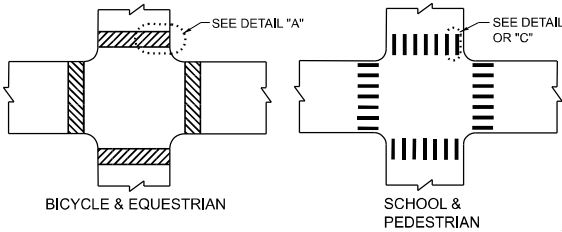

TYPICAL CROSSWALK MARKING

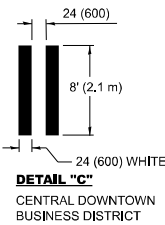
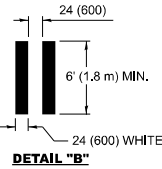

STATE OF ILLINOIS
DEPARTMENT OF TRANSPORTATION

CITY OF CHICAGO
TYPICAL PAVEMENT MARKINGS

SCALE: NONE SHEET 1 OF 3 SHEETS STA. TO STA.

F.A.U. RTE.	SECTION	COUNTY	TOTAL SHEETS	SHEET NO.
3728	2001-142RS	COOK	26	19
TC-24		CONTRACT NO. 62321		
		ILLINOIS	FED. AID PROJECT	

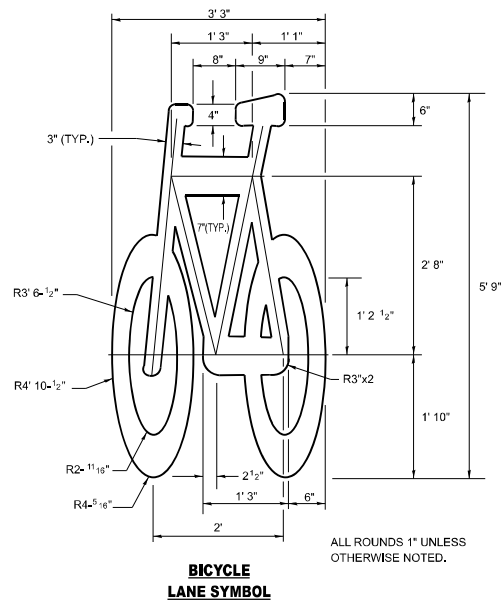
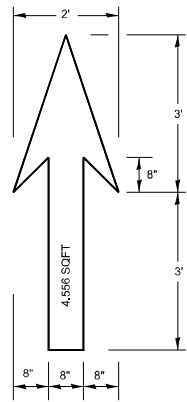

NOTE:

1. FOR BIKE LANE SYMBOLS ONLY,
USE PRE-FORMED THERMOPLASTIC
WITH A MINIMUM THICKNESS OF 90 MILS,
MINIMUM SKID RESISTANCE VALUE OF 60 BPN,
& A MINIMUM INDEX OF REFRACTION OF 1.50.
2. THE RESIDENT ENGINEER SHALL CONTACT
MR. BEN GOMBERG AT 312-744-8093 AT
LEAST ONE CALENDAR WEEK PRIOR TO
INSTALLING BIKE LANE SYMBOLS.

TYPICAL BIKE LANE SYMBOLS

DRAWING #28

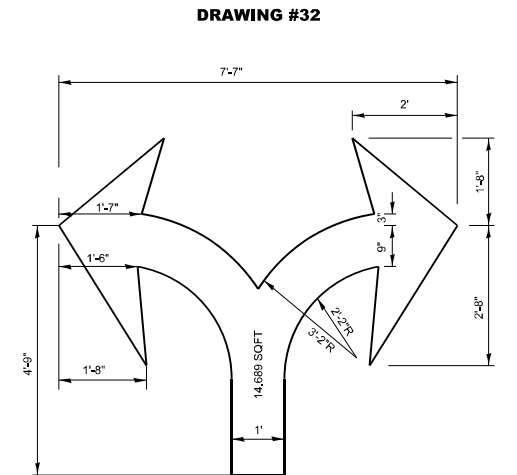
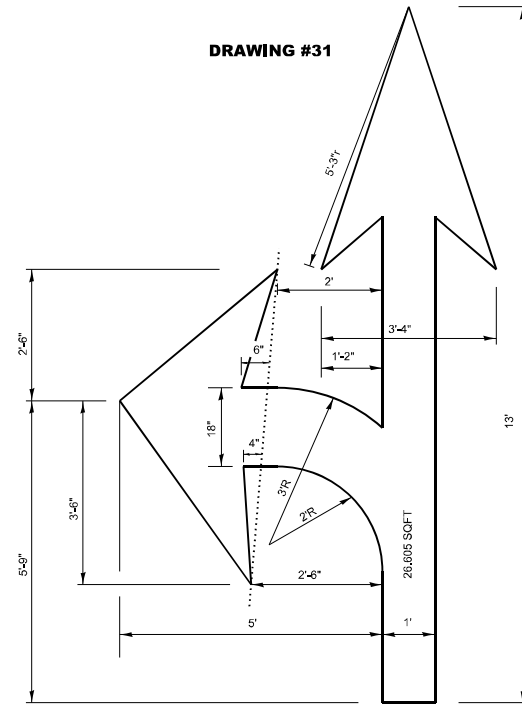
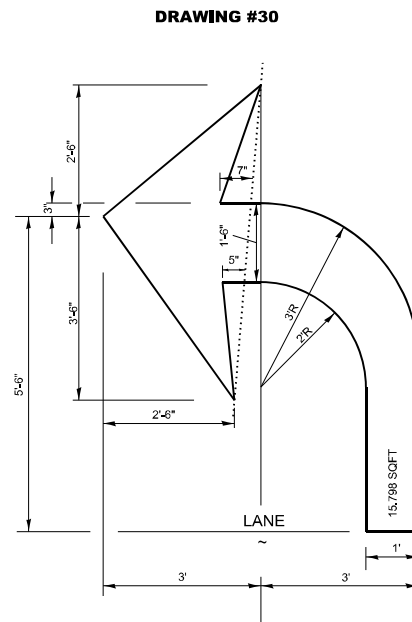
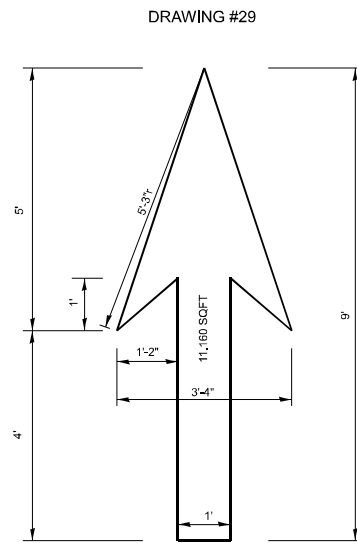

NOTE:

ALL MARKINGS SHALL BE
SOLID WHITE UNLESS
OTHERWISE NOTED IN THE
PLANS

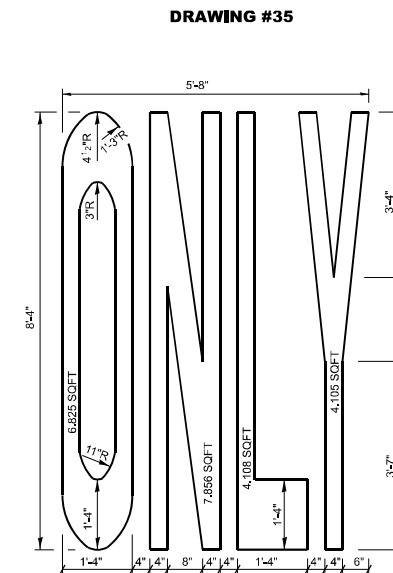
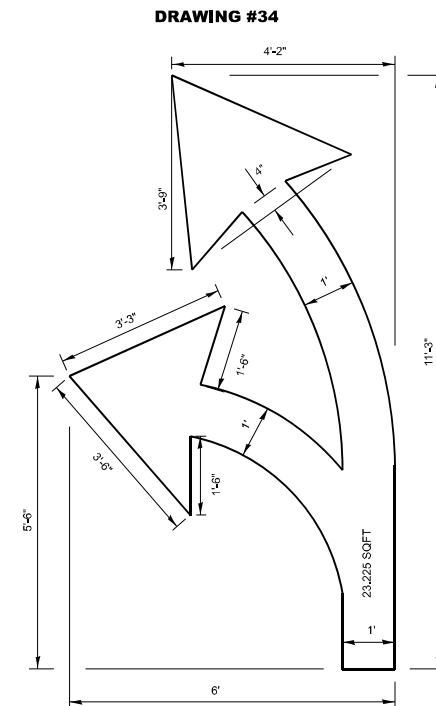
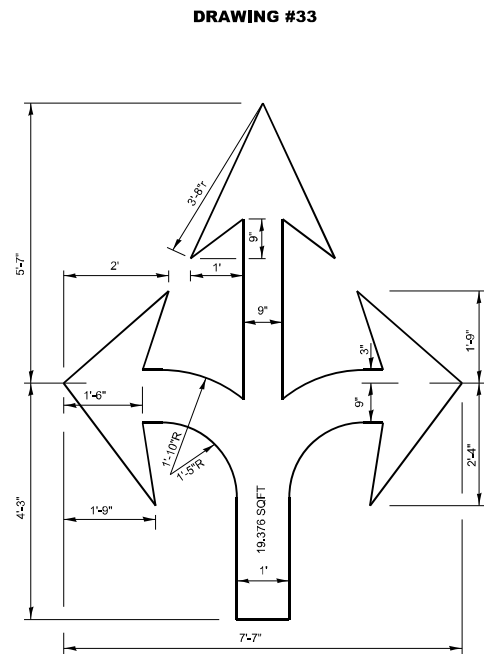

USER NAME = Merin_Jose	DESIGNED -	REVISED - T. RAMMACHER 12-07-00
	DRAWN -	REVISED -
	CHECKED -	REVISED -
PLOT DATE = 7/17/2025	DATE -	REVISED -

STATE OF ILLINOIS
DEPARTMENT OF TRANSPORTATION

CITY OF CHICAGO TYPICAL PAVEMENT MARKINGS

SCALE: NONE	SHEET 2	OF 3	SHEETS	STA.	TO STA.
-------------	---------	------	--------	------	---------

F.A.U RTE.	SECTION	COUNTY	TOTAL SHEETS	SHEET NO.
3728	2001-142RS	COOK	26	20
TC-24		CONTRACT NO. 62321		
		ILLINOIS	FED. AID PROJECT	

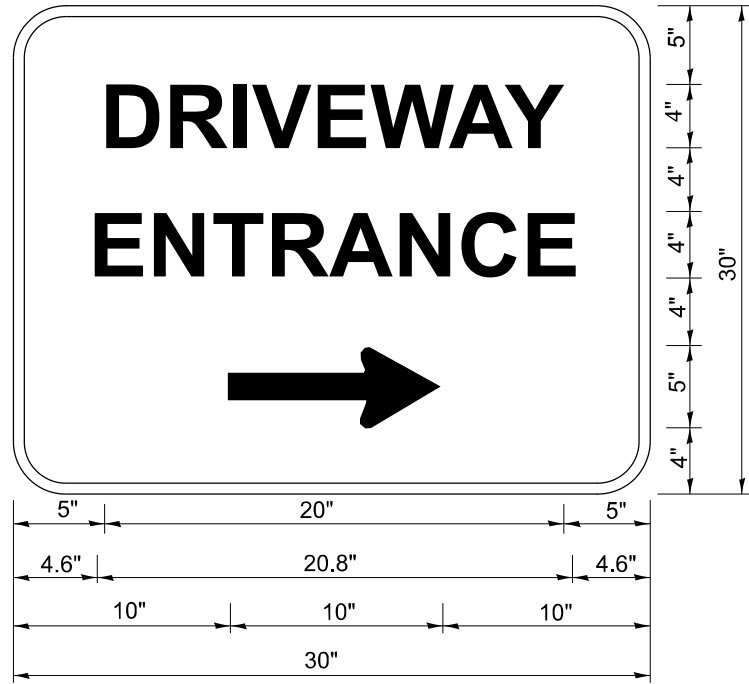

3.0" RADIUS, 0.5" BORDER, WHITE ON GREEN; REFLECTORIZED
"DRIVEWAY" D; "ENTRANCE" D; STANDARD ARROW CUSTOM 12.0" x 5.0"

NOTES:

1. HALF OF THE SIGNS WILL REQUIRE A LEFT HAND FACING ARROW.
2. TWO SIGNS SHALL BE USED AT EACH COMMERCIAL ENTRANCE
PLACED BACK-TO-BACK: ONE WITH A RIGHT HAND ARROW (SHOWN)
SHALL BE PLACED ON THE NEAR RIGHT SIDE THE DRIVEWAY
AND ONE WITH A LEFT HAND ARROW SHALL BE PLACED ON THE
FAR LEFT SIDE OF THE DRIVEWAY.
3. SIGNS TO BE PAID FOR AS ITEM "TEMPORARY INFORMATION SIGNING".

MODEL: TC-26 [Sheet]
FILE NAME: c:\p\work\pilot\illinois.gov_merlin.jose@illinois.gov\1107871\144901-shr-dist\signs.dgn

	USER NAME = Merlin.Jose	DESIGNED -	REVISED - C. JUCIUS 02-15-07	STATE OF ILLINOIS DEPARTMENT OF TRANSPORTATION	DRIVEWAY ENTRANCE SIGNING			F.A.U RTE.	SECTION	COUNTY	TOTAL SHEETS	SHEET NO.
		DRAWN -	REVISED -					3728	2001-142RS	COOK	26	21
		CHECKED -	REVISED -		TC-26			CONTRACT NO. 62321				
	PLOT DATE = 7/17/2025	DATE -	REVISED -		SCALE: NONE	SHEET 1	OF 1	SHEETS	STA.	TO STA.	ILLINOIS FED. AID PROJECT	

ADA DETAIL FOR SINGLE PERPENDICULAR CURB RAMPS W/ EXIST. 5% OR LESS RUN. SLOPE

PD-01A

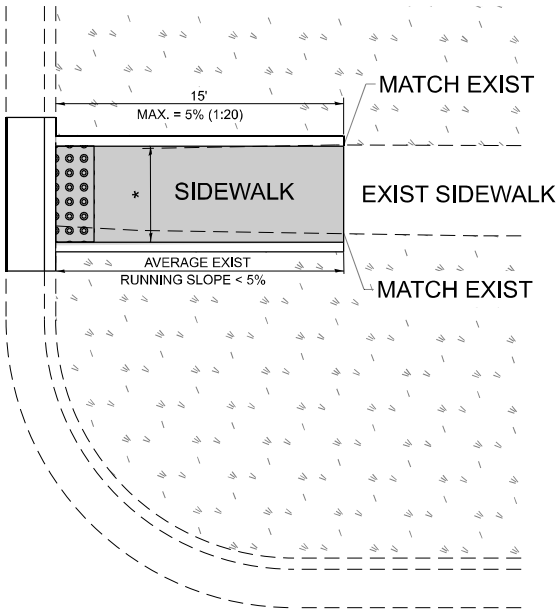

PD-01B

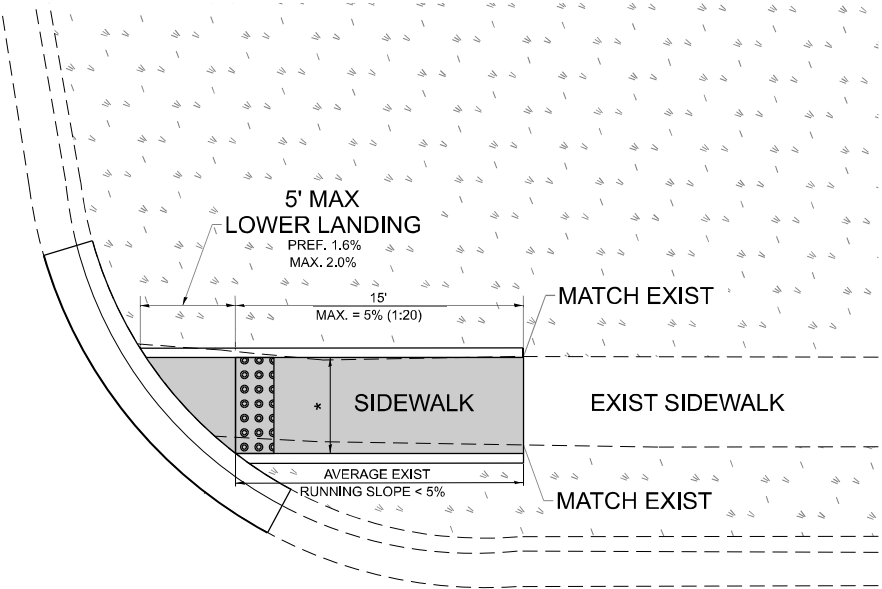

PD-01C

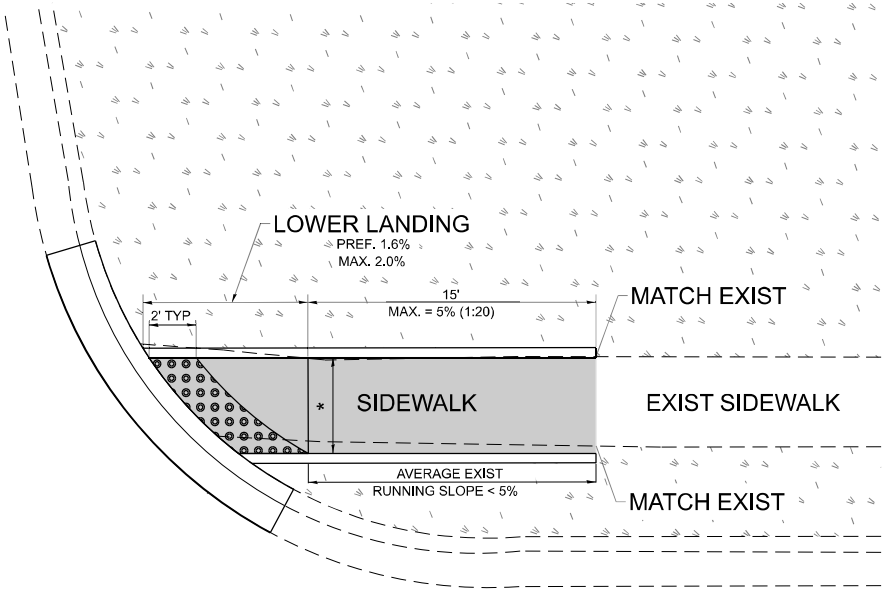

LEGEND

- 

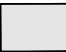
EXIST. GRASS
- 

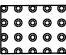
PROPOSED SIDEWALK
- 

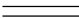
DETECTABLE WARNINGS
- 

PROPOSED SIDE CURB

CONSTRUCTION NOTES:

- 1) ALL CROSS SLOPES ARE PREFERRED 1.6% (1:64), MAXIMUM 2% (1:50) EXCEPT WHEN TRANSITIONING TO EXISTING SIDEWALK
- * MATCH EXISTING SIDEWALK WIDTH

STATE OF ILLINOIS
DEPARTMENT OF TRANSPORTATION

PROJECT DETAIL FOR SINGLE PERPENDICULAR CURB RAMPS
(PD-01)

SCALE: NONE SHEET 1 OF 1 SHEETS STA. TO STA.

F.A.U RTE.	SECTION	COUNTY	TOTAL SHEETS	SHEET NO.
3728	2001-142RS	COOK	26	22
PD-01		CONTRACT NO. 62321		
ILLINOIS		FED. AID PROJECT		

MODEL: PD-01 [Sheet]
FILE NAME: c:\pwworking\illinois.gov_merinjose\illinois.gov\1107871\144901-shr-DistSigs.dgn

USER NAME = Merin,Jose	DESIGNED -	REVISED -
	DRAWN - R. LEDEZMA	REVISED -
	CHECKED -	REVISED -
PLOT DATE = 7/17/2025	DATE - 10/02/2019	REVISED -

ADA DETAIL FOR DEPRESSED CORNER CURB RAMPS

PD-05A

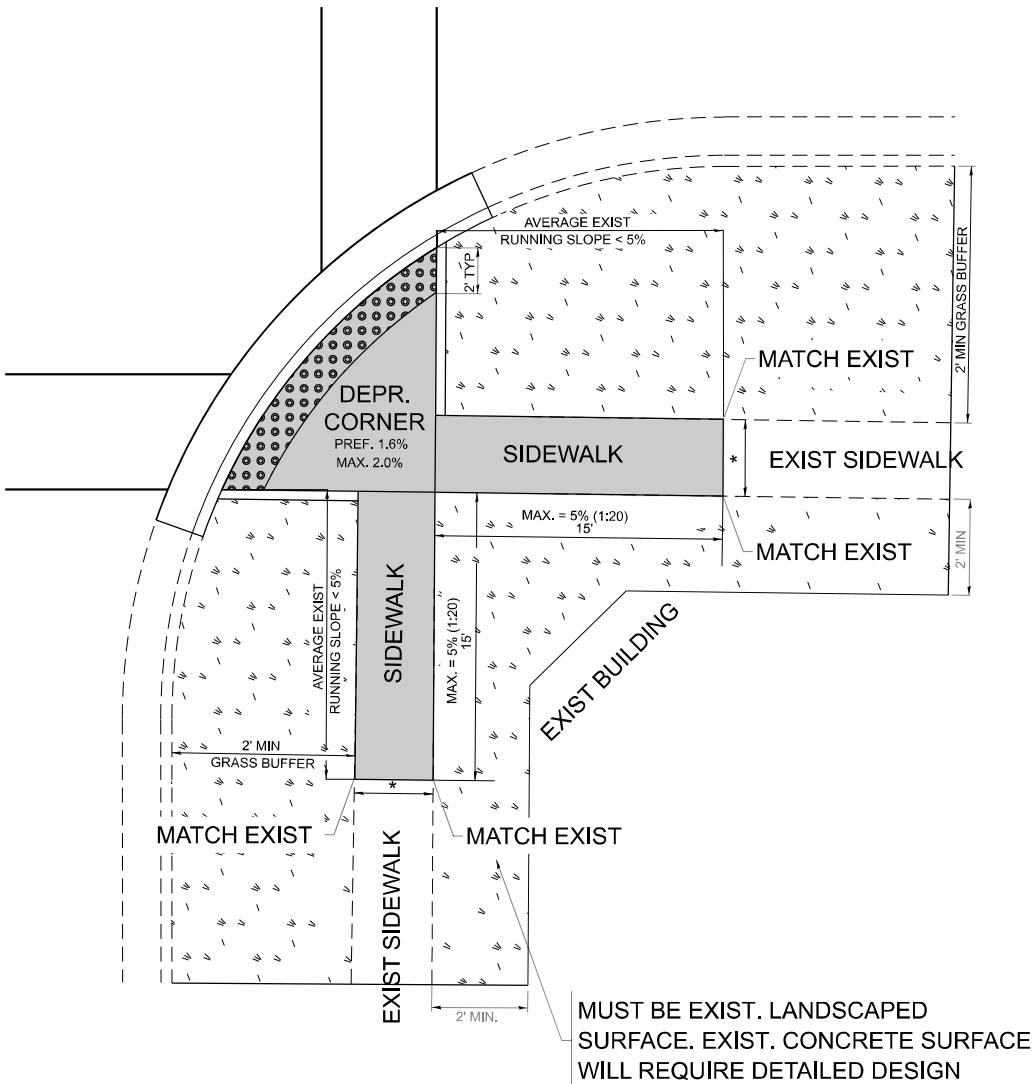

PD-05B

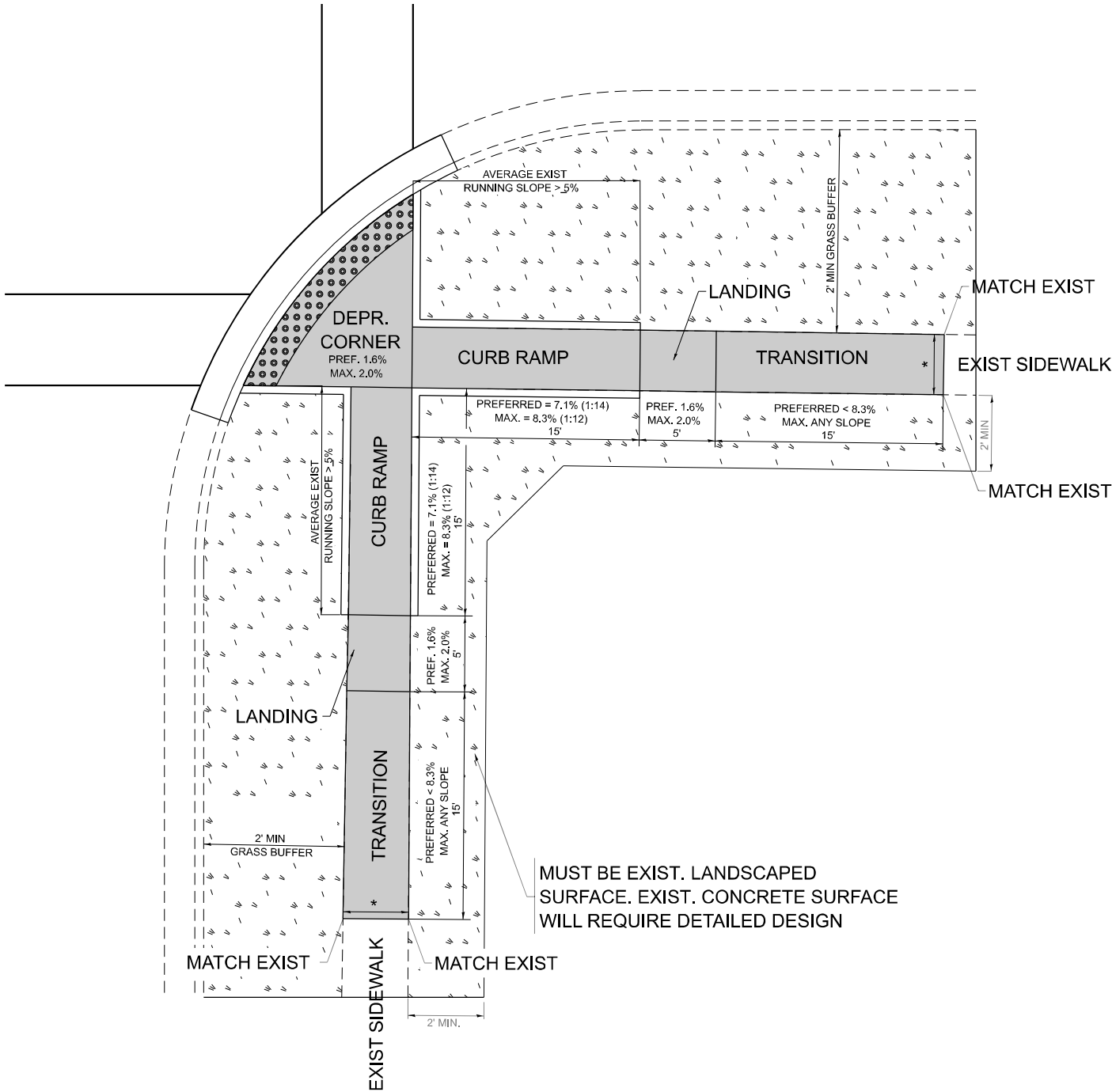

LEGEND

- EXIST. GRASS
- PROPOSED SIDEWALK
- PROPOSED SIDE CURB
- DETECTABLE WARNINGS

CONSTRUCTION NOTES:

- 1) ALL CROSS SLOPES ARE PREFERRED 1.6% (1:64), MAXIMUM 2% (1:50) EXCEPT WHEN TRANSITIONING TO EXISTING SIDEWALK
- * MATCH EXISTING SIDEWALK WIDTH

MODEL: PD-05 (Sheet)
FILE NAME: c:\paw\work\paw\illinois.gov\merin.jose\illinois.gov\1107871\144901-shr-dist\Sigs.dgn

USER NAME	= Merin,Jose	DESIGNED	-	REVISED	-
DRAWN	-	R. LEDEZMA	-	REVISED	-
CHECKED	-		-	REVISED	-
PLOT DATE	= 7/17/2025	DATE	-	REVISED	-

STATE OF ILLINOIS
DEPARTMENT OF TRANSPORTATION

PROJECT DETAIL FOR DEPRESSED CORNER CURB RAMPS
(PD-05)

SCALE: NONE SHEET 1 OF 1 SHEETS STA. TO STA.

F.A.U RTE.	SECTION	COUNTY	TOTAL SHEETS	SHEET NO.
3728	2001-142RS	COOK	26	23
PD-05		CONTRACT NO. 62321		
ILLINOIS		FED. AID PROJECT		

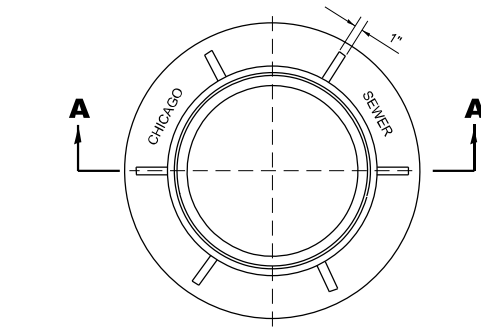

PLAN

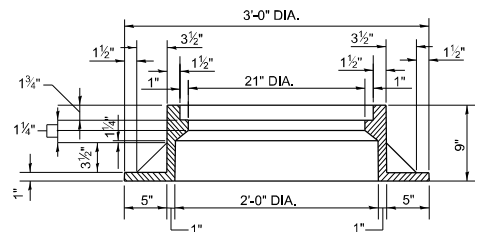

SECTION A-A

NOTE: METAL PLATES MUST BE FURNISHED FOR PERFORATED LIDS ON MANHOLES.

HEAVYWEIGHT MANHOLE FRAME

MATERIAL: CAST IRON

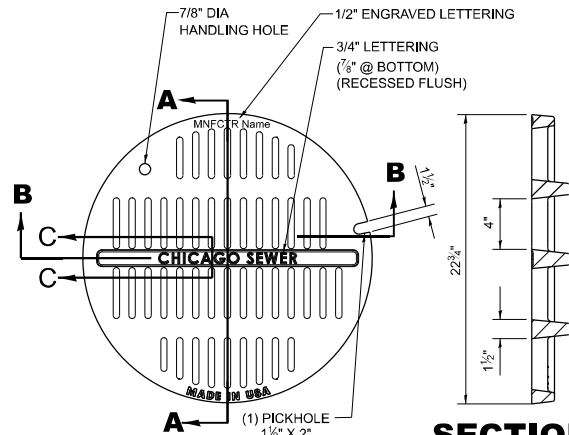

SECTION A-A

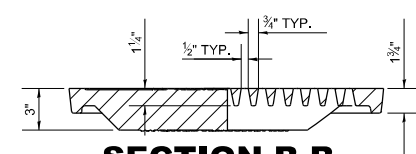

SECTION B-B

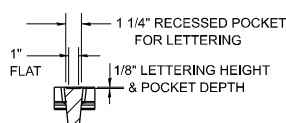

SECTION C-C

MATERIALS
GRATE-GRAY IRON
ASTM A48 CL35B

DESIGN LOAD
HEAVY DUTY

COATING
UNDIPPED

OPEN AREA
85.6 SQ. IN.

STANDARD CB / MH LID

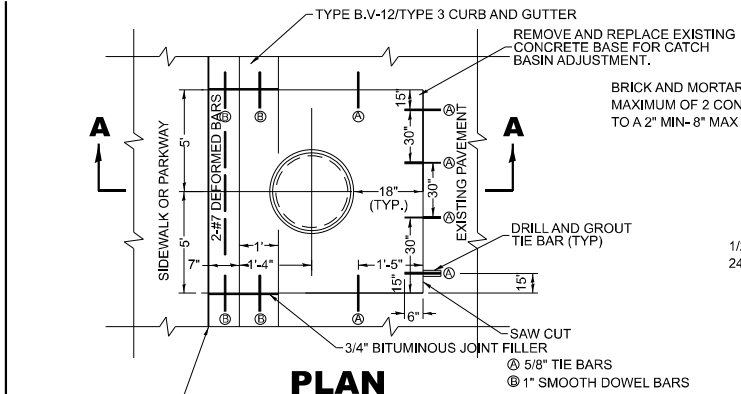

PLAN

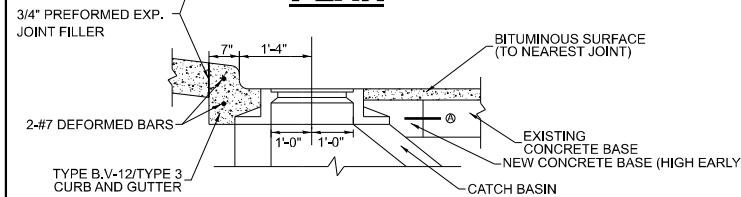

SECTION A-A

NOTES:

IF THE ADJUSTMENT EXCEEDS AN 8" HEIGHT, THE CONE MUST BE REMOVED AND THE BARREL SECTION MUST BE ADJUSTED.

THE CONTRACTOR IS REQUIRED TO REPLACE ANY BROKEN FRAMES AND LIDS OF SEWER STRUCTURES WITH STANDARD FRAMES AND LIDS OF THE DWM. IN ADJUSTMENT OR RECONSTRUCTION OF SEWER STRUCTURES, ANY NON-STANDARD FRAMES AND LIDS MUST BE REPLACED WITH STANDARD FRAMES AND LIDS. IN ADJUSTMENT OR RECONSTRUCTION OF INLETS, ANY NON-STANDARD INLETS (GUTTER BOXES) MUST BE REPLACED WITH DWM STANDARD INLETS.

THE FRAMES AND LIDS OF SEWER STRUCTURES TO BE ABANDONED, REMOVED, OR FILLED MUST BE SALVAGED AND THE DWM NOTIFIED FOR PICK UP.

MANHOLES, CATCH BASINS AND INLETS MUST BE PROTECTED FROM THE ENTRY OF ASPHALT/DEBRIS INTO THE SEWER SYSTEM DURING CONSTRUCTION. THE CONTRACTOR MUST MARK LOCATIONS OF ALL SEWER STRUCTURES ON THE SIDEWALK BEFORE STARTING PAVEMENT REMOVAL/REPLACEMENT. ADJUSTMENT OF FRAMES AND LIDS OF SEWER STRUCTURES MUST BE COMPLETED PRIOR TO STREET RESURFACING.

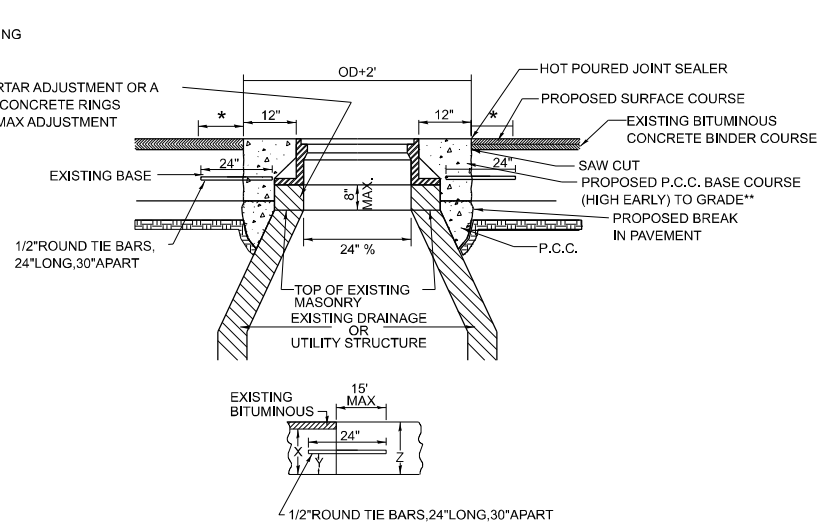

* REFER TO CDOT FOR ASPHALT RESTORATION ENQUIRE MENRS & CRACK SEAL.

** ON NON-MORATORIUM STREETS, FULL DEPTH. PCC BASE COURSE MAY BE UTILIZED. ON MORATORIUM STREETS, PAVEMENT RESTORATION SHALL ADHERE TO CDOT REQUIRED MWNTS.

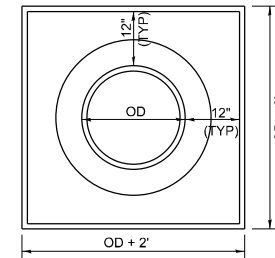

PLAN VIEW
(BASE TO GRADE)

DETAIL OF FRAME ADJUSTMENT

MATERIALS
GRATE-GRAY IRON
ASTM A48 CL35B

DESIGN LOAD
HEAVY DUTY

COATING
UNDIPPED

OPEN AREA
85.6 SQ. IN.

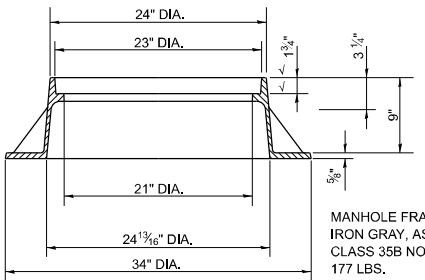
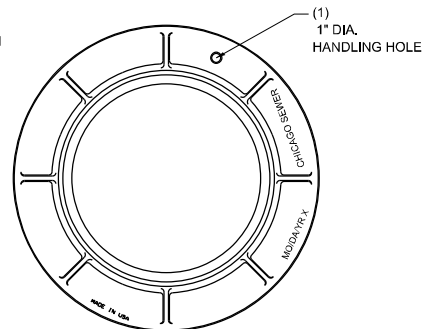

MANHOLE FRAME CAST
IRON GRAY, ASTM A-48
CLASS 35B NO PAINT
177 LBS.

LIGHTWEIGHT MANHOLE FRAME

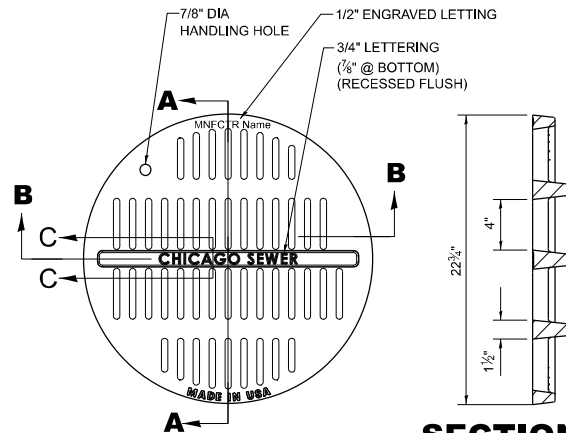

SECTION A-A

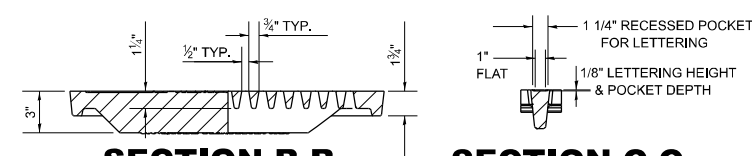

SECTION B-B

SECTION C-C

ADA COMPLIANT CATCH BASIN / MANHOLE LID

NOTE:
NOT TO BE USED WITHOUT
PRIOR APPROVAL OF CDWM

SOLID LID FOR MANHOLES

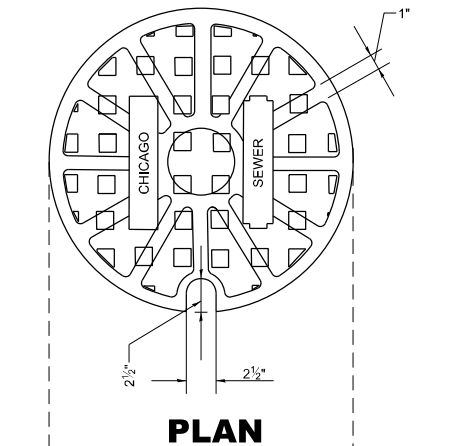

PLAN

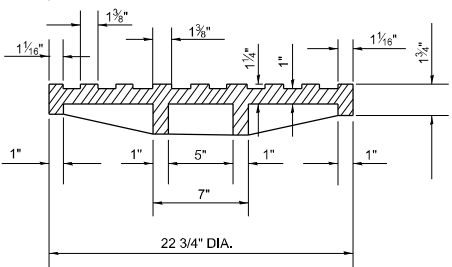

SECTION

STATE OF ILLINOIS
DEPARTMENT OF TRANSPORTATION

CITY OF CHICAGO
MANHOLE LIDS AND FRAMES

F.A.U RTE.	SECTION	COUNTY	TOTAL SHEETS	SHEET NO.
3728	2001-142RS	COOK	26	24
BD600-13 (BD-47)		CONTRACT NO. 62321		
		ILLINOIS FED. AID PROJECT		

SCALE: NONE SHEET 1 OF 1 SHEETS STA. TO STA.

USER NAME = Merin,Jose	DESIGNED - M. GOMEZ	REVISED - K. SMITH 02-01-22
	DRAWN -	REVISED - K. SMITH 11-18-22
	CHECKED -	REVISED -
PLOT DATE = 7/17/2025	DATE - 01-25-01	REVISED -

MODEL: BD-47 (Sheet)
FILE NAME: c:\pav_work\pav\illinois.gov\110787\1D144901-shr-Dist\Sigs.dgn

MODEL: Utility (Sheet)
FILE NAME: c:\p\work\p\work\illinois.gov\110787\1D14301-shr-exhibits.dgn

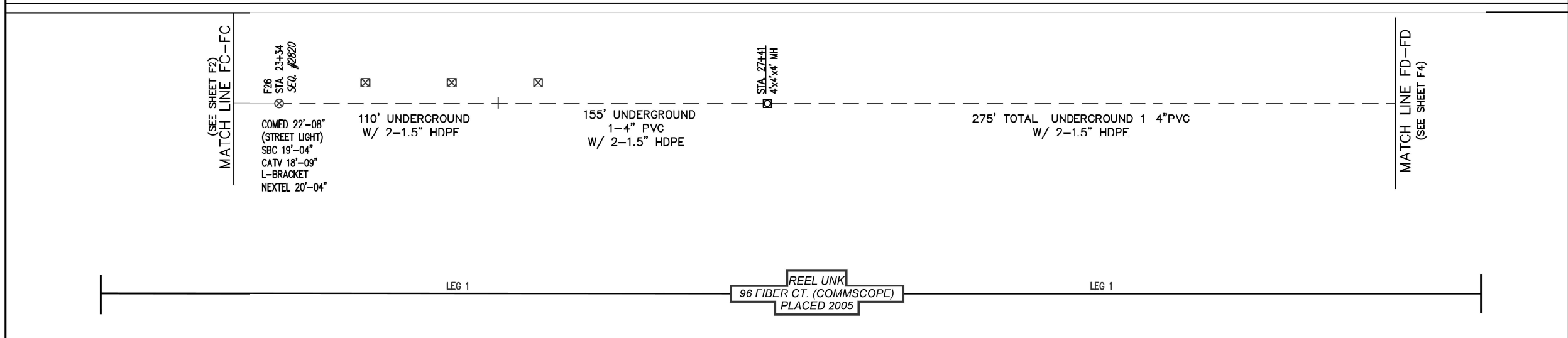
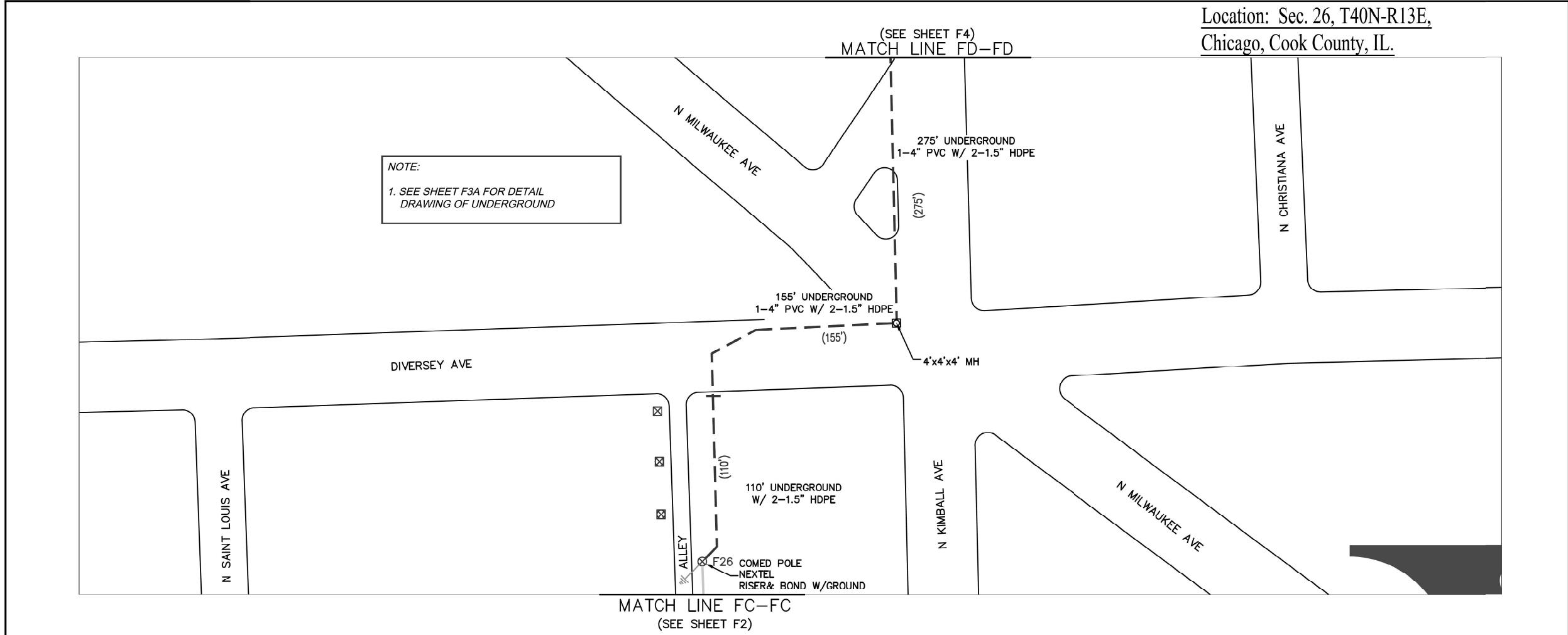

Sprint
Together with NEXTEL

Proprietary Information.

LEGEND

SYMBOLS

- JOINT POLE
- JOINT TRANSFORMER POLE
- CE POWER POLE
- CE TRANSFORMER POLE
- TELEPHONE POLE
- CATV POLE
- COMED RISER
- CATV PED
- CATV VAULT
- TELEPHONE VAULT
- TELEPHONE PED
- CE TRANSFORMER
- CATV POWER SUPPLY
- CE VAULT/PED
- TRAFFIC CONTROL VAULT
- CATV MANHOLE
- SEWER MANHOLE (Indicate Sanitary/Storm)
- WATER MANHOLE (Indicate Ownership i.e. DWC)
- PROPOSED MANHOLE
- FIBER MARKER
- GAS MARKER (Indicate Ownership)
- RIGHT-OF-WAY MARKER (Bench Mark)
- RAILROAD CROSSING GATE
- ROAD SIGN
- STREET LIGHT
- TRAFFIC SIGNAL LIGHT
- GUY AND ANCHOR
- FIRE HYDRANT
- EXISTING GROUND
- CATCH BASIN ROUND
- CATCH BASIN SQUARE
- SEWER DRAIN
- WATER VALVE
- GAS VALVE
- CULVERT PIPE
- TREE
- BUSH
- HEDGES

LINETYPES

- CENTER LINE
- RIGHT-OF-WAY LINE
- CURB LINE
- UNDERGROUND FIBER
- AERIAL FIBER
- WATER MAIN
- SANITARY SEWER
- STORM SEWER MAIN
- GAS MAIN
- AMERITECH
- BURIED COMED CABLE
- FENCE

Remarks

PCA - PROPOSED CABLE ATTACHMENT
PBC - PARALLEL BUILD TO CATV
PBT - PARALLEL BUILD TO TELEPHONE
MKR.1 - CHANGE EXTENSION BRACKET TO L-BRACKET
MKR.2 - POLE CHANGE
MKR.3 - POLE TRANSFER
MKR.4 - EXPOSED WIRES, LOW DRIP LOOP

		Engineering:		Contractor:		Project Name/Location		Scale: Not to Scale		Date: May, 2006
		W: \TELECOM.JPG		W: \WESTLOGO.jpg		Nextel Project Eisenhower Hotel (Section E) (As-Built)		Designed By	MDF	Project No.: 2506-001
		1039 W. Grand Ave. (1st Floor) Chicago, Illinois 60622 Phone: (312) 733 - 3828 Fax: (312) 733 - 3876		227 E. Laraway St. Frankfort, IL 60423 Phone: (815) 469 - 8831 Fax: (815) 469 - 8832				Drawn By	KJB	Customer No.: 2623-016
								Checked By	SMF	Sheet No.
Description								Approved By	SMF	F3 F3 of F10 Sheets

USER NAME = Merin,Jose		DESIGNED -	REVISED -	STATE OF ILLINOIS DEPARTMENT OF TRANSPORTATION		UTILITY MARKUP PLAN		F.A.U RTE.	SECTION	COUNTY	TOTAL SHEETS	SHEET NO.
		DRAWN -	REVISED -					3728	2001-142RS	COOK	26	25
		CHECKED -	REVISED -					CONTRACT NO. 62321				
PLOT DATE = 7/17/2025		DATE -	REVISED -			SCALE:	SHEET 16 OF 26 SHEETS	STA.	TO STA.	ILLINOIS FED. AID PROJECT		

MODEL: Utility (Sheet) - 2
FILE NAME: c:\p\work\wv\illinois.gov\110787\1D14901-shr-exhibits.dgn

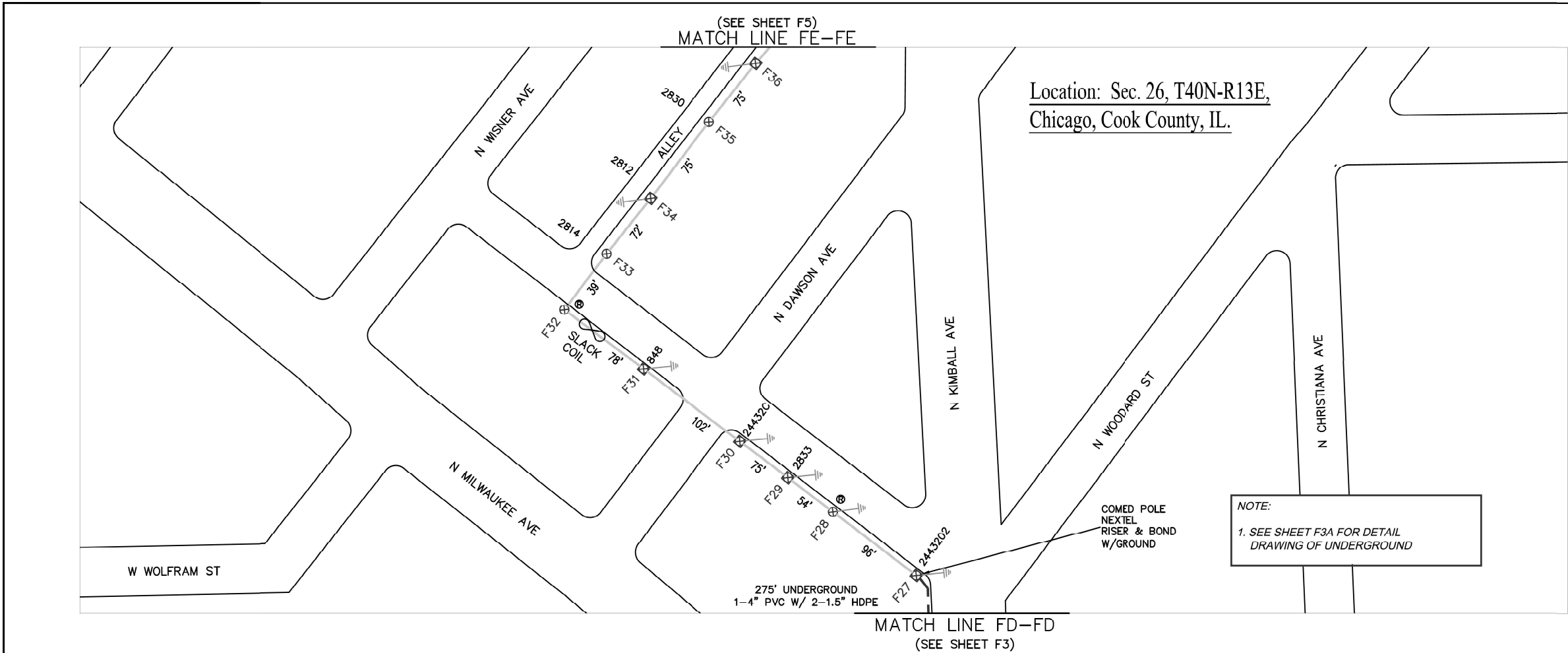

North Arrow

Sprint
Together with NEXTEL

Proprietary Information.

LEGEND

SYMBOLS

- JOINT POLE
- JOINT TRANSFORMER POLE
- CE POWER POLE
- CE TRANSFORMER POLE
- TELEPHONE POLE
- CATV POLE
- COMED RISER
- CATV PED
- CATV VAULT
- TELEPHONE VAULT
- TELEPHONE PED
- CE TRANSFORMER
- CATV POWER SUPPLY
- CE VAULT/PED
- TRAFFIC CONTROL VAULT
- CATV MANHOLE
- SEWER MANHOLE (Indicate Sanitary/Storm)
- WATER MANHOLE (Indicate Ownership I.e. DMC)
- PROPOSED MANHOLE
- FIBER MARKER
- GAS MARKER (Indicate Ownership)
- RIGHT-OF-WAY MARKER (Bench Mark)
- RAILROAD CROSSING GATE
- ROAD SIGN
- STREET LIGHT
- TRAFFIC SIGNAL LIGHT
- GUY AND ANCHOR
- FIRE HYDRANT
- EXISTING GROUND
- CATCH BASIN ROUND
- CATCH BASIN SQUARE
- SEWER DRAIN
- WATER VALVE
- GAS VALVE
- CULVERT PIPE
- TREE
- BUSH
- HEDGES

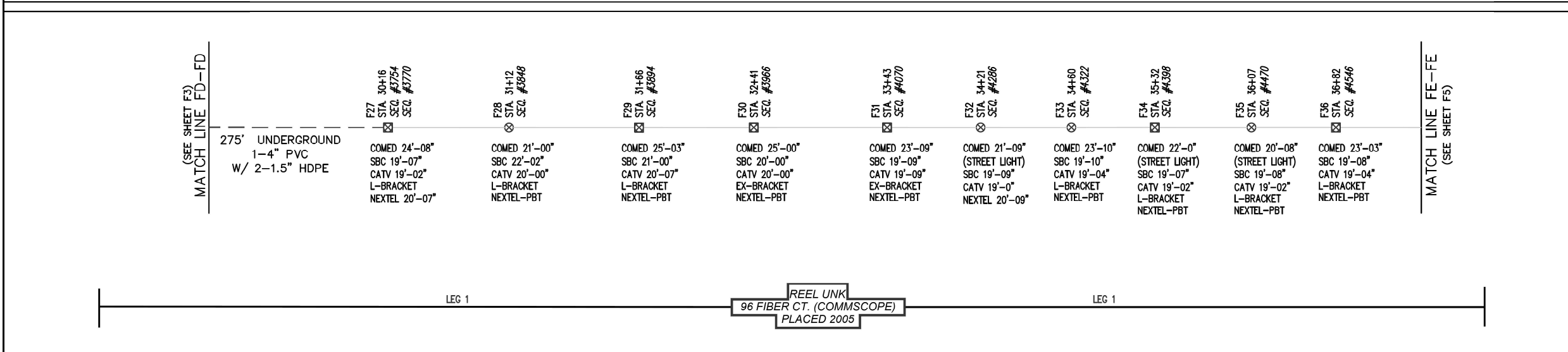

LINETYPES

- CENTER LINE
- RIGHT-OF-WAY LINE
- CURB LINE
- UNDERGROUND FIBER
- AERIAL FIBER
- WATER MAIN
- SANITARY SEWER
- STORM SEWER MAIN
- GAS MAIN
- AMERITECH
- BURIED COMED CABLE
- FENCE

Remarks

PCA - PROPOSED CABLE ATTACHMENT
PBC - PARALLEL BUILD TO CATV
PBT - PARALLEL BUILD TO TELEPHONE
MKR.1 - CHANGE EXTENSION BRACKET TO L-BRACKET
MKR.2 - POLE CHANGE
MKR.3 - POLE TRANSFER
MKR.4 - EXPOSED WIRES, LOW DRIP LOOP

		Engineering:		Contractor:		Project Name/Location		Scale: Not to Scale		Date: May, 2006	
		W: \TELECOM.JPG		W: \WESTLOGO.jpg		Nextel Project Eisenhower Hotel (Section E) (As-Built)		Designed By	MDF	Project No.: 2506-001	
		1039 W. Grand Ave. (1st Floor) Chicago, Illinois 60622 Phone: (312) 733 - 3828 Fax: (312) 733 - 3876		227 E. Laraway St. Frankfort, IL 60423 Phone: (815) 469 - 8831 Fax: (815) 469 - 8832				Drawn By	KJB	Customer No.: 2623-016	
								Checked By	SMF	Sheet No.	
Description								Approved By	SMF	F4 F4 of F10 Sheets	

USER NAME = Merin,Jose	DESIGNED -	REVISED -
	DRAWN -	REVISED -
	CHECKED -	REVISED -
PLOT DATE = 7/17/2025	DATE -	REVISED -

STATE OF ILLINOIS
DEPARTMENT OF TRANSPORTATION

UTILITY MARKUP PLAN

SCALE: SHEET 17 OF 26 SHEETS STA. TO STA.

F.A.U RTE.	SECTION	COUNTY	TOTAL SHEETS	SHEET NO.
3728	2001-142RS	COOK	26	26
CONTRACT NO. 62321				
ILLINOIS FED. AID PROJECT				