

STATE OF ILLINOIS
DEPARTMENT OF TRANSPORTATION

F.A.U. RTE.	SECTION	COUNTY	TOTAL SHEETS	SHEET NO.
9206	64Q	ST. CLAIR	6	1
		ILLINOIS	CONTRACT NO. 76U72	

D-98-067-25



PROPOSED
HIGHWAY PLANS

FAU ROUTE 9206 (WATER ST.)
SECTION 64Q
CM - CHIP SEAL
ST. CLAIR COUNTY

C-98-136-25

FOR INDEX OF SHEETS, SEE SHEET NO. 2

TRAFFIC DATA WATER ST. IL 3 TO ST. LAMBERT DR.	
LOCATION	2025 ADT
	3000 (ACTUAL)
	2045 ADT
	3600 (ESTIMATED)
MU%	1.7%
SU%	6.1%

TRAFFIC DATA WATER ST. ST. LAMBERT DR. TO OLD IL 3	
LOCATION	2025 ADT
	1600 (ACTUAL)
	2045 ADT
	2000 (ESTIMATED)
MU%	2.5%
SU%	8.8%

FUNCTIONAL CLASSIFICATION: MAJOR COLLECTOR

PCC PAVEMENT OMISSION
STA. 74+16 TO STA. 74+28

PCC PAVEMENT OMISSION
STA. 80+50 TO STA. 80+62

BEGIN PROJECT:
STA. 15+36.00
LAT: 38.566766
LONG: -90.191050

BRIDGE OMISSION
STA. 76+31 TO STA. 79+82

END PROJECT:
STA. 104+68
LAT: 38.543795
LONG: -90.197439

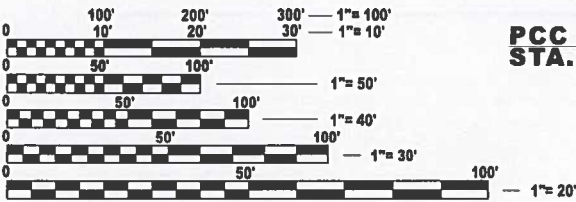

FULL SIZE PLANS HAVE BEEN PREPARED USING STANDARD
ENGINEERING SCALES. REDUCED SIZED PLANS WILL NOT
CONFORM TO STANDARD SCALES. IN MAKING MEASUREMENTS
ON REDUCED PLANS, THE ABOVE SCALES MAY BE USED.

J.U.L.I.E.
JOINT UTILITY LOCATION INFORMATION FOR EXCAVATION
1-800-892-0123
OR 811

PROJECT ENGINEER: BILLIE OWEN
PROJECT MANAGER: MIKE BERG

CONTRACT NO. 76U72



NOT TO SCALE

GROSS LENGTH = 9,609.6 FT. = 1.82 MILE
NET LENGTH = 9,234.6 FT. = 1.74 MILE

STATE OF ILLINOIS
DEPARTMENT OF TRANSPORTATION

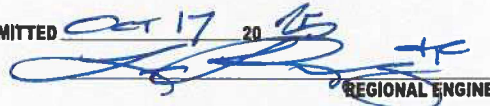
SUBMITTED Oct 17 2025  REGIONAL ENGINEER

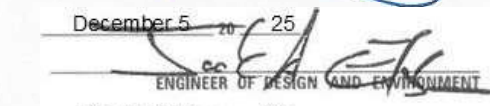
December 5, 2025  ENGINEER OF DESIGN AND ENVIRONMENT

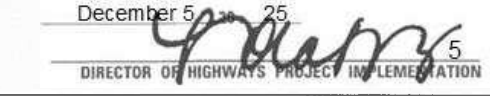
December 5, 2025  DIRECTOR OF HIGHWAYS PROJECT IMPLEMENTATION

PRINTED BY THE AUTHORITY
OF THE STATE OF ILLINOIS

INDEX OF SHEETS

1. COVER SHEET
2. INDEX OF SHEETS, HIGHWAY STANDARDS, GENERAL NOTES AND COMMITMENTS
3. SUMMARY OF QUANTITIES
4. TYPICAL SECTION
5. SCHEDULE OF QUANTITIES
6. LOCATION MAP, DETAILS

HIGHWAY STANDARDS

000001-09	STANDARDS SYMBOLS ABBREVIATIONS & PATTERNS
001006	DECIMAL OF INCH & FOOT
701011-04	OFF ROAD MOVING OPERATIONS, 2L, 2W, DAY ONLY
701201-05	LANE CLOSURE, 2L 2W, DAY ONLY, FOR SPEEDS ≥ 45 MPH
701301-04	LANE CLOSURE, 2L 2W, SHORT TIME OPERATIONS
701306-04	LANE CLOSURE, 2L 2W, SLOW MOVING OPERATIONS, DAY ONLYFOR SPEEDS ≥ 45 MPH
701311-03	LANE CLOSURE, 2L 2W, MOVING OPERATIONS, DAY ONLY
701901-11	TRAFFIC CONTROL DEVICES
780001-05	TYPICAL PAVEMENT MARKINGS
781001-04	TYPICAL APPLICATIONS RAISED REFLECTIVE PAVEMENT MARKERS
782001-01	CURB REFLECTORS

GENERAL NOTES

1. UTILITIES KNOWN TO HAVE FACILITIES WITHIN THE PROJECT ARES
- | | | | |
|--|-------------------------|--------|--------|
| AMEREN ILLINOIS | (GAS & ELECTRIC) | AERIAL | BURIED |
| AT&T ILLINOIS | (COMMUNICATIONS) | X | X |
| BUCKEYE PARTNERS L.P. WOODRIVER PIPELINE | (PIPELINE) | | X |
| VILLAGE OF CAHOKIA | (WATER, SANITARY SEWER) | | X |
| CHARTER COMMUNICATIONS, INC | (COMMUNICATIONS) | X | X |
| CITY OF COLUMBIA. | (WATER, SANITARY SEWER) | | X |
| VILLAGE OF DUPO | (WATER, SANITARY SEWER) | | X |
| VILLAGE OF DUPO | (GAS) | | X |
| HARRISONVILLE TELEPHONE COMPANY | (COMMUNICATION) | X | X |
| VERIZON BUSINESS | (COMMUNICATIONS) | X | X |
| METRO EAST SANITARY DISTRICT | (SANITARY SEWER) | | X |
| PARIRIE DU PONT PUBLIC WATER DISTRICT | (WATER) | | X |
| SEGRA | (COMMUNICATION) | X | X |
| SUGAR LOAF TOWNSHIP SEWER SYSTEM | (SANITARY SEWER) | | x |
2. NO SURVEY WAS PERFORMED FOR THIS PROJECT AND THE PLANS WERE CREATED USING MICROFLIM AND FIELD MEASUREMENTS.
3. THE RESIDENT ENGINEER SHALL VERIFY THE EXISTENCE OF HIGHWAY LIGHTING, INTELLIGENT TRANSPORTATION SYSTEMS (I.T.S.) UTILITIES, AND/OR ELECTRICAL CABLES ASSOCIATED WITH TRAFFIC SIGNALS WITHIN THE PROJECT LIMITS. IF ANY OF THESE EXIST WITHIN THE PROJECT LIMITS, AND IF THESE ITEMS REQUIRE LOCATING, THE CONTRACTOR SHALL BE DIRECTED TO DO SO ACCORDING TO SECTION 803 OF THE STANDARD SPECIFICATIONS. THIS WORK SHALL BE PAID FOR ACCORDING TO ARTICLE 109.04 OF THE STANDARD SPECIFICATIONS.
4. THE DEPARTMENT STRONGLY ENCOURAGES THE PRIME CONTRACTOR AND THEIR APPROVED SUB-CONTRACTORS TO HIRE MINORITY, WOMEN AND DISADVANTAGED INDIVIDUALS FROM ITS FEDERALLY FUNDED HIGHWAY CONSTRUCTION CAREERS TRAINING PROGRAM (HCCTP) TO HELP MEET WORKFORCE AND TRAINEE GOALS. THIS PROGRAM IS TRAINING MINORITIES, WOMEN AND DISADVANTAGED INDIVIDUALS IN HIGHWAY CONSTRUCTION-RELATED SKILLS, E.G., MATH FOR THE TRADES, JOB READINESS, TECHNICAL SKILLS COURSEWORK (CARPENTRY, CONCRETE FLATWORK, BLUEPRINT READING, SITE PLANS, SITE WORK, TOOLS USE, ETC.) AND OSHA 10 HOUR CERTIFICATION, TO PREPARE THEM FOR A CAREER IN THE HIGHWAY CONSTRUCTION TRADES. GRADUATES ARE WELL-TRAINED AND READY TO BECOME PRODUCTIVE ENTRY-LEVEL CONSTRUCTION WORKERS. CONTACT THE DISTRICT 8 EEO OFFICE AT 618-346-3360 AND/OR THE HCCTP COORDINATOR AT 618-874-6528 TO LEARN MORE ABOUT THE PROGRAM AND FOR ASSISTANCE IN MEETING WORKFORCE AND TRAINEE GOALS.
5. THE VOID IN THE PAVEMENT WHICH RESULTS FROM THE RAISED REFLECTIVE PAVEMENT MARKER REMOVAL SHALL BE REPAIRED WITH MATERIAL AS DIRECTED BY THE ENGINEER. THE MATERIAL AND WORK SHALL BE PAID FOR IN ACCORDANCE WITH ARTICLE 783 OF THE STANDARD SPECIFICATIONS.
6. ALL TURF AREAS DISTURBED BY THE CONTRACTOR SHALL BE SEEDED WITH THE APPROPRAITE EROSION CONTROL, AS DIRECTED BY THE ENGINEER, AT THE CONTRACTOR'S EXPENSE.
7. THE CONTRACTOR SHALL USE CA-16 FOR THE SEAL AND COVER AGGREGATE.
8. TWO CHANGEABLE MESSAGE SIGNS SHALL BE PROVIDED ALONG IL 3 AND OLD IL 3 (STOLLE RD.) TO ALERT DRIVERS OF THE UPCOMING ROAD CONSTRUCTION. CHANGEABLE MESSAGE SIGNS SHALL BE PLACED 14 DAYS PRIOR TO BEGINNING WORK. EXACT LOCATIONS OF THE CHANGEABLE MESSAGE SIGNS SHALL BE DETERMINED BY THE ENGINEER.
9. THE DESIGNATED APPLICATION RATE FOR THE FOG SEAL IS 0.04LB/SQ FT.
10. THE PROPOSED PAVEMENT MARKING SHALL MATCH THE LOCATIONS OF THE EXISTING PAVEMENT MARKING, AS DIRECTED BY THE ENGINEER.

COMMITMENTS

NONE

STATE OF ILLINOIS
DEPARTMENT OF TRANSPORTATION

INDEX OF SHEETS. HIGHWAY STANDARDS,
GENERAL NOTES, COMMITMENTS

F.A.U RTE.	SECTION	COUNTY	TOTAL SHEETS	SHEET NO.
9206	64Q	ST. CLAIR	5	2
CONTRACT NO. 76U72				
		ILLINOIS	FED. AID PROJECT	

SCALE: NTS SHEET 1 OF 1 SHEETS STA. TO STA.

MODEL: GenNotes [Sheet]
FILE NAME: c:\pwy_work\pwytdotmiller\rajd1140456\0876\U72-sh-generalnotes.dgn

MODEL: SQO [Sheet]
FILE NAME: c:\pw_work\pwidomillera\1140456\0876\U72-shh-sqo.dgn

* SPECIALTY ITEM

CODE NO.	ITEM	UNIT	TOTAL QUANTITY	CONSTR. CODE
				100% STATE
				ROADWAY
				0005 URBAN
67100100	MOBILIZATION	L SUM	1	1
70100450	TRAFFIC CONTROL AND PROTECTION, STANDARD 701201	L SUM	1	1
70100460	TRAFFIC CONTROL AND PROTECTION, STANDARD 701306	L SUM	1	1
70300100	SHORT TERM PAVEMENT MARKING	FOOT	778	778
70300150	SHORT TERM PAVEMENT MARKING REMOVAL	SQ FT	259	259
70300211	TEMPORARY PAVEMENT MARKING LETTERS AND SYMBOLS - PAINT	SQ FT	63	63
70300221	TEMPORARY PAVEMENT MARKING - LINE 4"- PAINT	FOOT	22549	22549
70300261	TEMPORARY PAVEMENT MARKING - LINE 12"- PAINT	FOOT	52	52
70300281	TEMPORARY PAVEMENT MARKING - LINE 24"- PAINT	FOOT	69	69
* 78001100	PAINT PAVEMENT MARKING - LETTERS AND SYMBOLS	SQ FT	63	63
* 78001130	PAINT PAVEMENT MARKING - LINE 6"	FOOT	24005	24005
* 78001150	PAINT PAVEMENT MARKING - LINE 12"	FOOT	52	52
* 78001180	PAINT PAVEMENT MARKING - LINE 24"	FOOT	69	69
78300200	RAISED REFLECTIVE PAVEMENT MARKER REMOVAL	EACH	107	107

CODE NO.	ITEM	UNIT	TOTAL QUANTITY	CONSTR. CODE
				100% STATE
				ROADWAY
				0005 URBAN
78300201	PAVEMENT MARKING REMOVAL - GRINDING	SQ FT	8040	8040
X1500005	BITUMINOUS SURFACE TREATMENT, A2	SQ YD	21834	21834
X4060107	BITUMINOUS MATERIALS (FOG SEAL)	POUND	8734	8734
X7810400	TEMPORARY RAISED PAVEMENT MARKER	EACH	1089	1089
Z0048665	RAILROAD PROTECTIVE LIABILITY INSURANCE	L SUM	1	1

REV - MS

	USER NAME = rahshun.miller	DESIGNED -	REVISED -	STATE OF ILLINOIS DEPARTMENT OF TRANSPORTATION	SUMMARY OF QUANTITIES			F A U RTE.	SECTION	COUNTY	TOTAL SHEETS	SHEET NO.
		DRAWN -	REVISED -					9206	64Q	ST. CLAIR	6	3
		CHECKED -	REVISED -					CONTRACT NO. 76U72				
	PLOT DATE = 10/7/2025	DATE -	REVISED -		SCALE: NTS	SHEET 1	OF 1 SHEETS	STA.	TO STA.	ILLINOIS FED. AID PROJECT		

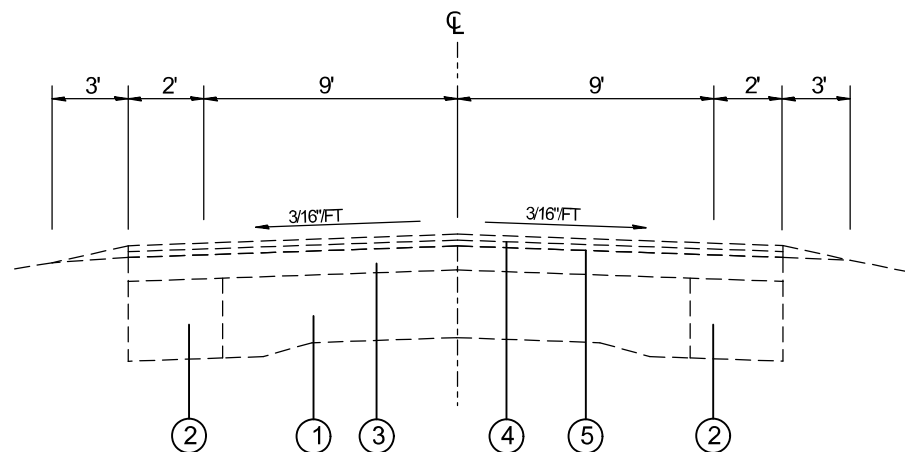

EXISTING TYPICAL SECTION

FAU 9206 (WATER ST.)

STA. 15+56 TO STA. 44+51
STA. 54+55 TO STA. 62+80
STA. 74+16 TO STA. 74+28 (PCC PAVEMENT OMISSION)
STA. 75+19 TO STA. 76+05
STA. 76+05 TO STA. 79+82 (BRIDGE OMISSION)
STA. 79+82 TO STA. 80+08
STA. 80+50 TO STA. 80+62 (PCC PAVEMENT OMISSION)
STA. 82+21 TO STA. 104+68

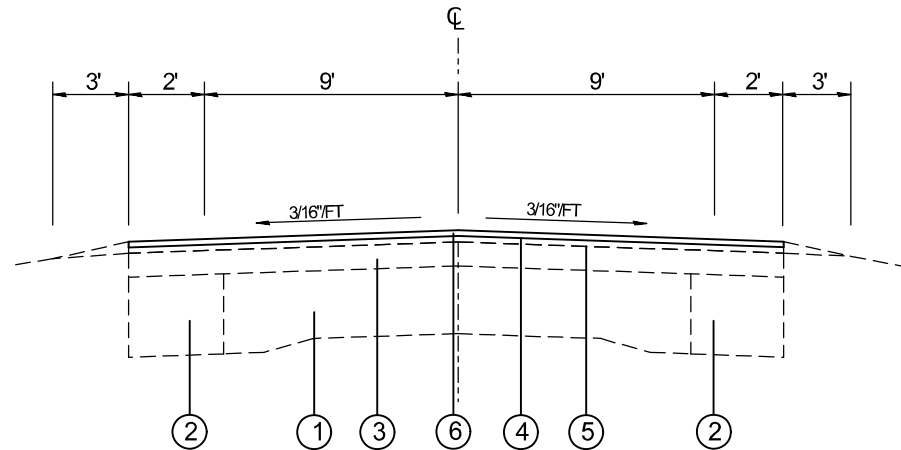

PROPOSED TYPICAL SECTION

FAU 9206 (WATER ST.)

STA. 15+56 TO STA. 44+51
STA. 54+55 TO STA. 62+80
STA. 74+16 TO STA. 74+28 (PCC PAVEMENT OMISSION)
STA. 75+19 TO STA. 76+05
STA. 76+05 TO STA. 79+82 (BRIDGE OMISSION)
STA. 79+82 TO STA. 80+08
STA. 80+50 TO STA. 80+62 (PCC PAVEMENT OMISSION)
STA. 82+21 TO STA. 104+68

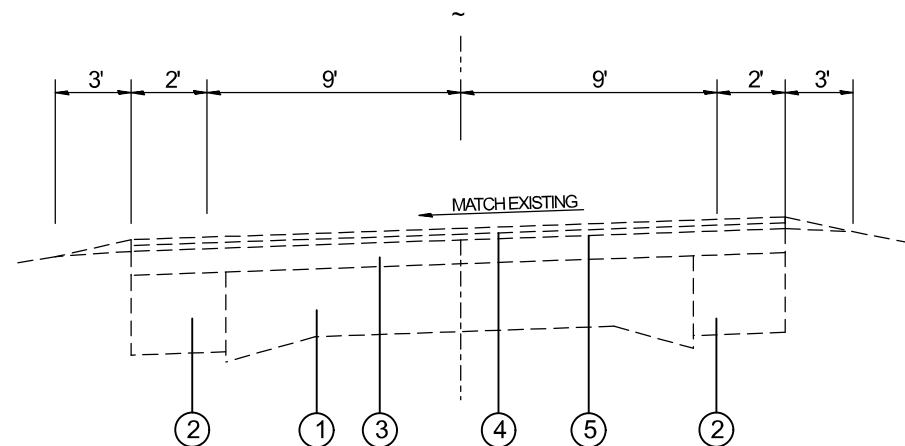

EXISTING TYPICAL SECTION

FAU 9206 (WATER ST.)

STA. 44+51 TO STA. 54+55
STA. 62+80 TO STA. 74+16
STA. 74+28 TO STA. 75+19
STA. 80+08 TO STA. 80+50
STA. 80+62 TO STA. 82+21

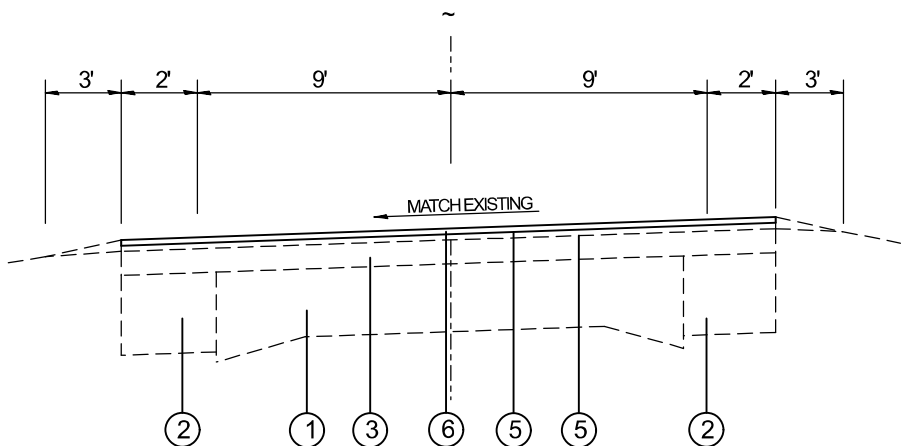

PROPOSED TYPICAL SECTION

FAU 9206 (WATER ST.)

STA. 44+51 TO STA. 54+55
STA. 62+80 TO STA. 74+16
STA. 74+28 TO STA. 75+19
STA. 80+08 TO STA. 80+50
STA. 80+62 TO STA. 82+21

LEGEND

- ① EXISTING PCC PAVEMENT (9"-7"-9")
- ② EXISTING 8" P.C.C. BASE COURSE WIDENING
- ③ EXISTING RESURFACING 3"
- ④ EXISTING LEVELING BINDER (MM), MIX C, TYPE 2, 3/4"
- ⑤ EXISTING BIT CONC SURF CRSE, MIX D, CL I, TYP 2, 1 1/2"
- ⑥ PROPOSED CHIP SEAL

STATE OF ILLINOIS
DEPARTMENT OF TRANSPORTATION

TYPICAL SECTION

SCALE: NTS SHEET 1 OF 1 SHEETS STA. TO STA.

F.A.U. RTE.	SECTION	COUNTY	TOTAL SHEETS	SHEET NO.
9206	64Q	ST. CLAIR	6	2
CONTRACT NO. 76U72				
ILLINOIS FED. AID PROJECT				

MODEL: Typical [Sheet]
FILE NAME: c:\pav_work\pav\miller\rajd1140456\B676U72-sh-typicals.dgn

USER NAME = rahshun.miller	DESIGNED -	REVISED -
	DRAWN -	REVISED -
	CHECKED -	REVISED -
PLOT DATE = 10/7/2025	DATE -	REVISED -

PAVEMENT MARKING SCHEDULE

STA	TO	STA	LENGTH	NO PASSING DIRECTION NB/SB	PAINT LINE 6"		THERMO LINE 6"				THERMOPLASTIC			RAISED REFLECTIVE PAVEMENT MARKERS		WORK ZONE PAVEMENT MARKINGS REMOVAL	SHORT TERM PAVEMENT MARKINGS	PAVEMENT MARKING REMOVAL	TEMPORARY RPM
					YELLOW	WHITE	WHITE		YELLOW	YELLOW	YELLOW	WHITE	WHITE						
					LANE LINE	EDGE LINE	EDGE LINE	ISLAND @ IL 3	LANE LINE	10' - 30' SKIP-DASH	LINE 12"	LINE 24"	LETTERS AND SYMBOLS						
			FOOT		FOOT	FOOT	FOOT	FOOT	FOOT	FOOT	FOOT	FOOT	SQ FT	AMBER	REMOVAL	SQ FT	FOOT	SQ FT	EACH
15+36	TO	104+68	8557				17114	52						107	107	5977	778	5977	1089
15+26	TO	16+13	87	NB/SB					348		52					168		168	
16+13	TO	20+20	407	SB					407	103						170		170	
20+20	TO	67+72	4752							1188						396		396	
67+72	TO	76+31	859	SB					859	215						358		358	
BRIDGE OMISSION																			
76+31	TO	79+82	351	NB/SB	702	702													
79+82	TO	91+48	1166	NB					1166	292						486		486	
91+48	TO	99+40	792							198						66		66	
99+40	TO	104+68	528	SB					528	132						220		220	
103+68												22	61.2			105		105	
104+68												11				22		22	
16+00												14				28		28	
16+05												22				44		44	
15+50																			
SUB TOTAL :					702	702	17114	52	3308	2127	52								
TOTAL :					1404		22601				52	69	61.2	107	107	8,040	778	8040	1089

RESURFACING SCHEDULE

STATION	TO	STATION	LENGTH	WIDTH	BITUMINOUS SURFACE TREATMENT A2	BITUMINOUS FOG SEAL
			(FOOT)	(FOOT)	(SQ YD)	(LBS)
15+36	TO	74+16	5880	22	14373	5749.3
PCC OMISSION						
74+16	TO	74+28	12	22	29	11.7
74+28	TO	76+31	203	22	496	198.5
BRIDGE OMISSION						
76+31	TO	79+82	351	22	858	343.2
79+82	TO	80+50	68	22	166	66.5
PCC OMISSION						
80+50	TO	80+62	12	22	29	11.7
80+62	TO	104+68	2406	22	5881	2352.5
TOTAL :					21834	8734

MODEL: Schedule [Sheet]
FILE NAME: c:\pw_work\pwtdmiller\rajd1140456\0876\U72-sh-schedules.dgn

USER NAME = rahshun.miller	DESIGNED -	REVISED -
	DRAWN -	REVISED -
	CHECKED -	REVISED -
PLOT DATE = 9/15/2025	DATE -	REVISED -

STATE OF ILLINOIS
DEPARTMENT OF TRANSPORTATION

SCHEDULE OF QUANTITIES

SCALE: NTS SHEET 1 OF 1 SHEETS STA. TO STA.

F.A.U RTE.	SECTION	COUNTY	TOTAL SHEETS	SHEET NO.
9206	64Q	ST. CLAIR	6	4
CONTRACT NO. 76U72				
ILLINOIS FED. AID PROJECT				

MODEL: Location Map (Sheet)
FILE NAME: c:\p\work\p\dwg\miller\rajd1140456\0876U72-sh-locationmap.dgn

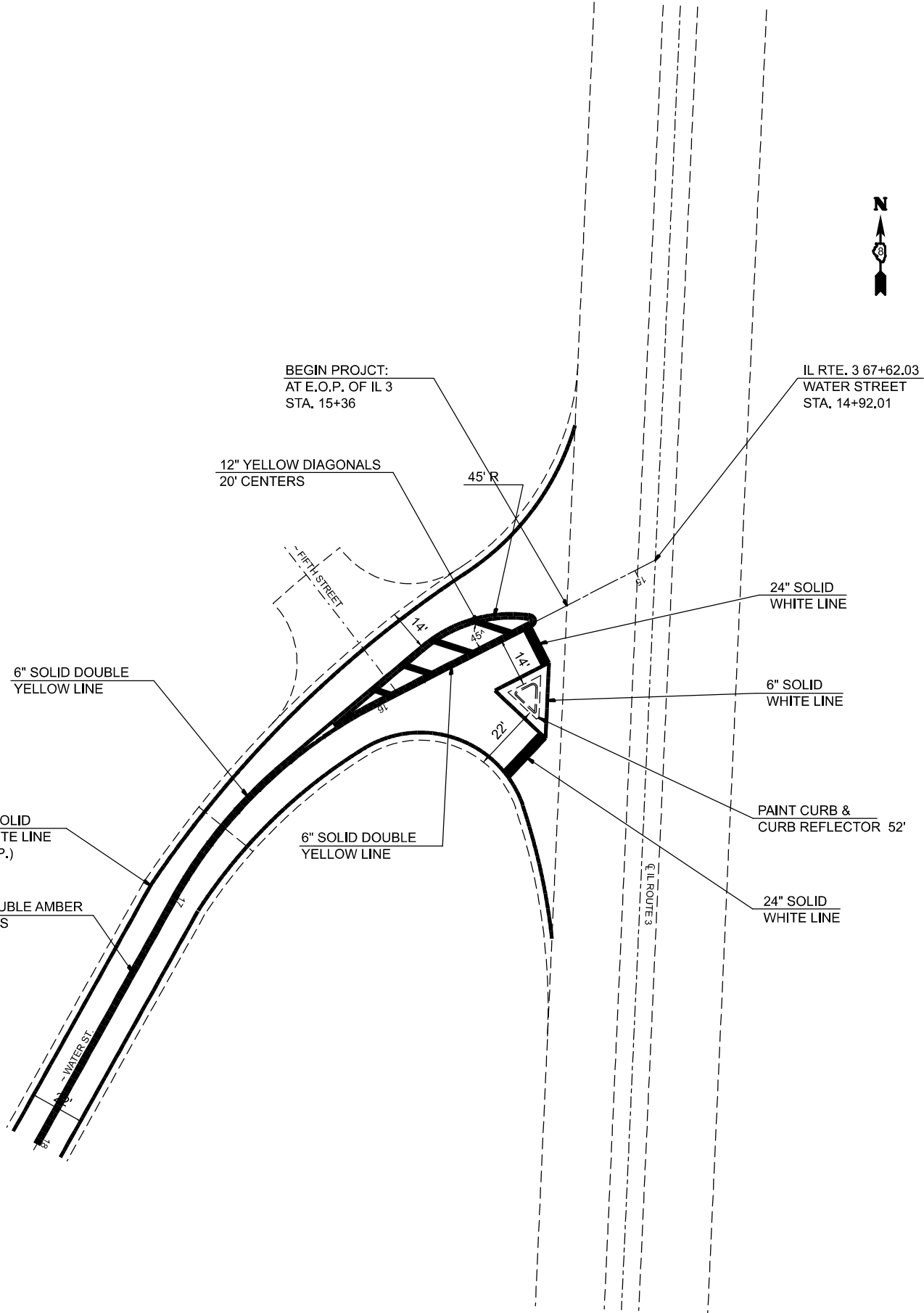
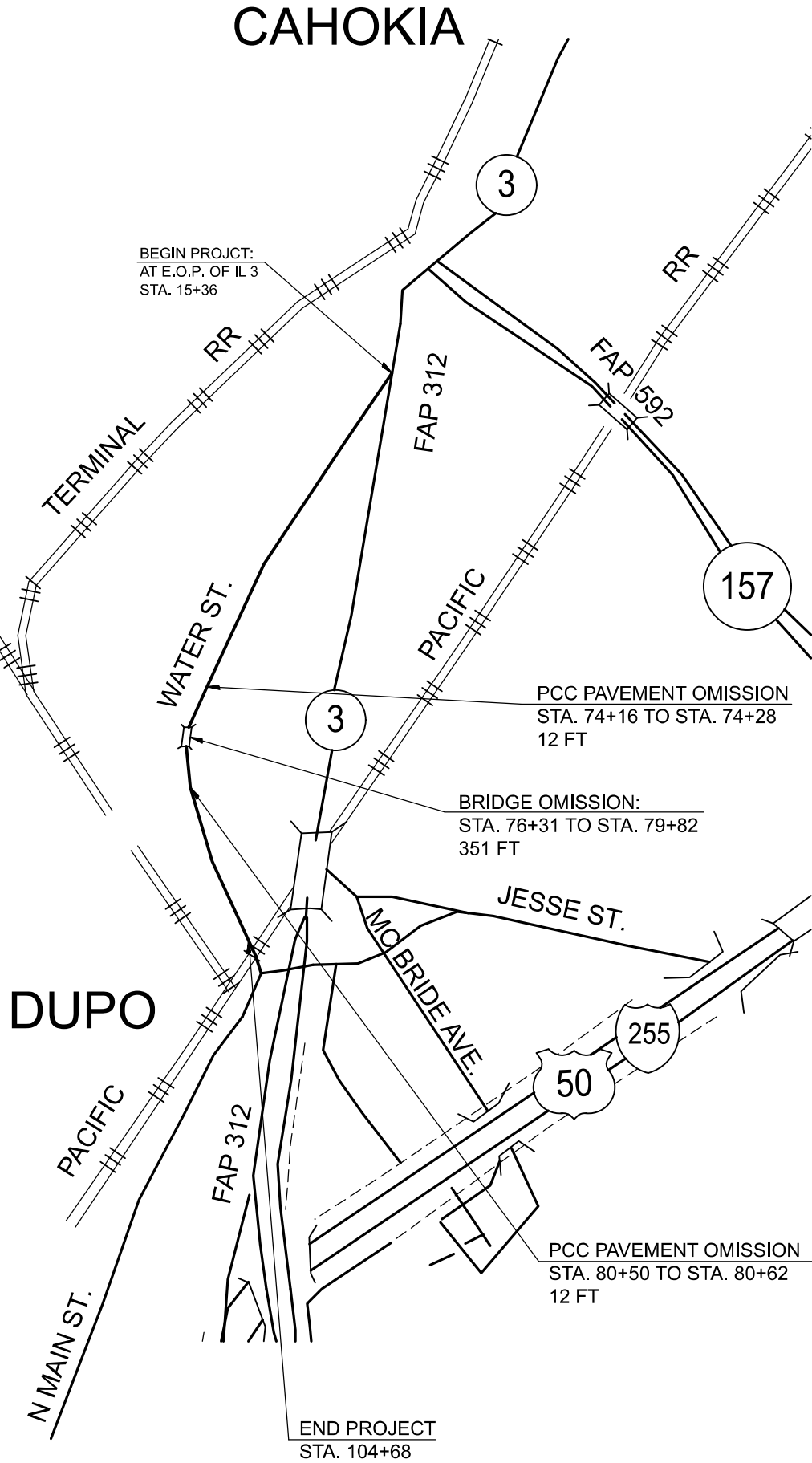

STATE OF ILLINOIS
DEPARTMENT OF TRANSPORTATION

LOCATION MAP, DETAIL

SCALE: NTS SHEET 1 OF 1 SHEETS STA. TO STA.

F.A.U RTE.	SECTION	COUNTY	TOTAL SHEETS	SHEET NO.
9206	64Q	ST. CLAIR	6	3
CONTRACT NO. 76U72				
ILLINOIS FED. AID PROJECT				