

INDEX OF SHEETS

- 1. COVER SHEET
- 2. GENERAL NOTES
- 3. SUMMARY OF QUANTITIES
- 4. TYPICAL SECTIONS
- 5. TRAFFIC CONTROL DETAILS
- 6. TEMPORARY CONCRETE BARRIER WALL / GUARDRAIL DELINEATION
- 7. TEMPORARY INFORMATION SIGNING

HIGHWAY STANDARDS

- 000001- 09 STANDARD SYMBOLS, ABBREVIATIONS AND PATTERNS
- 001006 DECIMAL OF AN INCH AND OF A FOOT
- 701001-02 OFF-ROAD OPERATIONS 2L, 2W, MORE THAN 15' AWAY
- 701006-05 OFF-ROAD OPERATIONS 2L, 2W, 15' TO 24" FROM PAVEMENT EDGE
- 701201-05 LANE CLOSURE, 2L, 2W, DAY ONLY, FOR SPEEDS ≥ 45 MPH
- 701301-04 LANE CLOSURE, 2L, 2W, SHORT TIME OPERATIONS
- 701321-19 LANE CLOSURE, 2L, 2W, BRIDGE REPAIR WITH BARRIER
- 701901- 11 TRAFFIC CONTROL DEVICES
- 704001-08 TEMPORARY CONCRETE BARRIER

PROJECT LOCATION

STRUCTURE NO. 019-0012
CARRYING F.A.P. ROUTE 17 (IL 64)
OVER THE KISHWAUKEE RIVER
1.5 MILES WEST OF JCT. IL 23

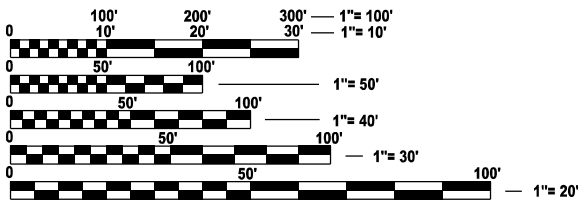

FULL SIZE PLANS HAVE BEEN PREPARED USING STANDARD
ENGINEERING SCALES. REDUCED SIZED PLANS WILL NOT
CONFORM TO STANDARD SCALES. IN MAKING MEASUREMENTS
ON REDUCED PLANS, THE ABOVE SCALES MAY BE USED.

J.U.L.I.E.
JOINT UTILITY LOCATION INFORMATION FOR EXCAVATION
1-800-892-0123
OR 811

PROJECT ENGINEER JUNIOR SENAT P.E.
UNIT CHIEF RON WOODSHANK
DISTRICT 3 (815) 434-6131
CONTRACT NO. 66R90

STATE OF ILLINOIS
DEPARTMENT OF TRANSPORTATION

PROPOSED
HIGHWAY PLANS
F.A.P. ROUTE 17 (IL 64)
SECTION (125BR)BP
PROJECT
BRIDGE PAINTING
DEKALB COUNTY
C-93-153-25

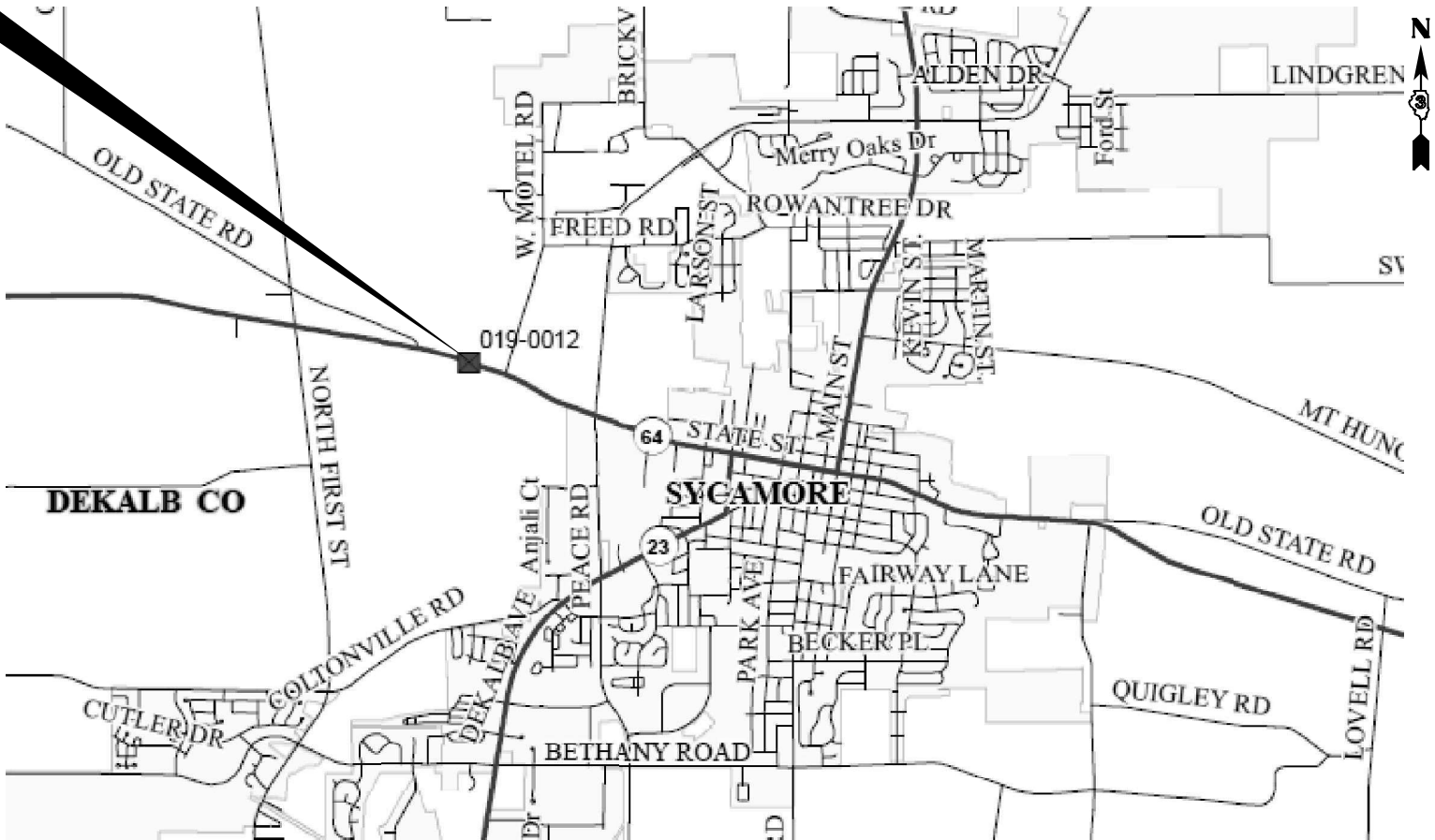

POINT LOCATION

F.A.P. RTE.	SECTION	COUNTY	TOTAL SHEETS	SHEET NO.
17	(125BR)BP	DEKALB	7	1
ILLINOIS CONTRACT NO. 66R90				

D-93-115-25



FUNCTIONAL CLASSIFICATION
URBAN - OTHER PRINCIPAL ARTERIAL
F.A.P. ROUTE 17 (IL ROUTE 64)
2023 ADT = 7,650
P.V. 85.0 % S.U. 7.0 % M.U. 8.0 %

STATE OF ILLINOIS
DEPARTMENT OF TRANSPORTATION

SUBMITTED October 16, 2025
Trisha Thompson REGIONAL ENGINEER

December 5, 2025
Scott Etk ENGINEER OF DESIGN AND ENVIRONMENT

December 5, 2025
James DIRECTOR OF HIGHWAYS PROJECT IMPLEMENTATION

PRINTED BY THE AUTHORITY
OF THE STATE OF ILLINOIS

GENERAL NOTES

PLAN DIMENSIONS AND DETAILS RELATIVE TO THE EXISTING STRUCTURE HAVE BEEN TAKEN FROM EXISTING PLANS ARE SUBJECT TO NOMINAL CONSTRUCTION VARIATIONS. THE CONTRACTOR SHALL FIELD VERIFY EXISTING DIMENSIONS AND DETAILS AFFECTING NEW CONSTRUCTION AND MAKE NECESSARY APPROVED ADJUSTMENTS PRIOR TO CONSTRUCTION OR ORDERING OF MATERIALS. SUCH VARIATIONS SHALL NOT BE CAUSE FOR ADDITIONAL COMPENSATION FOR A CHANGE IN SCOPE OF THE WORK, HOWEVER, THE CONTRACTOR WILL BE PAID FOR THE QUANTITY ACTUALLY FURNISHED AT THE UNIT PRICE BID FOR THE WORK.

CLEANING AND PAINTING EXISTING STEEL / STRUCTURAL STEEL COMPONENTS

CLEANING AND PAINTING OF THE EXISTING STEEL / STRUCTURAL STEEL SHALL BE AS SPECIFIED IN THE SPECIAL PROVISION FOR "CLEANING AND PAINTING EXISTING STEEL STRUCTURES".

THE FOLLOWING STEEL / STRUCTURAL STEEL COMPONENTS SHALL BE CLEANED AND PAINTED.

- a) STRUCTURAL STEEL COMPONENTS

BEAMS / GIRDERS
STIFFENERS
DIAPHRAGMS
CROSS / LATERAL FRAMING
STEEL COMPONENTS OF BEARINGS
ANGLE BRACKETS / CLIPS
CONNECTION PLATES
ANCHORS / BOLTS
- b) STEEL COMPONENTS

DECK DRAINS (DOWN PIPES)
SCUPPERS (DOWN PIPES)
STEEL HANDRAILS (WHEN PRESENT)

OTHER STEEL / STRUCTURAL STEEL COMPONENTS WHEN PRESENT SHALL BE AS DIRECTED BY THE RESIDENT ENGINEER / TECHNICIAN.

STRUCTURE NO. 019-0012 SHALL BE CONSIDERED AS "LOCATION NO. 1".

EXISTING STRUCTURAL STEEL COATINGS FOR STRUCTURE NO. 019-0012 CONTAIN "LEAD BASED" PAINT COATINGS. THE CONTRACTOR SHALL TAKE APPROPRIATE PRECAUTIONS TO DEAL WITH LEAD PAINT ON THIS STRUCTURE.

SSPC QP1 AND SSPC QP2 "CONTRACTOR CERTIFICATION" IS REQUIRED FOR THIS STRUCTURE.

A MINIMUM OF TWO AIR MONITOR(S) WILL BE REQUIRED TO MONITOR ABRASIVE BLASTING OPERATIONS AT THIS SITE. AIR MONITORS SHALL BE FURNISHED AND INSTALLED AT THE LOCATIONS AS DIRECTED BY THE ENGINEER.

CLEANING EXISTING STEEL / STRUCTURAL STEEL COMPONENTS

CLEANING ALL EXISTING STEEL / STRUCTURAL STEEL SHALL BE CLEANED PER NEAR WHITE BLAST CLEANING, "SSPC-SP10".

SEE THE SPECIAL PROVISION FOR "CONTAINMENT AND DISPOSAL OF LEAD PAINT CLEANING RESIDUES.

PAINTING EXISTING STEEL / STRUCTURAL STEEL COMPONENTS

ALL EXISTING STEEL / STRUCTURAL STEEL SHALL BE PAINTED ACCORDING TO THE REQUIREMENTS OF PAINT SYSTEM 1 - OZ/E/U.

- 1) THE COLOR OF THE FINAL FINISH COAT FOR ALL INTERIOR STEEL / STRUCTURAL STEEL SURFACES SHALL BE GRAY, MUNSELL NO 5B 7/1.
- 2) THE COLOR OF THE FINAL FINISH COAT FOR THE EXTERIOR AND BOTTOM FLANGE OF THE FASCIA BEAMS, STEEL COMPONENTS OF FASCIA BEARINGS, DECK DRAINS / SCUPPERS AND STEEL HANDRAILS (WHEN PRESENT) SHALL BE "GREEN, MUNSELL NO. 7.5G 1/2.

DISPOSAL OF CLEANING AND PAINTING RESIDUES

THE CONTRACTOR SHALL BE REQUIRED TO SECURE WASTE CONTAINERS THAT REMAIN ON THE JOB SITE. THIS WILL ENTAIL THAT ALL WASTE CONTAINERS CANNOT BE MOVED OR OPENED DURING NON-WORKING HOURS.

WORKING DAYS SHALL BE CHARGED UNTIL THE CONTRACTOR / SUBCONTRACTOR LISCENSED TO REMOVE AND DISPOSE OF LEAD PAINT RESIDUES HAS REMOVED THE WASTE MATERIAL FROM THE JOB SITE ACCORDING TO ALL FEDERAL, STATE AND LOCAL ORDINANCES. IF THE CONTRACTOR / SUBCONTRACTOR FAILS TO REMOVE AND DISPOSE OF THE LEAD PAINT RESIDUES WITHIN THE WORKING DAYS STIPULATED, LIQUIDATED DAMAGES SHALL BE CHARGED PER CALENDAR DAY ACCORDING TO ARTICLE 108.09 OF THE STANDARD SPECIFICATIONS UNTIL SUCH TIME THAT ALL PAINT RESRESUDUES HAVE BEEN REMOVED AND DISPOSED OF.

COMMITMENTS

NONE.

STATE OF ILLINOIS
DEPARTMENT OF TRANSPORTATION
DISTRICT THREE
AS BUILT INFORMATION

SUPERVISING CONSTRUCTION FIELD ENGINEER

RESIDENT ENGINEER / TECHNICIAN

START & END DATES
OF CONSTRUCTION:

INSPECTORS:

MODEL: Default
FILE NAME: c:\pwworking\woodshank\rd1138973\0366R90.dgn

	USER NAME = ronald.woodshank	DESIGNED - RW	REVISED	STATE OF ILLINOIS DEPARTMENT OF TRANSPORTATION	GENERAL NOTES			F.A.P. RTE.	SECTION	COUNTY	TOTAL SHEETS	SHEET NO.
		DRAWN - RW	REVISED -					17	(125BR)BP	DEKALB	7	2
		CHECKED - JS	REVISED -					CONTRACT NO. 66R90				
	PLOT DATE = 9/4/2025	DATE - 7/9/2025	REVISED -		SCALE:	SHEET 1	OF 1 SHEETS	STA.	TO STA.	ILLINOIS FED. AID PROJECT		

MODEL: Default
FILE NAME: c:\pwwork\pwwork\woodshank\rd1138973\D366R90.dgn

CODE NO.	ITEM	UNIT	TOTAL QUANTITY	CONSTRUCTION CODE
				BRIDGE PAINTING
				100% STATE
				BRIDGE
				0047
				S.N. 019-0012
67100100	MOBILIZATION	L SUM	1	1
70100405	TRAFFIC CONTROL AND PROTECTION, STANDARD 701321	EACH	1	1
70100450	TRAFFIC CONTROL AND PROTECTION, STANDARD 701201	L SUM	1	1
70106500	TEMPORARY BRIDGE TRAFFIC SIGNALS	EACH	1	1
70106700	TEMPORARY RUMBLE STRIPS	EACH	6	6
70400100	TEMPORARY CONCRETE BARRIER	FOOT	326	326
70600251	IMPACT ATTENUATORS, TEMPORARY (NON- REDIRECTIVE, NARROW), TEST LEVEL 3	EACH	2	2
* 78009006	MODIFIED URETHANE PAVEMENT MARKING - LINE 6"	FOOT	170	170
78300202	PAVEMENT MARKING REMOVAL - WATER BLASTING	SQ FT	85	85
X5067501	BRIDGE CLEANING AND PAINTING WARRANTY NUMBER 1	L SUM	1	1
X7200061	TEMPORARY INFORMATION SIGNING	SQ FT	42	42
Z0007101	CONTAINMENT AND DISPOSAL OF LEAD PAINT CLEANING RESIDUES NO. 1	L SUM	1	1
Z0010501	CLEANING AND PAINTING STEEL BRIDGE NO. 1	L SUM	1	1

*SPECIALITY ITEMS

	USER NAME = ronald.woodshank	DESIGNED - RW	REVISED -	STATE OF ILLINOIS DEPARTMENT OF TRANSPORTATION	SUMMARY OF QUANTITIES				F.A.P. RTE.	SECTION	COUNTY	TOTAL SHEETS	SHEET NO.
		DRAWN - RW	REVISED -						17	(125BR)BP	DEKALB	7	3
		CHECKED - JS	REVISED -						CONTRACT NO. 66R90				
	PLOT DATE = 9/4/2025	DATE - 7/9/2025	REVISED -		SCALE:				SHEET 1	OF 1	SHEETS	STA.	TO STA.

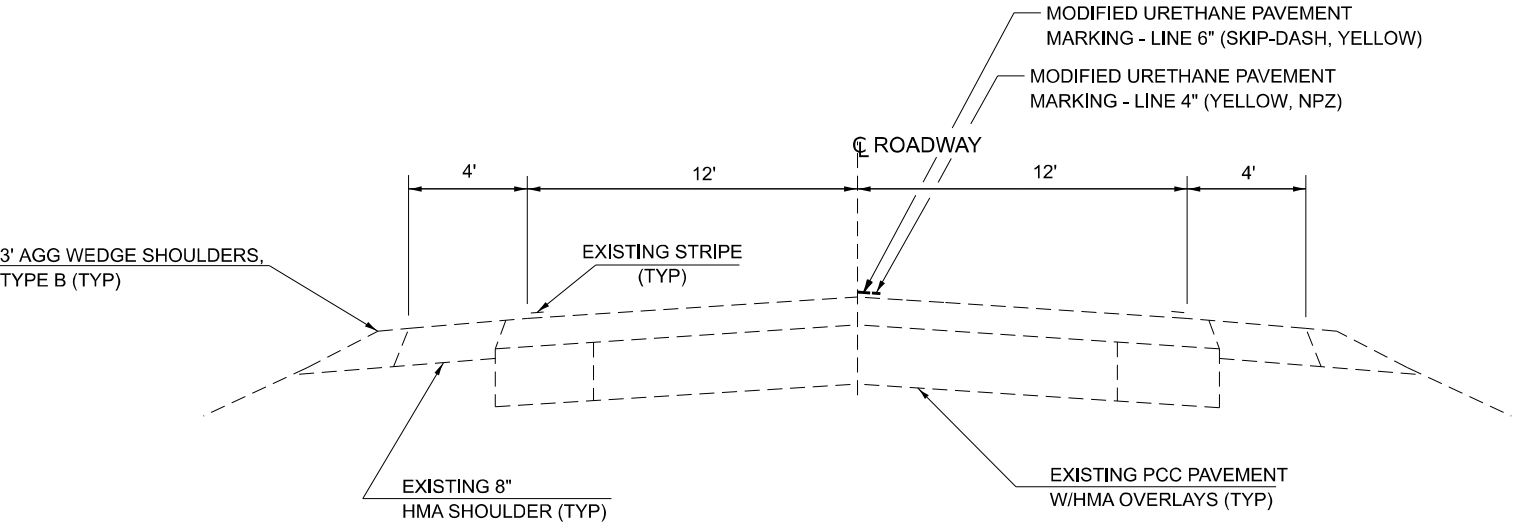

PROPOSED TYPICAL SECTION

STA. 318+90 TO STA. 612+00
STA. 613+83 TO STA. 665+92

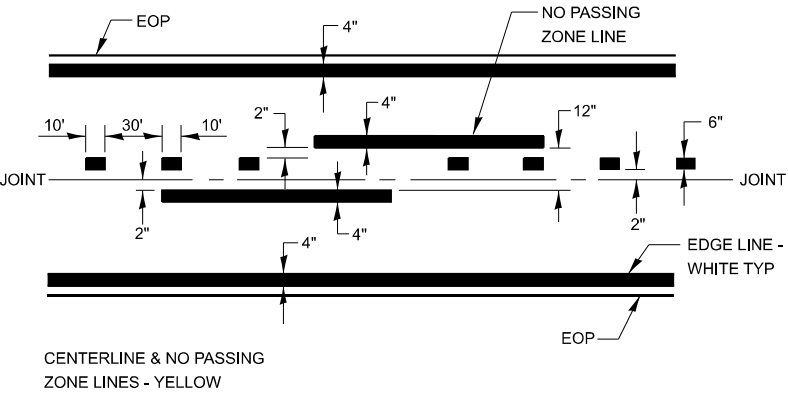

PAVEMENT MARKING

MODEL: Default
FILE NAME: c:\pwwork\pwwork\woodshank\1136973\136973\136973\136973.dgn

	USER NAME = ronald.woodshank	DESIGNED - RW	REVISED -	STATE OF ILLINOIS DEPARTMENT OF TRANSPORTATION	TYPICAL SECTION			F.A.P. RTE. 17	SECTION (125BR)BP	COUNTY DEKALB	TOTAL SHEETS 7	SHEET NO. 4
		DRAWN - RW	REVISED -									
		CHECKED - JS	REVISED -		SCALE: SHEET 1 OF 1 SHEETS STA. TO STA.			CONTRACT NO. 66R90				
	PLOT DATE = 9/4/2025	DATE - 7/9/2025	REVISED -					ILLINOIS FED. AID PROJECT				

MODEL: Default
FILE NAME: c:\pwwork\pwwork\woodshank\1138973\0366R90.dgn

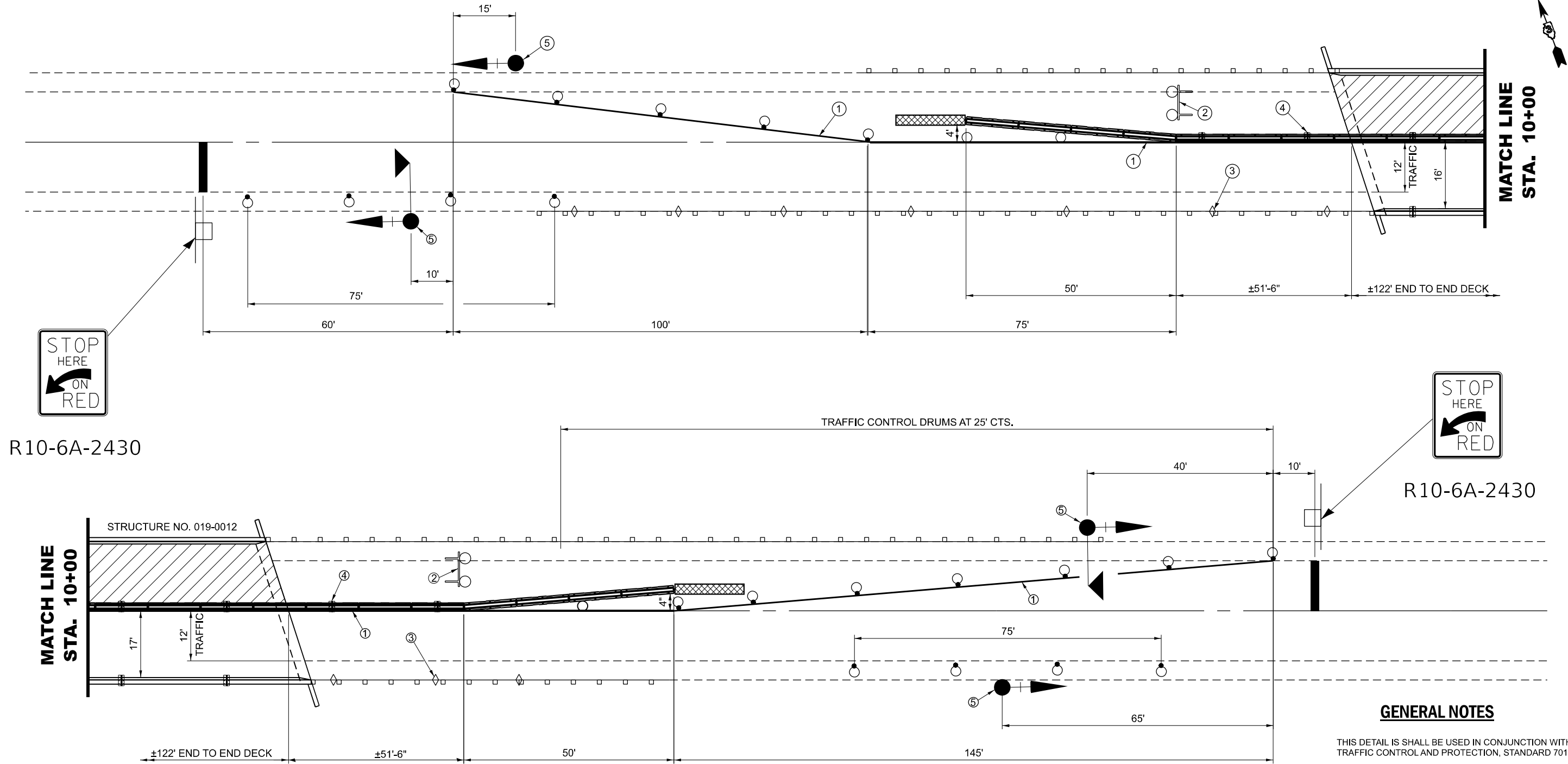

R10-6A-2430

R10-6A-2430

SYMBOLS



WORK AREA



SIGN



TYPE III BARRICADE
WITH FLASHING LIGHTS



IMPACT ATTENUATOR



DRUM (TANGENT ONLY)



TRAFFIC SIGNAL WITH BACK PLATE
AND MICROWAVE DETECTOR



DRUM WITH STEADY BURNING
BI-DIRECTIONAL LIGHT (TAPER ONLY)



TEMPORARY CONCRETE BARRIER



BARRIER WALL REFLECTOR, TYPE "C"



CRYSTAL, BIDIRECTIONAL
GUARDRAIL REFLECTOR



FLASHING BI-DIRECTIONAL LIGHT



TRAFFIC SIGNAL WITH BACK PLATE

- ① TEMPORARY PAVEMENT MARKING
- ② TYPE III BARRICADE TO BE PLACED WHEN NO WORK IS BEING PERFORMED.
- ③ GUARDRAIL REFLECTORS, TYPE "A" AT 25' CTS. SEE SHEET 6 OF 7 FOR DETAILS.
- ④ BARRIER WALL REFLECTORS TYPE "C" AT 25' CTS. SEE SHEET 6 OF 7 FOR DETAILS AND STANDARD.
- ⑤ THE EDGE OF THE POST MOUNTED SIGNAL HEAD SHALL BE BETWEEN 24" AND 6' FROM EDGE OF SHOULDER.

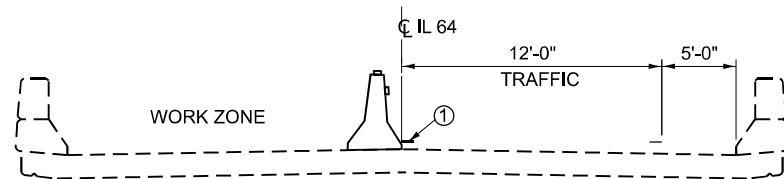

CROSS SECTION

LOOKING EAST

GENERAL NOTES

THIS DETAIL IS SHALL BE USED IN CONJUNCTION WITH TRAFFIC CONTROL AND PROTECTION, STANDARD 701321.

TRAFFIC SIGNALS SHALL BE OPERATIONAL ONLY WHEN ALL TRAFFIC CONTROLS ARE IN PLACE. WHEN TRAFFIC SIGNALS ARE NOT IN OPERATION, FLAGGERS SHALL BE USED AND TRAFFIC CONTROL SHALL CONFORM TO STANDARD 701201 OR 701206.

TEMPORARY CONCRETE BARRIER SHALL BE ACCORDING TO STANDARD 704001.

TEMPORARY CONCRETE BARRIER DELINEATION SHALL BE ACCORDING TO THE DETAILS AS PROVIDD IN THE PLANS.

EXISTING OR TEMPORARY PAVEMENT MARKINGS SHALL BE ON BOTH SIDES OF OPEN LANE FROM STOP BAR TO STOP BAR.

USER NAME: Donald Woodshank	DESIGNED - RW	REVISED -
	DRAWN - RW	REVISED -
	CHECKED - JS	REVISED -
PLOT DATE: 9/4/2025	DATE - 7/8/2025	REVISED -

STATE OF ILLINOIS
DEPARTMENT OF TRANSPORTATION

TRAFFIC CONTROL DETAILS

SCALE: SHEET 1 OF 1 SHEETS STA. TO STA.

F.A.P. RTE.	SECTION	COUNTY	TOTAL SHEETS	SHEET NO.
17	(125BR)BP	DEKALB	7	5
CONTRACT NO. 66R90				
ILLINOIS FED. AID PROJECT				

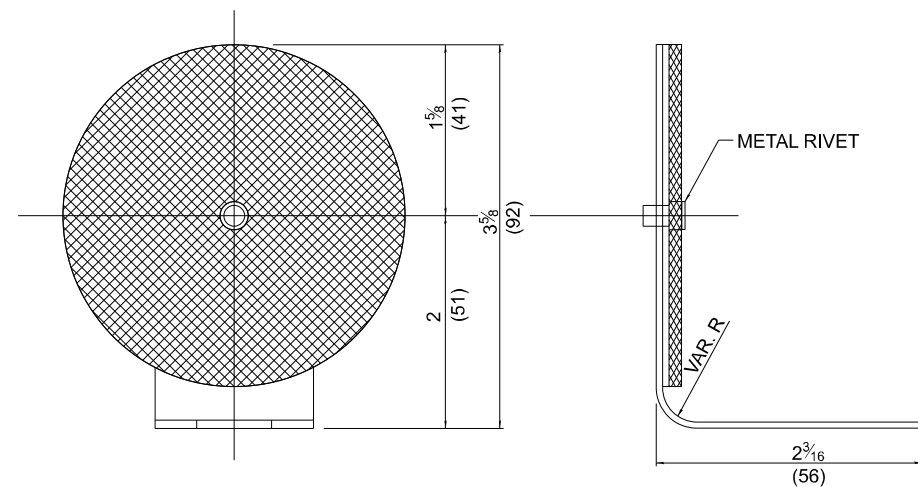
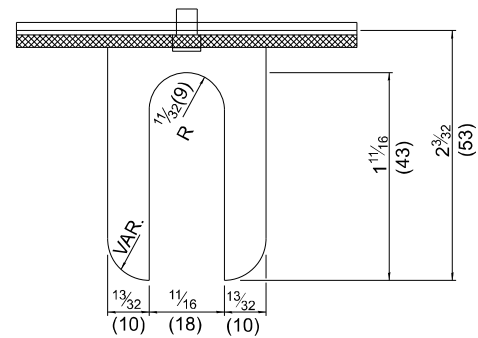
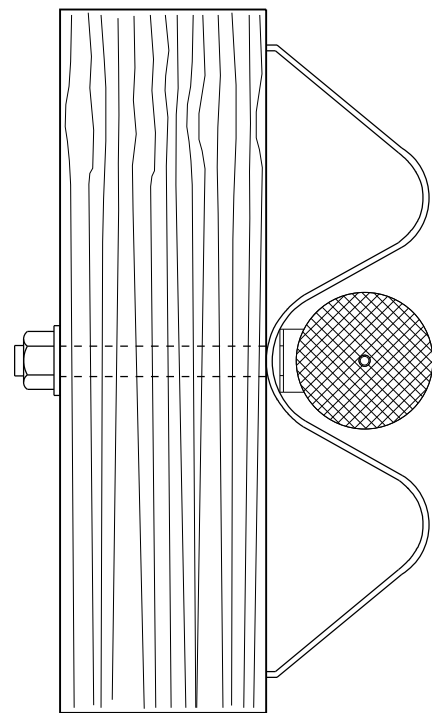
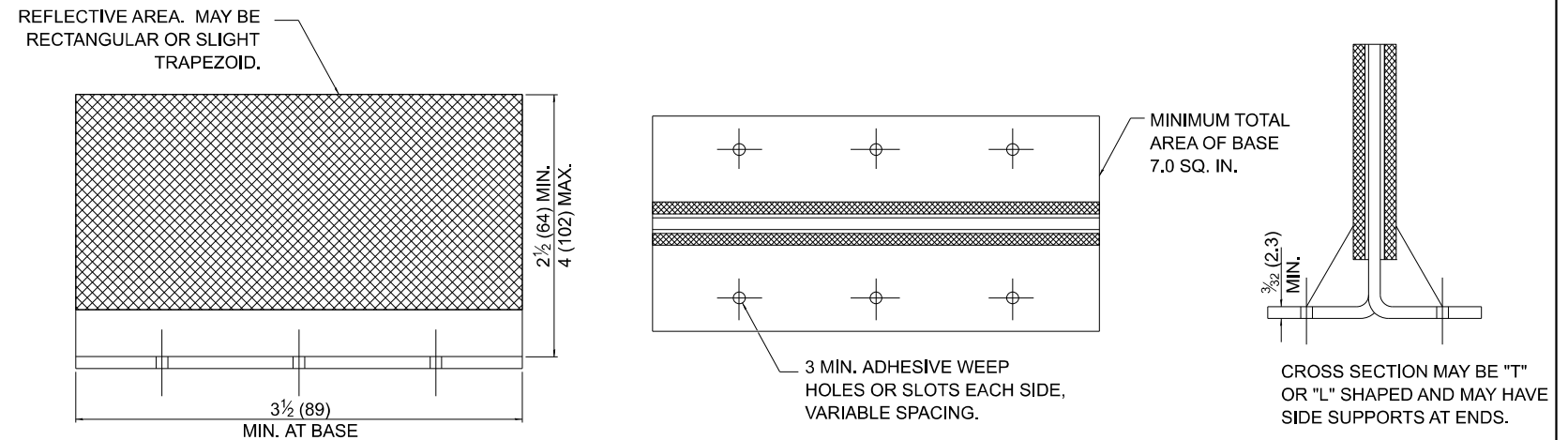
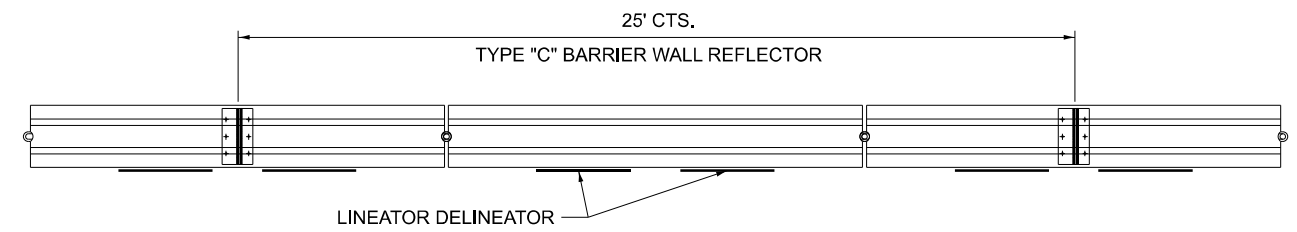
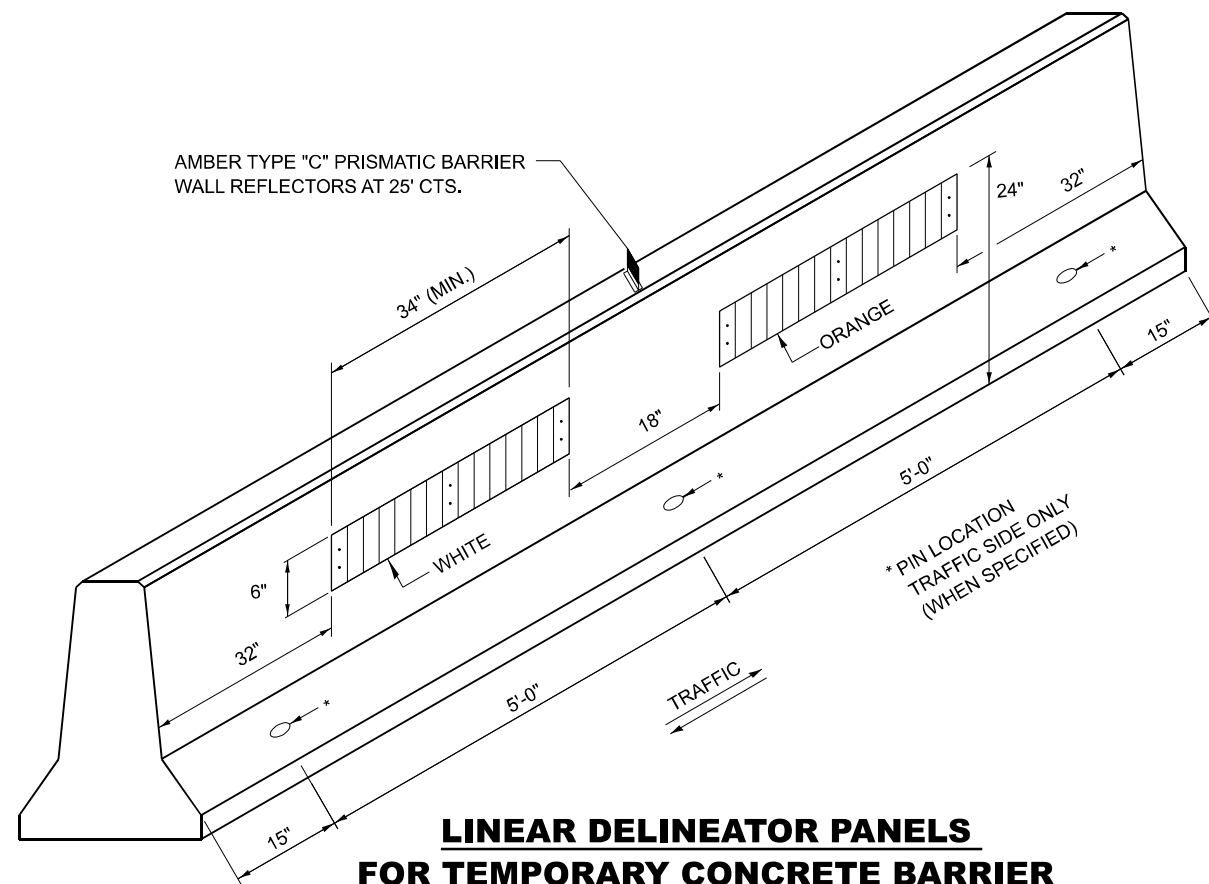

<div>USER NAME: Ronald.Woodshank</div> <div>DRAWN: RW</div> <div>CHECKED: JS</div> <div>PLOT DATE: 9/4/2025</div>	DESIGNED - RW	REVISED -	<div>STATE OF ILLINOIS</div> <div>DEPARTMENT OF TRANSPORTATION</div>	<div>TEMPORARY CONCRETE BARRIER WALL / GUARDRAIL DELINEATION</div>			F.A.P. RTE.	SECTION	COUNTY	TOTAL SHEETS	SHEET NO.
	DRAWN - RW	REVISED -					17	(125BR)BP	DEKALB	7	6
	CHECKED - JS	REVISED -					CONTRACT NO. 66R90				
	DATE - 7/8/2025	REVISED -		SCALE:	SHEET 1 OF 1 SHEETS	STA. TO STA.	ILLINOIS	FED. AID PROJECT			

