

TYPICAL URBAN ENTRANCE

QUANTITY URBAN ENTRANCE
 Section B'-B' to B-B= 0.1 cu. yd./ft.
 Section C-C to B'-B' + B-B to A-A= 0.69 cu. yd.

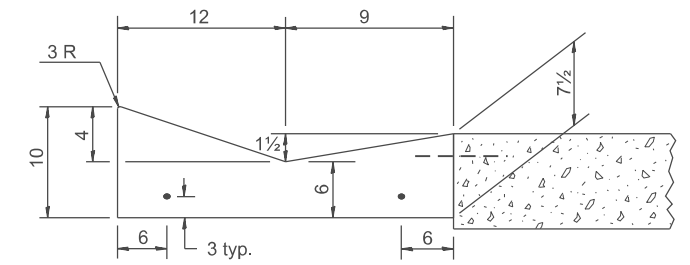

SECTION A-A & C-C

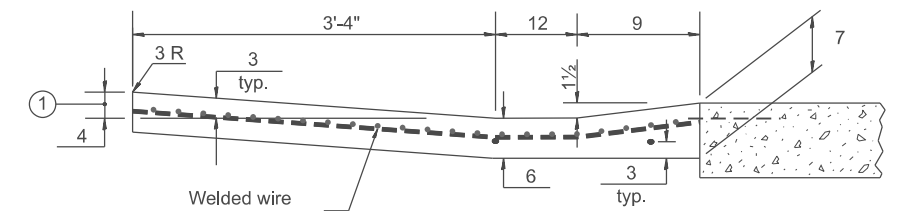

SECTION B-B & B'-B'

SPECIAL NOTES:
 ① 4 is the normal dimension. If specified in the plans, the following shall be used for improved entrance match-up: Minimum - 2 1/2 Maximum - 5

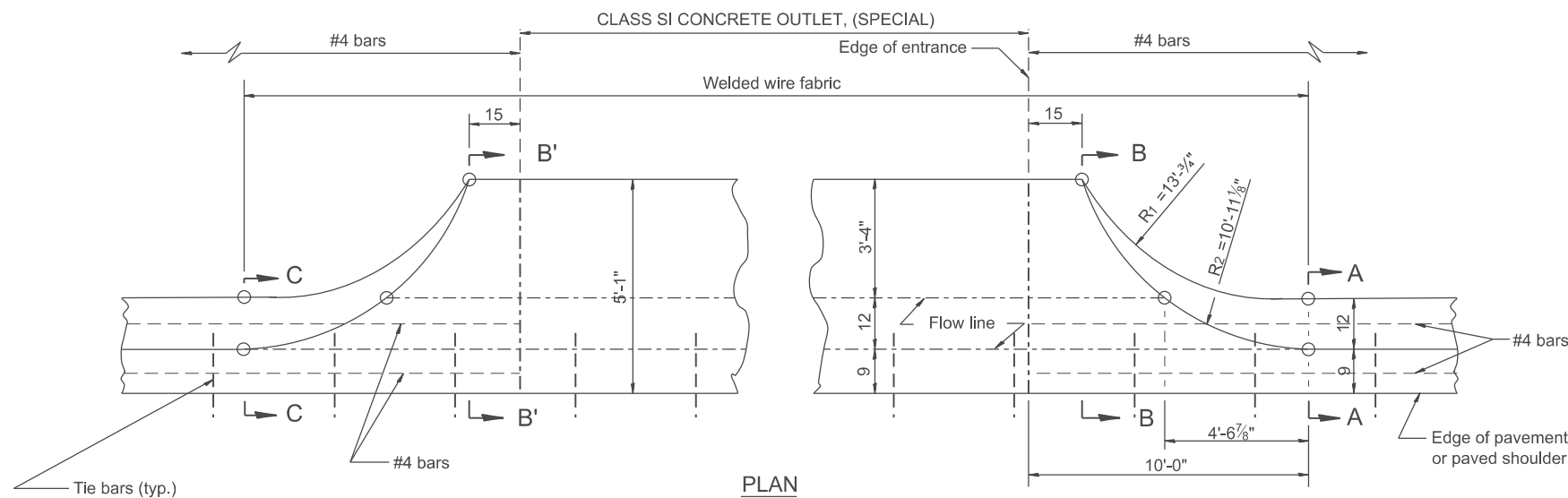

TYPICAL RURAL ENTRANCE

QUANTITY RURAL ENTRANCE
 Section B'-B' to B-B= 0.1 cu. yd./ft.
 Section C-C to B'-B' + B-B to A-A= 1.19 cu. yd.

MODEL: SHT_PLAN
 FILE NAME: C:\Bentley\CONNECT10110\organization\Chilidiot_Standards\Civil\DOT_Sheets.cad

QUANTITIES	
CALC. BY:	DATE:
CHECKED BY:	DATE:
QUANTITY CALCULATIONS ARE ON FILE AT THE DISTRICT 4 OFFICE; BUREAU OF PROJECT IMPLEMENTATION; DOCUMENTATION SECTION	

USER NAME = Eric.Thomas	DESIGNED -	REVISED -
	DRAWN -	REVISED -
	CHECKED -	REVISED -
PLOT DATE = 12/7/2022	DATE -	REVISED -

STATE OF ILLINOIS
 DEPARTMENT OF TRANSPORTATION

CONCRETE GUTTER, TYPE B, (SPECIAL)
 (INLET, OUTLET & ENTRANCE)

SCALE: NOT TO SCALE SHEET 3 OF 3 SHEETS STA. TO STA.

All dimensions are in inches unless otherwise noted.

F.A. RTE.	SECTION	COUNTY	TOTAL SHEETS	SHEET NO.
	DISTRICT 4 DETAIL NO. 606201			
CONTRACT NO.		ILLINOIS FED. AID PROJECT		