

EXISTING BOX		A	B	D	t	EACH COLLAR				EXPANSION BOLT EACH
W	H					REINFORCEMENT BARS				
						CONC. COLLAR CU. YD.	g	L	LBS.	
12 PIPE		32	32	12	2	0.18	10	4'-7"	12	4
18 PIPE		39	39	18	2½	0.24	12¾	5'-6"	15	4
24 PIPE		3'-10"	3'-10"	24	3	0.30	15¾	6'-6"	17	4
24	24	4'-5"	4'-5"	30	3½	0.37	18¾	7'-6"	20	4
30	30	5'-0"	5'-0"	36	4	0.45	21½	8'-5"	22.5	8
36	36	5'-7"	5'-7"	42	4½	0.50	24½	9'-5"	25	10
42	42	6'-2"	6'-2"	48	5	0.61	27¼	10'-4"	28	10
48	48	6'-9"	6'-9"	54	5½	0.80	30¼	11'-4"	30	10

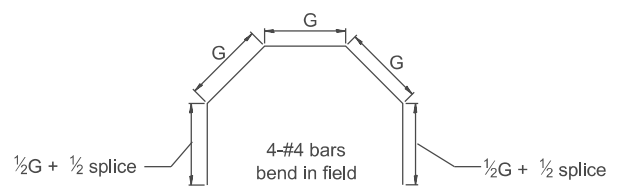

GENERAL NOTES

1. The collar shall be constructed entirely of CLASS SI CONCRETE and in accordance with the applicable portions of Section 503 of the Standard Specifications. Reinforcement Bars shall conform to Section 508.
2. Expansion Bolts shall consist of approved Expansion Anchors, and ¾ Hook Bolts which conform to Section 1006.09. These Bolts shall extend at least 8 into the new Concrete.
3. This work will be paid for by the cubic yard (cubic meter) for CONCRETE COLLAR, by the pound for REINFORCEMENT BARS, and by Each for EXPANSION BOLTS of the size indicated.

All dimensions are in inches unless otherwise noted.

MODEL: SHT_PLAN
FILE NAME: C:\Bentley\CONNECT10110\Organization\ChilidDOT_Standards\Civil\DOT_Sheets.cad

QUANTITIES

CALC. BY: _____ DATE: _____

CHECKED BY: _____ DATE: _____

QUANTITY CALCULATIONS ARE ON FILE AT THE DISTRICT 4 OFFICE; BUREAU OF PROJECT IMPLEMENTATION; DOCUMENTATION SECTION

USER NAME = Eric.Thomas	DESIGNED -	REVISED -
	DRAWN -	REVISED -
	CHECKED -	REVISED -
PLOT DATE = 12/7/2022	DATE -	REVISED -

**STATE OF ILLINOIS
DEPARTMENT OF TRANSPORTATION**

PIPE CULVERT EXTENSION COLLAR (WITH END SECTION)

SCALE: NOT TO SCALE SHEET OF SHEETS STA. TO STA.

F.A. RTE.	SECTION	COUNTY	TOTAL SHEETS	SHEET NO.
DISTRICT 4 DETAIL NO. 542001		CONTRACT NO.		
ILLINOIS FED. AID PROJECT				