

DESIGNER NOTES:
 1. CONSIDERATION SHOULD BE GIVEN TO CONTINUOUS PAVING OF TURNOUTS AT LOCATIONS WHERE THE DISTANCE BETWEEN TURNOUT CONTROL POINTS IS LESS THAN 50'.
 2. THIS DRAWING SHOULD BE USED IF THERE IS NOT A PAVED SHOULDER OR IF THE PAVED SHOULDER IS LESS THAN 6'.

MODEL: SHT_PLAN_2
 FILE NAME: C:\Bentley\CONNECT\10110\organization\ChilidDOT_Standards\Civil\DOT_Sheets.ctb

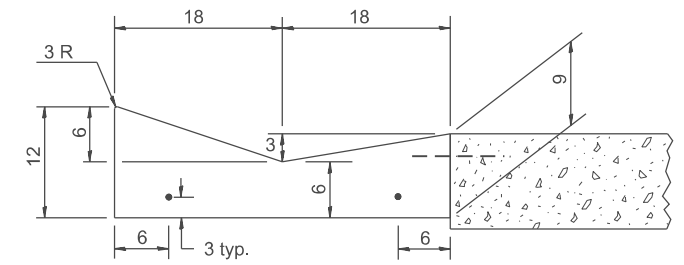

SECTION A-A

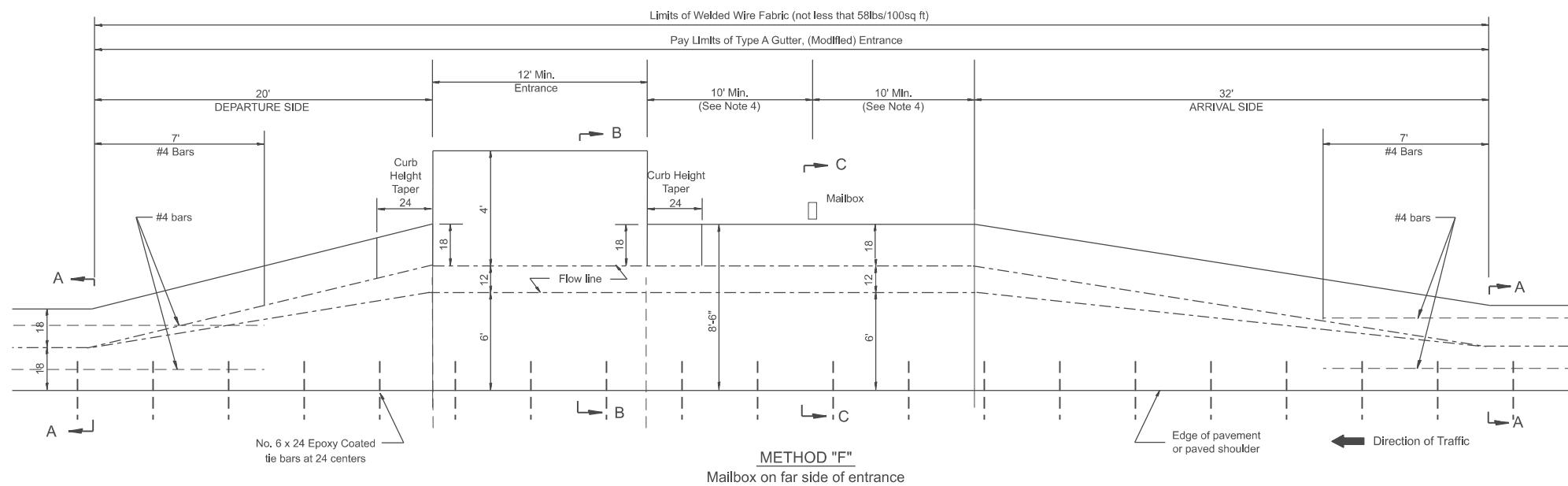
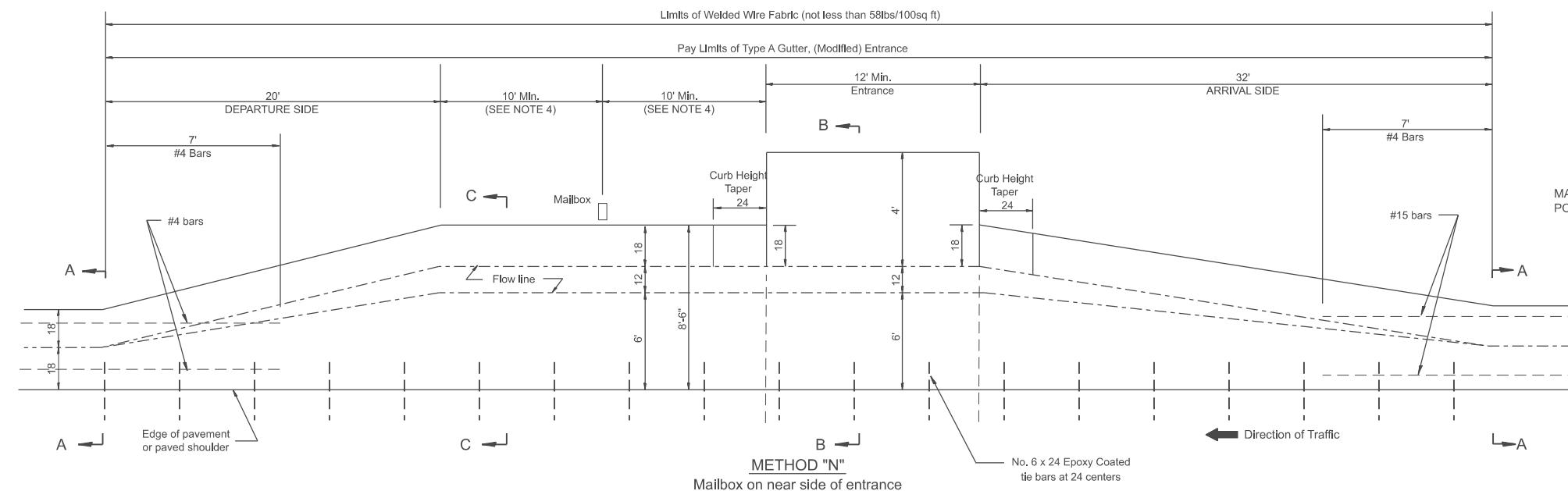
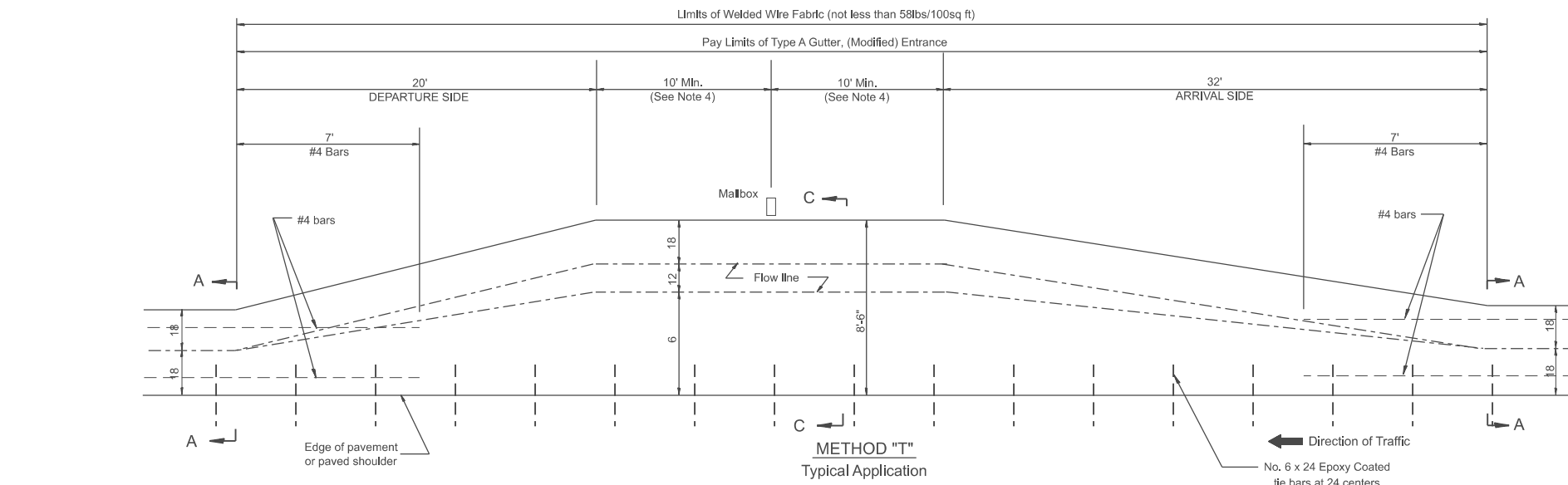
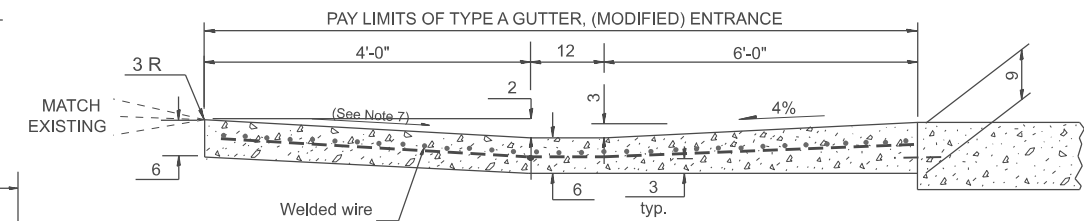

SECTION B-B

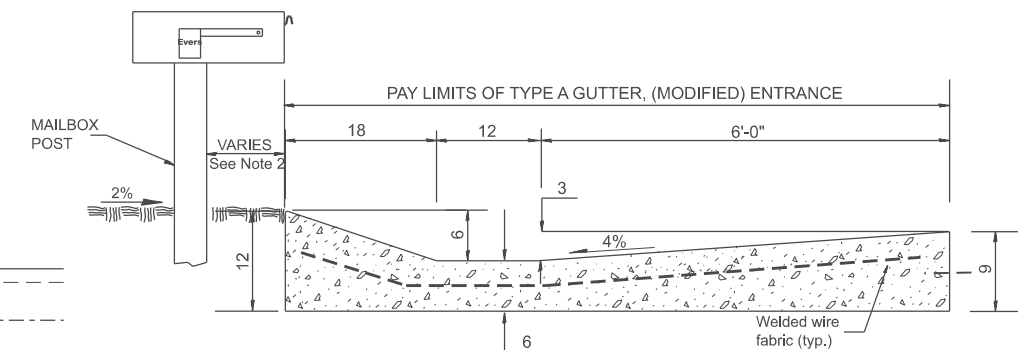

SECTION C-C

QUANTITY CALCULATION		
LOCATION	LENGTH	CU YD / FT
Arrival Side	32 ft	0.14
Section B-B	12 ft Min.	0.23
Section C-C	20 ft Min.	0.20
Departure Side	20 ft	0.14

GENERAL NOTES

- See plans for turnout slopes on super elevated horizontal curves.
- Mailboxes shall be mounted such that the face of the mailbox is vertically above the back of the gutter.
- The mailbox turnout shall be saw cut at approximately 10'-0" centers.
- If more than one mailbox is present, this dimension shall be measured from the end box in each direction.
- Refer to the plans for entrance width, length and surface type.
- The cross slope is to be constructed as given in the plans from back of turnout to where driveway matches existing.
- Slope may be increased from 4% (min.) to 6% (max.) in order to match the existing.

All dimensions are in inches unless otherwise noted.

USER NAME = Eric.Thomas	DESIGNED -	REVISED -
	DRAWN -	REVISED -
	CHECKED -	REVISED -
PLOT DATE = 12/7/2022	DATE -	REVISED -

STATE OF ILLINOIS
DEPARTMENT OF TRANSPORTATION

MAILBOX TURNOUTS IN TYPE A GUTTER,
(MODIFIED) SECTION

SCALE: NOT TO SCALE SHEET OF SHEETS STA. TO STA.

F.A. RTE.	SECTION	COUNTY	TOTAL SHEETS	SHEET NO.
DISTRICT 4 DETAIL NO. 406211		CONTRACT NO.		
ILLINOIS FED. AID PROJECT				