

EXPANSION BOLTS SHALL CONSIST OF SELF DRILLING EXPANSION SHIELDS AND 3/4" DIA HOOKED BOLTS. HOOKED BOLTS SHALL EXTEND A MINIMUM OF 9" INTO NEW CONCRETE.  
 MINIMUM CERTIFIED PROOF LOAD = 4,080 LBS

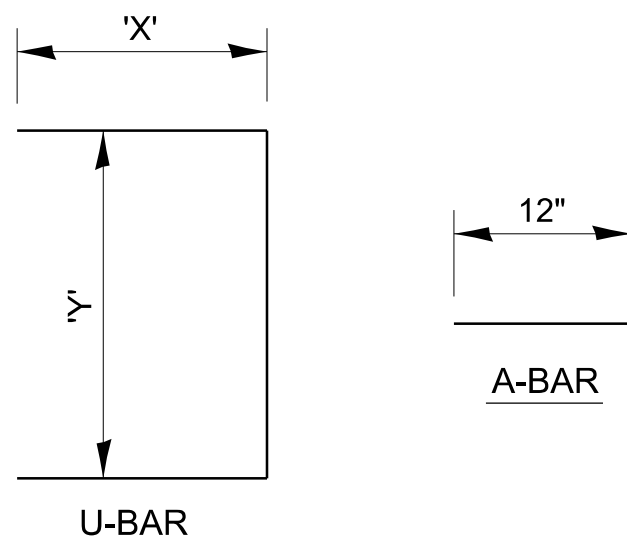

LOCATION	EXISTING CULVERT SIZE	PIPE DIMENSION	PIPE AREA	EXTENSION COLLAR		A-BAR	U-BAR		QUANTITIES ARE FOR ONE SIDE ONLY		
				WIDTH	HEIGHT		12	'X'	'Y'	CLASS SI CONC COLLAR	REINFORCEMENT BARS
				IN	IN	IN	IN	IN	CU YD	POUND	EACH
	DIA IN	DIA IN	SQ FT								

# COLLAR DETAILS (CMP EXTENSION OF PIPE CULVERT)