

EXPANSION BOLTS SHALL CONSIST OF SELF DRILLING EXPANSION SHIELDS AND 3/4" DIA HOOKED BOLTS. HOOKED BOLTS SHALL EXTEND A MINIMUM OF 9" INTO NEW CONCRETE.
 MINIMUM CERTIFIED PROOF LOAD = 4,080 LBS

QUANTITIES ARE FOR ONE SIDE ONLY

LOCATION	EXISTING CULVERT SIZE	PIPE DIMENSION	PIPE AREA	EXTENSION COLLAR		A-BAR 12 IN	U-BAR		CLASS SI CONC COLLAR CU YD	REINFORCEMENT BARS POUND	3/4" DIA EXPANSION BOLTS EACH
				WIDTH IN	HEIGHT IN		'X' IN	'Y' IN			
	DIA IN	DIA IN	SQ FT								

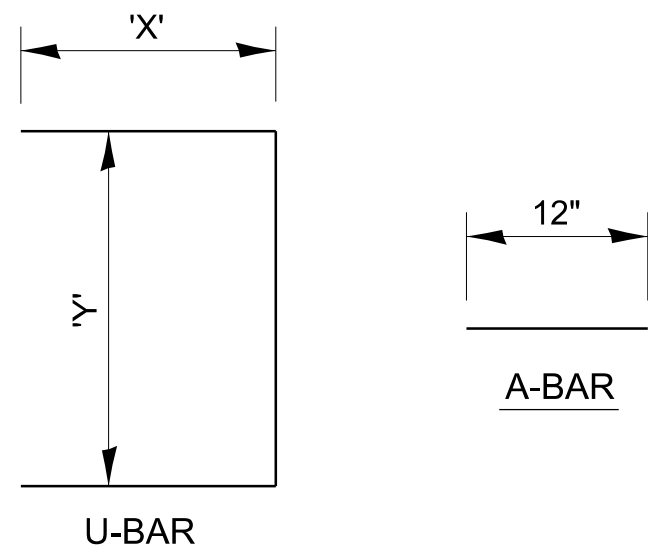

COLLAR DETAIL (R.C.C.P. EXTENSION OF PIPE CULVERT)