

F.A.I. RTE.	SECTION	COUNTY	TOTAL SHEETS	SHEET NO.
80/94	*	COOK	870	762
STA.		TO STA.		
FED ROAD DIST. NO.		ILLINOIS FED. AID PROJECT		

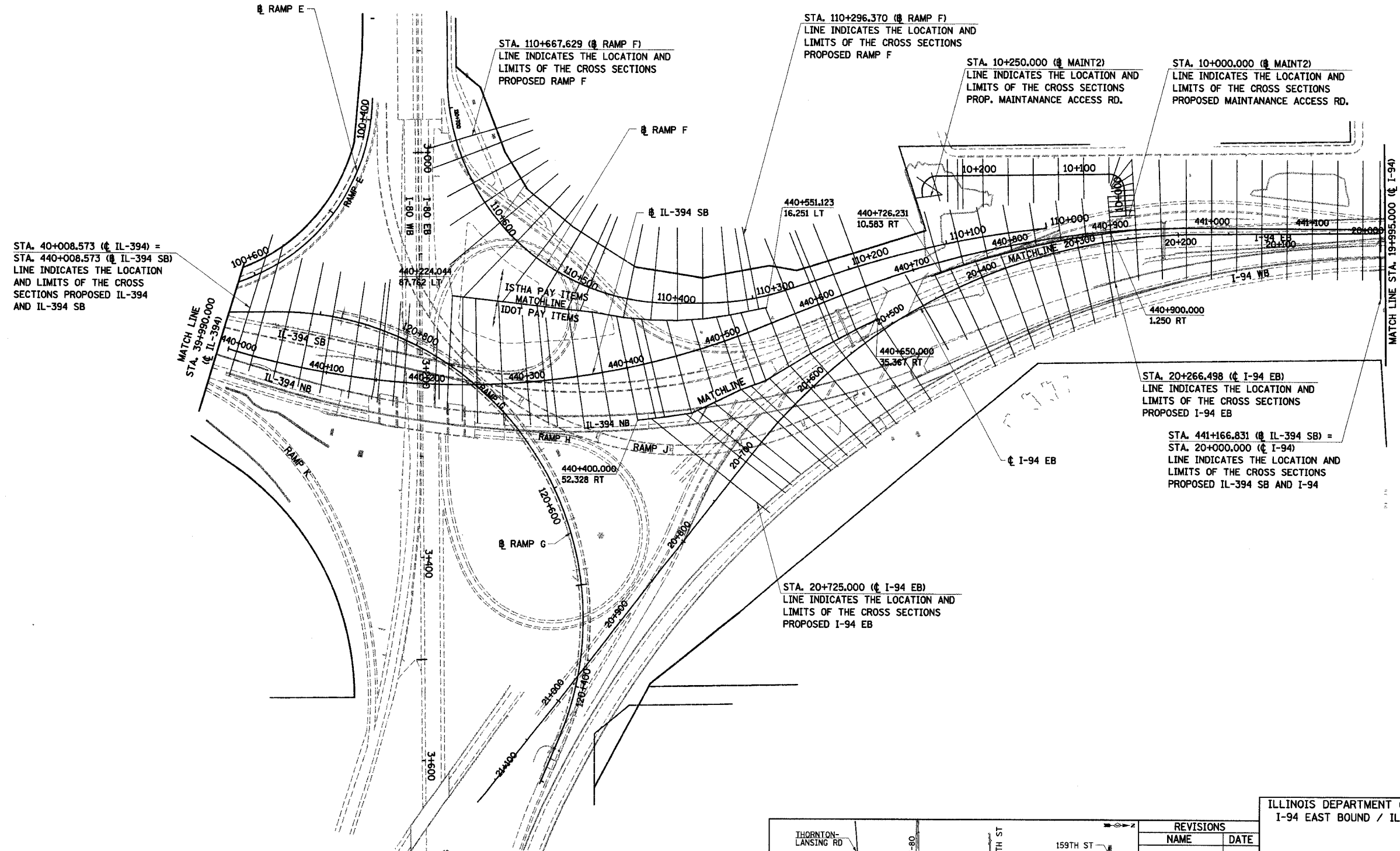

STA. 40+008.573 (IL-394) =
STA. 440+008.573 (IL-394 SB)
LINE INDICATES THE LOCATION
AND LIMITS OF THE CROSS
SECTIONS PROPOSED IL-394
AND IL-394 SB

STA. 110+667.629 (RAMP F)
LINE INDICATES THE LOCATION AND
LIMITS OF THE CROSS SECTIONS
PROPOSED RAMP F

STA. 110+296.370 (RAMP F)
LINE INDICATES THE LOCATION AND
LIMITS OF THE CROSS SECTIONS
PROPOSED RAMP F

STA. 10+250.000 (MAINT2)
LINE INDICATES THE LOCATION AND
LIMITS OF THE CROSS SECTIONS
PROP. MAINTANANCE ACCESS RD.

STA. 10+000.000 (MAINT2)
LINE INDICATES THE LOCATION AND
LIMITS OF THE CROSS SECTIONS
PROPOSED MAINTANANCE ACCESS RD.

STA. 20+266.498 (I-94 EB)
LINE INDICATES THE LOCATION AND
LIMITS OF THE CROSS SECTIONS
PROPOSED I-94 EB

STA. 441+166.831 (IL-394 SB) =
STA. 20+000.000 (I-94)
LINE INDICATES THE LOCATION AND
LIMITS OF THE CROSS SECTIONS
PROPOSED IL-394 SB AND I-94

STA. 20+725.000 (I-94 EB)
LINE INDICATES THE LOCATION AND
LIMITS OF THE CROSS SECTIONS
PROPOSED I-94 EB

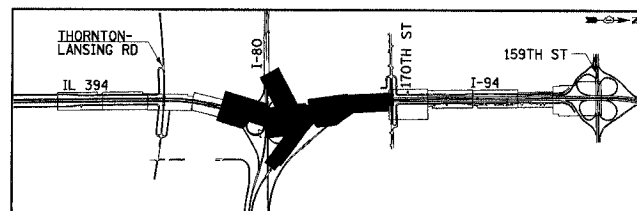

REVISIONS	
NAME	DATE

ILLINOIS DEPARTMENT OF TRANSPORTATION
I-94 EAST BOUND / IL 394 SOUTH BOUND

CROSS SECTION KEY MAP

HORIZ SCALE: 1 : 2000
VERT SCALE: NONE
DATE: JULY 18, 2005
DRAWN BY: BAJ/BJM
CHECKED BY: JES

