

P. A. I. NO.	SECTION	COUNTY	TOTAL SHEETS	SHEET NO.
8084		COOK	870	739
STA.	TO STA.			
FED. ROAD DIST. NO. 7	ALLIANCE	FED. AID PROJECT		
			CONTRACT NO. 62108	

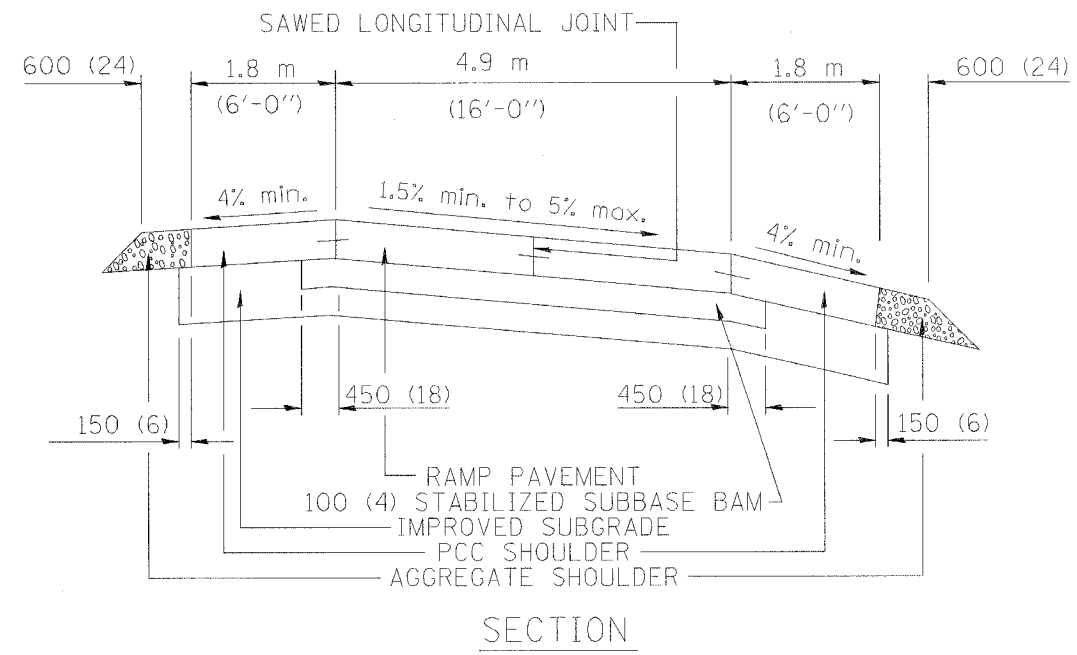

- NOTES:
- CENTERLINE JOINT REMAINS IN THE CENTER WHEN RAMP TRANSITIONS TO TWO (2) RAMPS AT 3.6 m (12').
  - ALL BARS TO BE EPOXY COATED.

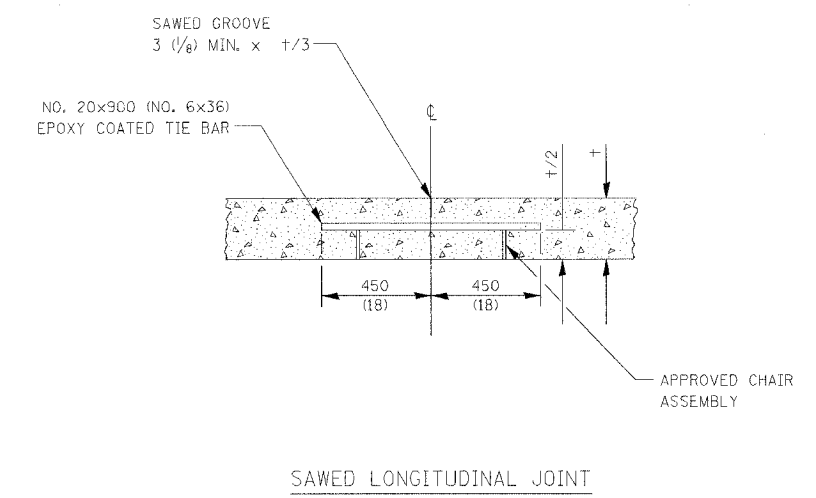
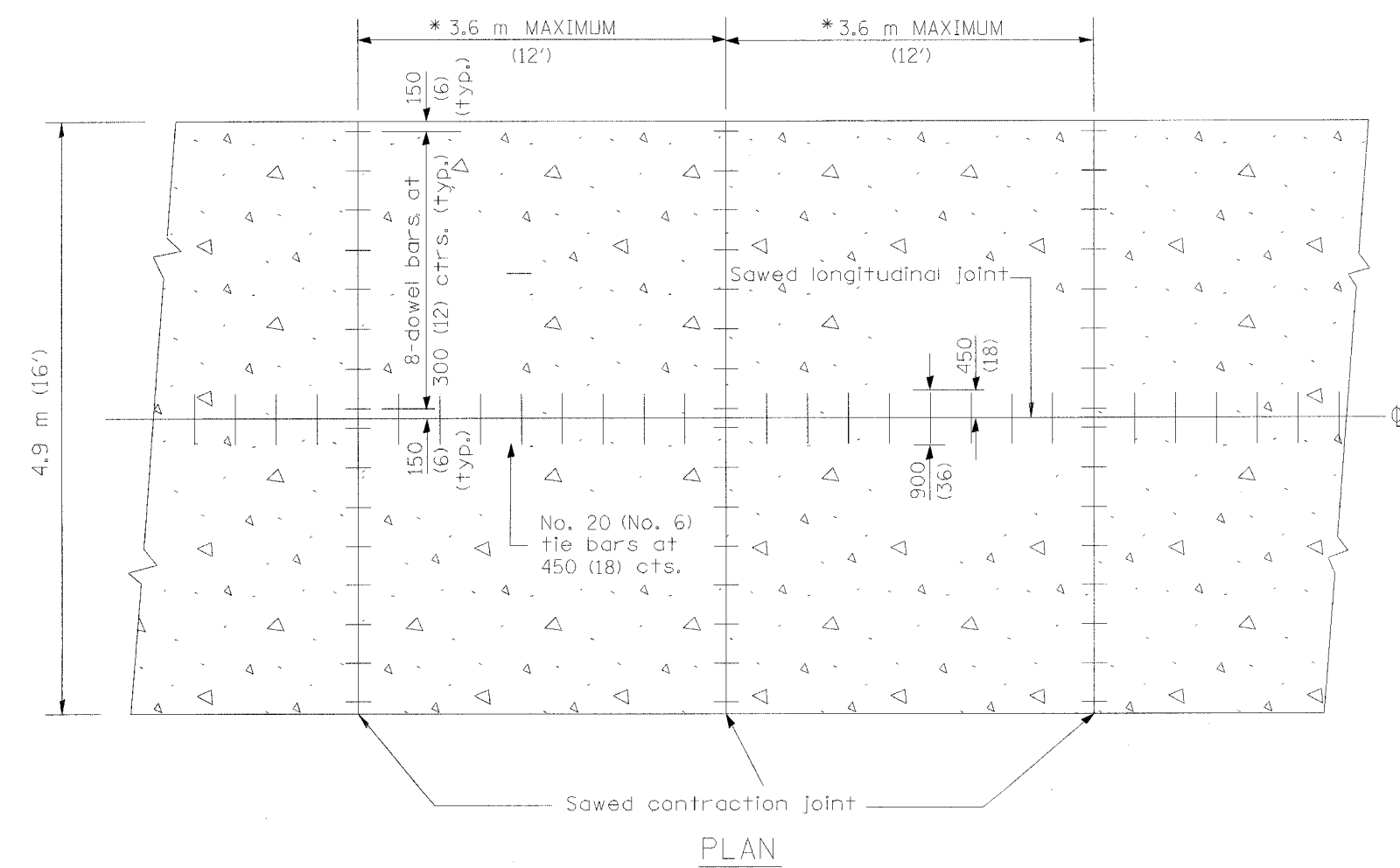

ALL DIMENSIONS ARE IN MILLIMETERS (INCHES) UNLESS OTHERWISE NOTED

ILLINOIS DEPARTMENT OF TRANSPORTATION

**DETAIL FOR CENTERLINE SAWCUT  
4.9 m (16') AND VARIABLE  
JOINTED PCC PAVEMENT  
FOR RAMPS**

REVISIONS	
NAME	DATE

SCALE: NONE  
DATE: 10/18/2002

DRAWN BY: TOM MATOUSEK  
CHECKED BY: A. ABBAS

BD49  
REVISION DATE:

\*DATE-TIME\*  
\*DGN-SPEC\*  
V1-BD49