

STATE OF ILLINOIS
DEPARTMENT OF TRANSPORTATION

| | | | | | |
|--------------------------|---------|----------------------------|--------------|--------------------|---------------|
| ROUTE NO. | SECTION | COUNTY | TOTAL SHEETS | SHEET NO. | SHEET NO. 33a |
| F. A. I. 80/94 | * | COOK | 870 | 547a | 91 SHEETS |
| FED. ROAD DIST. NO. 1 | | ILLINOIS FED. AID PROJECT- | | CONTRACT NO. 62108 | |
| (0203.1 & 0312-708W) R-3 | | | | | |

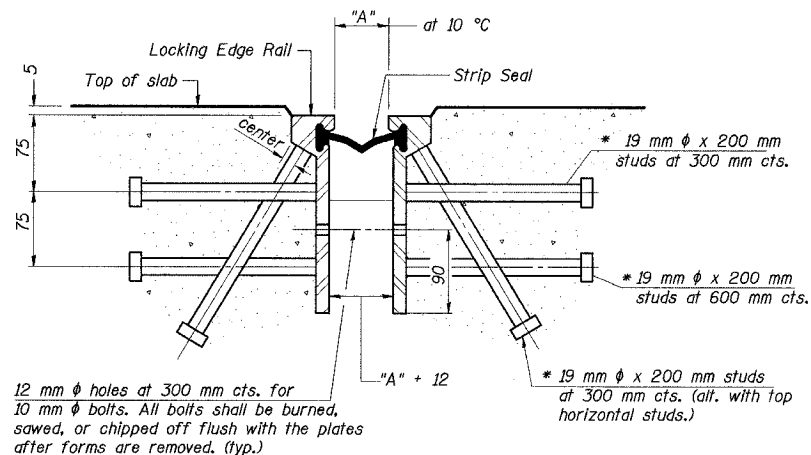

SECTION THRU ROLLED RAIL EXP. JOINT
(262 Studs Required)

| Required Strip Seal rated movement | "A" |
|------------------------------------|-----|
| 25 | 29 |
| 50 | 45 |

* Granular or solid flux filled headed studs conforming to Article 1006.32 of the Std. Specs., automatically end welded.

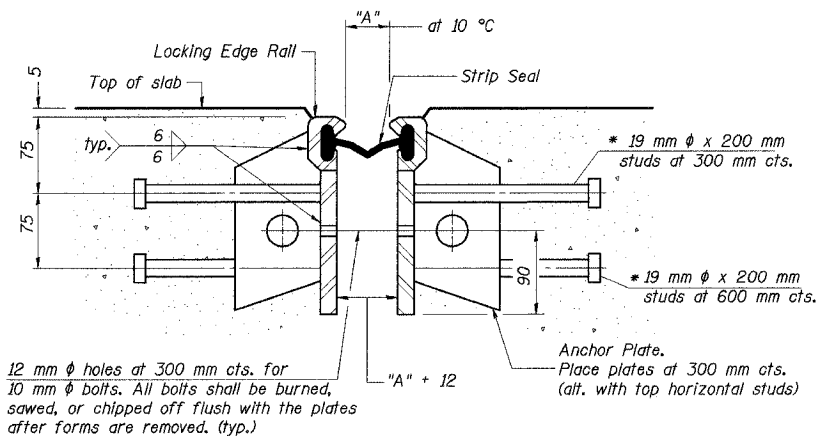

SECTION THRU WELDED RAIL EXP. JOINT
(158 Studs Required)
(104 Anchor Plates Required)

GENERAL NOTES

The strip seal shall be made continuous and shall have a minimum thickness of 6 mm. The configuration of the strip seal shall match the configuration of the Locking Edge Rails.
The height and thickness of the Locking Edge Rails shown are minimum dimensions. The actual configuration of the Locking Edge Rails and matching strip seal may vary from manufacturer to manufacturer. Flanged edge rails will not be allowed.
Locking Edge Rails may be spliced at slope discontinuities and stage construction joints.
The manufacturer's recommended installation methods shall be followed.
The joint opening and deck dimensions detailed on the superstructure are based on a preformed joint seal. If the contractor elects to use the alternate strip seal joint, the opening and deck dimensions shall be modified according to the dimensions detailed on this sheet. Required modifications shall be made at no additional cost to the State.

All dimensions in millimeters (mm) except as noted.

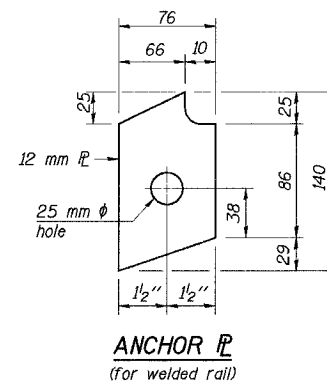
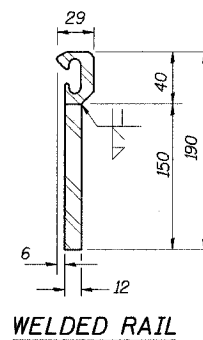
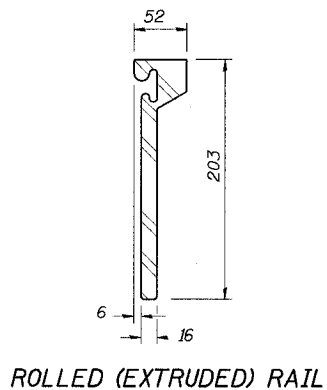

LOCKING EDGE RAILS

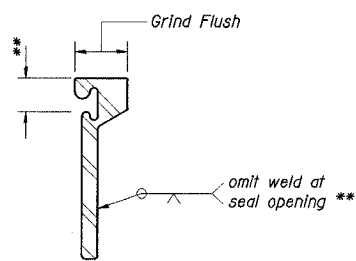

LOCKING EDGE RAIL SPLICE

The inside of the locking edge rail groove shall be free of weld residue.

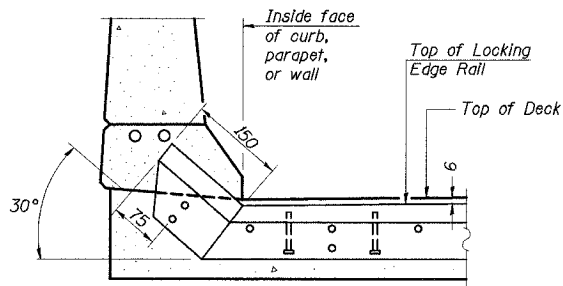

AT CURB, PARAPET, OR WALL

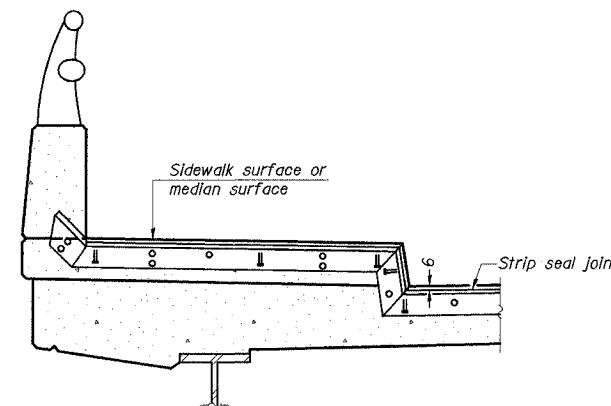

AT SIDEWALK OR MEDIAN*

* Shorter plates with a single row of studs at 300 mm centers may be necessary on medians which are shallower than 230 mm. See manufacturer's recommendation.

TYPICAL END TREATMENTS

BILL OF MATERIAL

| Item | Unit | Total |
|-------------------------------------|-------|-------|
| Strip Seal Expansion Joint Assembly | meter | 15.3 |

Required Strip Seal rated movement for this abutment for this project: 50 mm

ILLINOIS DEPARTMENT OF TRANSPORTATION
I-94 EAST BOUND / IL 394 SOUTH BOUND
EXPANSION JOINT AT SOUTH ABUTMENT

SB IL ROUTE 394 / RAMP F OVER THORN CREEK
F.A.P. 332 SECTION (0203.1 & 0312-708W) R-3
COOK COUNTY

STA. 440+704.350 STRUCTURE NO. 016-2800/2845

DATE JUL 18, 2005

SCALE ---

HNTB

| | |
|----------|-----|
| DESIGNED | PCA |
| CHECKED | TRL |
| DRAWN | LK |
| CHECKED | TRL |

EJ-BJS(M) 9-01-03

L:\kairs\34562\CADD\B1\SN_2800\cadd\CTR_19_2800\0190034.e_2800.dgn
18-AUG-2005 12:42