

STATE OF ILLINOIS  
DEPARTMENT OF TRANSPORTATION

ROUTE NO.	SECTION	COUNTY	TOTAL SHEETS	SHEET NO.	SHEET NO. 11 91 SHEETS
F. A. I. 80/94	*	COOK	870	525	
FED. ROAD DIST. NO. 1		ILLINOIS	FED. AID PROJECT-		
(02033.1 & 0312-708W) R-3			CONTRACT NO. 62108		

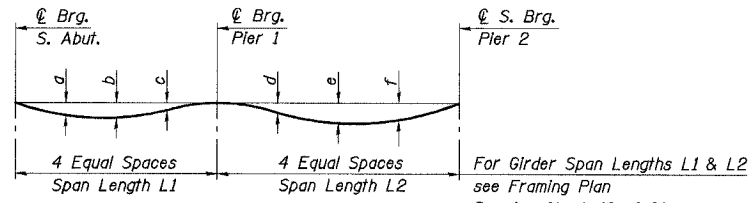

**DEAD LOAD DEFLECTION DIAGRAM**

(Includes weight of slab & parapet-no future wearing surface)

**DEAD LOAD DEFLECTION TABLE**

Girder No.	Deflection	Span 1 (L1)			Span 2 (L2)		
		a	b	c	d	e	f
1		24	26	10	25	51	44
2		27	29	12	23	46	39
3		28	32	13	18	39	34
4		29	33	15	15	34	29
5		29	35	16	13	28	25
6		30	36	17	9	24	21

Note: The above deflections are not to be used in the field if the engineer is working from the grade elevations adjusted for dead load deflections as shown in the "Top of Slab Elevations" tables. All offsets shown in the "Top of Slab Elevations" tables are in meters.

**END OF SPAN DIMENSIONS**

(Values in Meters)

Location	D1	D2	D3
Girder 1	1.700	N/A	N/A
Girder 2	1.700	N/A	3.843
Girder 3	1.700	N/A	2.842
Girder 4	1.700	N/A	1.841
Girder 5	1.700	3.840	N/A
Girder 6	1.700	2.839	N/A
@ SB IL 394 & PGL	1.706	2.617	N/A

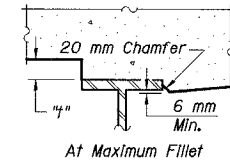
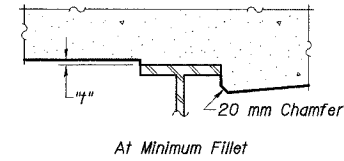

To determine "t": After all structural steel has been erected, elevations of the top flanges of the girders shall be taken at intervals shown in the elevation tables. These elevations subtracted from the "Theoretical Grade Elevations Adjusted for Dead Load Deflection" shown, minus slab thickness, equals the fillet heights "t" above top flange of girders.

**FILLET HEIGHTS**

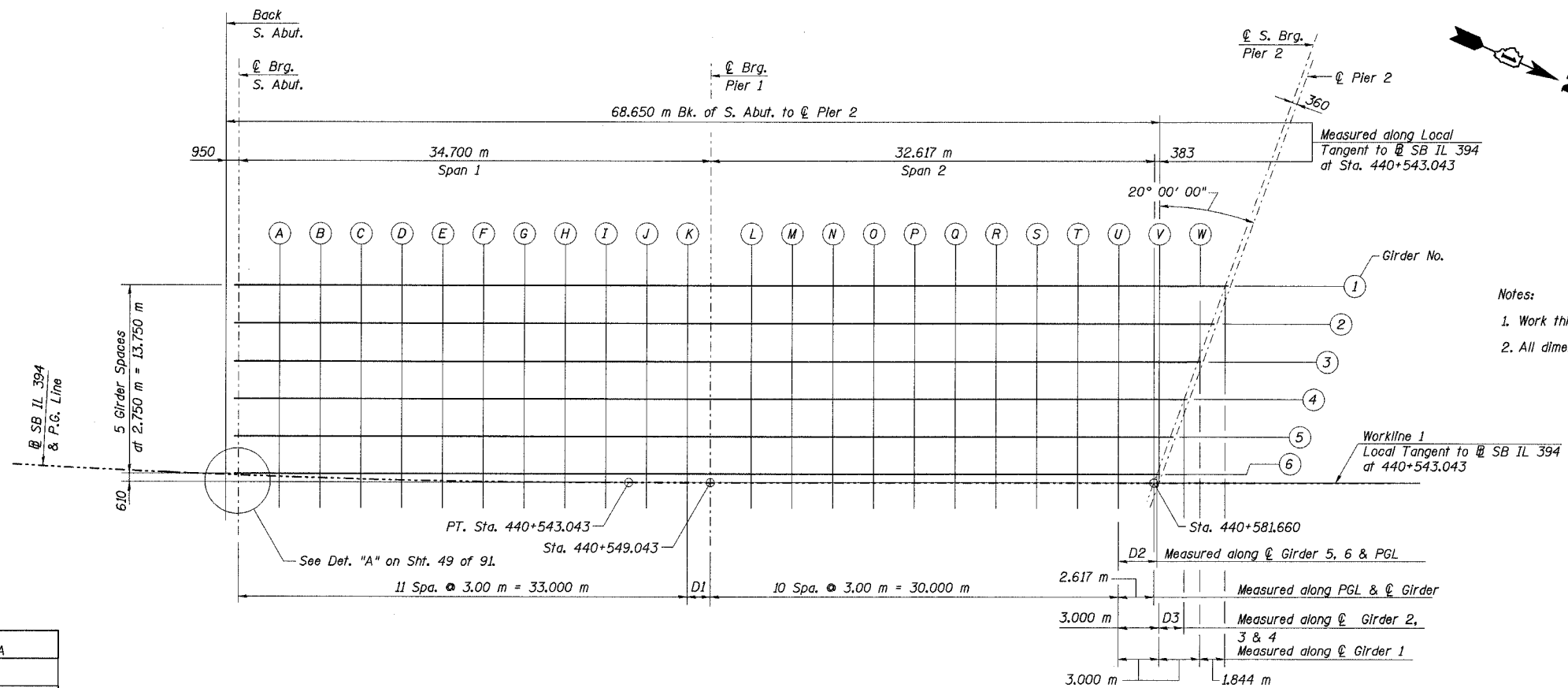

Notes:  
1. Work this sheet with Sheet Nos. 12 & 13 of 91.  
2. All dimensions are in millimeters (mm) unless otherwise noted.

DESIGNED	MEA
CHECKED	JY
DRAWN	LK
CHECKED	JY

**ELEVATION GRID**

ILLINOIS DEPARTMENT OF TRANSPORTATION  
I-94 EAST BOUND / IL 394 SOUTH BOUND  
**TOP OF SLAB ELEVATIONS, GRID & DETAILS, SPANS 1 & 2 - UNIT 2**  
SB IL ROUTE 394 OVER THORN CREEK  
F.A.P. 332 SECTION (02033.1 & 0312-708W) R-3  
COOK COUNTY  
STA. 440+704.350 STRUCTURE NO. 016-2800  
DATE JUL 18, 2005  
SCALE ---

**HNTB**

J:\bauchberg\EA\34562\LOAD\1\SNL\_2800\cda\CTR\_19\_2800\sp190214a\_2800.dgn  
08-JUL-2005 13:46