

F.A.I. RTE	SECTION	COUNTY	TOTAL SHEETS	SHEET NO.
80/94	*	COOK	870	426
STA.		TO STA.		
FED ROAD DIST. NO.		ILLINOIS FED. AID PROJECT		

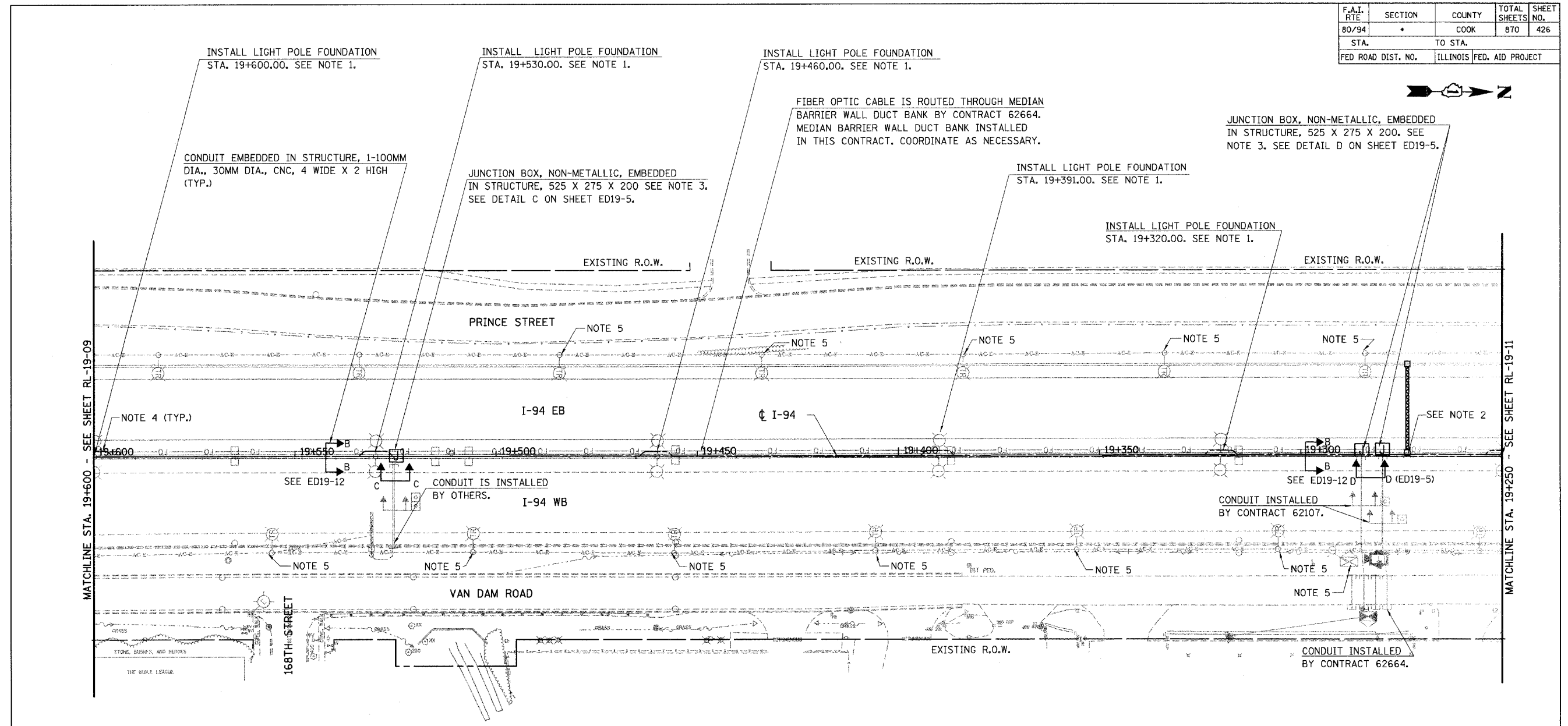

NOTES:

1. INSTALL FOUNDATION, CONDUITS, AND ANCHOR BOLTS FOR LIGHT POLE. CONTRACTOR TO COORDINATE THROUGH IDOT WITH CONTRACT 62664 TO OBTAIN ANCHOR BOLTS & ASSURE PROPER INSTALLATION. LIGHT POLE IS INSTALLED IN CONTRACT 62664. CONDUITS INSTALLED IN FOUNDATION SHALL BE 100MM DIA. RGS CONDUIT. SEE ED19-8.
2. SEE OVERHEAD SIGN STRUCTURE DRAWINGS FOR CONDUIT IN FOUNDATION DETAILS. INSTALL 2-100MM DIA. RGS CONDUITS IN FOUNDATION LOCATED IN MEDIAN. CONNECT CONDUIT IN SIGN FOUNDATION WITH LIGHTING DUCT IN MEDIAN BARRIER WALL DUCT BANK. ELECTRIC CABLE FEEDING SIGN AND LUMINAIRES IS INSTALLED IN CONTRACT 62664.
3. JUNCTION BOX IS TO BE PROVIDED UNDER THIS CONTRACT. ELECTRIC CABLE FEEDING SIGN AND LUMINAIRES FOR SIGN IS FURNISHED AND INSTALLED UNDER CONTRACT 62664. SEE DETAIL C ON ED19-5.
4. ROUTE 30MM DIA. CNC DUCT BANK AROUND LIGHT POLE FOUNDATION. THIS WILL BE PAID FOR AS "CONDUIT ENCASED, REINFORCED CONCRETE, 30MM DIA., CNC, 4 WIDE X 2 HIGH". LIGHTING CONDUIT IS ATTACHED TO CONDUIT IN LIGHT POLE FOUNDATION. SEE CONDUIT ROUTING DETAIL ED19-11.
5. THIS ITEM IS INSTALLED AND REMOVED DURING CONTRACT 62108 WITH CONCURRENT WORK UNDER CONSTRUCTION BY CONTRACT 62664.
6. ALL PVC ENCASED OR EMBEDDED IN CONCRETE WILL BE PVC SCHEDULE 40. (TYP.)

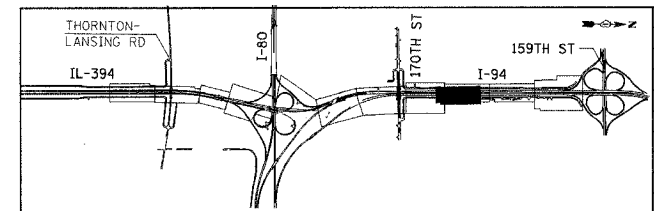

REVISIONS	
NAME	DATE

ILLINOIS DEPARTMENT OF TRANSPORTATION
I-94 EAST BOUND / IL 394 SOUTH BOUND

**ROADWAY CONDUIT PLAN
STA. 19+250 TO STA. 19+600**

HORIZ SCALE: 1:500
VERT SCALE:
DATE: JULY 18, 2005
DRAWN BY: SPR
CHECKED BY: BB

