

F.A.I. RTE	SECTION	COUNTY	TOTAL SHEETS	SHEET NO.
80/94	*	COOK	870	412
STA.		TO STA.		
FED ROAD DIST. NO.		ILLINOIS FED. AID PROJECT		

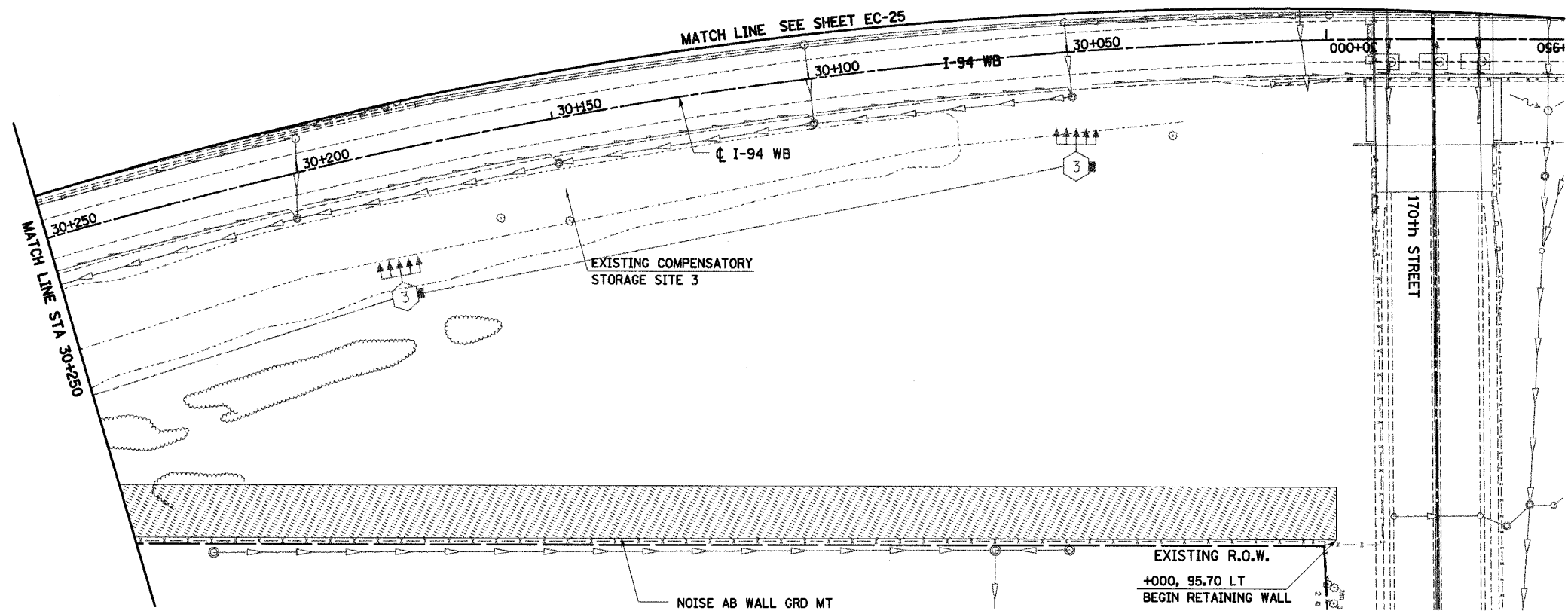

**NOTES:**

1. WORK THIS SHEET WITH THE EROSION AND SEDIMENT CONTROL GENERAL NOTES, LEGEND AND STRATEGY SHEETS.
2. ALL STATIONING AND OFFSET MEASUREMENTS OFF CL I-94 WB UNLESS OTHERWISE NOTED.
3. ALL DIMENSIONS ARE IN METERS (m) UNLESS OTHERWISE NOTED.

**FINAL CONDITION**

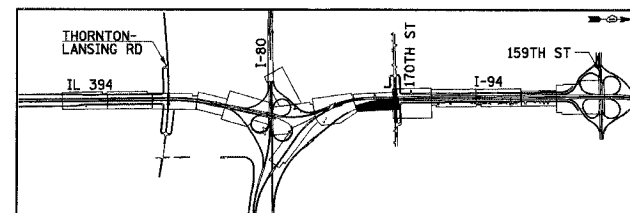

REVISIONS	
NAME	DATE

EC-31

ILLINOIS DEPARTMENT OF TRANSPORTATION  
I-94 EAST BOUND / IL 394 SOUTH BOUND

**EROSION CONTROL PLAN**  
**I-94 WB**  
**STA. 30+000 TO STA. 30+250**

HORIZ SCALE: 1:500  
VERT SCALE: 1:50  
DATE: JULY 18, 2005

DRAWN BY: JPH  
CHECKED BY: JES

**HNTB**