

F.A.I. RTE	SECTION	COUNTY	TOTAL SHEETS	SHEET NO.
80/94		COOK	870	403
STA. 440+525		TO STA. 440+900		
FED ROAD DIST. NO.		ILLINOIS FED. AID PROJECT		

NOTES:

1. WORK THIS SHEET WITH THE EROSION AND SEDIMENT CONTROL GENERAL NOTES, LEGEND AND STRATEGY SHEETS.
2. ERODIBLE AREAS AND OFFSET MEASUREMENTS OFF @ IL-394 SB UNLESS OTHERWISE NOTED.
3. ALL DIMENSIONS ARE IN METERS (m) UNLESS OTHERWISE NOTED.
4. SEDIMENT TRAPS TO BE PLACED AT OUTLET OF ALL SLOPE DRAINS (NOT SHOWN FOR CLARITY).
5. TEMPORARY FENCE TO BE PLACED AT LOCATIONS ALONG ALL CONSTRUCTION LIMITS WHERE PERMIMTER EROSION BARRIER IS NOT INDICATED (TEMPORARY FENCE NOT SHOWN AT THESE LOCATIONS FOR CLARITY).

SILT FENCE SET BACK 7.6M FROM CREEK EDGE. TEMPORARY FENCE PLACED .6M FROM SILT FENCE.

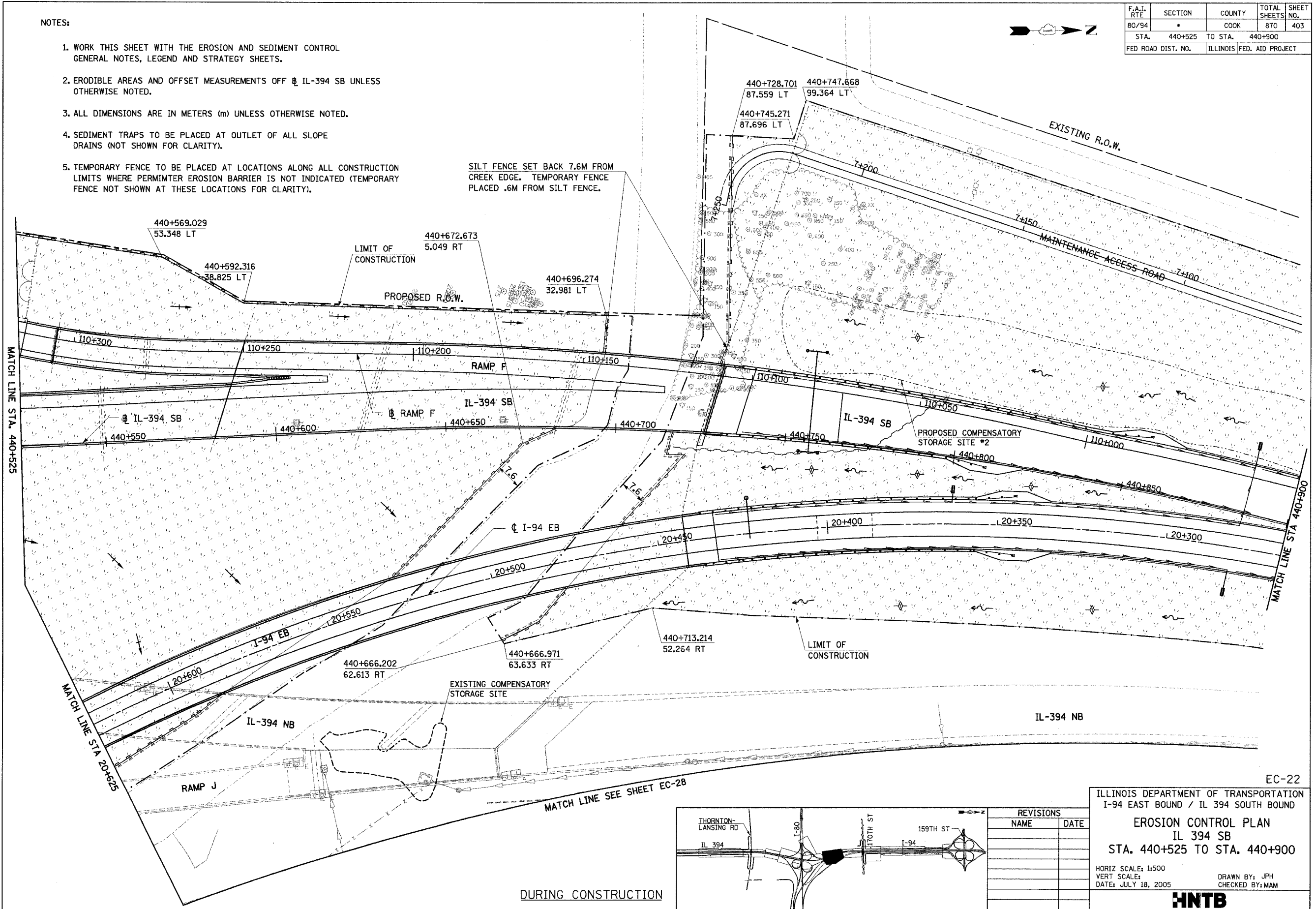

DURING CONSTRUCTION

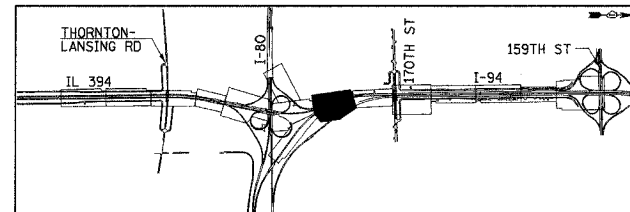

REVISIONS	
NAME	DATE

EC-22
 ILLINOIS DEPARTMENT OF TRANSPORTATION
 I-94 EAST BOUND / IL 394 SOUTH BOUND
EROSION CONTROL PLAN
 IL 394 SB
 STA. 440+525 TO STA. 440+900

HORIZ SCALE: 1:500
 VERT SCALE:
 DATE: JULY 18, 2005

DRAWN BY: JPH
 CHECKED BY: MAM

HNTB