

| F.A.I. RTE | SECTION | COUNTY | TOTAL SHEETS | SHEET NO. |
|----------------------------|---------|---------------------------|--------------|-----------|
| 80/94 | * | COOK | 870 | 386 |
| STA. 18+363 TO STA. 18+725 | | ILLINOIS FED. AID PROJECT | | |

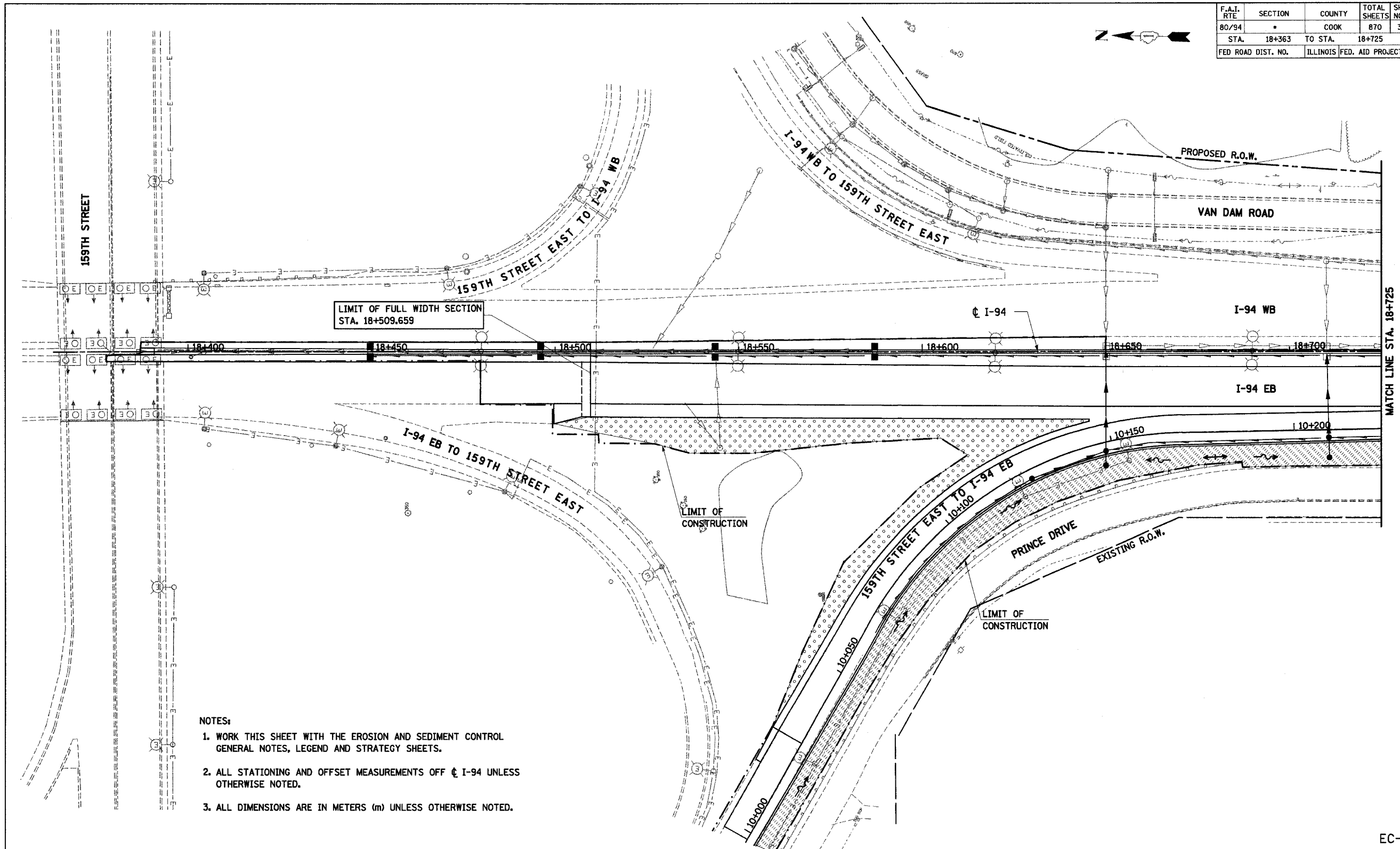

- NOTES:**
1. WORK THIS SHEET WITH THE EROSION AND SEDIMENT CONTROL GENERAL NOTES, LEGEND AND STRATEGY SHEETS.
 2. ALL STATIONING AND OFFSET MEASUREMENTS OFF C I-94 UNLESS OTHERWISE NOTED.
 3. ALL DIMENSIONS ARE IN METERS (m) UNLESS OTHERWISE NOTED.

FINAL CONDITION

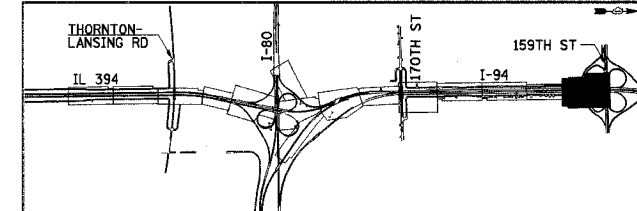

| REVISIONS | |
|-----------|------|
| NAME | DATE |
| | |
| | |
| | |
| | |
| | |

ILLINOIS DEPARTMENT OF TRANSPORTATION
I-94 EAST BOUND / IL 394 SOUTH BOUND

EROSION CONTROL PLAN
I-94
STA. 18+363 TO STA. 18+725

HORIZ SCALE: 1:500
VERT SCALE: DRAWN BY: JPH
DATE: JULY 18, 2005 CHECKED BY: MAM

HNTB