

F.A.I. RTE	SECTION	COUNTY	TOTAL SHEETS	SHEET NO.
80/94	*	COOK	870	375
STA. 39+150		TO STA. 39+500		
FED ROAD DIST. NO.		ILLINOIS FED. AID PROJECT		

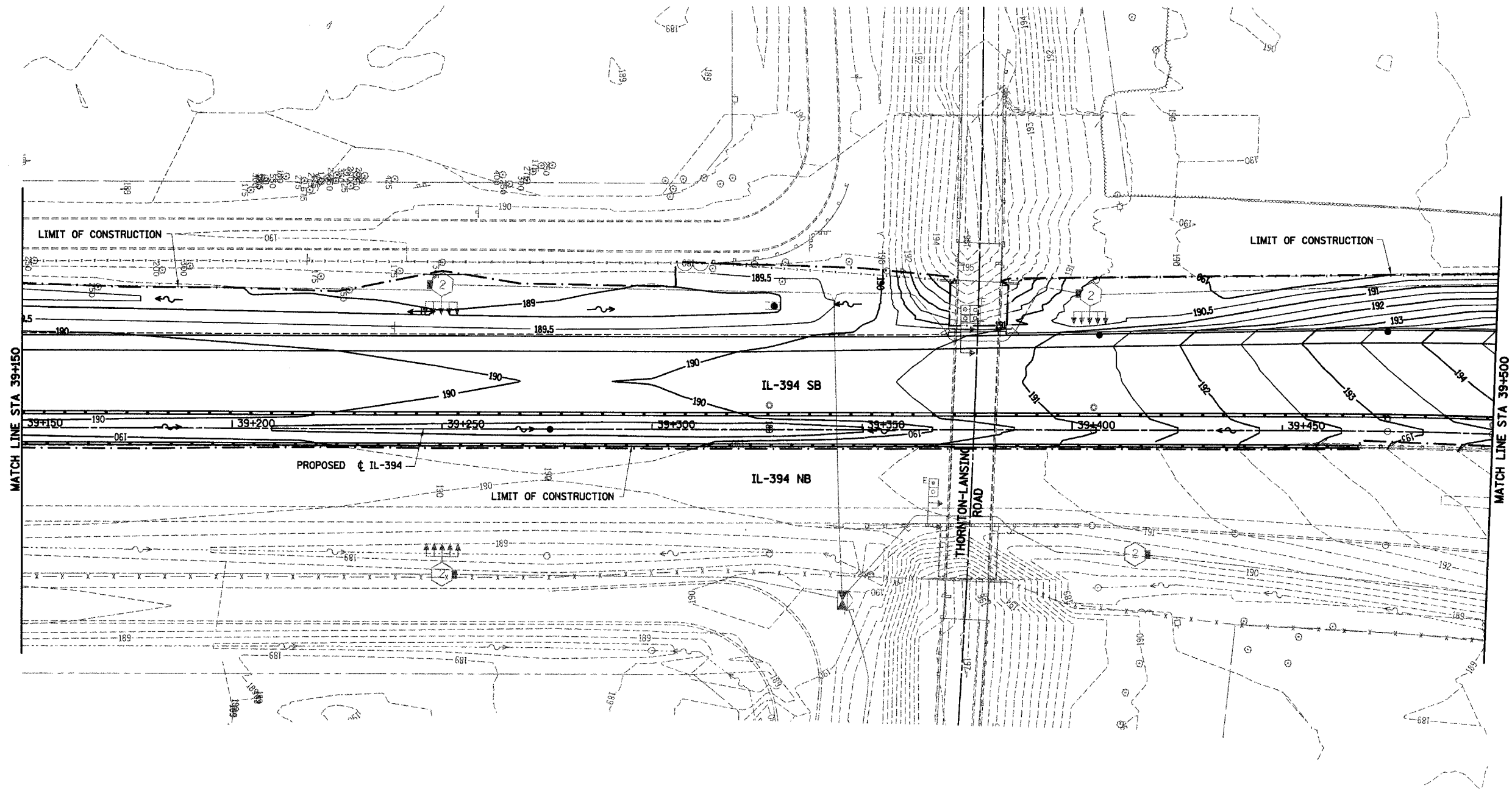
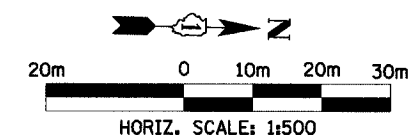

MATCH LINE STA 39+150

MATCH LINE STA 39+500

- LEGEND**
- 190--- EXISTING CONTOUR
 - 190--- EXISTING DITCH LINE
 - 190— PROPOSED CONTOUR
 - ~~~ PROPOSED DITCH FLOW
 - PROPOSED DITCH LINE
 - +— PROPOSED SWALE
 - +— PROPOSED SUMMIT
 - ⊙ PROPOSED MANHOLE
 - ⊙ PROPOSED INLET
 - PROPOSED CATCH BASIN
 - ▲ PROPOSED END SECTION

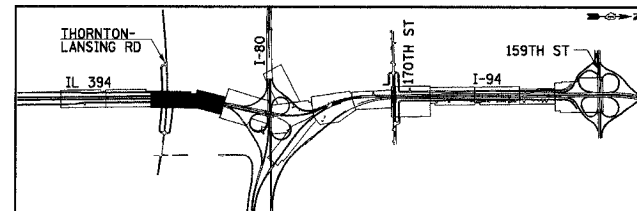

REVISIONS	
NAME	DATE

IG - 5

ILLINOIS DEPARTMENT OF TRANSPORTATION
I-94 EAST BOUND / IL 394 SOUTH BOUND

GRADING PLAN
IL-394
STA. 39+150 TO STA. 39+500

HORIZ SCALE: 1:500
VERT SCALE: 1:10
DATE: JULY 18, 2005

DRAWN BY: BAJ
CHECKED BY: JES

HNTB