

F.A.I. RTE.	SECTION	COUNTY	TOTAL SHEETS	SHEET NO.
80/94	SEE BELOW	COOK	762	359
STA.		TO STA.		
FED. ROAD DIST. NO.		ILLINOIS FED. AID PROJECT		
CONTRACT NO. 62108				

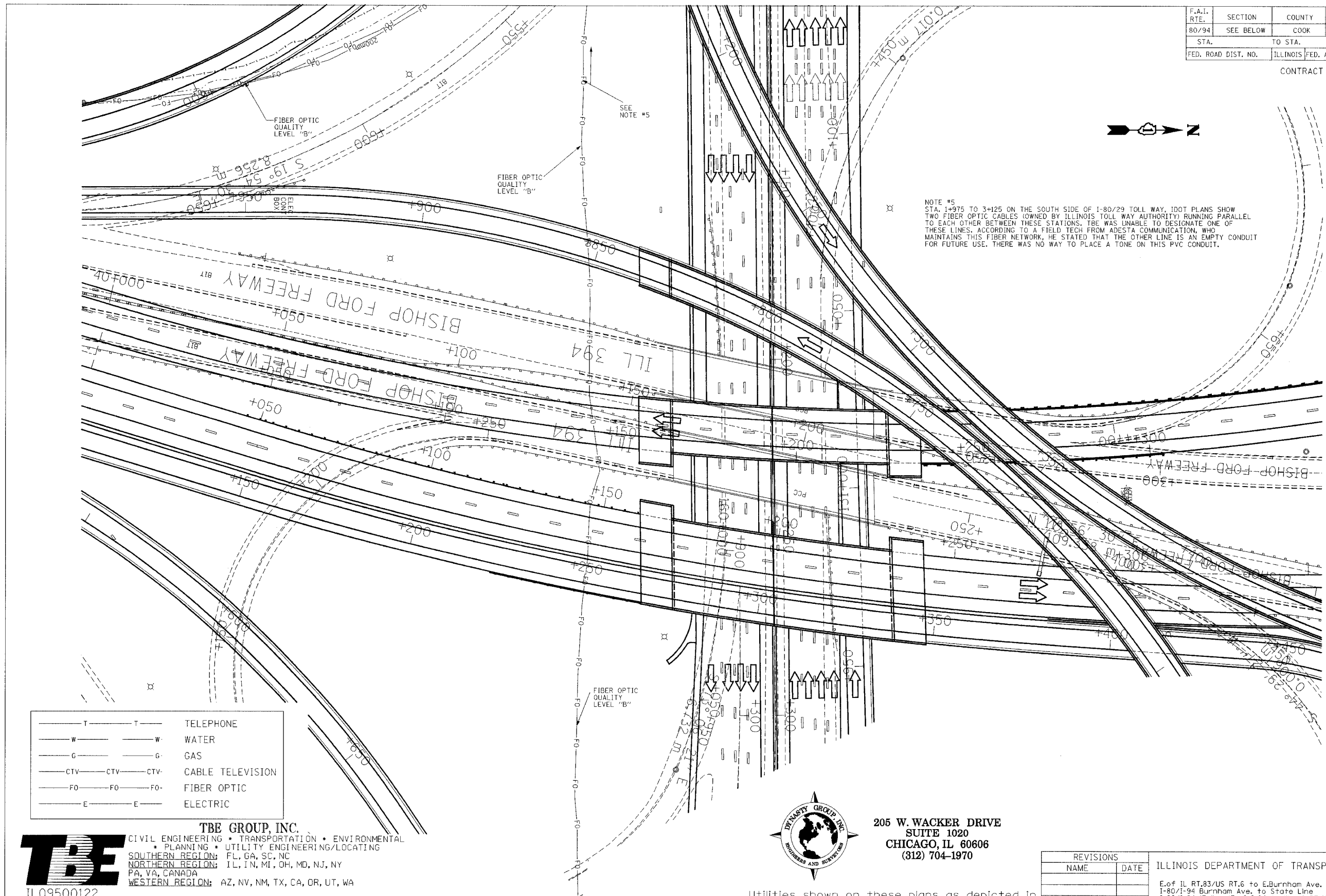

NOTE #5
 STA. 1+975 TO 3+125 ON THE SOUTH SIDE OF I-80/29 TOLL WAY, IDOT PLANS SHOW TWO FIBER OPTIC CABLES (OWNED BY ILLINOIS TOLL WAY AUTHORITY) RUNNING PARALLEL TO EACH OTHER BETWEEN THESE STATIONS. TBE WAS UNABLE TO DESIGNATE ONE OF THESE LINES, ACCORDING TO A FIELD TECH FROM ADESTA COMMUNICATION, WHO MAINTAINS THIS FIBER NETWORK, HE STATED THAT THE OTHER LINE IS AN EMPTY CONDUIT FOR FUTURE USE. THERE WAS NO WAY TO PLACE A TONE ON THIS PVC CONDUIT.

— T — T —	TELEPHONE
— W — W —	WATER
— G — G —	GAS
— CTV — CTV — CTV —	CABLE TELEVISION
— FO — FO — FO —	FIBER OPTIC
— E — E —	ELECTRIC

TBE GROUP, INC.
 CIVIL ENGINEERING • TRANSPORTATION • ENVIRONMENTAL
 • PLANNING • UTILITY ENGINEERING/LOCATING
 SOUTHERN REGION: FL, GA, SC, NC
 NORTHERN REGION: IL, IN, MI, OH, MD, NJ, NY
 PA, VA, CANADA
 WESTERN REGION: AZ, NV, NM, TX, CA, OR, UT, WA

IL09500122
 TBE SUE PAGE NO: 14 of 52
 Signature _____
 SUE Quality Level "A" : Test Holes
 SUE Quality Level "B" : Designating



205 W. WACKER DRIVE
 SUITE 1020
 CHICAGO, IL 60606
 (312) 704-1970

Utilities shown on these plans as depicted in the legend have been investigated by TBE Group, Inc in accordance with SUE Industry Standards as of 2/8/02.
 All other information shown has been provided to TBE Group, Inc by others.

REVISIONS		ILLINOIS DEPARTMENT OF TRANSPORTATION
NAME	DATE	
		E.of IL RT.83/US RT.6 to E.Burnham Ave.
		I-80/I-94 Burnham Ave. to State Line
		I-80/I-94 (Tollway)E.of I-94 to W. of RT.83/US 6.
		I-94/IL RT. 394 S.of US 6 to 186th Street(Nbound & Sbound)
		Contract No. 62110, 62111,62114,62105,62107,62108
		SCALE : 500 DRAWN BY : JAC
		SOL "B" DATE : 2/8/02 CHECKED BY