

F.A.I. RTE	SECTION	COUNTY	TOTAL SHEETS	SHEET NO.
80/94	*	COOK	870	283
STA.	TO STA.			
FED ROAD DIST. NO.	ILLINOIS FED. AID PROJECT			

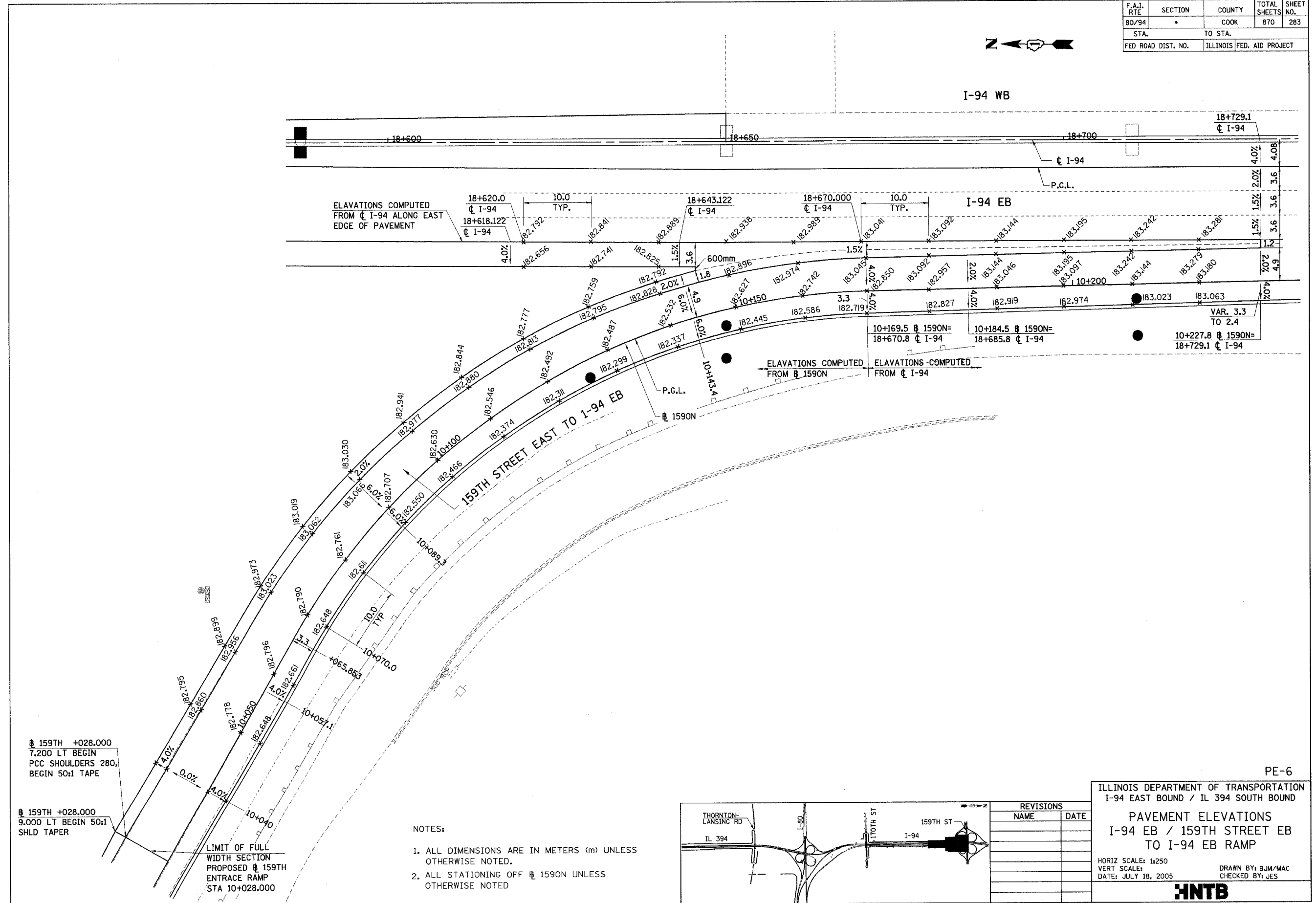

159TH +028.000  
7.200 LT BEGIN  
PCC SHOULDERS 280,  
BEGIN 50:1 TAPE

159TH +028.000  
9.000 LT BEGIN 50:1  
SHLD TAPER

LIMIT OF FULL  
WIDTH SECTION  
PROPOSED 159TH  
ENTRANCE RAMP  
STA 10+028.000

- NOTES:
1. ALL DIMENSIONS ARE IN METERS (m) UNLESS OTHERWISE NOTED.
  2. ALL STATIONING OFF 1590N UNLESS OTHERWISE NOTED

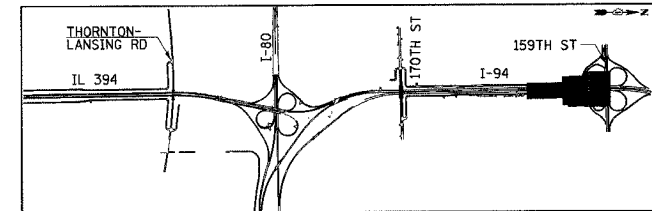

REVISIONS	
NAME	DATE

PE-6

ILLINOIS DEPARTMENT OF TRANSPORTATION  
I-94 EAST BOUND / IL 394 SOUTH BOUND

PAVEMENT ELEVATIONS  
I-94 EB / 159TH STREET EB  
TO I-94 EB RAMP

HORIZ SCALE: 1:250  
VERT SCALE: 1:10  
DATE: JULY 18, 2005

DRAWN BY: BJM/MAC  
CHECKED BY: JES

**HNTB**