

F.A.I. RTE	SECTION	COUNTY	TOTAL SHEETS	SHEET NO.
80/94	*	COOK	870	277
STA.	TO STA.			
FED ROAD DIST. NO.	ILLINOIS	FED. AID PROJECT		

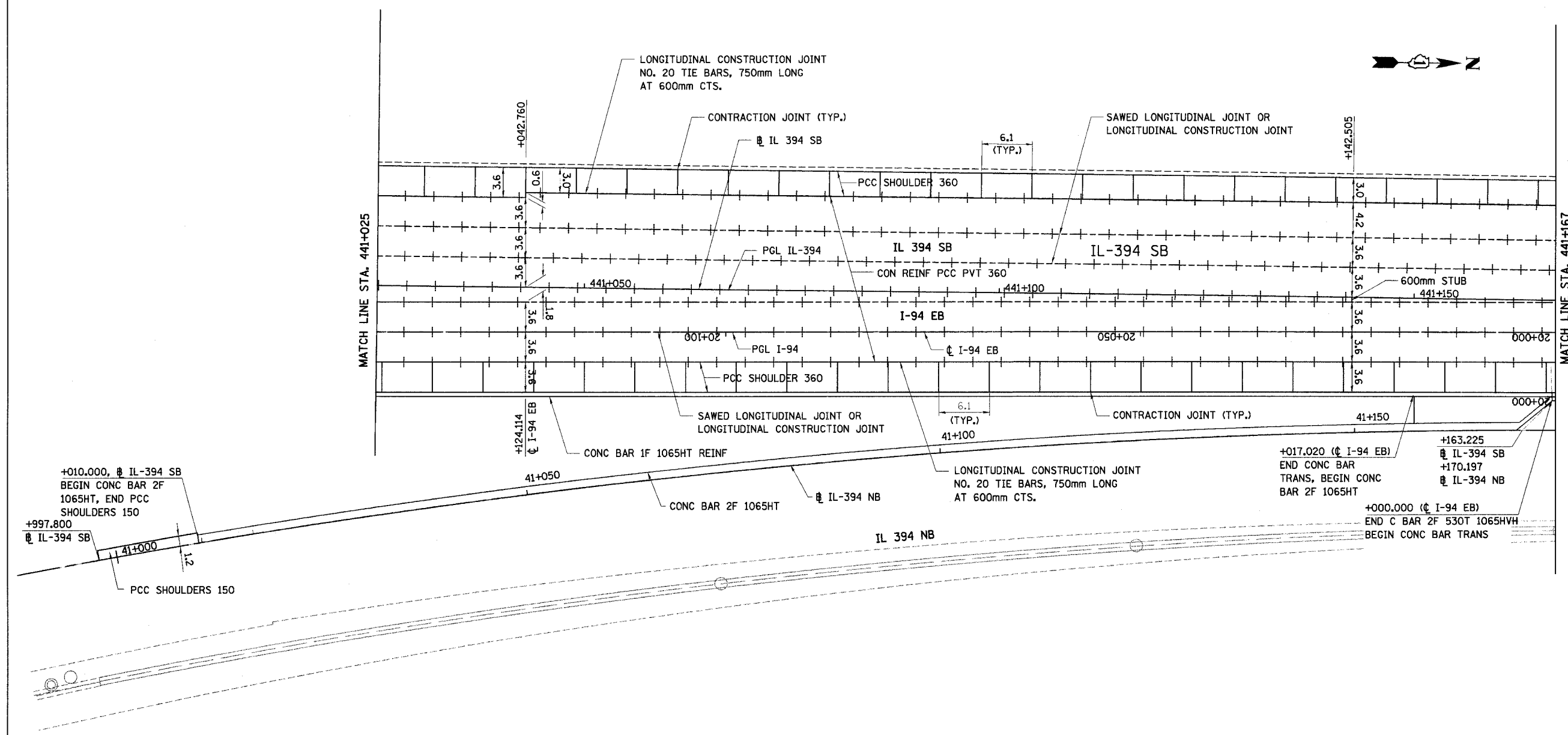

- NOTES:
1. ALL DIMENSIONS ARE IN METERS (m) UNLESS OTHERWISE NOTED.
 2. ALL PAVEMENT JOINTS SHALL BE DETAILED AS SHOWN ON STANDARD 420001 AND PCC SHOULDER DETAIL.
 3. ALL STATIONING OFF ϕ IL 394 UNLESS OTHERWISE NOTED.

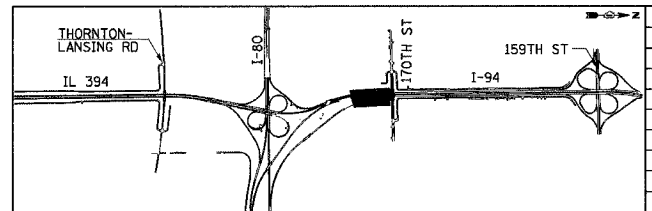

REVISIONS	
NAME	DATE

ILLINOIS DEPARTMENT OF TRANSPORTATION
 I-94 EAST BOUND / IL 394 SOUTH BOUND

PAVEMENT JOINTING PLAN
 IL 394 SB / I-94 EB

HORIZ SCALE: 1:250
 VERT SCALE: 1:250
 DATE: JULY 18, 2005

DRAWN BY: BJM/MAC
 CHECKED BY: JES

