

F.A.I. RTE 80/94	SECTION •	COUNTY COOK	TOTAL SHEETS 870	SHEET NO. 240
STA. 39+525		TO STA. 39+875		
FED ROAD DIST. NO.		ILLINOIS FED. AID PROJECT		

- NOTES:
1. MANHOLE TO BE RECONSTRUCTED.
 2. MANHOLE TO BE ADJUSTED.
 3. REFER TO ROADWAY PROFILE PLANS FOR ALL ROADWAY PROFILE SLOPE AND CURVE GEOMETRY.

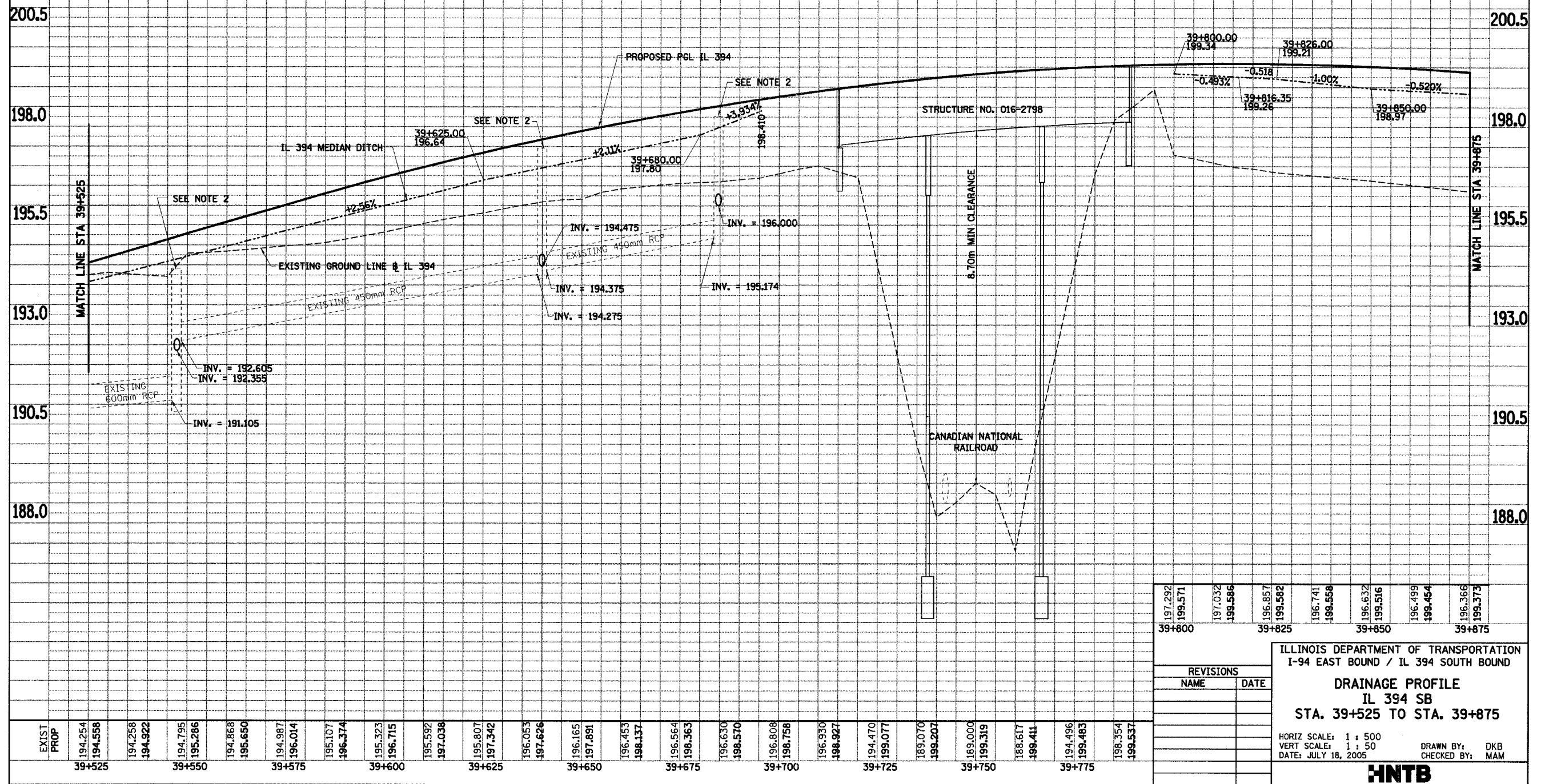

197.292	199.571	197.032	199.586	196.857	199.582	196.741	199.558	196.632	199.516	196.499	199.454	196.366	199.373										
39+800		39+825			39+850			39+875															
ILLINOIS DEPARTMENT OF TRANSPORTATION I-94 EAST BOUND / IL 394 SOUTH BOUND																							
DRAINAGE PROFILE IL 394 SB STA. 39+525 TO STA. 39+875																							
REVISIONS <table border="1"> <thead> <tr> <th>NAME</th> <th>DATE</th> </tr> </thead> <tbody> <tr><td> </td><td> </td></tr> <tr><td> </td><td> </td></tr> <tr><td> </td><td> </td></tr> <tr><td> </td><td> </td></tr> </tbody> </table>														NAME	DATE								
NAME	DATE																						
HORIZ SCALE: 1 : 500 VERT SCALE: 1 : 50 DATE: JULY 18, 2005 DRAWN BY: DKB CHECKED BY: MAM																							
HNTB																							