

F.A.I. RTE	SECTION	COUNTY	TOTAL SHEETS	SHEET NO.
80/94		COOK	870	232
STA. 440+900 TO STA. 441+167.161				
FED ROAD DIST. NO.		ILLINOIS FED. AID PROJECT		

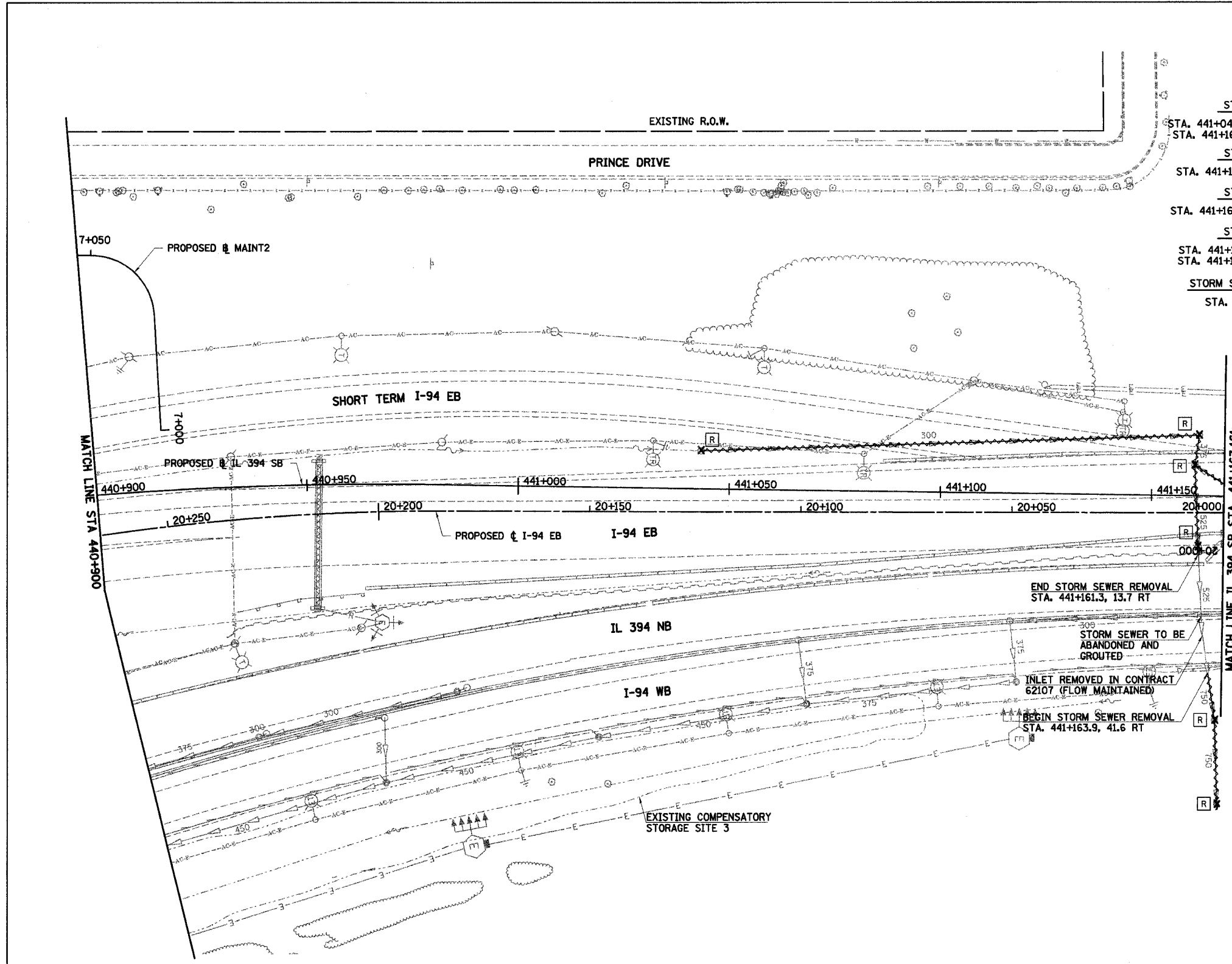

- STORM SEWER REMOVAL - 300mm**
 STA. 441+043.21 TO 441+161.13 - 118.0m (94.7 cu m)
 STA. 441+160.15 TO 441+167.161 - 8.2m (6.6 cu m)
- STORM SEWER REMOVAL - 375mm**
 STA. 441+161.13 TO 441+160.15 - 7.2m (7.4 cu m)
- STORM SEWER REMOVAL - 525mm**
 STA. 441+160.15 TO 441+161.30 - 21.0m (31.5 cu m)
- STORM SEWER REMOVAL - 750mm**
 STA. 441+163.9 TO 441+165.7 - 11.2m (25.5 cu m)
 STA. 441+165.7 TO 441+166.5 - 19.7m (44.8 cu m)
- STORM SEWER TO BE ABANDONED AND GROUTED**
 STA. 441+161.3 TO 441+163.9 - 6.2 cu m

- REMOVING CATCH BASINS**
 441+043.2, 9.1 LT
 441+161.1, 14.4 LT
 441+161.2, 12.0 RT
- REMOVING INLETS**
 441+160.2, 7.2 LT
- REMOVING MANHOLES**
 441+166.5, 72.3 RT
 441+165.7, 52.6 RT

- NOTES:**
1. ALL STATIONING AND OFFSET MEASUREMENTS OFF IL 394 SB UNLESS OTHERWISE NOTED.
 2. ALL DIMENSIONS ARE IN METERS (m) UNLESS OTHERWISE NOTED.
 3. ALL PIPE SIZES ARE IN MILLIMETERS (mm) UNLESS OTHERWISE NOTED.
 4. QUANTITY OF TRENCH BACKFILL FOR STORM SEWER REMOVAL IS PROVIDED IN SCHEDULE AT TOP OF PLAN SHEET AFTER LENGTH OF PIPE TO BE REMOVED. TRENCH BACKFILL QUANTITY BASED ON LENGTH OF PIPE REMOVED. IF EXISTING STORM SEWER IS REMOVED AND REPLACED, TRENCH BACKFILL WILL BE PROVIDED FOR PROPOSED STORM SEWER ONLY.

LEGEND - EXISTING

- | | | | |
|-------|--|-----|--|
| ○ | EXISTING INLET | REC | EXISTING DRAINAGE STRUCTURE RECONSTRUCTED |
| ○ | EXISTING CATCH BASIN | A | EXISTING FRAMES AND GRATES ADJUSTMENT |
| ○ | EXISTING MANHOLE | C | EXISTING DRAINAGE STRUCTURES TO BE CLEANED |
| ⊞ | EXISTING MEDIAN DRAINAGE STRUCTURE | → | EXISTING STORM SEWER TO BE REMOVED |
| X [R] | EXISTING DRAINAGE STRUCTURE REMOVAL | → | EXISTING STORM SEWER |
| [AD] | EXISTING DRAINAGE STRUCTURE ADJUSTMENT | → | EXISTING SLOTTED DRAIN |
| — | EXISTING DITCH | → | EXISTING PIPE UNDERDRAIN |

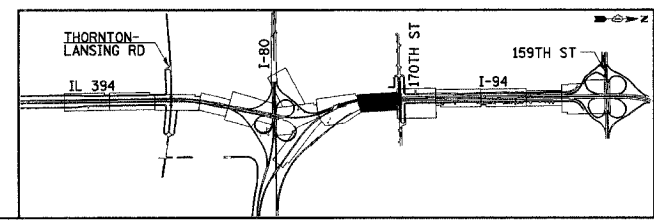

REVISIONS	
NAME	DATE

DU-21

ILLINOIS DEPARTMENT OF TRANSPORTATION
 I-94 EAST BOUND / IL 394 SOUTH BOUND

DRAINAGE AND UTILITIES
IL 394 SB
STA. 440+900 TO STA. 441+167.161

HORIZ SCALE: 1:500
 VERT SCALE: 1:500
 DATE: JULY 18, 2005

DRAWN BY: JPH
 CHECKED BY: MAM

HNTB