

F.A.I. RTE	SECTION	COUNTY	TOTAL SHEETS	SHEET NO.
80/94	*	COOK	870	220
STA.	38+550	TO STA.	38+875	
FED ROAD DIST. NO.	ILLINOIS FED. AID PROJECT			

REMOVING CATCH BASINS
38+742.2, 35.3 LT

CATCH BASINS TO BE ADJUSTED
38+640.0, 4.5 LT
38+742.6, 2.7 LT

MANHOLES TO BE ADJUSTED
38+640.1, 6.4 LT

MANHOLES TO BE RECONSTRUCTED W/ TIFCL
38+742.3, 6.0 LT

STORM SEWER REMOVAL - 450mm
38+742.199 TO 38+742.291 - 29.2m (36.7 cu m)

LEGEND - EXISTING

- EXISTING INLET
- EXISTING CATCH BASIN
- ⊙ EXISTING MANHOLE
- ⊠ EXISTING MEDIAN DRAINAGE STRUCTURE
- X [R] EXISTING DRAINAGE STRUCTURE REMOVAL
- AD. EXISTING DRAINAGE STRUCTURE ADJUSTMENT
- EXISTING DITCH
- REC EXISTING DRAINAGE STRUCTURE RECONSTRUCTED
- A EXISTING FRAMES AND GRATES ADJUSTMENT
- C EXISTING DRAINAGE STRUCTURES TO BE CLEANED
- EXISTING STORM SEWER TO BE REMOVED
- EXISTING STORM SEWER
- EXISTING SLOTTED DRAIN
- EXISTING PIPE UNDERDRAIN

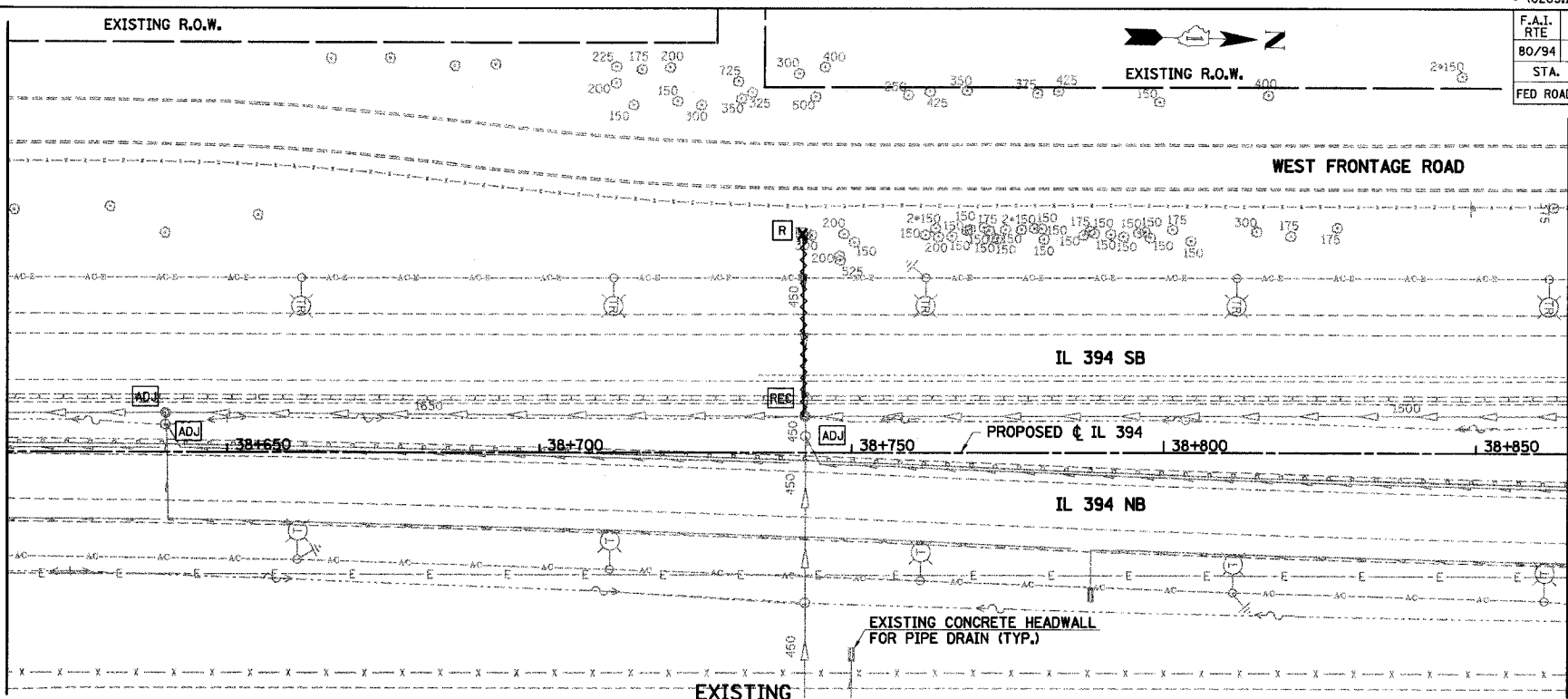

LEGEND - PROPOSED

- PROPOSED STORM SEWER
- PROPOSED SUMMIT
- PROPOSED DITCH
- PROPOSED SLOTTED DRAIN
- PROPOSED SWALE
- PROPOSED INLET
- PROPOSED CATCH BASIN
- ⊙ PROPOSED MANHOLE
- ⊠ MEDIAN DRAINAGE STRUCTURE
- ▲ PRECAST REINFORCED CONC. FLARED END SECTION

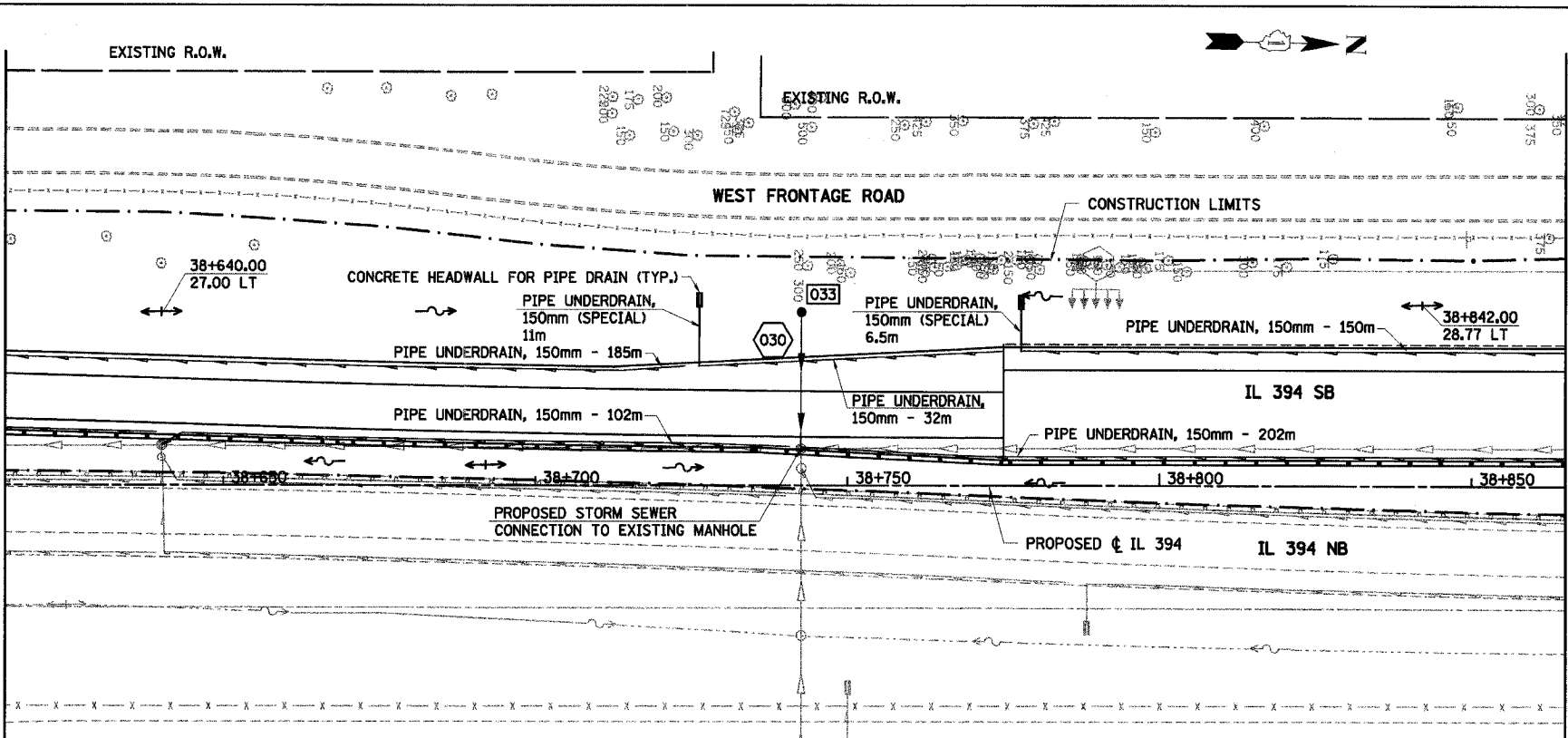

NOTES:

- ALL DIMENSIONS ARE IN METERS (m) UNLESS OTHERWISE NOTED.
- ALL PIPE SIZES IN MILLIMETERS (mm) UNLESS OTHERWISE NOTED.
- QUANTITY OF TRENCH BACKFILL FOR STORM SEWER REMOVAL IS PROVIDED IN SCHEDULE AT TOP OF PLAN SHEET AFTER LENGTH OF PIPE TO BE REMOVED. TRENCH BACKFILL QUANTITY BASED ON LENGTH OF PIPE REMOVED. IF EXISTING STORM SEWER IS REMOVED AND REPLACED, TRENCH BACKFILL WILL BE PROVIDED FOR PROPOSED STORM SEWER ONLY.

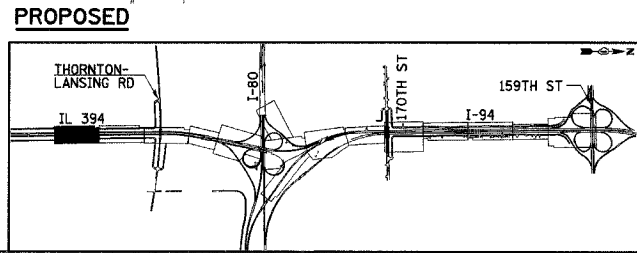

REVISIONS	
NAME	DATE

ILLINOIS DEPARTMENT OF TRANSPORTATION
I-94 EAST BOUND / IL 394 SOUTH BOUND

DRAINAGE AND UTILITIES
IL 394
STA. 38+615 TO STA. 38+865

HORIZ SCALE: 1:500
VERT SCALE: 1:500
DATE: JULY 18, 2005

DRAWN BY: JPH
CHECKED BY: MAM

HNTB