

F.A.I. RTE	SECTION	COUNTY	TOTAL SHEETS	SHEET NO.
80/94	*	COOK	870	213
STA.	18+363	TO STA.	18+725	
FED ROAD DIST. NO.	ILLINOIS		FED. AID PROJECT	

NOTES:

1. ALL DIMENSIONS IN METERS (m) UNLESS OTHERWISE NOTED.
2. ALL STATIONING AND OFFSET MEASUREMENTS OFF OF ϕ I-94 UNLESS OTHERWISE NOTED.
3. SEE TYPICAL SECTIONS FOR PIPE UNDERDRAIN LOCATIONS.
4. CONTRACTOR TO REMOVE TEMPORARY BULKHEAD FROM MEDIAN DRAINAGE STRUCTURES PLACED IN CONTRACT 62107 AND CONNECT PROPOSED STORM SEWER TO EXISTING INVERT. WORK INCLUDED IN COST OF PROPOSED STORM SEWER.
5. CONNECT PROPOSED DRAINAGE STRUCTURE TO EXISTING STORM SEWER. WORK INCLUDED IN COST OF MEDIAN DRAINAGE STRUCTURE. CONTRACTOR TO MATCH EXISTING INVERTS FROM REMOVED STRUCTURES.
6. PIPE UNDERDRAINS OFFSET FOR CLARITY. SEE TYPICAL SECTIONS FOR PIPE UNDERDRAIN LOCATIONS (TYP).

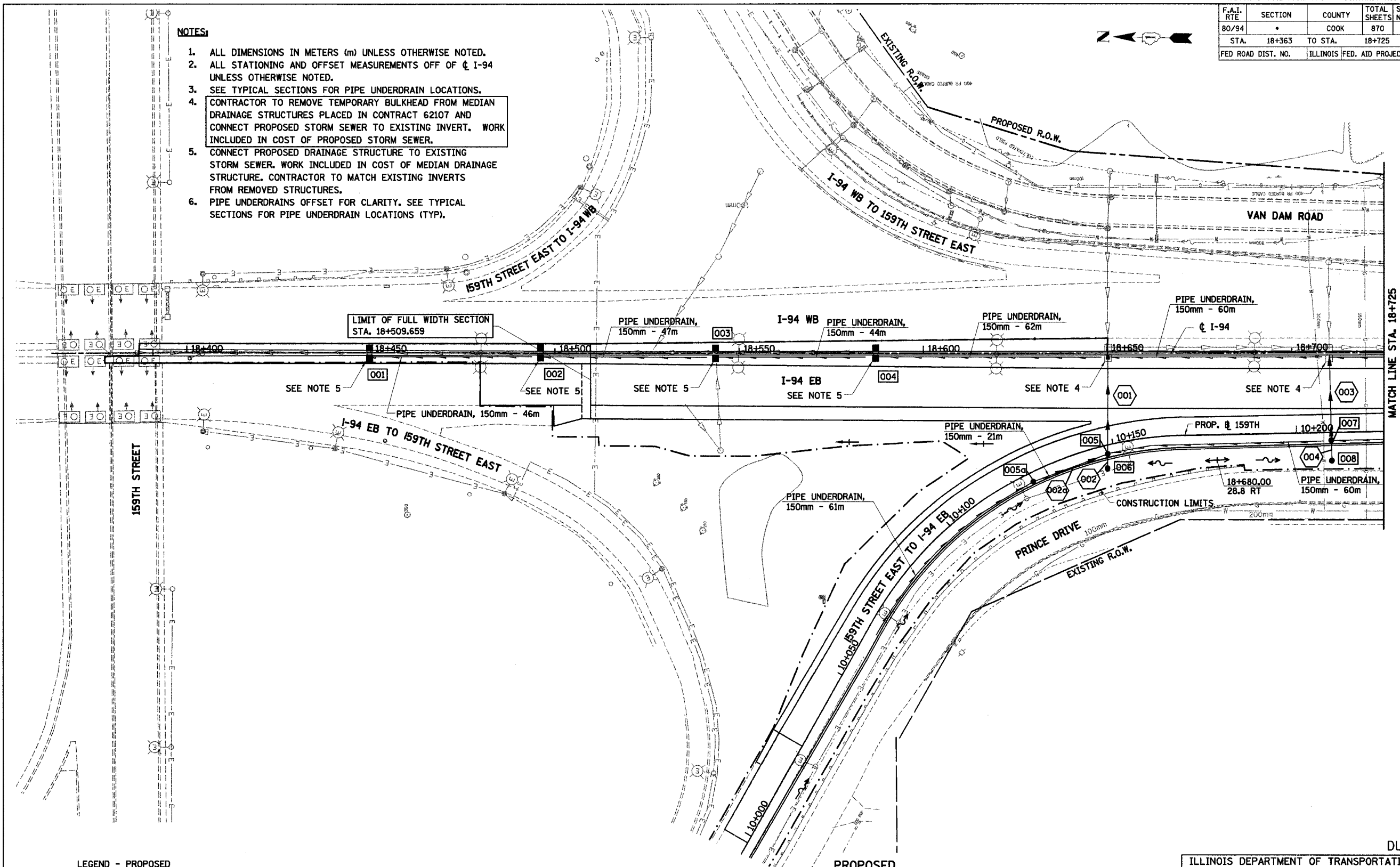

LEGEND - PROPOSED

- | | | | |
|--|------------------------|--|---|
| | PROPOSED STORM SEWER | | PROPOSED INLET |
| | PROPOSED SUMMIT | | PROPOSED CATCH BASIN |
| | PROPOSED DITCH | | PROPOSED MANHOLE |
| | PROPOSED SLOTTED DRAIN | | MEDIAN DRAINAGE STRUCTURE |
| | PROPOSED SWALE | | PRECAST REINFORCED CONC. FLARED END SECTION |

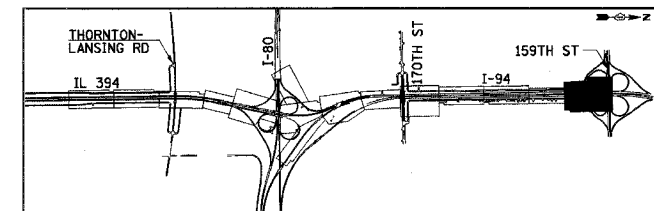

REVISIONS	
NAME	DATE

ILLINOIS DEPARTMENT OF TRANSPORTATION
I-94 EAST BOUND / IL 394 SOUTH BOUND

DRAINAGE AND UTILITIES
I-94
STA. 18+363 TO STA. 18+725

HORIZ SCALE: 1:500
VERT SCALE: 1:500
DATE: JULY 18, 2005

DRAWN BY: JPH
CHECKED BY: MAM

HNTB

MATCH LINE STA. 18+725