

F.A.I. 80/94 (KINGERY EXPRESSWAY) BORING LOCATION PLAN ILLINOIS DEPARTMENT OF TRANSPORTATION, COOK COUNTY		F.A.I. RTE	SECTION	COUNTY	TOTAL SHEETS NO.
80/94				COOK	870 175
STA. 18+725		TO STA. 19+050		ILLINOIS FED. AID PROJECT	
FED ROAD DIST. NO.					

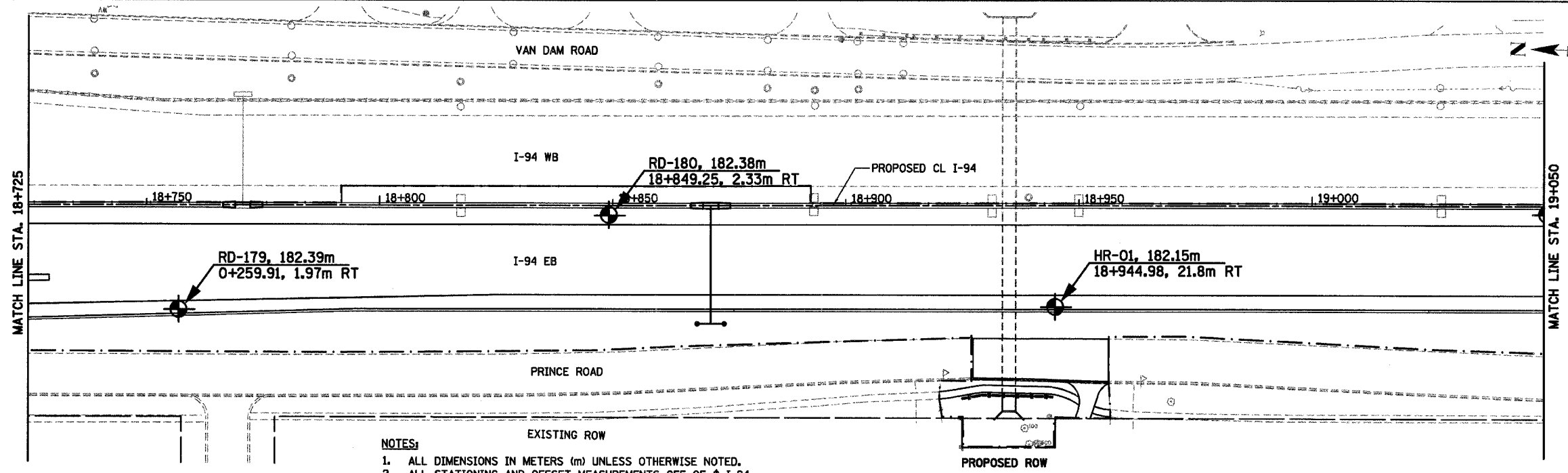

- NOTES:
1. ALL DIMENSIONS IN METERS (m) UNLESS OTHERWISE NOTED.
  2. ALL STATIONING AND OFFSET MEASUREMENTS OFF OF CL I-94 UNLESS OTHERWISE STATED.

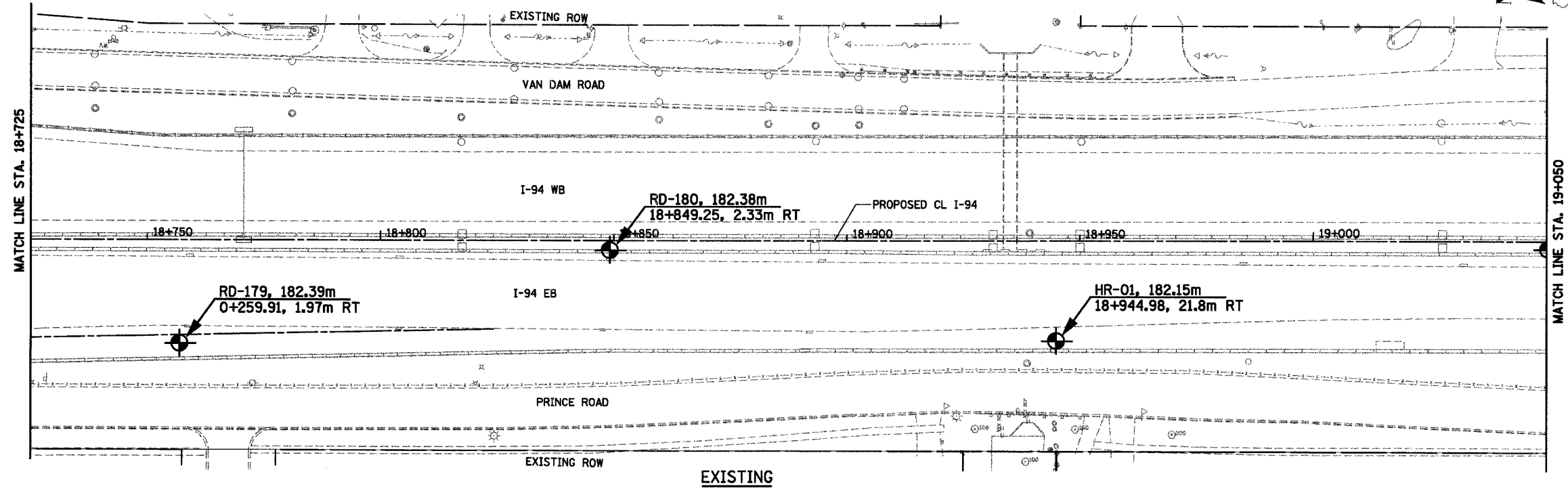
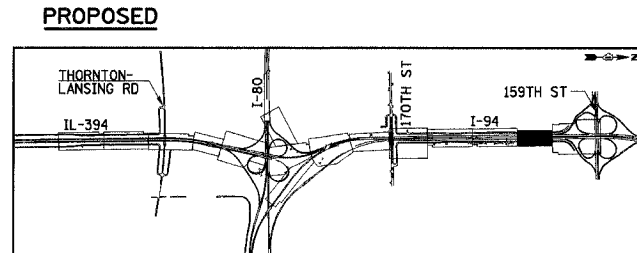

REVISIONS	
NAME	DATE

SB-03  
ILLINOIS DEPARTMENT OF TRANSPORTATION  
I-94 EAST BOUND / IL 394 SOUTH BOUND  
**SOIL BORING PLAN**  
I-94  
STA. 18+725 TO STA. 19+050  
HORIZ SCALE: 1:500  
VERT SCALE:  
DATE: JULY 18, 2005  
DRAWN BY:  
CHECKED BY: