

F.A.I. RTE	SECTION	COUNTY	TOTAL SHEETS	SHEET NO.
80/94		COOK	870	129
STA. 18+725		TO STA. 19+050		
FED ROAD DIST. NO.		ILLINOIS FED. AID PROJECT		

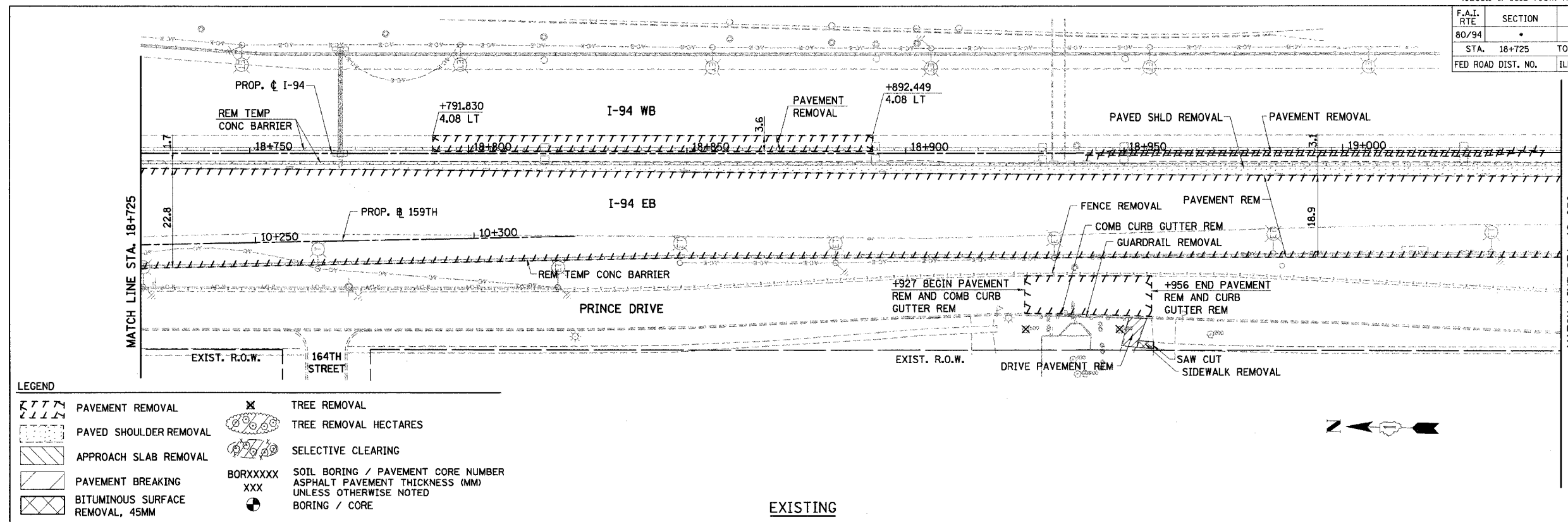

**LEGEND**

	PAVEMENT REMOVAL		TREE REMOVAL
	PAVED SHOULDER REMOVAL		TREE REMOVAL HECTARES
	APPROACH SLAB REMOVAL		SELECTIVE CLEARING
	PAVEMENT BREAKING	BORXXXX	SOIL BORING / PAVEMENT CORE NUMBER
	BITUMINOUS SURFACE REMOVAL, 45MM	XXX	ASPHALT PAVEMENT THICKNESS (MM) UNLESS OTHERWISE NOTED
			BORING / CORE

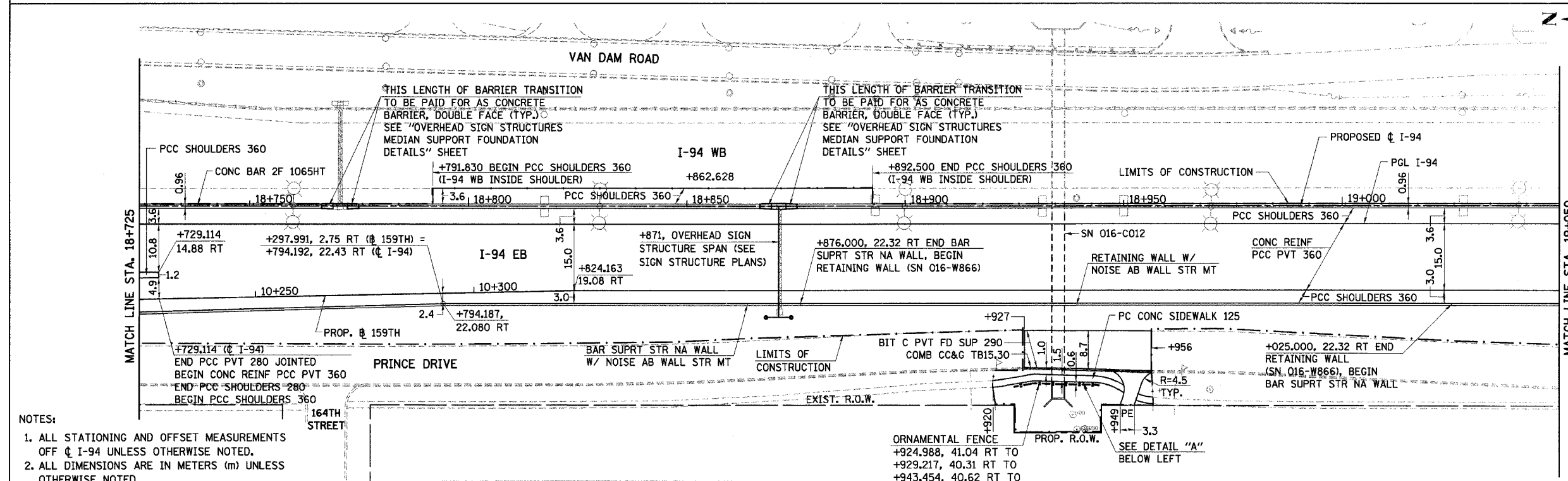

- NOTES:**
1. ALL STATIONING AND OFFSET MEASUREMENTS OFF @ I-94 UNLESS OTHERWISE NOTED.
  2. ALL DIMENSIONS ARE IN METERS (m) UNLESS OTHERWISE NOTED.
  3. ALL TREE DIAMETERS ARE IN MILLIMETERS (mm) UNLESS OTHERWISE NOTED.
  4. WHERE EXISTING SIGNS INTERFERE WITH CONSTRUCTION OPERATIONS, SEE ARTICLE 107.25 OF THE STANDARD SPECIFICATIONS.
  5. SEE CONTRACT 62664 FOR LIGHTING REMOVAL.
  6. ALL CONCRETE GUTTER OR COMBINATION CONCRETE CURB AND GUTTER ENCOUNTERED UNDER THE EXISTING BITUMINOUS SURFACE SHALL BE REMOVED AND PAID FOR UNDER ITS CORRESPONDING PAY ITEM

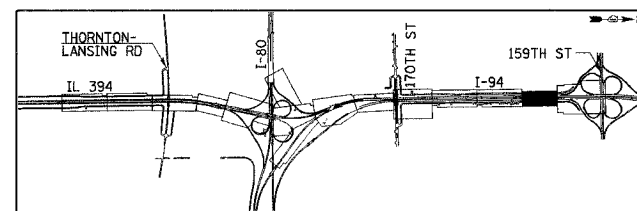
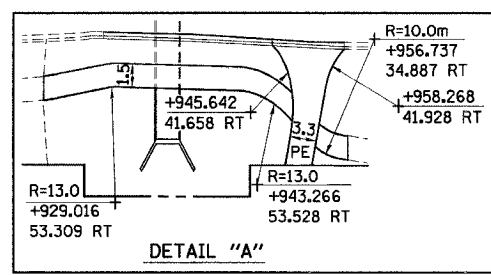

**REVISIONS**

NAME	DATE

ILLINOIS DEPARTMENT OF TRANSPORTATION  
 I-94 EAST BOUND / IL 394 SOUTH BOUND  
**EXISTING AND PROPOSED PLAN**  
 I-94  
 STA. 18+725 TO STA. 19+050

HORIZ SCALE: 1:500  
 VERT SCALE:  
 DATE: JULY 18, 2005

DRAWN BY: BAJ  
 CHECKED BY: JES

**HNTB**