

F.A.I. RTE	SECTION	COUNTY	TOTAL SHEETS	SHEET NO.
80/94	*	COOK	870	113
STA. 19+825		TO STA. 41+075		
FED ROAD DIST. NO.		ILLINOIS FED. AID PROJECT		

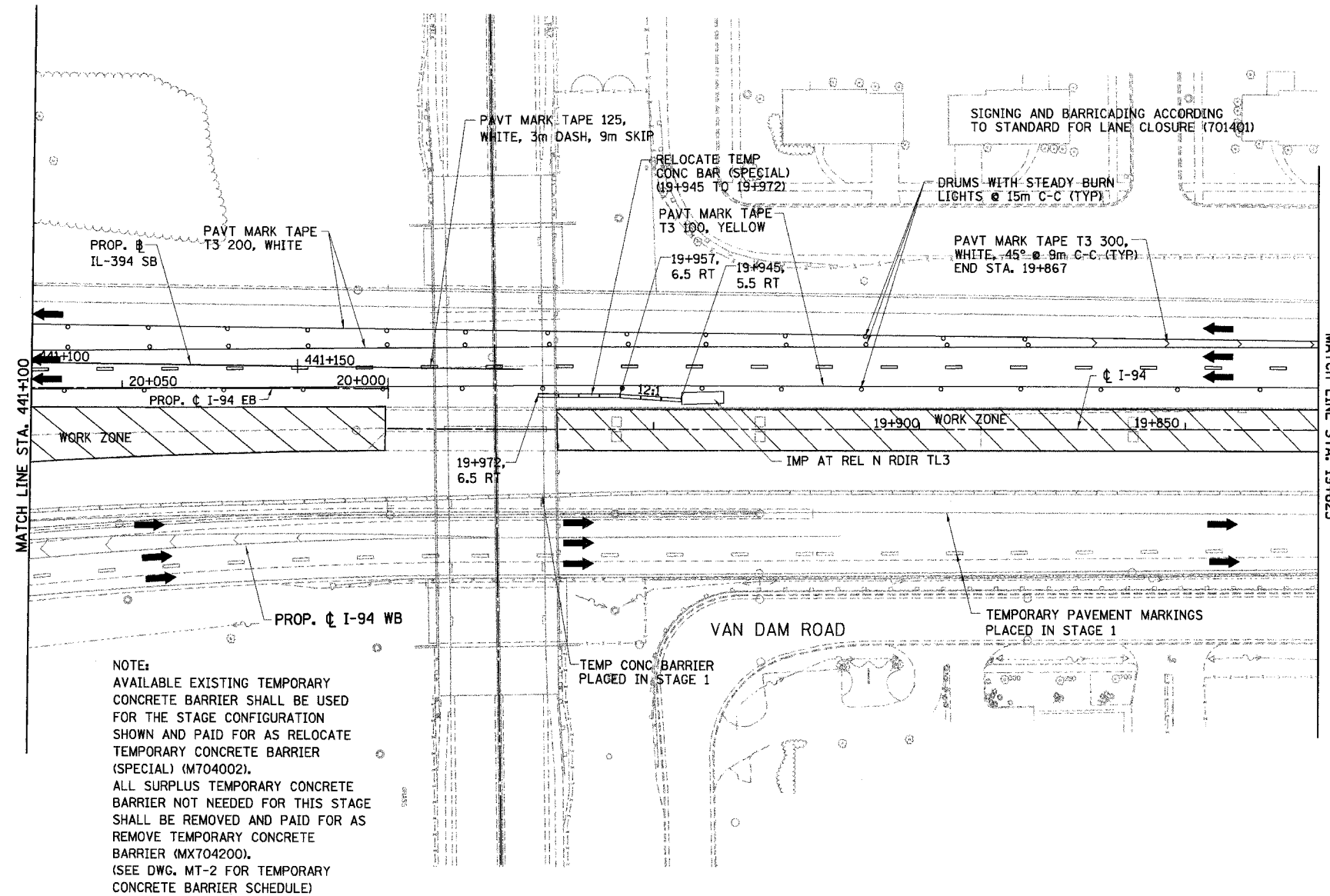

LEGEND

- WORK ZONE
- TEMPORARY PAVEMENT
- TRAFFIC DIRECTION
- LANE CLOSURE
- DRUMS WITH STEADY BURN LIGHTS
- VERTICAL PANELS
- TYPE III BARRICADE WITH 2 FLASHING LIGHTS

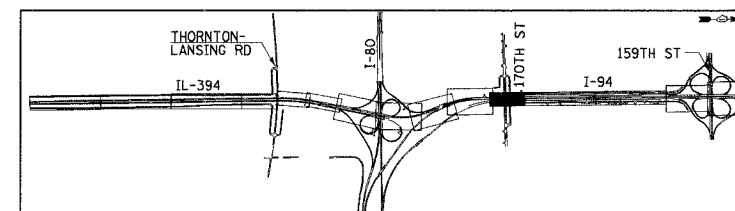

REVISIONS	
NAME	DATE

MT-39

ILLINOIS DEPARTMENT OF TRANSPORTATION  
 I-94 EAST BOUND / IL 394 SOUTH BOUND

**MAINTENANCE OF TRAFFIC  
 IL-394/ I-94 - STAGE 3  
 STA. 19+825 TO STA. 441+100**

HORIZ SCALE: 1:500  
 VERT SCALE: NONE  
 DATE: JULY 18, 2005

DRAWN BY: STS  
 CHECKED BY: JES

**HNTB**