

| F.A.I. RTE                 | SECTION | COUNTY                    | TOTAL SHEETS | SHEET NO. |
|----------------------------|---------|---------------------------|--------------|-----------|
| 80/94                      |         | COOK                      | 870          | 92        |
| STA. 18+725 TO STA. 19+275 |         | ILLINOIS FED. AID PROJECT |              |           |

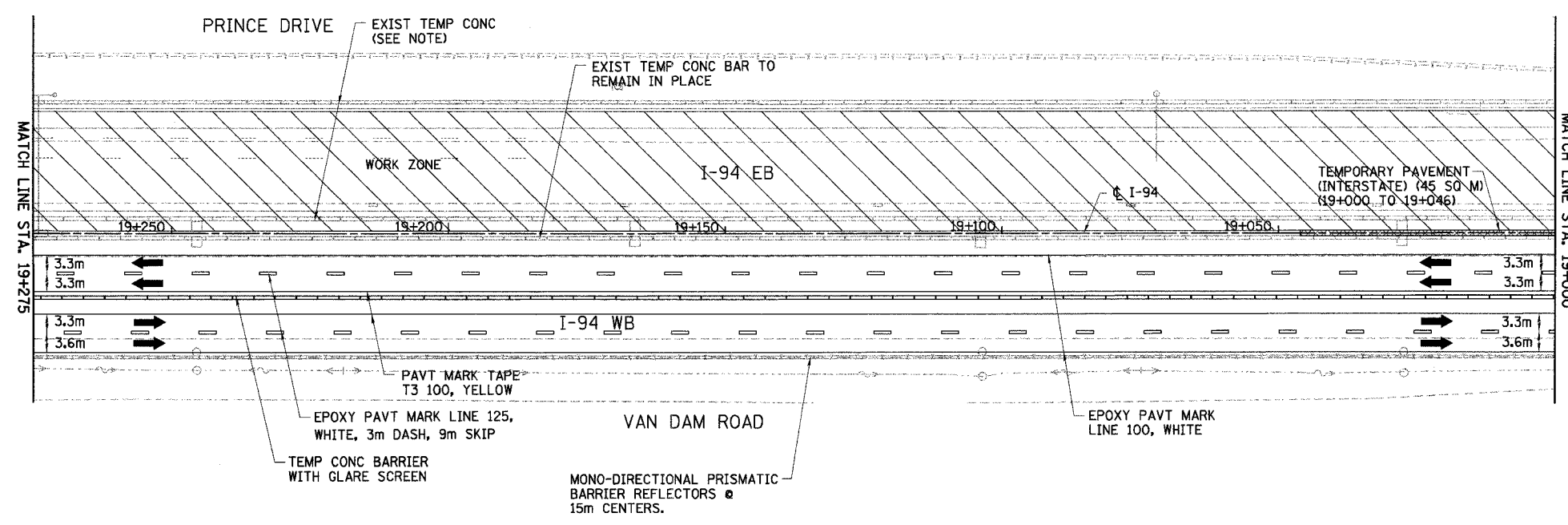
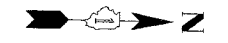

NOTE:  
AVAILABLE EXISTING TEMPORARY CONCRETE BARRIER SHALL BE USED FOR THE STAGE CONFIGURATION SHOWN AND PAID FOR AS RELOCATE TEMPORARY CONCRETE BARRIER (SPECIAL) (M704002), WHERE THERE IS A SHORTAGE, TEMPORARY CONCRETE BARRIER (M7040100) SHALL BE USED (SEE DWG. MT-2 FOR TEMPORARY CONCRETE BARRIER SCHEDULE)

GLARE SCREEN SHALL BE PAID SEPARATELY AS MODULAR GLARE SCREEN SYSTEM.

MONO-DIRECTIONAL PRISMATIC REFLECTORS SHALL BE PLACED ON EACH SIDE OF WALL AS SHOWN IN MAINTENANCE OF TRAFFIC TYPICAL SECTIONS.

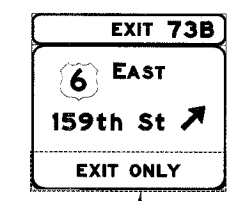
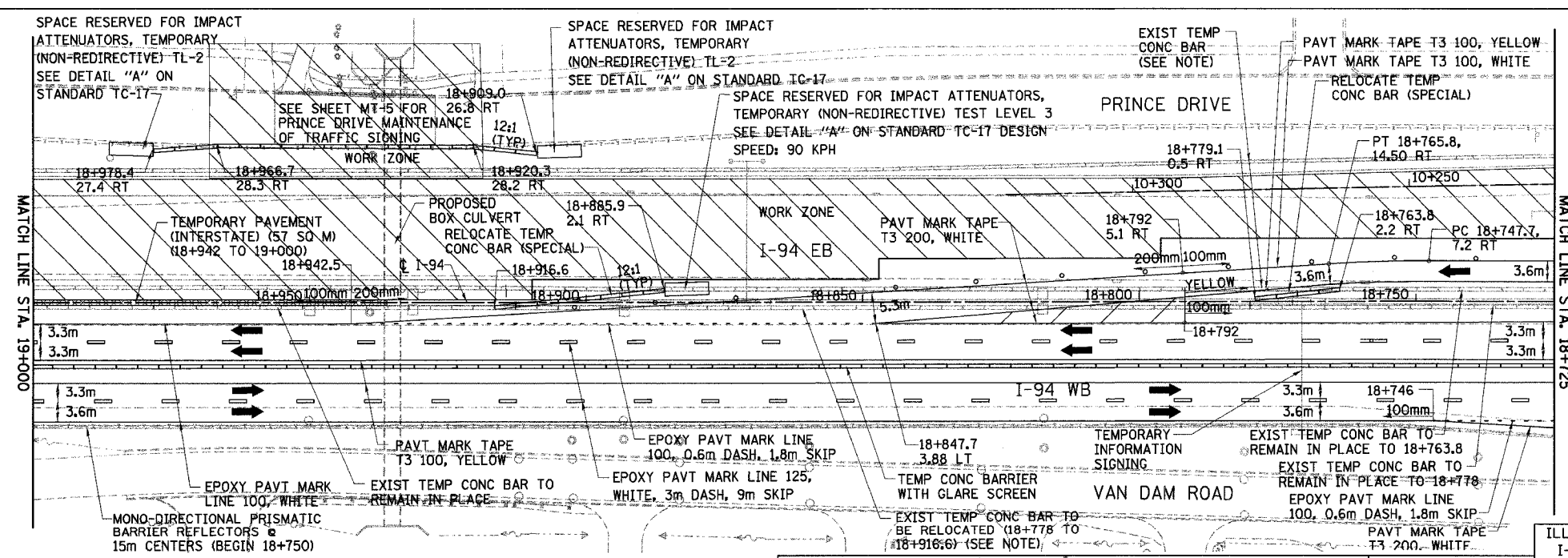

LEGEND

|  |                    |  |   |
|--|--------------------|--|---|
|  | WORK ZONE          |  | DRUMS WITH STEADY BURN LIGHTS             |
|  | TEMPORARY PAVEMENT |  | VERTICAL PANELS                           |
|  | TRAFFIC DIRECTION  |  | TYPE III BARRICADE WITH 2 FLASHING LIGHTS |
|  | LANE CLOSURE       |  |   |

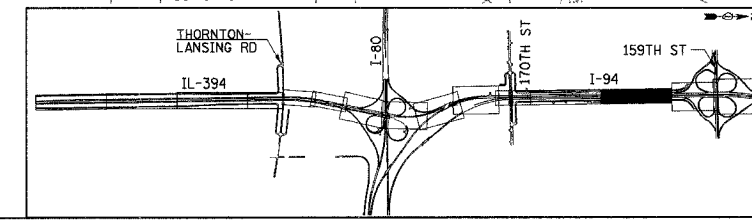

| REVISIONS |      |
|-----------|------|
| NAME      | DATE |
|           |      |
|           |      |
|           |      |
|           |      |

ILLINOIS DEPARTMENT OF TRANSPORTATION  
I-94 EAST BOUND / IL 394 SOUTH BOUND

**MAINTENANCE OF TRAFFIC**  
I-94 - STAGE 1  
STA. 18+725 TO STA. 19+275

HORIZ SCALE: 1:500  
VERT SCALE: NONE  
DATE: JULY 18, 2005

DRAWN BY: STS  
CHECKED BY: JES

**HNTB**