

F.A.I. RTE	SECTION	COUNTY	TOTAL SHEETS	SHEET NO.
80/94		COOK	870	91
STA. 19+275		TO STA. 19+825		
FED ROAD DIST. NO.		ILLINOIS FED. AID PROJECT		

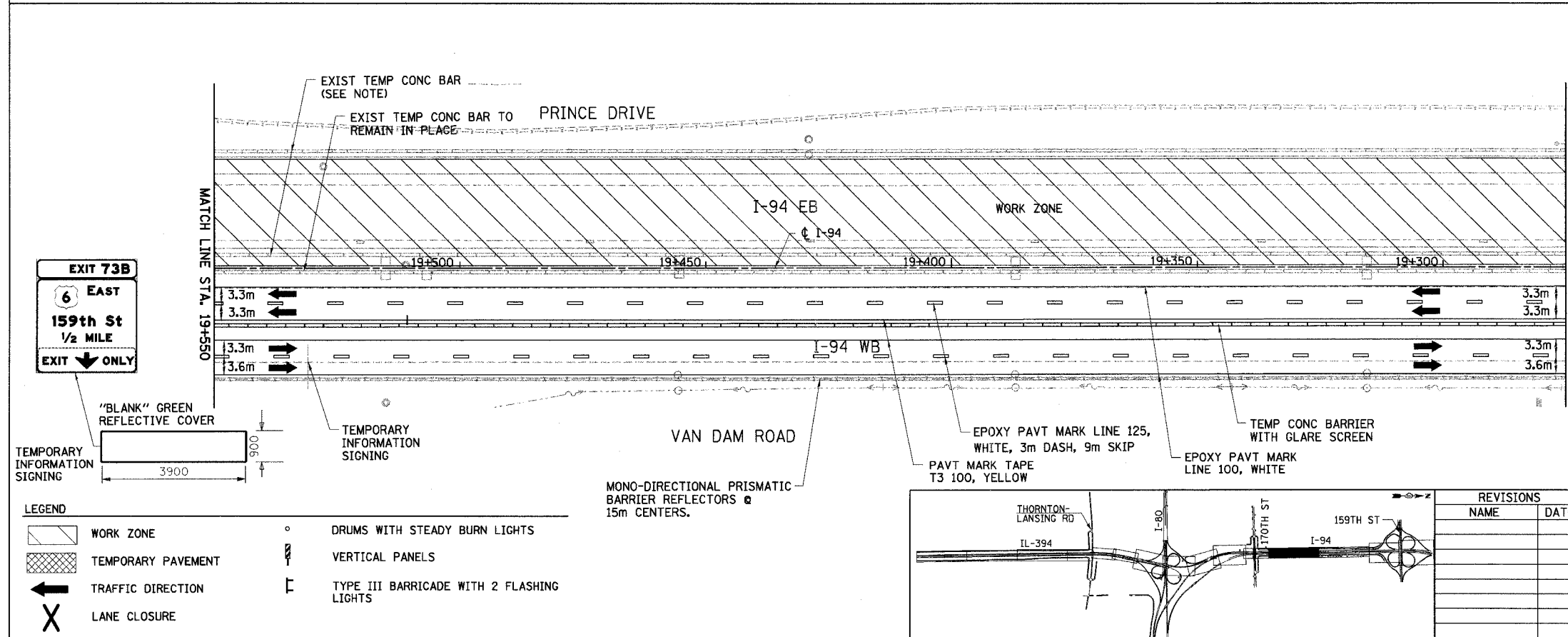
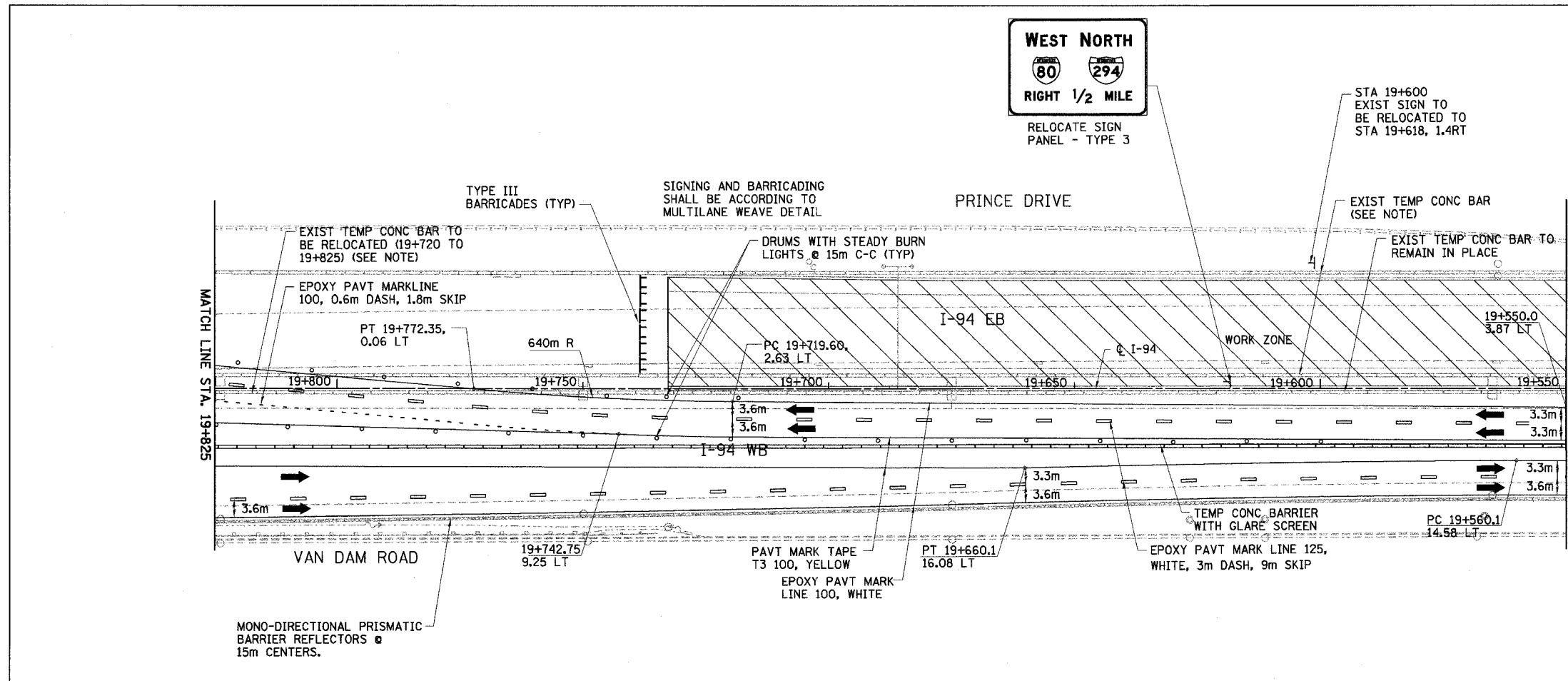

NOTE:
AVAILABLE EXISTING TEMPORARY CONCRETE BARRIER SHALL BE USED FOR THE STAGE CONFIGURATION SHOWN AND PAID FOR AS RELOCATE TEMPORARY CONCRETE BARRIER (SPECIAL) (M704002). WHERE THERE IS A SHORTAGE, TEMPORARY CONCRETE BARRIER (M7040100) SHALL BE USED (SEE DWG. MT-2 FOR TEMPORARY CONCRETE BARRIER SCHEDULE)

GLARE SCREEN SHALL BE PAID SEPARATELY AS MODULAR GLARE SCREEN SYSTEM.

MONO-DIRECTIONAL PRISMATIC REFLECTORS SHALL BE PLACED ON EACH SIDE OF WALL AS SHOWN IN MAINTENANCE OF TRAFFIC TYPICAL SECTIONS.

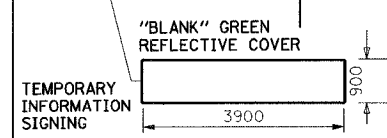
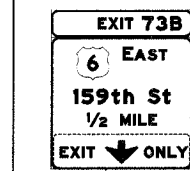

LEGEND

	WORK ZONE		DRUMS WITH STEADY BURN LIGHTS
	TEMPORARY PAVEMENT		VERTICAL PANELS
	TRAFFIC DIRECTION		TYPE III BARRICADE WITH 2 FLASHING LIGHTS
	LANE CLOSURE		

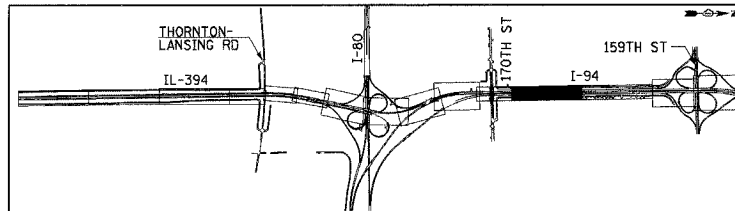

REVISIONS	
NAME	DATE

MT-17
ILLINOIS DEPARTMENT OF TRANSPORTATION
I-94 EAST BOUND / IL 394 SOUTH BOUND

MAINTENANCE OF TRAFFIC
I-94 - STAGE 1
STA. 19+275 TO STA. 19+825

HORIZ SCALE: 1:500
VERT SCALE: NONE
DATE: JULY 18, 2005

DRAWN BY: STS
CHECKED BY: JES

HNTB