

• (0203.1 & 0312-708W) R-3 CONTRACT NO. 62108

F.A.I. RTE	SECTION	COUNTY	TOTAL SHEETS	SHEET NO.
80/94	*	COOK	870	89
STA. 40+800		TO STA. 41+075		
FED ROAD DIST. NO.		ILLINOIS FED. AID PROJECT		

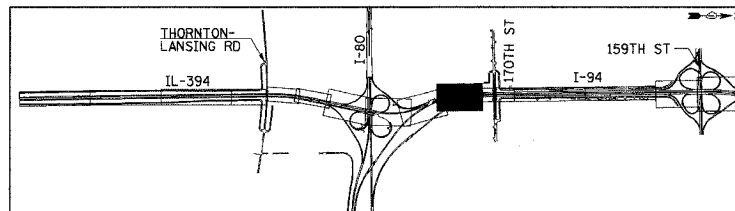
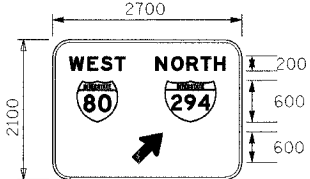
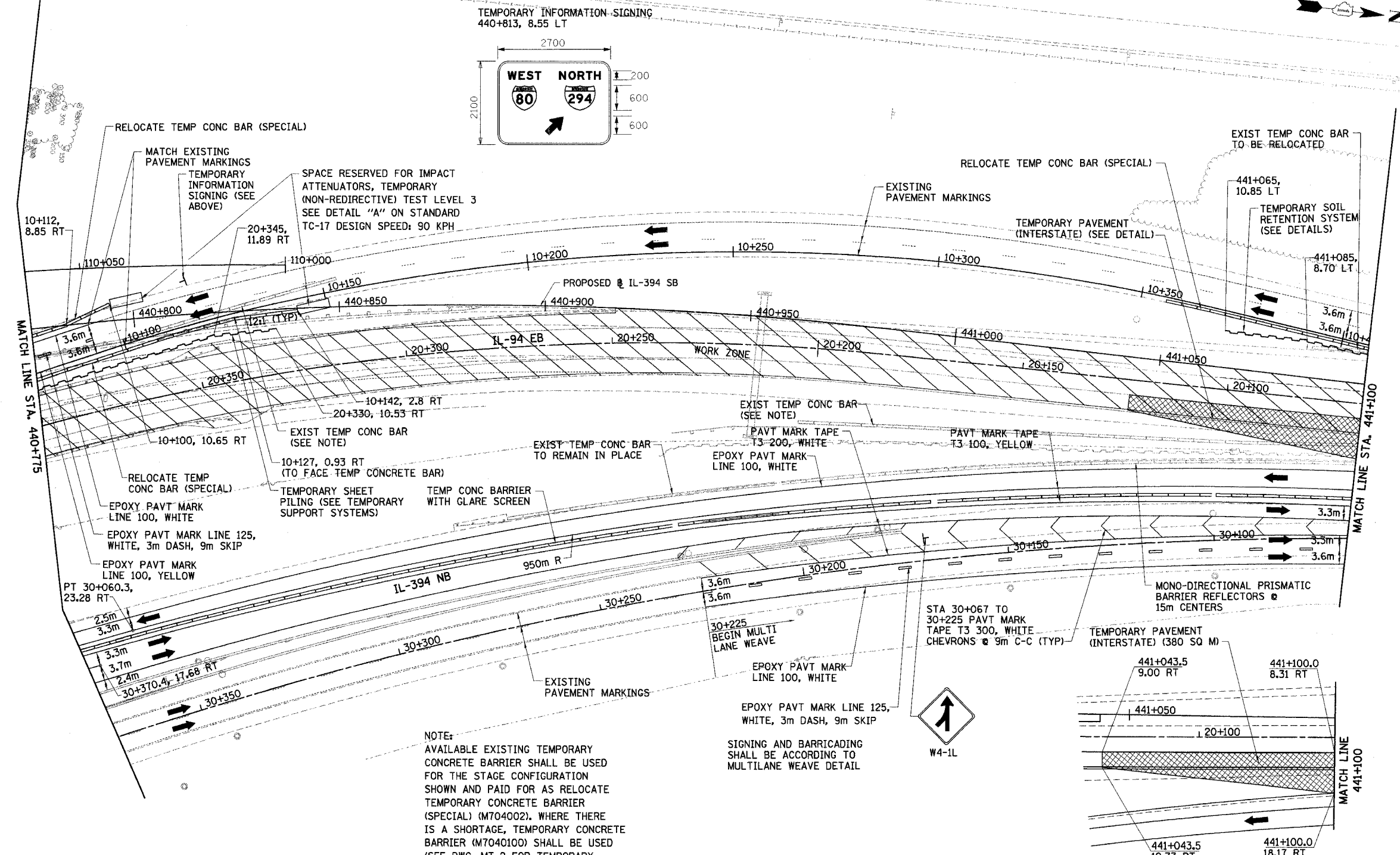

REVISIONS	
NAME	DATE

ILLINOIS DEPARTMENT OF TRANSPORTATION  
I-94 EAST BOUND / IL 394 SOUTH BOUND

MT-15

MAINTENANCE OF TRAFFIC  
IL-394 - STAGE 1  
STA. 440+775 TO STA. 441+100

HORIZ SCALE: 1:500  
VERT SCALE: NONE  
DATE: JULY 18, 2005

DRAWN BY: STS  
CHECKED BY: JES

**HNTB**