

F.A.I. RTE.	SECTION	COUNTY	TOTAL SHEETS	SHEET NO.
80/94	*	COOK	825	1

FOR INDEX OF SHEETS, SEE SHEET NO. 2

**TRAFFIC DATA**

FAI 94 ( INTERSTATE 94)  
IL 394 ( ILLINOIS ROUTE 394)

**DESIGN DESIGNATION:**

I-94 EB (F.A.I. RTE 94): 4600 (20) INTERSTATE 70.60 (CRCP-30)  
IL 394 SB (F.A.P. RTE 332): 3050 (20) FREEWAY 38.95 (CRCP-30)

**ADT:**

I-94 = 92,700 (1995); 116,000 (2020)  
IL 394 = 41,900 (1995); 78,000 (2020)

**DESIGN SPEED:**

I-94 = 110 KM/HR  
IL 394 = 110 KM/HR

I-94	=	1490.341 m
I-94 EB	=	1024.196 m
IL 394	=	1412.509 m
IL 394 SB	=	1042.854 m
GROSS LENGTH	=	4969.900 m
NET LENGTH	=	4969.900 m = 4.970 km

**METRIC RATIOS**

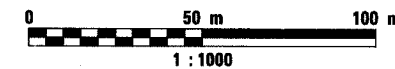
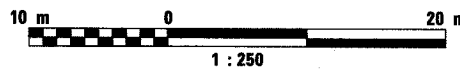
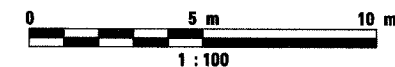
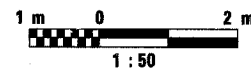

FULL SIZE PLANS HAVE BEEN PREPARED USING STANDARD ENGINEERING SCALES. REDUCED SIZED PLANS WILL NOT CONFORM TO STANDARD SCALES. IN MAKING MEASUREMENTS ON REDUCED PLANS, THE ABOVE SCALES MAY BE USED.

J.U.L.I.E.  
JOINT UTILITY LOCATION  
INFORMATION FOR EXCAVATION  
1-800-892-0123

STATE OF ILLINOIS  
DEPARTMENT OF TRANSPORTATION  
DIVISION OF HIGHWAYS

**PROPOSED  
HIGHWAY PLANS**

ROUTE: F.A.I. 94 (I-94) & F.A.P. 332 (IL 394)  
SECTION (0203.1 & 0312-708W) R-3

**ADD LANES, BRIDGE REPLACEMENT, INTERCHANGE RECONSTRUCTION  
SOUTH BOUND  
(SOUTH OF 159TH STREET TO SOUTH OF THORNTON-LANSING ROAD)  
PROJECT: ACNHI-ACNHF-000S(471)  
COOK COUNTY  
C-91-014-01**

THIS IMPROVEMENT IS LOCATED IN  
THE VILLAGES OF LANSING AND SOUTH  
HOLLAND IN COOK COUNTY.

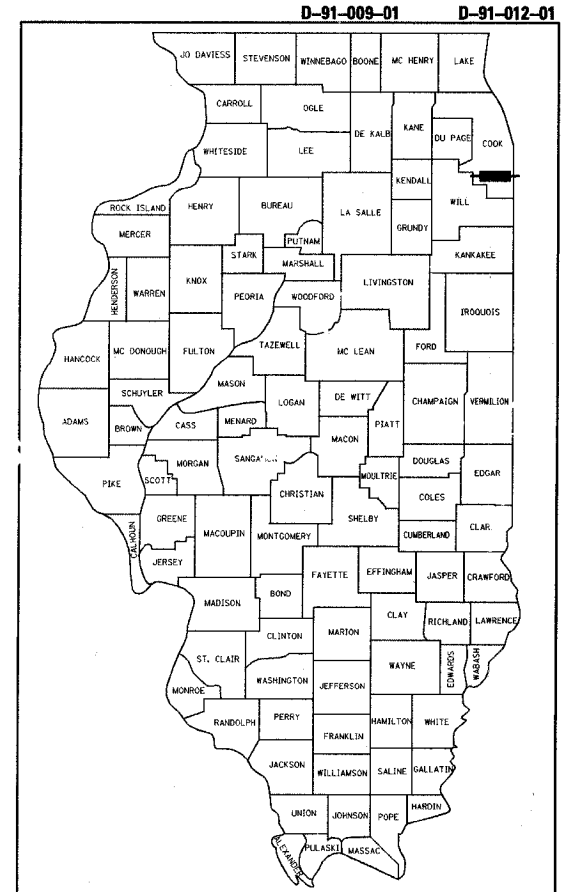

LOCATION OF SECTION INDICATED THUS: -

STATE OF ILLINOIS  
DEPARTMENT OF TRANSPORTATION  
DIVISION OF HIGHWAYS

SUBMITTED July 5, 20 05  
Dina O'Keefe/PA  
DEPUTY DIRECTOR OF HIGHWAYS, REGION ENGINEER

October 14, 20 05  
Mike Line/PA  
ENGINEER OF DESIGN AND ENVIRONMENT

October 14, 20 05  
Eric E. Ham/PA  
DEPUTY DIRECTOR OF HIGHWAYS, CHIEF ENGINEER

**PRINTED BY THE AUTHORITY  
OF THE STATE OF ILLINOIS**

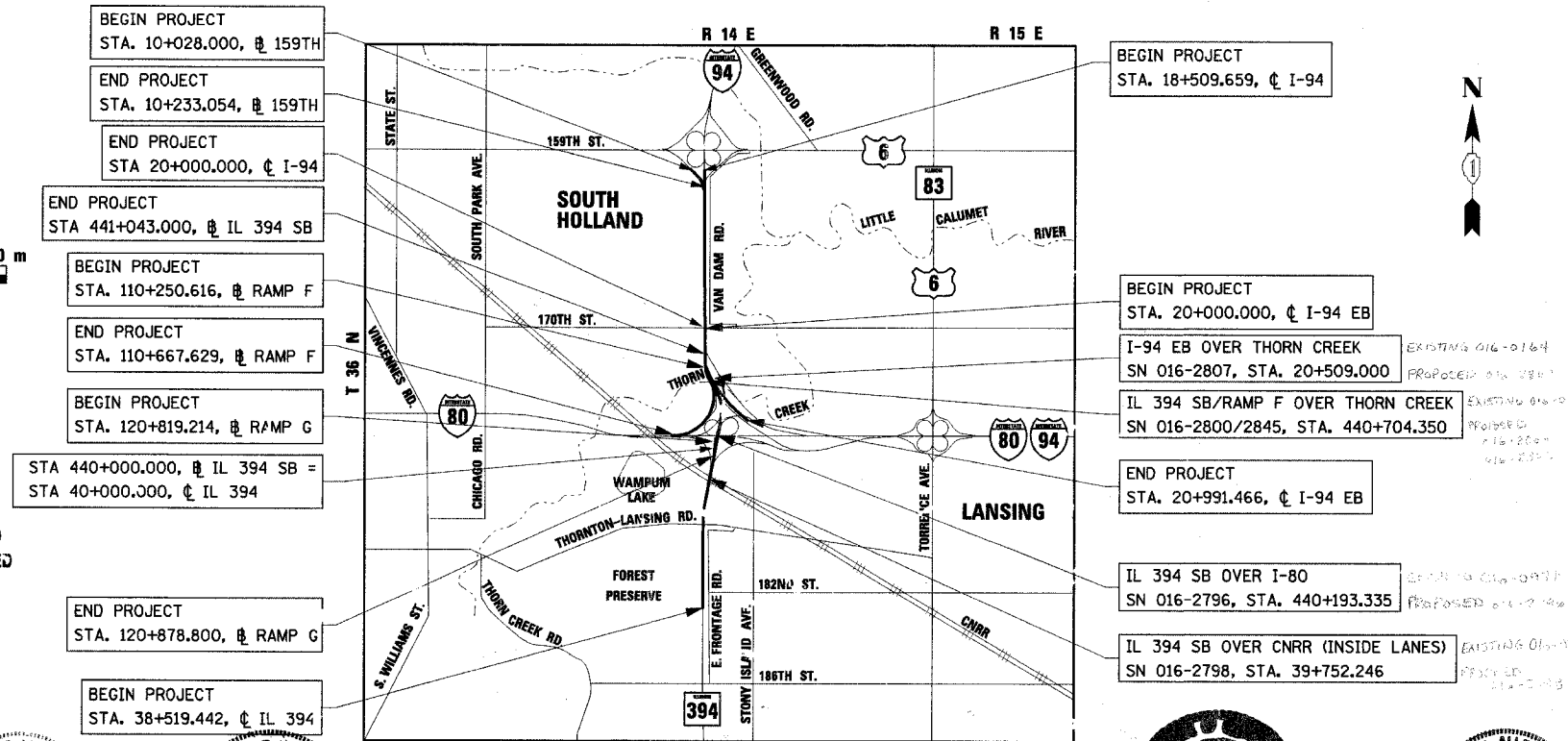

SUNG H. LEE, P.E.  
LICENSE NO. 062-039022  
EXPIRES: 11/30/05  
DATE: 6/30/05  
SHEETS: ROADWAY -  
1-26, 30-47, 49, 51-58, 61-121,  
127-149, 152-158, 161-170,  
212-235, 238-255, 272-283,  
287-297, 301-312, 371-380,  
382-412, 415, 761-763,  
765-792, 812-870



PHILIP C. AZZARELLO, S.E.  
LICENSE NO. 081-004245  
EXPIRES: 11/30/06  
DATE: 6-30-05  
SHEETS: STRUCTURAL -  
315-334, 344-352b, 443-473,  
511-667, 705-707, 715-716



BRIAN BURKHARD, P.E.  
LICENSE NO. 062-049173  
EXPIRES: 11/30/05  
DATE: 6/28/05  
SHEETS: LIGHTING -  
417-442

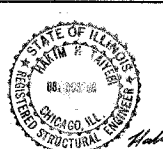

HAKIM H. TAIYEBI, S.E.  
LICENSE NO. 081-003266  
EXPIRES: 11/30/06  
DATE: 6/22/05  
SHEETS: STRUCTURAL -  
474-510



DEBORAH A. ZROKA, S.E.  
LICENSE NO. 081-005152  
EXPIRES: 11/30/06  
DATE: 6-30-05  
SHEETS: STRUCTURAL -  
668-704



RICHARD A. SAMs, P.E.  
LICENSE NO. 062-036430  
EXPIRES: 11/30/05  
DATE: 6-23-05  
SHEETS: ROADWAY -  
27-29, 48, 50, 59-60, 122-126, 150-151,  
159-160, 171-172, 236-237, 284-286,  
298-300, 313-314, 335-343, 381,  
413-414, 726-727, 764, 793-811



CONSULTANT PROJECT ENGINEER: CATHERINE A. KIBBLE (847) 705-4269 - Schaumburg, IL.