

FINAL SURVEY	SURVEYED	BY	DATE
NOTE BOOK	PLOTTED		
AREAS CHECKED	TEMPLATE		
AREAS CHECKED	AREAS CHECKED		

ORIGINAL SURVEY	SURVEYED	BY	DATE
NOTE BOOK	PLOTTED		
AREAS CHECKED	TEMPLATE		
AREAS CHECKED	AREAS CHECKED		

FILE NAME = S:\P\Projects\089-0228-VH-IL-3\Grat\cm\cadd\CADD\_Sheets\0876789-plt-ssht.dgn

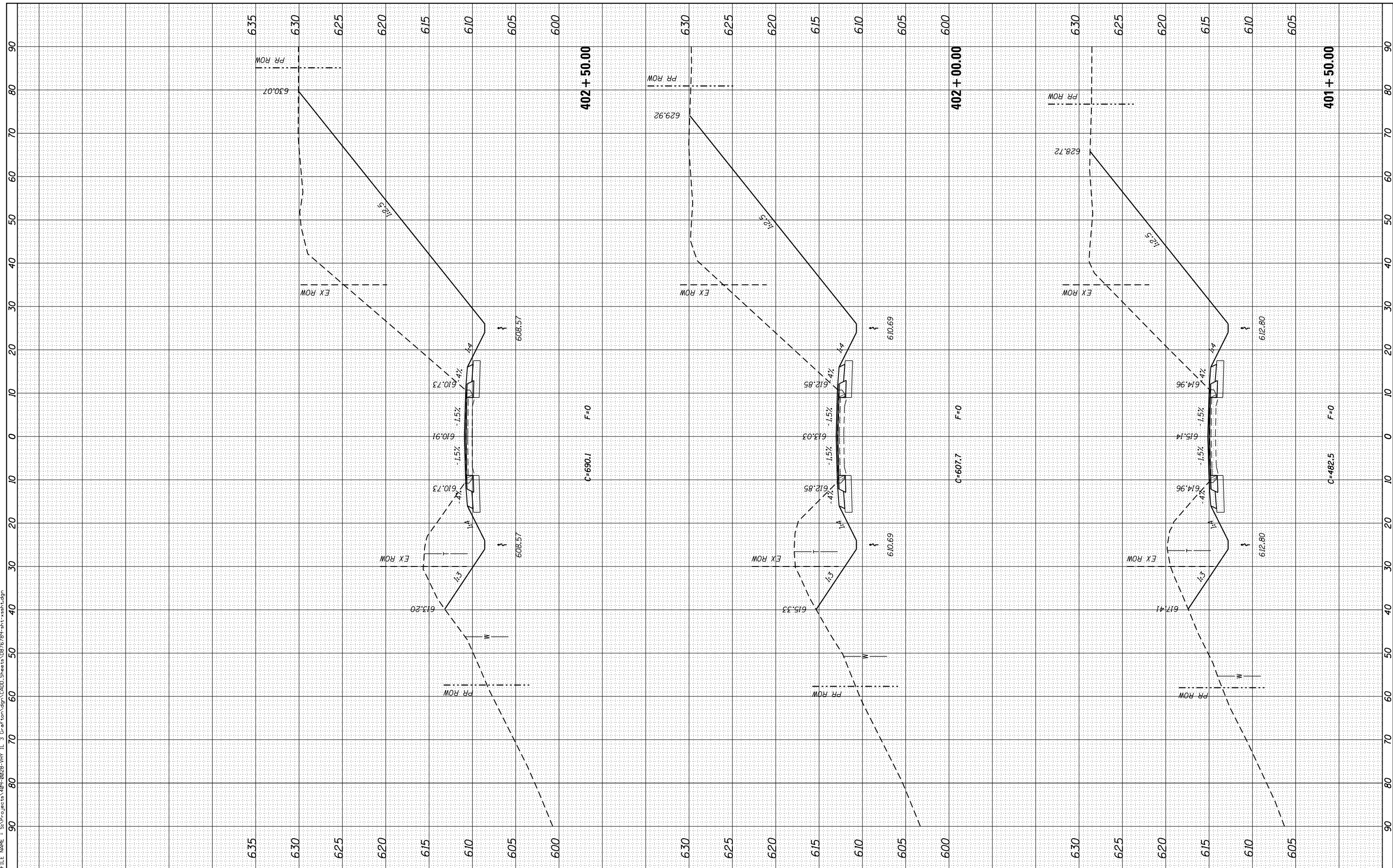

USER NAME = ljackson	DESIGNED - ACM	REVISED -
MODEL NAME = Default	DRAWN - EDW	REVISED -
PLOT SCALE = 20.0000' / in.	CHECKED - LWJ	REVISED -
PLOT DATE = 8/11/2014	DATE - 8-11-14	REVISED -

**STATE OF ILLINOIS  
DEPARTMENT OF TRANSPORTATION**

<b>CROSS SECTIONS FAS ROUTE 752 (IL ROUTE 3)</b>	
SCALE:	SHEET 127 OF 138 SHEETS STA. 401+50.00 TO STA. 402+50.00

F.A. RTE.	SECTION	COUNTY	TOTAL SHEETS	SHEET NO.
• 749/752	101 2RS-1	JERSEY	438	421
			CONTRACT NO. 76789	
ILLINOIS FED. AID PROJECT				