

CONTROL POINT TIE SHEET

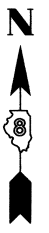
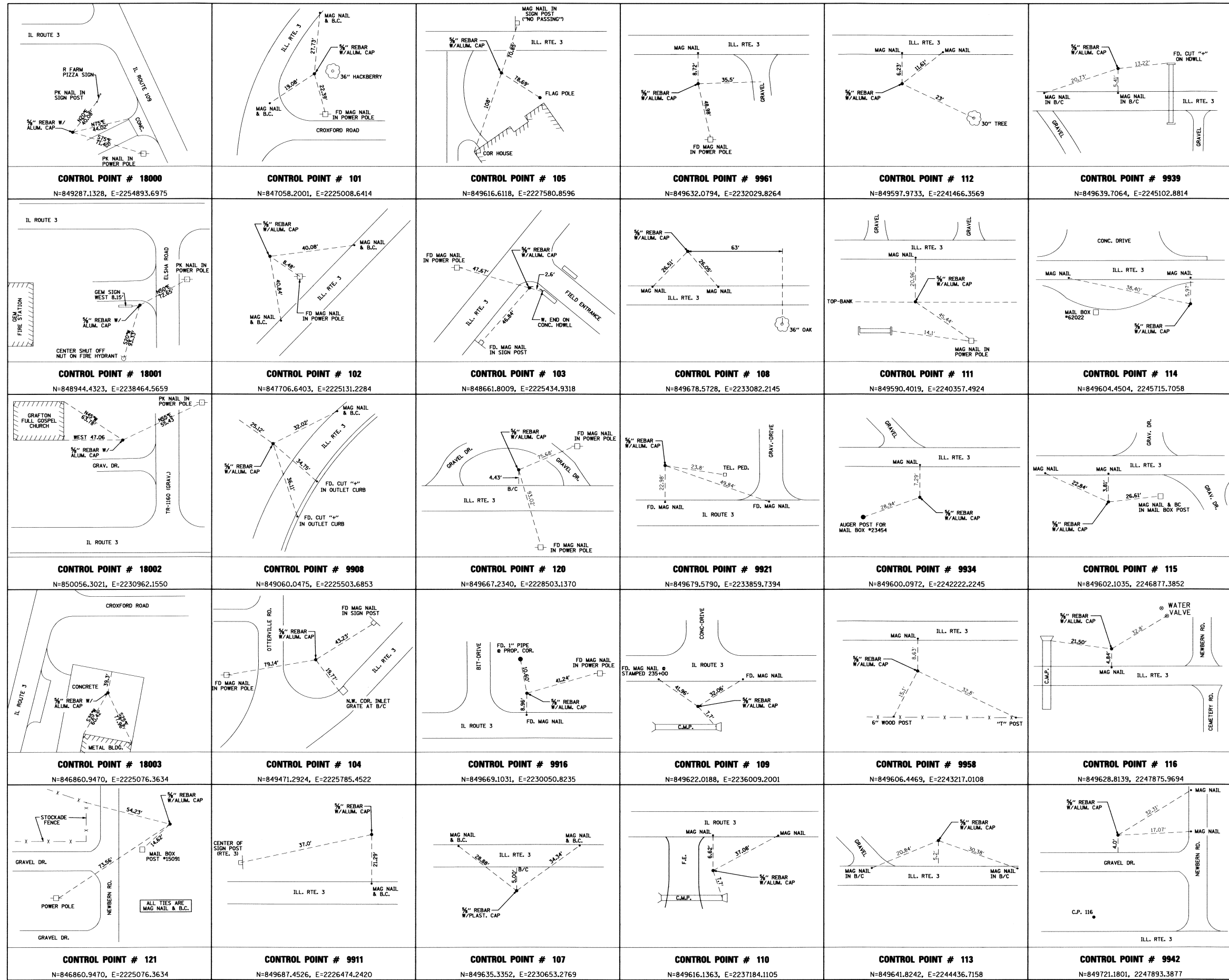

SPACE RESERVED FOR RECORDING OFFICER

JERSEY COUNTY, ILLINOIS

STATE OF ILLINOIS)
 COUNTY OF) SS

I, [FILL IN NAME AS PRINTED ON LICENSE], AN ILLINOIS PROFESSIONAL LAND SURVEYOR, STATE THAT I HAVE SURVEYED THE PLAT OF HIGHWAY SHOWN HEREON AND THAT THIS PROFESSIONAL SERVICE CONFORMS TO THE CURRENT ILLINOIS MINIMUM STANDARDS FOR A BOUNDARY SURVEY FOR THE PROPOSED PARCEL(S) TO BE ACQUIRED BY THE STATE OF ILLINOIS, DEPARTMENT OF TRANSPORTATION, SHOWN HEREON.

DATED 7-30-2010
Richard L. Leach
 RICHARD L. LEACH, PLS NO. 35-003234
 LICENSE EXPIRATION DATE: 11/30/2010



POEPPING, STONE, BACH AND ASSOCIATES
 100 SOUTH 54TH ST. P.O. BOX 709
 QUINCY, IL 62306 PHONE NO. 217-223-4605
 IL DESIGN FIRM NO. 184-000493

COMPLETION DATE OF FIELD WORK PERFORMED
 LAND SURVEY: DEC. 2008 ROW STAKING: APRIL 2010

ILLINOIS DEPARTMENT OF TRANSPORTATION
 PLAT OF HIGHWAYS
 FAS ROUTE 752 (IL 3)
 SECTION 101-2RS-1
 JERSEY COUNTY
 JOB NO. R-98-021-00

SHEET 68 OF 69

ILLINOIS DEPARTMENT OF TRANSPORTATION
 DIVISION OF HIGHWAYS/REGION 5/DISTRICT 8
 1102 EASTPORT PLAZA DRIVE
 COLLINGSVILLE, ILLINOIS 62234-6198

F.A.S. RTE.	SECTION	COUNTY	TOTAL SHEETS	SHEET NO.
752	101-2RS-1	JERSEY	438	186
CONTRACT NO.			76789	
FED. ROAD DIST. NO.		ILLINOIS FED. AID PROJECT		