

**LEGEND**

	WORK AREA	①	TYPE III BARRICADE TO BE PLACED WHEN NO WORK IS BEING PERFORMED
	TEMPORARY CONSTRUCTION SIGN		TEMPORARY CONCRETE BARRIER
	TYPE III BARRICADE		DRUM WITH STEADY BURNING BI-DIRECTIONAL LIGHT AND 4" TEMPORARY PAVEMENT MARKING
	TRAFFIC SIGNAL		
	IMPACT ATTENUATOR		

NOTE: DOUBLE VERTICAL PANELS AND CRYSTAL BIDIRECTIONAL BARRIER MARKERS SHALL BE INSTALLED AS SHOWN ON STANDARD 701321

**NOTES:**  
 CONSTRUCT PRIOR TO STAGE 1,  
 HMA BASE COURSE, 9" 191.7 SQ YDS  
 HMA BASE COURSE, 8" 363.8 SQ YDS  
 CONSTRUCT DURING STAGE 1,  
 HMA BASE COURSE, 9" 176.7 SQ YDS  
 HMA BASE COURSE, 8" 328.0 SQ YDS  
 TEMPORARY CONCRETE BARRIER 500.0 FOOT

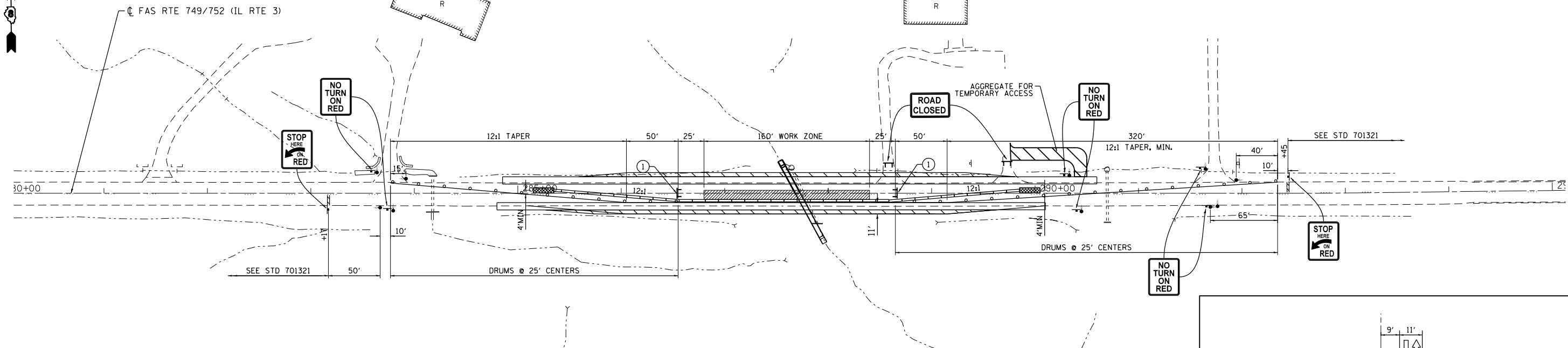
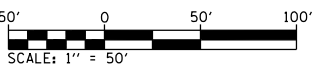
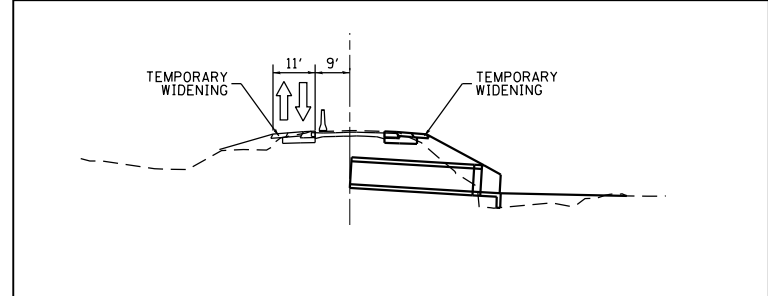

**NOTES:**  
 RELOCATE TEMPORARY CONCRETE BARRIER 450.0 FOOT  
 AGGREGATE FOR TEMPORARY ACCESS 42.0 TONS  
 PAVEMENT REMOVAL 311.8 SQ YD

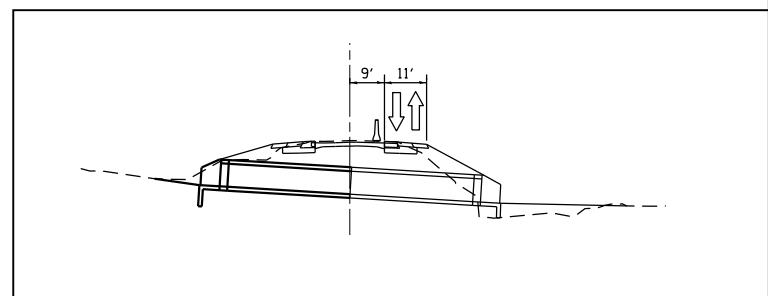

FILE NAME = S:\Projects\085-002B-VHY\_IL\_3\_Cret\ton\adm\CADD\_Sheets\08576789-st-1-staging.dgn



USER NAME = l_jackson	DESIGNED - ACM	REVISED -
MODEL NAME = CULVERT 13	DRAWN - EDW	REVISED -
PLOT SCALE = 99.9998' / in.	CHECKED - LWJ	REVISED -
PLOT DATE = 8/22/2014	DATE - 8-11-14	REVISED -

**STATE OF ILLINOIS  
 DEPARTMENT OF TRANSPORTATION**

<b>STAGING AND TRAFFIC CONTROL PLAN</b>		
<b>CULVERT # 13 - STA 287+70.68</b>		
SCALE: 1"=50'	SHEET 8 OF 17 SHEETS	STA. 280+00 TO STA. 295+00

F.A.S. RTE.	SECTION	COUNTY	TOTAL SHEETS	SHEET NO.
• 749/752	101-2RS-1	JERSEY	438	98
			CONTRACT NO. 76789	
ILLINOIS FED. AID PROJECT				