

**NOTES:**  
 CONSTRUCT PRIOR TO STAGE 1,  
 HMA BASE COURSE, 9" 176.7 SQ YDS  
 HMA BASE COURSE, 8" 390.6 SQ YDS  
 CONSTRUCT DURING STAGE 1,  
 HMA BASE COURSE, 9" 155.0 SQ YDS  
 HMA BASE COURSE, 8" 370.7 SQ YDS  
 TEMPORARY CONCRETE BARRIER 462.5 FOOT  
 AGGREGATE FOR TEMPORARY ACCESS 172.1 TONS

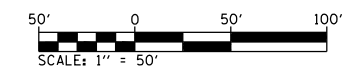
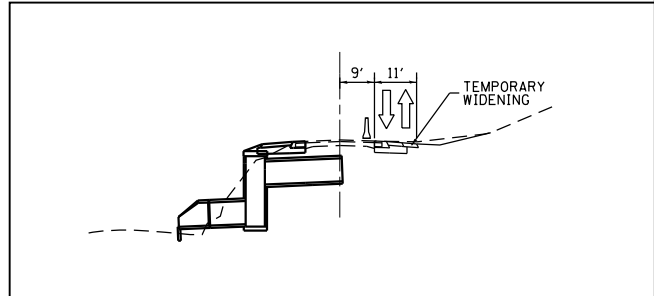

**LEGEND**

	WORK AREA	①	TYPE III BARRICADE TO BE PLACED WHEN NO WORK IS BEING PERFORMED
	TEMPORARY CONSTRUCTION		TEMPORARY CONCRETE BARRIER
	SIGN		DRUM WITH STEADY BURNING BI-DIRECTIONAL LIGHT AND 4\"/>
	TYPE III BARRICADE		
	TRAFFIC SIGNAL		
	IMPACT ATTENUATOR		

NOTE: DOUBLE VERTICAL PANELS AND CRYSTAL BIDIRECTIONAL BARRIER MARKERS SHALL BE INSTALLED AS SHOWN ON STANDARD 701321

**STAGE 1**

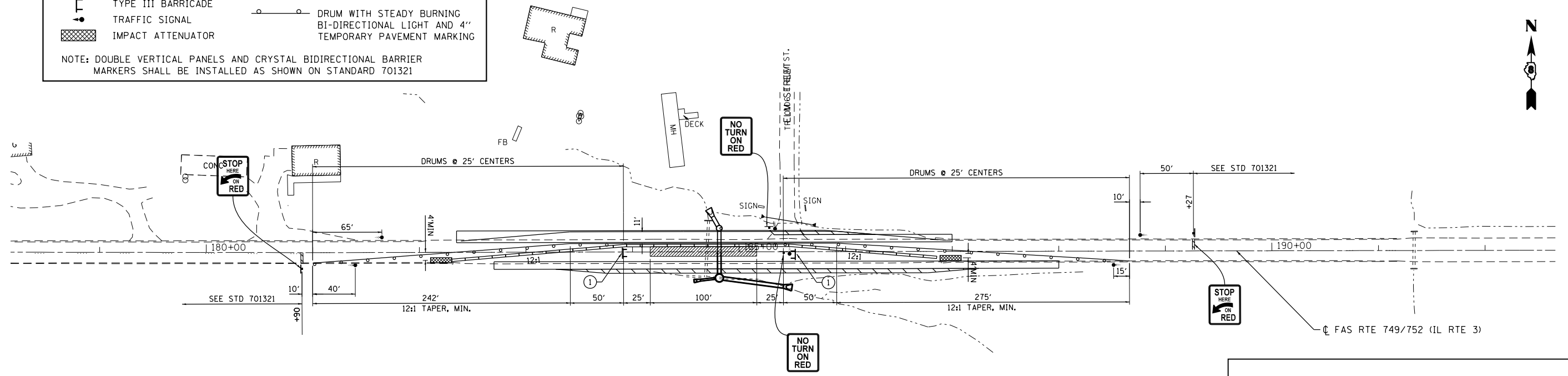

**NOTES:**  
 RELOCATE TEMPORARY CONCRETE BARRIER 462.5 FOOT  
 PAVEMENT REMOVAL 187.5 SQ YD

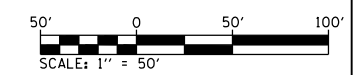
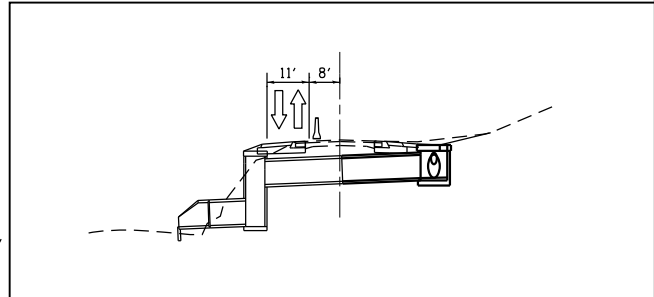

**STAGE 2**

FILE NAME = S:\Projects\08-0228-VHJ\_IL\_3\_Cret\cm\lgm\CADD\_Sheets\08161818-st-1-staging.dgn



USER NAME = l.jackson	DESIGNED - ACM	REVISED -
MODEL NAME = CULVERT 06	DRAWN - EDW	REVISED -
PLOT SCALE = 99.9998' / in.	CHECKED - LWJ	REVISED -
PLOT DATE = 8/22/2014	DATE - 8-11-14	REVISED -

**STATE OF ILLINOIS  
 DEPARTMENT OF TRANSPORTATION**

**STAGING AND TRAFFIC CONTROL PLAN  
 CULVERT # 6 - STA 184+81.48**

SCALE: 1"=50' SHEET 4 OF 17 SHEETS STA. 178+00 TO STA. 192+00

F.A.S. RTE.	SECTION	COUNTY	TOTAL SHEETS	SHEET NO.
• 749/752	101-2RS-1	JERSEY	438	94
			CONTRACT NO. 76789	
ILLINOIS FED. AID PROJECT				