

STATE OF ILLINOIS
DEPARTMENT OF TRANSPORTATION

PROJECT NO.	SECTION	SHEET NO.	TOTAL SHEETS
F.A. 116	74BR	19	8
SHEET NO. 3 14 SHEETS			

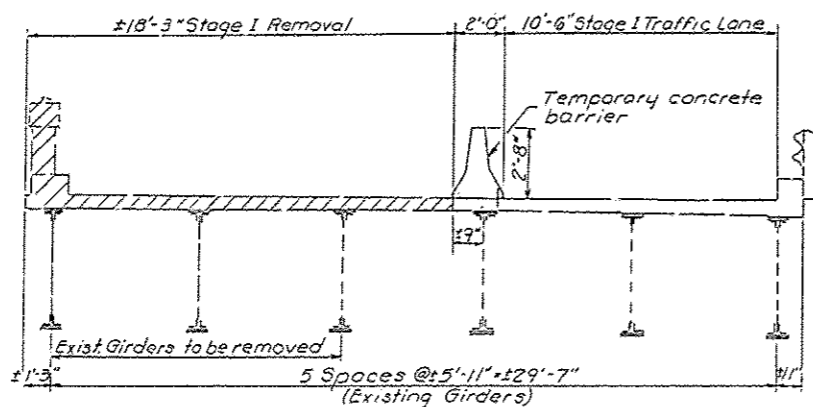

STAGE I REMOVAL

Notes:
Hatched area to be removed.
All cross sections are looking North.
For temporary concrete barrier details see sheet #4.
Removal of existing rails is incidental to Removal of Exist. Super.

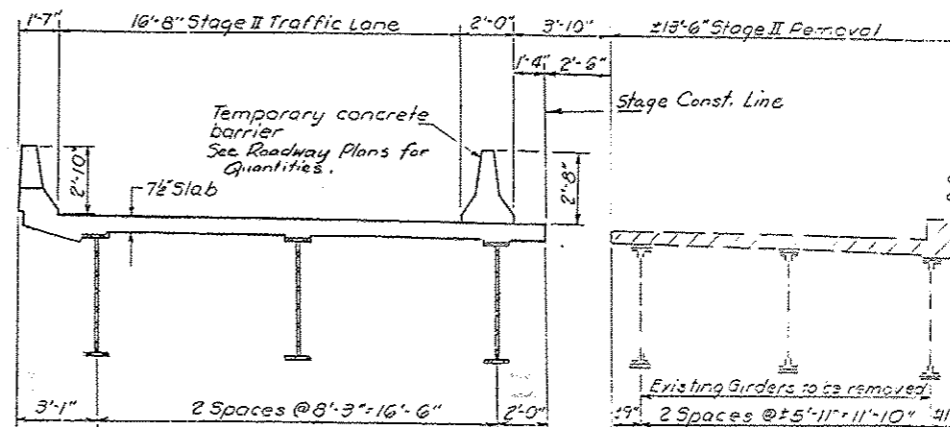

STAGE II REMOVAL

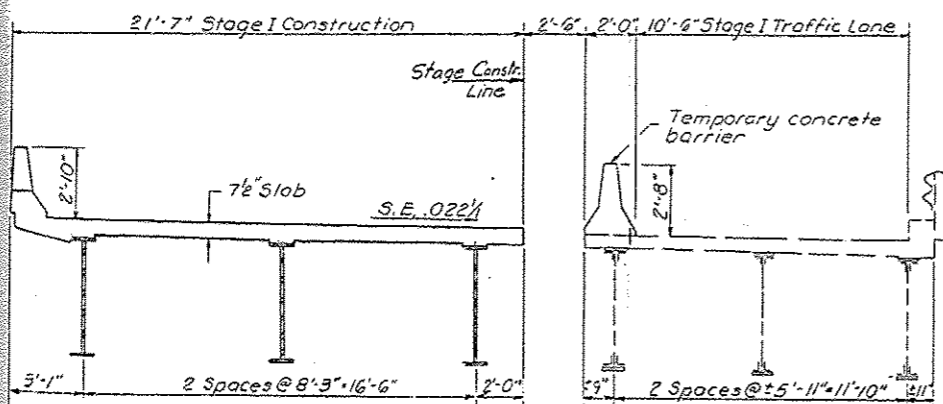

STAGE I CONSTRUCTION

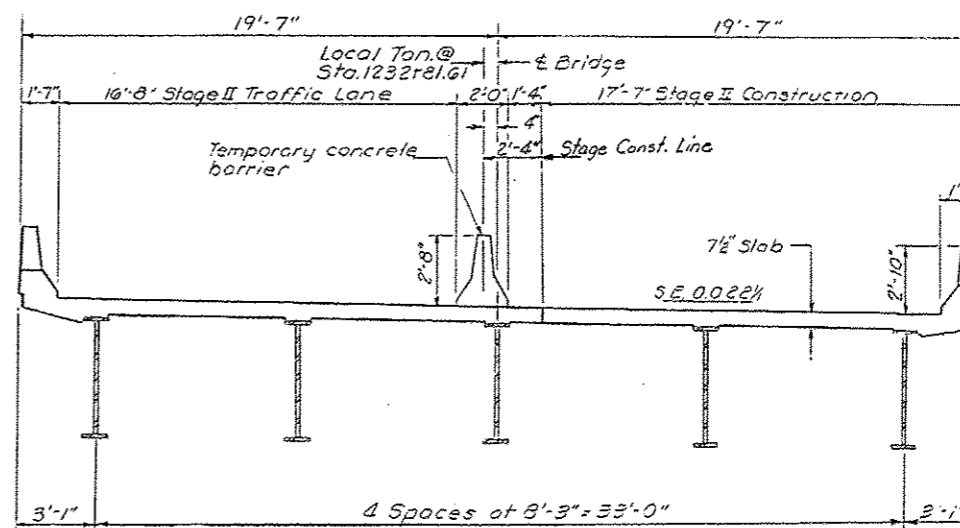

STAGE II CONSTRUCTION

DESIGNED <i>John J. H. [Signature]</i>	EXAMINED <i>James J. [Signature]</i>
CHECKED <i>John [Signature]</i>	PASSED <i>Carl [Signature]</i>
DRAWN <i>F.M.</i>	APPROVED <i>[Signature]</i>
CHECKED <i>[Signature]</i>	DIRECTOR OF HIGHWAYS

May 7 1984

STAGE CONSTRUCTION SEQUENCE
F.A. RTE. 116 SEC. 7V BR.
EDWARDS COUNTY
STA. 1232+78.28

FILE NAME:	USER NAME: staffanek	DESIGNED: -	REVISED: -	STATE OF ILLINOIS DEPARTMENT OF TRANSPORTATION	PLAN STRUCTURE 024-0005	F.A.P. RTE.	SECTION	COUNTY	TOTAL SHEETS	SHEET NO.	
Default	74699-ah-1-plan.dgn	DRAWN: -	REVISED: -			116	D7 BRIDGE PAINTING 2015-3	EDWARDS	19	15	
	PLOT SCALE: 1/8" = 1'-0"	CHECKED: -	REVISED: -			CONTRACT NO. 74699					
	PLOT DATE: 8/5/2014	DATE: -	REVISED: -			ILLINOIS FED. AID PROJECT					
						SCALE: N/A	SHEET 11 OF 13 SHEETS	STA.	TO STA.		