

NOTES

1. CONTRACTOR TO INSTALL PULL ROPE IN 2" EMPTY CONDUIT FOR FUTURE USE.
2. THE COST OF THE JUNCTION BOX SHALL BE INCLUDED IN THE COST OF EMBEDDED CONDUIT.

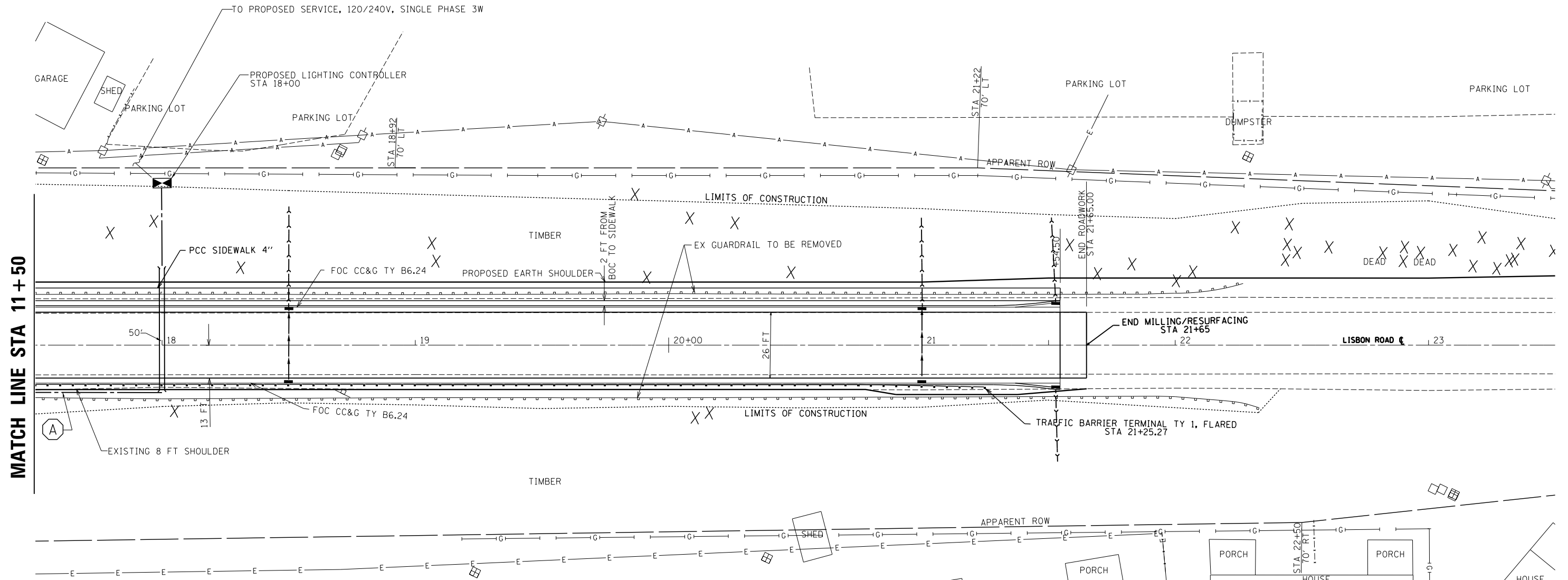

MATCH LINE STA 11+50

LEGEND

- PROPOSED JUNCTION BOX, STAINLESS STEEL, ATTACHED TO STRUCTURE, 12"x10"x6" TYP., OR AS NOTED
 - PROPOSED LIGHTING CONTROLLER, POLE MOUNTED, 240 VOLT, 30 AMP
 - PROPOSED UNIT DUCT, 600V, 2-1C, NO.8, 1/C NO. 8 GROUND (XLP-TYPE USE), 3/4" DIA. POLYETHYLENE
 - CONDUIT EMBEDDED IN STRUCTURE, 2" DIA. PVC.
 - PROPOSED COILABLE, NON-METALLIC CONDUIT, 3" DIA., SECHEDULE 80
- CABLE/CONDUIT SCHEDULE**
- UNIT DUCT, 600V, 2-1C, NO.8, 1/C NO. 8 GROUND (XLP-TYPE USE), 3/4" DIA. POLYETHYLENE
 - ELECTRIC CABLE IN CONDUIT, (XLP-TYPE USE) 2-1C, NO.8, 1/C NO. 8 GROUND IN 2" DIA. PVC CONDUIT EMBEDDED IN STRUCTURE

FILE NAME =	USER NAME = jauche	DESIGNED -	REVISED -
ci:\pw\work\p1\dot\jauche\0249654\0366827-sh1-plnpr.f.dgn		DRAWN -	REVISED -
Default	PLOT SCALE = 40.0000' / in.	CHECKED -	REVISED -
	PLOT DATE = 8/13/2014	DATE -	REVISED -

**STATE OF ILLINOIS
DEPARTMENT OF TRANSPORTATION**

PROPOSED LIGHTING PLAN

SCALE: SHEET NO. 27 OF 98 SHEETS STA. TO STA.

F.A.I. RTE.	SECTION	COUNTY	TOTAL SHEETS	SHEET NO.
80	(32-2) HBR-6	GRUNDY	98	27
CONTRACT NO. 66B27				
ILLINOIS FED. AID PROJECT				