

**NOTES**

1. CONTRACTOR TO INSTALL PULL ROPE IN 2" EMPTY CONDUIT FOR FUTURE USE.
2. THE COST OF THE JUNCTION BOX SHALL BE INCLUDED IN THE COST OF EMBEDDED CONDUIT.

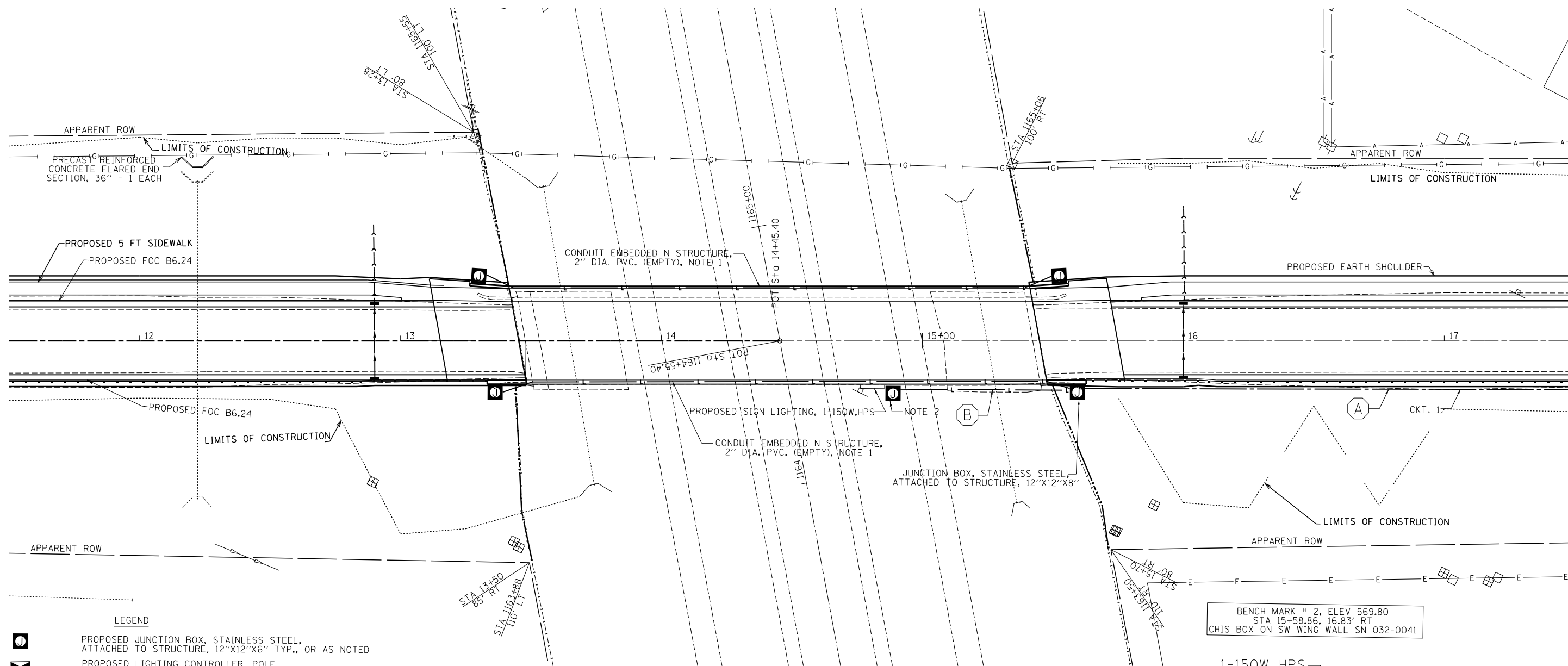

**LEGEND**

- PROPOSED JUNCTION BOX, STAINLESS STEEL, ATTACHED TO STRUCTURE, 12"X12"X6" TYP., OR AS NOTED
- PROPOSED LIGHTING CONTROLLER, POLE MOUNTED, 240 VOLT, 30 AMP
- PROPOSED UNIT DUCT, 600V, 2-1C, NO.8, 1/C NO. 8 GROUND (XLP-TYPE USE), 3/4" DIA. POLYETHYLENE
- CONDUIT EMBEDDED IN STRUCTURE, 2" DIA. PVC.
- PROPOSED COILABLE, NON-METALLIC CONDUIT, 3" DIA., SCHEDULE 80

**CABLE/CONDUIT SCHEDULE**

- (A) UNIT DUCT, 600V, 2-1C, NO.8, 1/C NO. 8 GROUND (XLP-TYPE USE), 3/4" DIA. POLYETHYLENE
- (B) ELECTRIC CABLE IN CONDUIT, (XLP-TYPE USE) 2-1C, NO.8, 1/C NO. 8 GROUND IN 2" DIA. PVC CONDUIT EMBEDDED IN STRUCTURE

BENCH MARK # 2, ELEV 569.80  
 STA 15+58.86, 16.83' RT  
 CHIS BOX ON SW WING WALL SN 032-0041

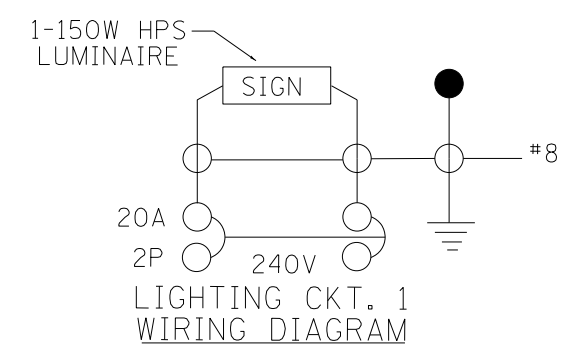

MATCH LINE STA 11+50

FILE NAME =	USER NAME = jauche	DESIGNED -	REVISED -	<b>STATE OF ILLINOIS DEPARTMENT OF TRANSPORTATION</b>	<b>PROPOSED LIGHTING PLAN</b>			F.A.I. RTE.	SECTION	COUNTY	TOTAL SHEETS	SHEET NO.	
Default	ct:\pw\work\p\dot\jauche\0249654\0366827-sh1-plnprf.dgn	DRAWN -	REVISED -		SCALE:	SHEET NO. 26 OF 98 SHEETS	STA.	TO STA.	80	(32-2) HBR-6	GRUNDY	98	26
	PLOT SCALE = 40.0000' / in.	CHECKED -	REVISED -		CONTRACT NO. 66B27								
	PLOT DATE = 8/13/2014	DATE -	REVISED -		ILLINOIS FED. AID PROJECT								