

DATE	
BY	
PLAN	
SURVEYED	
PLOTTED	
NOTE BOOK	
GRADES CHECKED	
STRUCTURE	
NOTATIONS	
NO.	

DATE	
BY	
PROFILE	
SURVEYED	
PLOTTED	
NOTE BOOK	
GRADES CHECKED	
STRUCTURE	
NOTATIONS	
NO.	

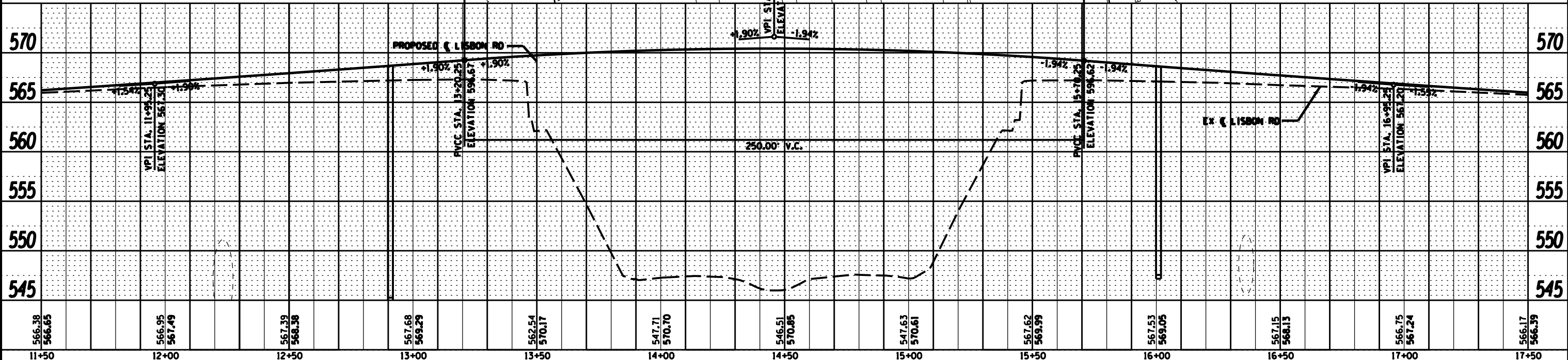
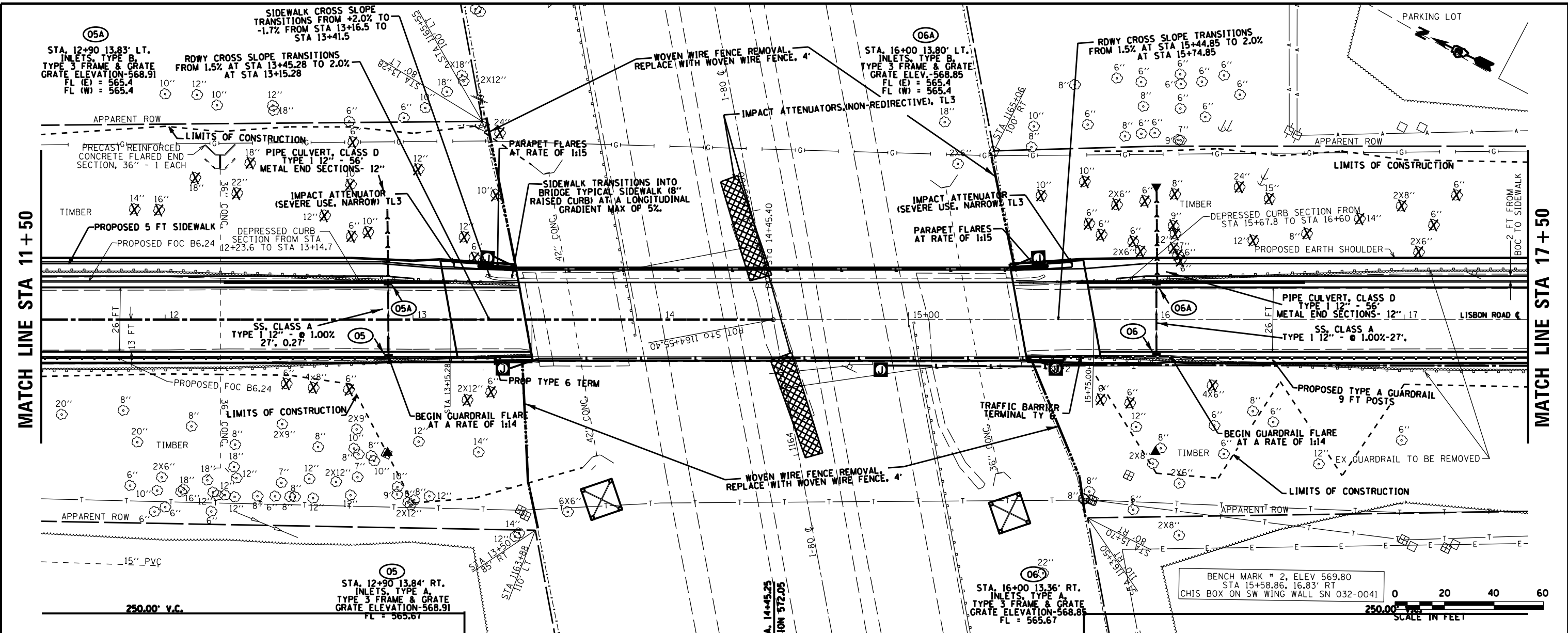

566.38	566.65	566.95	567.49	567.99	568.38	567.68	569.29	562.54	570.17	547.71	570.70	546.51	570.85	547.63	570.61	567.62	569.99	567.53	569.05	567.15	568.13	566.75	567.24	566.17	566.99	
11+50	12+00	12+50	13+00	13+50	14+00	14+50	15+00	15+50	16+00	16+50	17+00	17+50														

FILE NAME =  
 \*FILEL\*

USER NAME = \*USER\*  
 DESIGNED -  
 DRAWN -  
 CHECKED -  
 DATE -

REVISD -  
 REVISD -  
 REVISD -  
 REVISD -

STATE OF ILLINOIS  
 DEPARTMENT OF TRANSPORTATION

LISBON RD OVER I-80  
 PLAN AND PROFILE  
 SCALE: SHEET NO. 22 OF 98 SHEETS STA. TO STA.  
 F.A.I. RTE. SECTION COUNTY TOTAL SHEETS NO. 80 (32-2) HBR-6 GRUNDY 98 22 CONTRACT NO. 66827 ILLINOIS FED. AID PROJECT