

Notes:
 See sheet 16 of 26 for Sections C-C & D-D and View E-E.
 $a_5(E)$ and $a_6(E)$ bar spacings measured along \varnothing Rdwy.
 See sheet 16 of 26 for additional details.

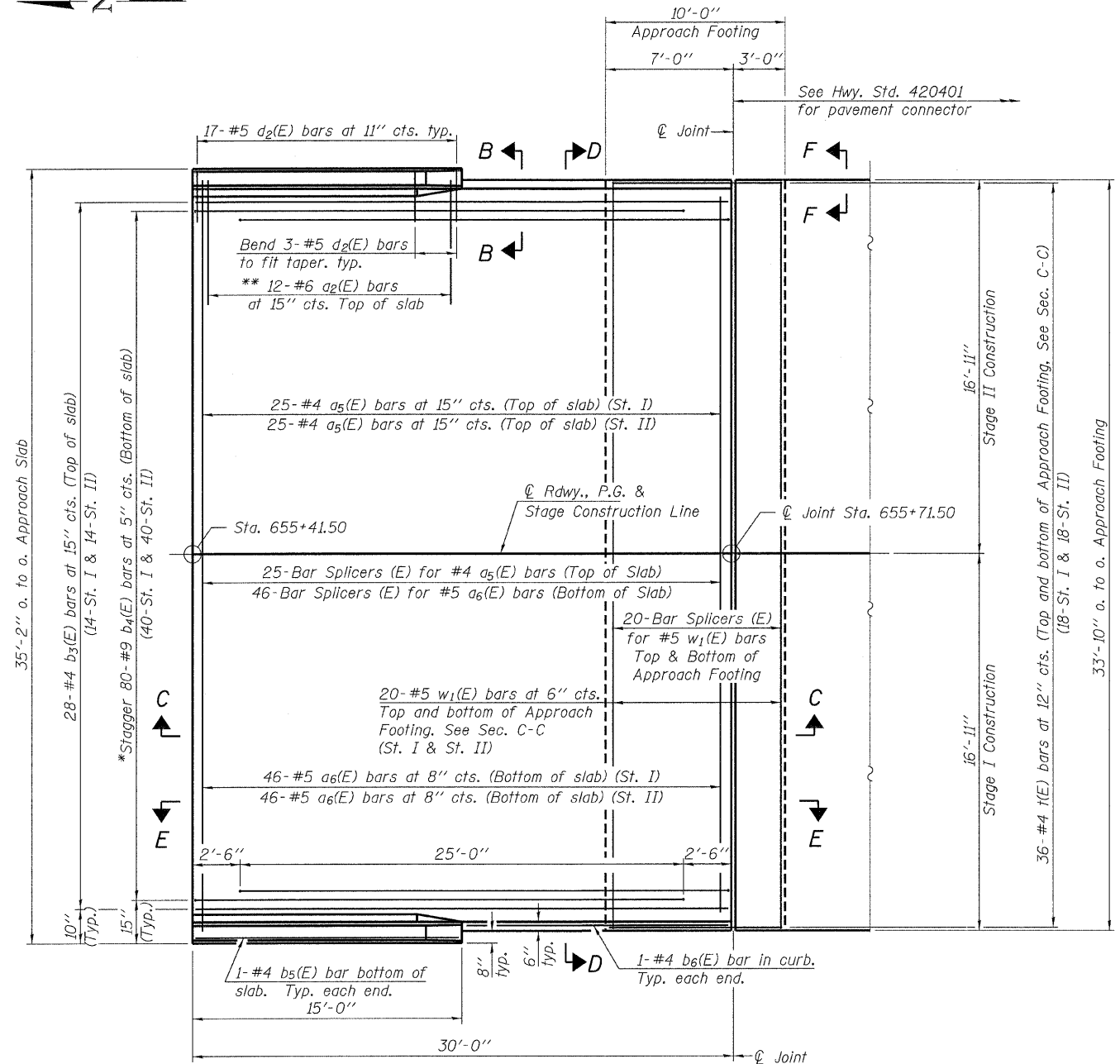

PLAN

* Tilt #9 $b_4(E)$ bars as required to maintain clearance.
 ** Space between $a_5(E)$ bars, typ. ea. parapet.

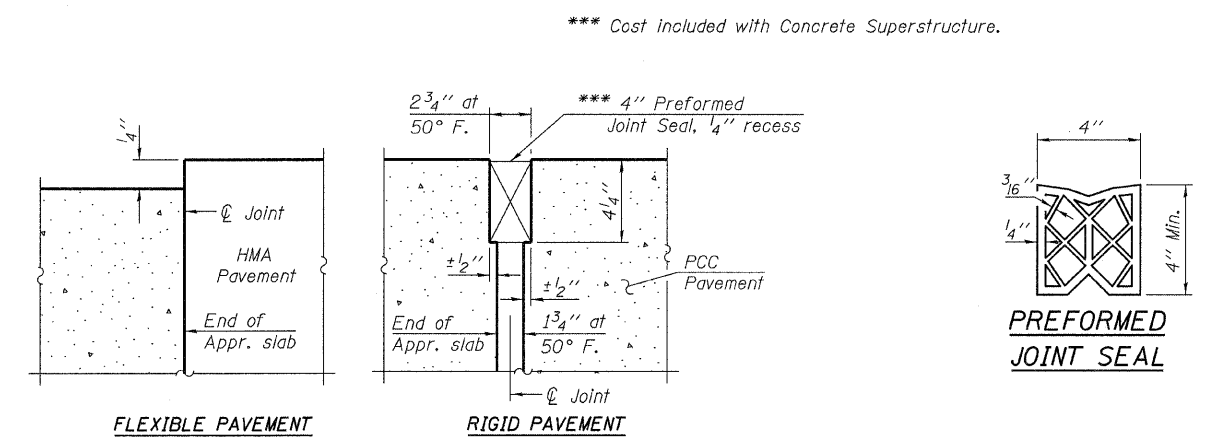

DETAIL A

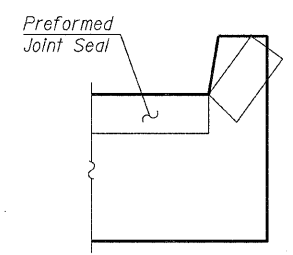

VIEW F-F

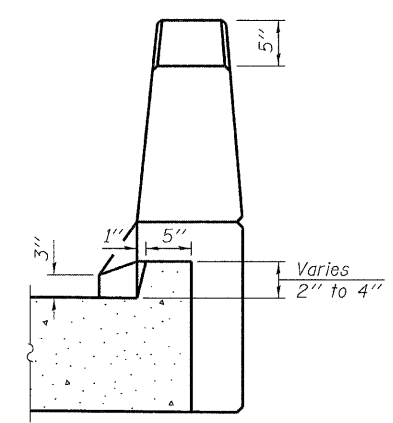

VIEW B-B

FILE NAME = 090148-sht-bridge.dgn	USER NAME =	DESIGNED - A.S.L.	REVISED -	STATE OF ILLINOIS DEPARTMENT OF TRANSPORTATION	BRIDGE APPROACH SLAB DETAILS - SOUTH STRUCTURE NO. 097-0076	F.A.P.	SECTION	COUNTY	TOTAL SHEETS	SHEET NO.	
HAMPTON, LENZINI AND RENWICK, INC. 3045 STEVENSON DRIVE, SUITE 201 SPRINGFIELD, ILLINOIS 62703	PLOT SCALE =	CHECKED - C.C.S.	REVISED -			328	105B-1	WHITE	54	36	
ILR ILLINOIS PROFESSIONAL DESIGN FIRM 15 / PE / SE CORP. 184-003969	PLOT DATE = 7/13/2011	DRAWN - D.A.B.	REVISED -			CONTRACT NO. 78161					
		CHECKED - M.D.C.	REVISED -			SHEET NO. 15 OF 26 SHEETS					
						ILLINOIS FED. AID PROJECT					