

PRIOR TO STAGE 1 CONSTRUCTION

1. PLACE PERIMETER EROSION BARRIER ON DISTURBED SLOPES AS SHOWN ON EROSION CONTROL PLANS.

STAGE 1

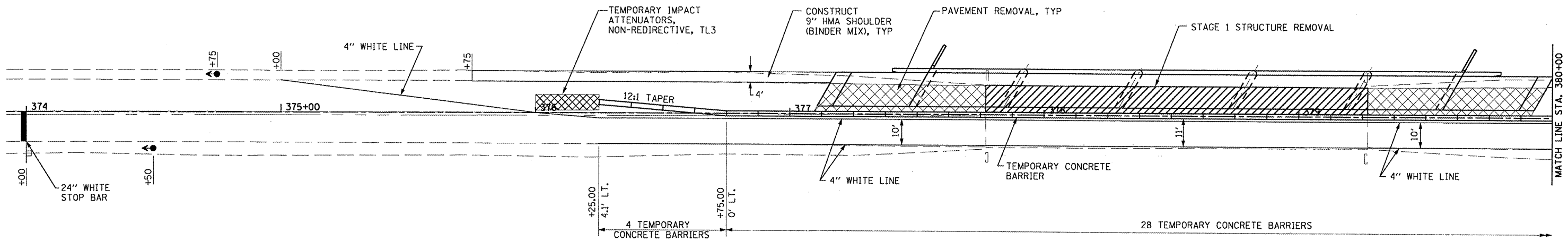

STAGE 1 CONSTRUCTION OF WEST SIDE

1. INSTALL BARRICADES SIGNS, TRAFFIC SIGNALS AND TEMPORARY MARKINGS AS DETAILED ON TRAFFIC CONTROL AND PROTECTION STANDARD 701321.
2. PLACE TEMPORARY CONCRETE BARRIERS. ANCHORS WILL BE REQUIRED.
3. EXISTING GUARD RAIL ON EAST SIDE TO REMAIN IN PLACE DURING STAGE 1 CONSTRUCTION.
4. INSTALL TEMPORARY SOIL RETENTION SYSTEM AS SHOWN ON SHEET 16 S.N. 036-0071 STRUCTURAL PLANS.
5. REMOVE GUARDRAIL, APPROACH PAVEMENT AND WEST SIDE OF EXISTING STRUCTURE. CONSTRUCT PROPOSED STRUCTURE, APPROACH PAVEMENT, APPROACH PAVEMENT CONNECTORS, HMA SHOULDER SECTION, GUARDRAIL AND ALL OTHER COLLATERAL WORK FOR WEST SIDE OF THE ROADWAY AS SHOWN.
6. UPON COMPLETION OF STAGE I, THE LEFT AND RIGHT LANES SHOULD BE PAVED FROM EXISTING ELEVATION AT STATION 374+00 TO THE TOP OF PROPOSED BINDER COURSE ELEVATION AT STATION 375+50 AND LIKewise FROM STATION 383+00 TO 381+50. FROM STATION 375+50 AND STATION 381+50 TO THE PROPOSED BRIDGE, THE LEFT LANE SHOULD BE PAVED TO THE TOP OF BINDER COURSE ELEVATION WITH TEMPORARY RAMPS REQUIRED AT THE BRIDGE. THE TEMPORARY RAMPS SHALL BE CONSIDERED AS INCLUDED IN THE COST OF THE HMA BINDER COURSE.

NOTES:

1. PLACE TRAFFIC CONTROL SIGNS AND DEVICES AS SHOWN IN STANDARD 701321.
2. ALL TEMPORARY BRIDGE TRAFFIC SIGNALS FOR STAGE 1 AND STAGE 2 SHALL BE CONSIDERED AS ONE EACH.
3. BARRIER OFFSETS ARE FROM THE CENTER OF THE BARRIER.
4. TEMPORARY PAVEMENT MARKINGS INCLUDED IN COST OF TRAFFIC CONTROL AND PROTECTION 701321.

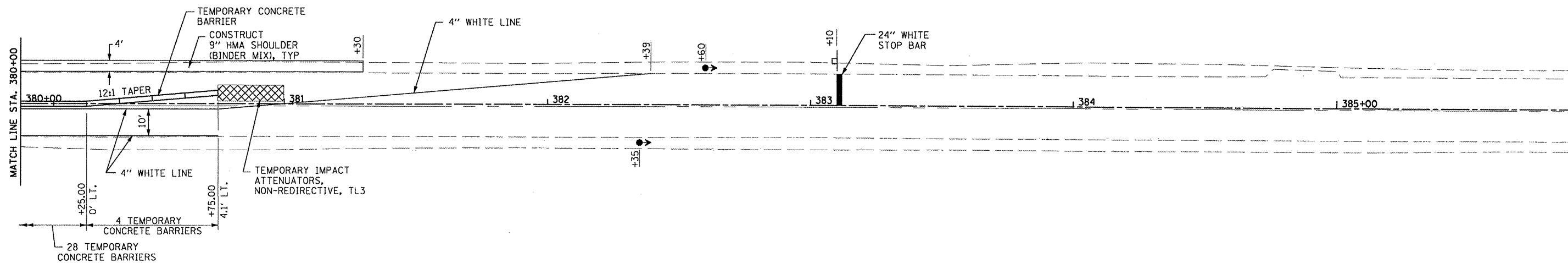
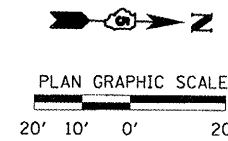

DATE	
BY	
PLAN	
SURVEYED	
NOTE BOOK	
ALIGNED	
CHECKED	
PT. OF WAY CHECKED	
ROAD FILE NAME	
NO.	

DATE	
BY	
PROFILE	
SURVEYED	
GRADES CHECKED	
NOTE BOOK	
STRUCTURE NOTATING OFFICER	
NO.	

HURST-ROSCHKE ENGINEERS, INC.
HILLSBORO, ILLINOIS 62049
(217)532-3959 FAX (217)532-3212



FILE NAME =	USER NAME = HURST-ROSCHKE	DESIGNED - JJC	REVISED -
T:\190-1785_W077_Honey_Creek\06\468298-sh1-staging_1.dgn		DRAWN - UJ	REVISED -
		CHECKED - MAR	REVISED -
		DATE - 2-26-11	REVISED -

STATE OF ILLINOIS
DEPARTMENT OF TRANSPORTATION

STAGE 1 CONSTRUCTION PLAN

SCALE: 1"=20' SHEET NO. 1 OF 2 SHEETS STA. 374+00 TO STA. 380+00

F.A.P. RTE.	SECTION	COUNTY	TOTAL SHEETS	SHEET NO.
522	(14-1-B1)BR	HENDERSON	70	10
CONTRACT NO. 68298				
FED. ROAD DIST. NO. 4 ILLINOIS FED. AID PROJECT				