

**FORM BRACES FOR
STAGE CONSTRUCTION**

When cantilever forming brackets are used, the work shall be done according to Article 503.06(b), except as modified below and in the details shown on this sheet.

The finishing machine rails shall be placed on the top flange of the exterior beams.

The beams or girders, supporting cantilever forming brackets, shall be tied together at 4 foot intervals.

For Standard construction, or Stage Construction the Hardwood bracing materials shall be placed as shown between webs of beams in each bay.

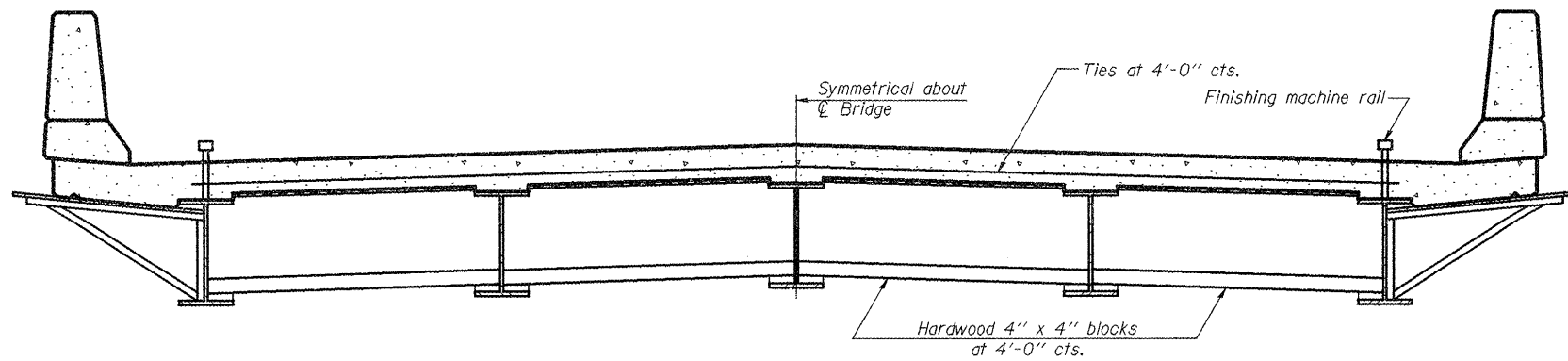

**FORM BRACES FOR
STANDARD CONSTRUCTION**



| | | | |
|-------------------------------------|-------------------------------|------------|-----------|
| FILE NAME = D468883-shtrplan.dgn | USER NAME = johnsonv | DESIGNED - | REVISED - |
| | | DRAWN - | REVISED - |
| | PLOT SCALE = 100.4566' / 1in. | CHECKED - | REVISED - |
| | PLOT DATE = 8/26/2011 | DATE - | REVISED - |

**STATE OF ILLINOIS
DEPARTMENT OF TRANSPORTATION**

**CANTILEVER FORMING BRACKETS
IL 94 OVER DIXON CREEK S.N. 036-0054**

SCALE: SHEET NO. 12 OF 15 SHEETS STA. 347+36

| F.A.P. RTE. | SECTION | COUNTY | TOTAL SHEETS | SHEET NO. |
|---------------------------|------------|-----------|---------------------------|-----------|
| 534 | 109B (BR2) | HENDERSON | 88 | 52 |
| | | | CONTRACT NO. 68083 | |
| ILLINOIS FED. AID PROJECT | | | | |