

Bench Mark: Brass disk on top of northwest wingwall, Sta. 78+23.83, 28.12' Left, Elev. 835.87.

Existing Structure: S.N. 019-0013 was built in 1938 as S.B.I. Route 64, Section 126B-1. The superstructure was replaced and substructure rehabilitated in 1982 as F.A. Route 17, Section 126(B-1)R. The existing structure consists of closed abutments supported on timber piles and a prestressed concrete deck beam superstructure with bituminous wearing surface. 52'-0" out-to-out of deck. 53'-10" back-to-back of abutments. Existing structure to be removed and replaced using stage construction.

No salvage

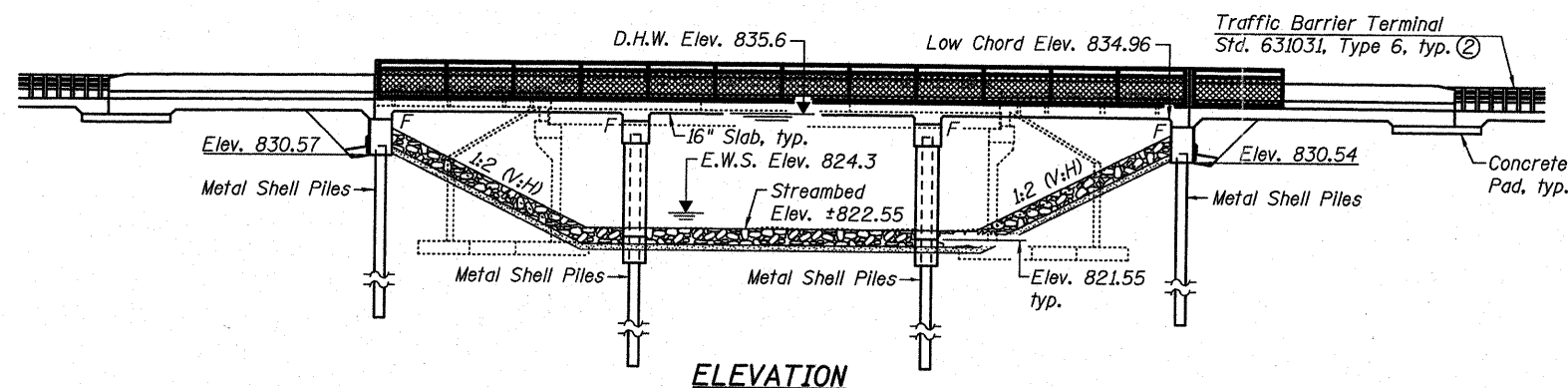

STATION 78+50.74
BUILT 20__ BY
STATE OF ILLINOIS
F.A.P. RT. 307 SEC. 126(B-1)BR
LOADING HL-93
STR. NO. 019-0048

NAME PLATE
See Std. 515001

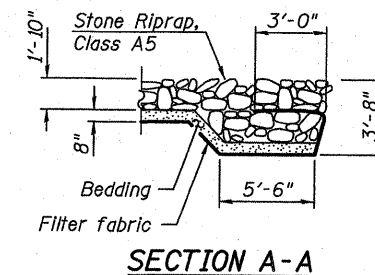
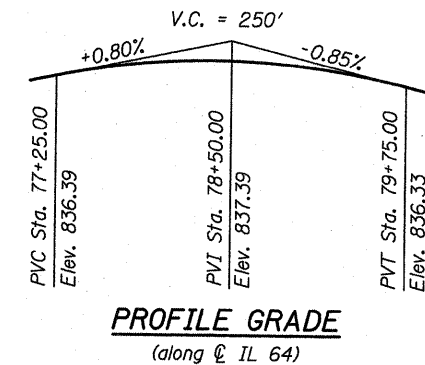

LOADING HL-93
Allow 50#/sq. ft. for future wearing surface.

DESIGN SPECIFICATIONS
2007 AASHTO LRFD Bridge Design Specifications
with 2008 & 2009 Interims

DESIGN STRESSES
FIELD UNITS
f'c = 3,500 psi
fy = 60,000 psi (Reinforcement)

SEISMIC DATA
Seismic Performance Zone (SPZ) = 1
Design Spectral Acceleration at 1.0 sec. (S₁) = 0.084g
Design Spectral Acceleration at 0.2 sec. (S_s) = 0.15g
Soil Site Class = D

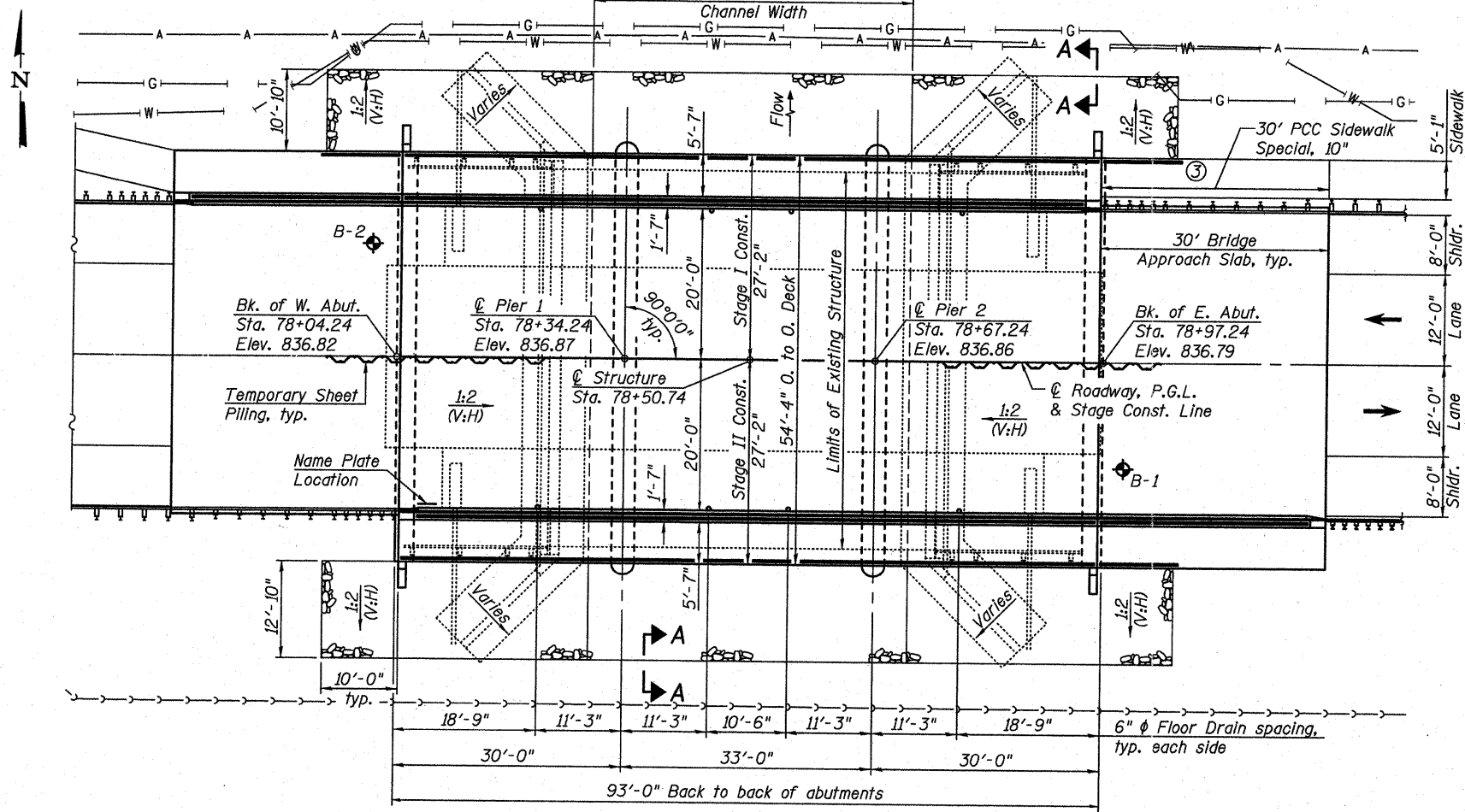

- Notes:
- For Index of Sheets, see sheet 2 of 20.
 - Bridge Fence Railing beyond West Approach Parapet not shown for clarity.
 - See sheet 2 of 20 for Bicycle Railing limits on sidewalk.

APPROVED
FOR STRUCTURAL ADEQUACY ONLY
George Lutz
ENGINEER OF BRIDGES AND STRUCTURES

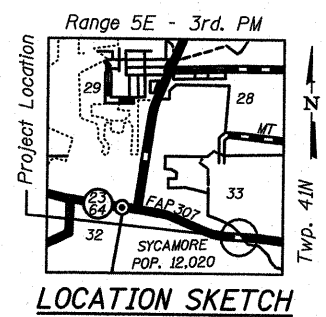

APPROVED
FOR STRUCTURAL ADEQUACY ONLY
George Lutz
ENGINEER OF BRIDGES AND STRUCTURES
8/18/2011
Exp. 11/30/2012

GENERAL PLAN & ELEVATION
IL ROUTE 64 OVER KISHWAUKEE RIVER
F.A.P. ROUTE 307 - SECTION 126(B-1)BR
DEKALB COUNTY
STATION 78+50.74
STRUCTURE NO. 019-0048

WATERWAY INFORMATION

Drainage Area = 108 sq. mi. Exist. Low Grade Elev. = 832 @ Sta. 67+35 to Sta. 70+15
Prop. Low Grade Elev. = 832 @ Sta. 67+35 to Sta. 70+15

Flood Yr.	Freq.	Opening Sq. Ft.		Nat. H.W.E.	Head - Ft.		Headwater El.		
		Exist.	Prop.		Exist.	Prop.	Exist.	Prop.	
Overtop	5	2800	472	668	832.0	0.9	0.7	832.9	832.7
Design	10	3830	486	753	832.9	1.1	0.7	834.0	833.6
Base	50	5570	486	753	835.6	0.2	0.1	835.8	835.7
	100	6266	486	753	836.4	0.1	0.1	836.5	836.5
	500	7832	486	753	837.6	0.0	0.0	837.6	837.6

DESIGN SCOUR ELEVATION TABLE

Design Scour Elevation	W. Abut.	Pier 1	Pier 2	E. Abut.
	830.1	812.55	812.55	830.1



USER NAME =	DESIGNED - JAD	REVISED -
PLOT SCALE =	CHECKED - SJN	REVISED -
PLOT DATE =	DRAWN - JAD	REVISED -
	CHECKED - SJN	REVISED -

STATE OF ILLINOIS
DEPARTMENT OF TRANSPORTATION

F.A.P. RTE.	SECTION	COUNTY	TOTAL SHEETS	SHEET NO.
307	126(B-1)BR	DEKALB	62	19
			CONTRACT NO. 66987	