

F.A.P. RTE.	SECTION	COUNTY	TOTAL SHEETS	SHEET NO.
326	(121)I	LIVINGSTON	27	1
		ILLINOIS	CONTRACT NO. 66869	

STATE OF ILLINOIS
DEPARTMENT OF TRANSPORTATION
DIVISION OF HIGHWAYS
**PROPOSED
HIGHWAY PLANS**

FAP ROUTE 326 (IL 47)
SECTION (121)I
PROJECT: ACF-0326(082)
CULVERT REPLACEMENT
LIVINGSTON COUNTY

C-93-076-11

P-93-030-08
D-93-061-11

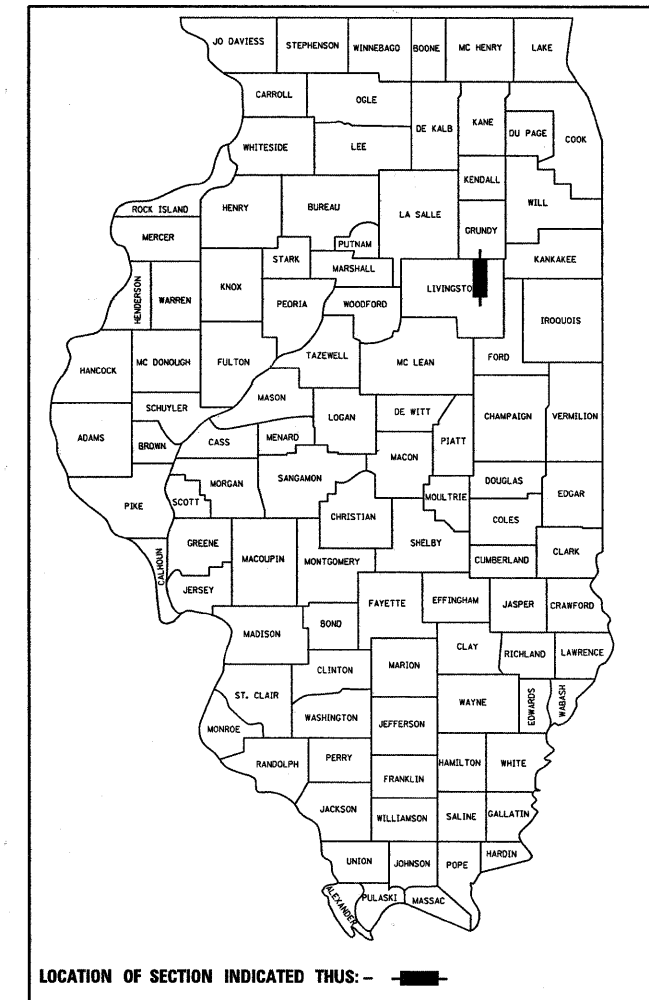

FUNCTIONAL CLASSIFICATION
RURAL OTHER PRINCIPAL ARTERIAL

2007 ADT = 2400
P.V. = 61.4% S.U. = 9.4% M.U. = 29.2%

STATE OF ILLINOIS
DEPARTMENT OF TRANSPORTATION
DIVISION OF HIGHWAYS

SUBMITTED _____ 20 _____

Eric S. Thacker
DEPUTY DIRECTOR OF HIGHWAYS, REGION ENGINEER
October 14 20 11

Scott E. Stitt, P.E.
acting ENGINEER OF DESIGN AND ENVIRONMENT
October 14 20 11

Christine M. Reed
DIRECTOR OF HIGHWAYS, CHIEF ENGINEER

**PRINTED BY THE AUTHORITY
OF THE STATE OF ILLINOIS**

INDEX OF SHEETS

- 1 COVER SHEET
- 2 GENERAL NOTES
- 3-4 SUMMARY OF QUANTITIES
- 5-6 TYPICAL SECTIONS
- 7-8 SCHEDULES
- 9 TIE POINTS
- 10 PLAN AND PROFILE
- 11 STAGE I CONSTRUCTION AND TRAFFIC CONTROL
- 12 STAGE II CONSTRUCTION AND TRAFFIC CONTROL
- 13 EROSION CONTROL AND PAVEMENT MARKING
- 14-20 CULVERT PLANS
- 21 EXISTING CULVERT PLANS
- 22-23 DETAILS
- 24-27 CROSS SECTIONS

STANDARDS

- 000001-06 STANDARD SYMBOLS, ABBREVIATIONS AND PATTERNS
- 001006 DECIMAL OF AN INCH AND OF A FOOT
- 280001-05 TEMPORARY EROSION CONTROL SYSTEMS
- 442201-03 CLASS C AND D PATCHES
- 482011-03 HMA SHOULDER STRIPS/SHOULDERS WITH RS OR WIDENING & RS PROJECTS
- 701001-02 OFF-ROAD OPERATIONS 2L, 2W, MORE THAN 15' (4.5 m) AWAY
- 701006-03 OFF-ROAD OPERATIONS 2L, 2W, 15' (4.5 m) TO 24" (600 mm) FROM PAVEMENT EDGE
- 701011-02 OFF-ROAD MOVING OPERATIONS 2L, 2W, DAY ONLY
- 701201-04 LANE CLOSURE, 2L, 2W, DAY ONLY, FOR SPEEDS ≥ 45 MPH
- 701301-04 LANE CLOSURE, 2L, 2W, SHORT TIME OPERATIONS
- 701306-03 LANE CLOSURE, 2L, 2W, SLOW MOVING OPERATIONS DAY ONLY, FOR SPEEDS ≥ 45 MPH
- 701311-03 LANE CLOSURE, 2L, 2W, MOVING OPERATIONS - DAY ONLY
- 701321-11 LANE CLOSURE, 2L, 2W, BRIDGE REPAIR WITH BARRIER
- 701326-04 LANE CLOSURE, 2L, 2W, PAVEMENT WIDENING, FOR SPEEDS ≥ 45 MPH
- 701901-01 TRAFFIC CONTROL DEVICES
- 704001-06 TEMPORARY CONCRETE BARRIER
- 780001-02 TYPICAL PAVEMENT MARKINGS
- 781001-03 TYPICAL APPLICATIONS RAISED REFLECTIVE PAVEMENT MARKERS

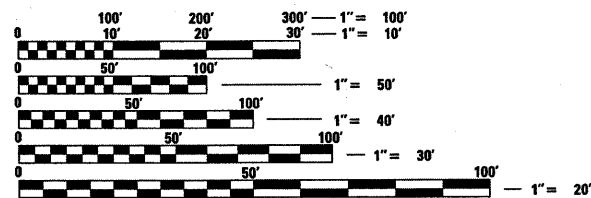

FULL SIZE PLANS HAVE BEEN PREPARED USING STANDARD ENGINEERING SCALES. REDUCED SIZED PLANS WILL NOT CONFORM TO STANDARD SCALES. IN MAKING MEASUREMENTS ON REDUCED PLANS, THE ABOVE SCALES MAY BE USED.

J.U.I.E.
JOINT UTILITY LOCATION INFORMATION FOR EXCAVATION
1-800-892-0123
OR 811

PROJECT ENGINEER: CRAIG S. REED, P.E.
UNIT CHIEF: RUTH SCHWANKE

CONTRACT NO. 66869

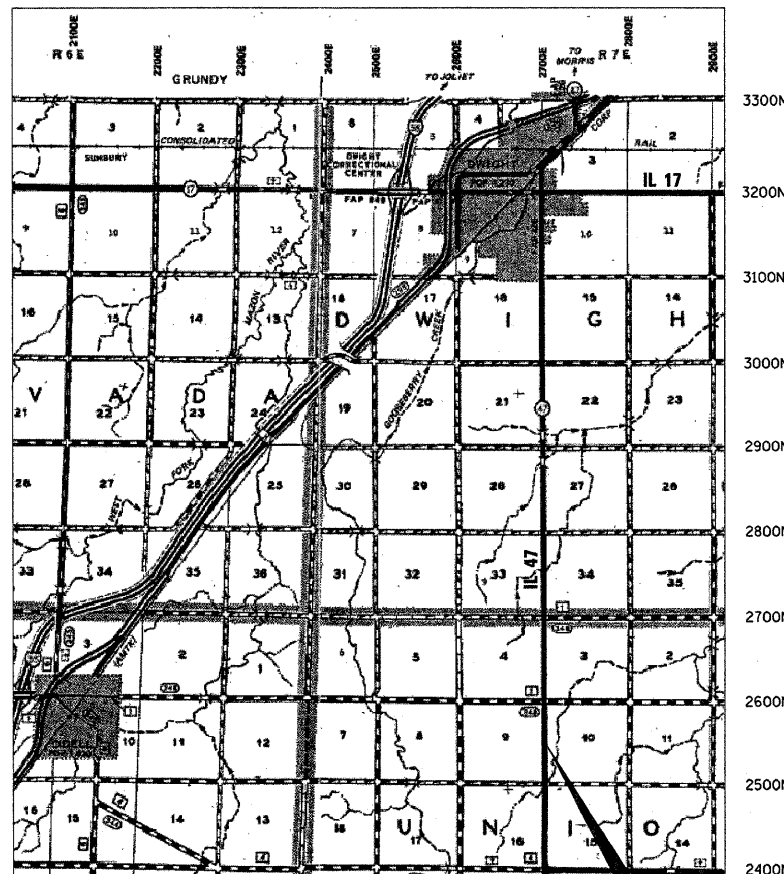

T 30 N

PROJECT LOCATION

STA. 376+04.43
EXISTING SN 053-2541 - 6' X 3' REINFORCED CONCRETE BOX CULVERT
PROPOSED SN 053-2578 - 10' X 3' PRECAST REINFORCED CONCRETE BOX CULVERT AND PRECAST END SECTIONS WITH PIPE GRATES

GROSS LENGTH = 400 FT. = 0.08 MILE
NET LENGTH = 400 FT. = 0.08 MILE