

PLAN	REVISIONS	DATE
NO.	PLOTTED	
NO.	ALIGNED	
NO.	CHECKED	
NO.	CHECKED	
NO.	CHECKED	
NO.	CHECKED	
NO.	CHECKED	
NO.	CHECKED	
NO.	CHECKED	

PROFILE	REVISIONS	DATE
NO.	PLOTTED	
NO.	GRADES CHECKED	
NO.	BLANK NOTED	
NO.	STRUCTURE NOTATIONS CHKD	

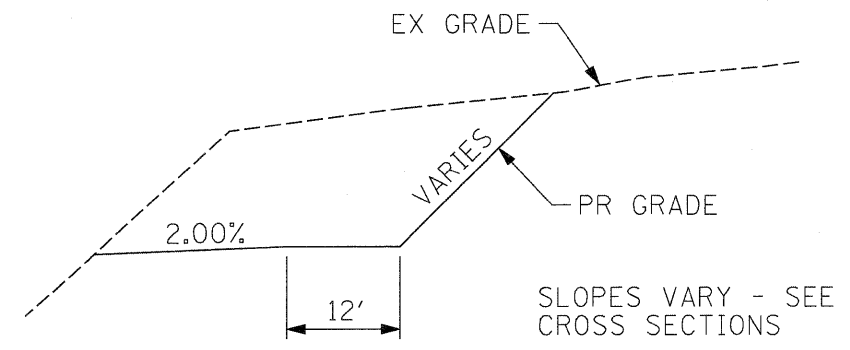
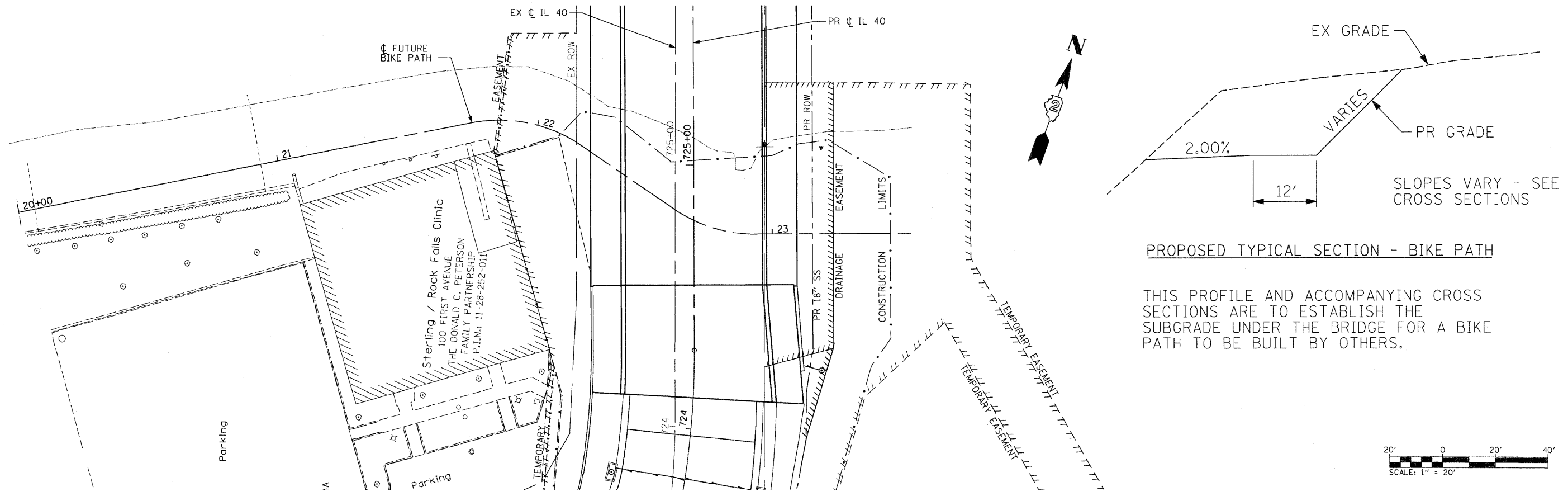

PROPOSED TYPICAL SECTION - BIKE PATH

THIS PROFILE AND ACCOMPANYING CROSS SECTIONS ARE TO ESTABLISH THE SUBGRADE UNDER THE BRIDGE FOR A BIKE PATH TO BE BUILT BY OTHERS.

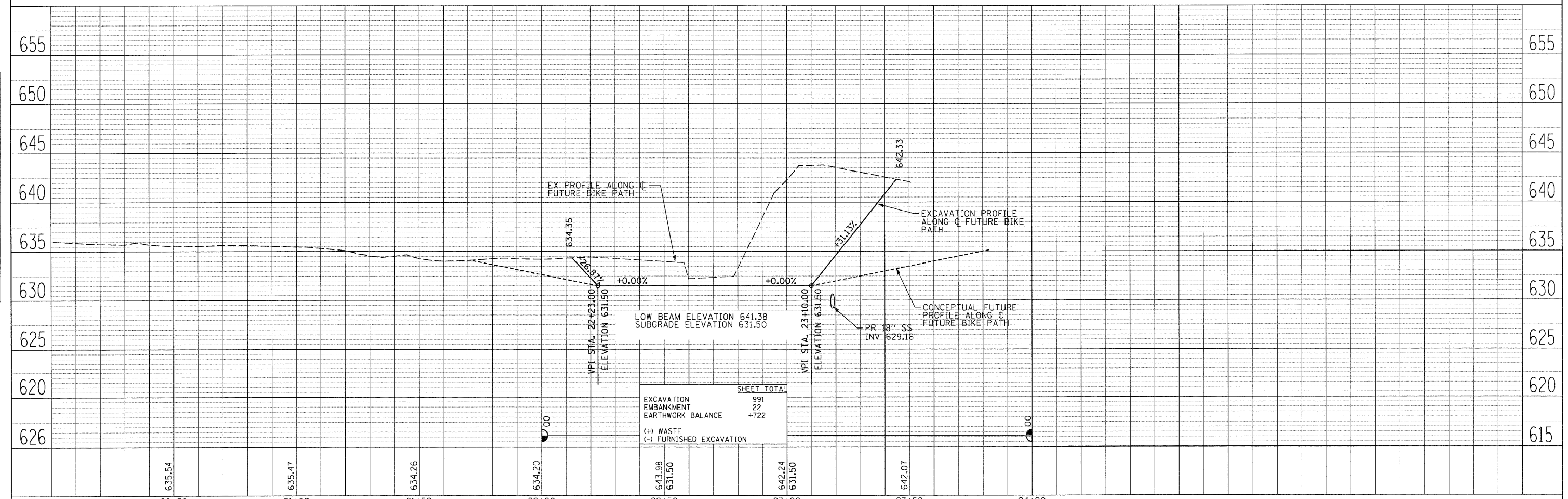
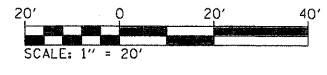

FILE NAME = 0264880-sht-bikepath1.dgn	USER NAME = dwoznarski	DESIGNED -	REVISED -	STATE OF ILLINOIS DEPARTMENT OF TRANSPORTATION	IL 40 FUTURE BIKE PATH EXCAVATION LIMITS AND SECTIONS	F.A.P. RTE. = 646	SECTION = 18-2	COUNTY = WHITESIDE	TOTAL SHEETS = 257	SHEET NO. = 80		
PLOT SCALE = 20.0000' / IN.	CHECKED -	REVISED -	SCALE: 1"=20'			SHEET NO. 1 OF 2 SHEETS	STA. TO STA.	CONTRACT NO. 64B80				
PLOT DATE = 7/14/2011	DATE = 2-22-2010	REVISED -	FED. ROAD DIST. NO. ILLINOIS FED. AID PROJECT									