

ASPHALT SURFACE ADJACENT TO CURB REMOVAL AND REPLACEMENT SHALL BE COLD MILLED TO A DEPTH OF 2" AND A WIDTH OF ONE (1) TO FOUR (4) FEET FROM THE EDGE OF PAVEMENT IN ORDER TO PROVIDE A SMOOTH TRANSITION FROM THE PROPOSED CURB AND GUTTER TO THE EXISTING PAVEMENT SURFACE AND NOT TO EXCEED A 5% CROSS SLOPE. COST OF HMA SURFACE REMOVAL AND REPLACEMENT SHALL BE INCLUDED IN THE COST OF THE COMBINATION CURB AND GUTTER, TYPE B-6.12.

**RESTORATION OF WORK AREA**

RESTORATION OF THE TRAFFIC SIGNAL WORK AREA SHALL BE INCLUDED IN THE COST OF THE RELATED PAY ITEM SUCH AS FOUNDATION, CONDUIT HANDHOLE, TRENCH AND BACKFILL, ETC., AND NO EXTRA COMPENSATION SHALL BE ALLOWED. ALL ROADWAY SURFACES SUCH AS SHOULDERS, MEDIANS, SIDEWALKS, PAVEMENT, ETC. SHALL BE REPLACED IN KIND, ALL DAMAGE TO MOWED LAWNS SHALL BE REPLACED WITH AN APPROVED SOD, AND ALL DAMAGE TO UNMOWED FIELDS SHALL BE SEEDING IN ACCORDANCE WITH STANDARD SPECIFICATIONS 252 AND 250 RESPECTIVELY.

**NOTE:**

THE TRAFFIC SIGNAL CONTROLLER EQUIPMENT FOR THIS PROJECT SHALL BE "EAGLE" TO MATCH THE EXISTING ADJACENT SYSTEM. ALL SIGNAL POSTS WILL BE 18' UNLESS OTHERWISE NOTED.

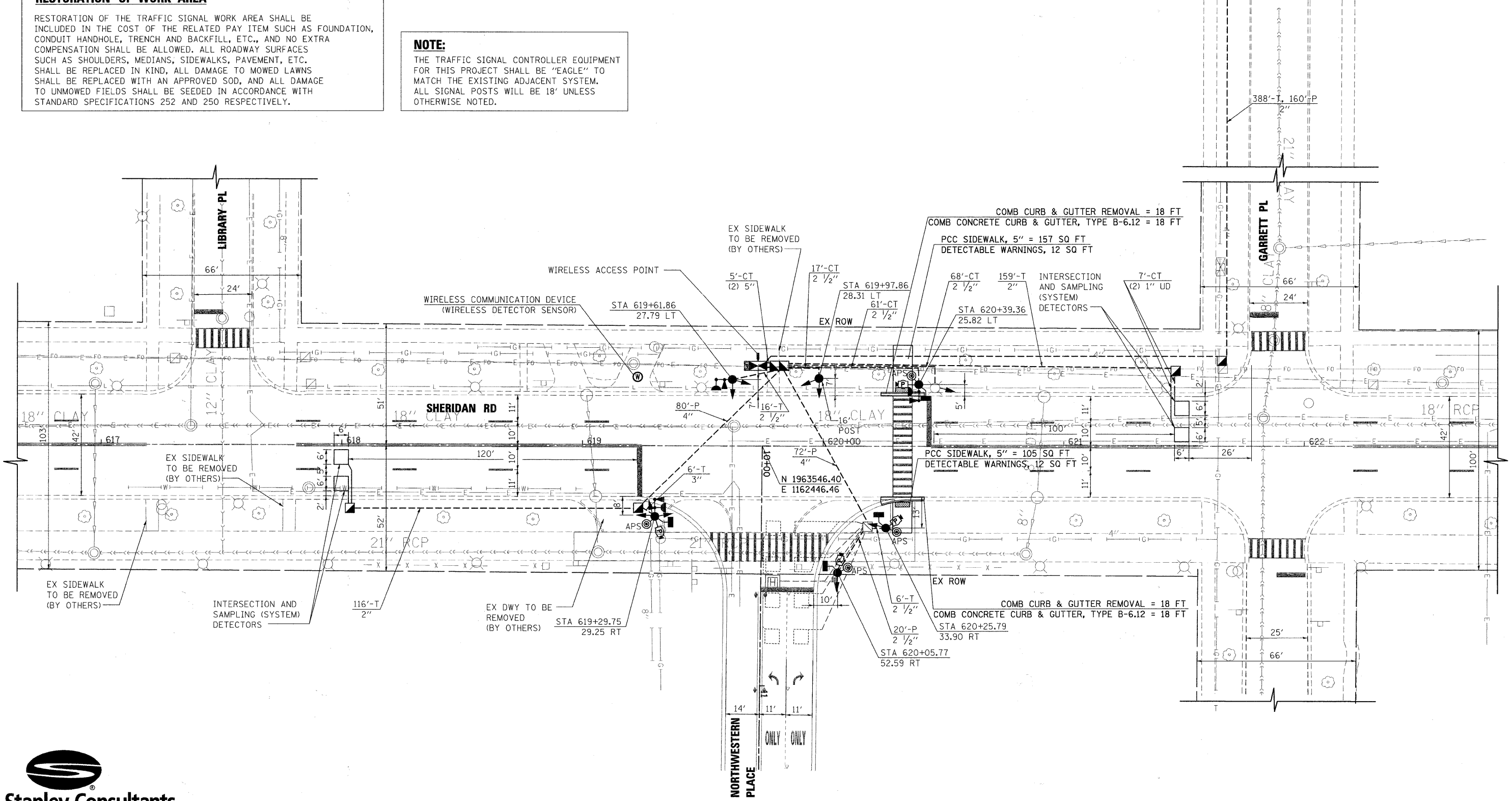
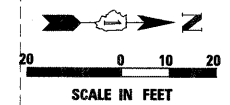

FILE NAME = 12\_023381-pln-003.dgn

USER NAME = USER8291  
 PLOT SCALE = 1:20  
 PLOT DATE = 9/9/2011

DESIGNED - THG/MPW  
 DRAWN - THG/MPW  
 CHECKED - SRS  
 DATE - 08/16/11

REVISED -  
 REVISED -  
 REVISED -  
 REVISED -

STATE OF ILLINOIS  
 DEPARTMENT OF TRANSPORTATION

TRAFFIC SIGNAL MODERNIZATION PLAN  
 SHERIDAN ROAD AND NORTHWESTERN PLACE  
 SCALE: 1" = 20'  
 SHEET NO. OF SHEETS STA. TO STA.

F.A.U. RTE. 2853	SECTION 10-00258-00TL	COUNTY COOK	TOTAL SHEETS 38	SHEET NO. 12
CONTRACT NO. 63630			ILLINOIS FED. AID PROJECT	