

FINAL SURVEY	DATE
SURVEYED	BY
PLOTTED	
NOTE BOOK	
DATE	
AREAS	
CHECKED	
NO.	

ORIGINAL SURVEY	DATE
SURVEYED	BY
PLOTTED	
NOTE BOOK	
DATE	
AREAS	
CHECKED	
NO.	

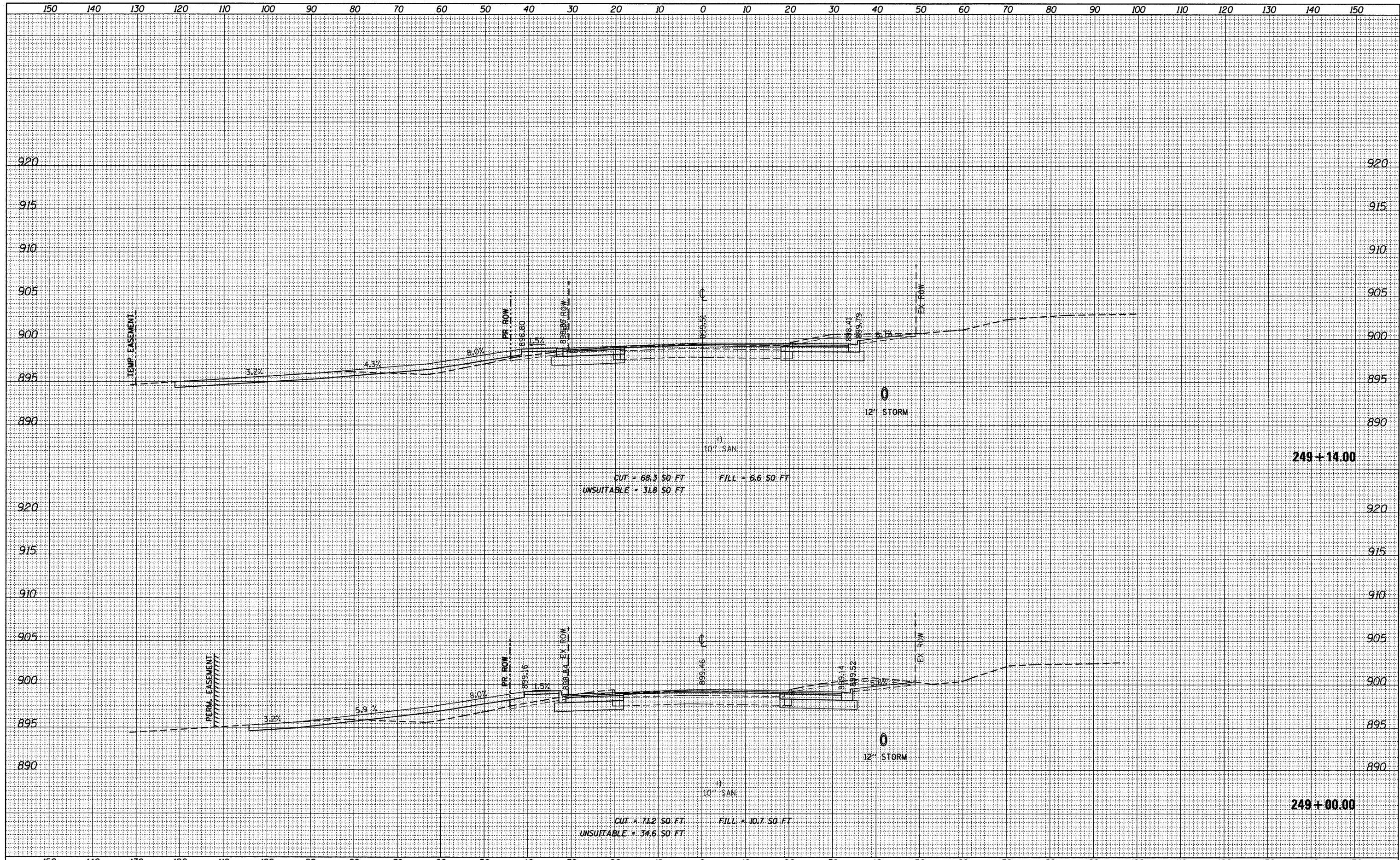

CUT = 68.3 SO. FT  
 FILL = 6.6 SO. FT  
 UNSUITABLE = 31.8 SO. FT

CUT = 71.2 SO. FT  
 FILL = 10.7 SO. FT  
 UNSUITABLE = 34.6 SO. FT

FILE NAME =	USER NAME = cesario	DESIGNED <i>BD</i>	REVISED -	<b>STATE OF ILLINOIS</b> <b>DEPARTMENT OF TRANSPORTATION</b>	<b>CONGRESS PARKWAY CROSS SECTIONS</b> 1"=10' HORIZ. SCALE: 1"=5' VERT. SHEET NO. 87 OF 92 SHEETS STA. 249+00.00 TO STA. 249+14.00	F.A.U. RTE.	SECTION	COUNTY	TOTAL SHEETS	SHEET NO.
F:\396-064 Pingree Road\CADD\Sheets\ldot Form\163519_Congress.dgn	PLLOT SCALE = 10.0000' / IN.	DRAWN <i>JPS</i>	REVISED -			126	95-00090-01-FP	MCHENRY	92	87
PLLOT DATE = 9/14/2011	DATE <i>08-29-2011</i>	CHECKED <i>BD</i>	REVISED -			CONTRACT NO. 63519				
		REVISIED -	REVISED -			ILLINOIS FED. AID PROJECT				